



TRAINING HANDBOOK

Understanding the functions
and applications of
Multiquip products.

TABLE OF CONTENTS

COMPACTION

- Rammers 2
- Plate Compactors 3-4
- Rollers 5-6

CONCRETE FINISHING

- Walk-Behind Trowels 8
- Ride-On Trowels 9
- Chemical Spraying Systems 10
- Screeds 11

CONCRETE & MASONRY EQUIPMENT

- Mixers 13
- Concrete Vibrators 14
- Rebar Equipment 15
- Mud Tubs 16

POWER BUGGIES

- MQ TuffTruk 18
- MQ Whiteman Buggies 19

DEWATERING

- Submersible Pumps 21
- Centrifugal Pumps 22
- Diaphragm Pumps 23
- Water Trailers 24

LIGHTING SOLUTIONS

- Diffused Lighting 26
- Light Towers 27
- Cart Lighting 28

GENERATORS & WELDERS

- MQ Power Generators 30
- Welders 31

COMPACTION



Rammers
Plate Compactors
Rollers



RAMMERS



MTX60HD

Trade Names

Jumping Jack - Tamper - Packer - MQ Mikasa

How do Rammers Work?

Rammers use a crank gear and connecting rod to compress springs located in the lower end of the unit. This results in HIGH amplitude, LOW frequency IMPACT that consolidates material, removes air pockets and increases load bearing ability.

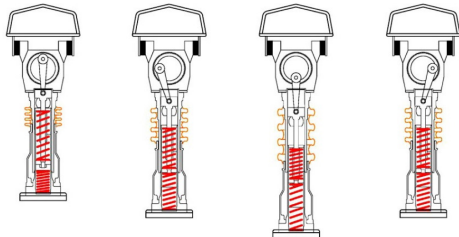

Who Uses Rammers?

Underground and general contractors, municipalities, landscapers, utilities

What Soil Type Is Ideal For Rammers?

Ideal for compacting cohesive soils, but not suited for granular material

Where Are Rammers Needed?

Trench compaction, confined areas, utility construction, cemeteries, plumbing and landscaping

What Else May The Customer Need?

Users may require transit levels, shovels, cutoff saws, safety equipment, skid steers, mini-excavators and water trailers

Let's Talk Rammers.

- 1. Selection** - Multiquip offers 6 different models including narrow trench rammers
- 2. MQ Zero** - Emission-free option of Honda battery powered rammer at 165 pounds
- 3. Ergonomics** - Vibration dampening of handle and well balanced design reduce operator fatigue
- 4. Reliable Starting** - Honda Engines
- 5. Reduced Down Time** - MTX-Series rammers feature cyclonic air filters with two-stage pre-cleaners
- 6. Simple Operation** - A single lever controls throttle, start/stop and fuel shut-off function

Learn more! Download MQ Rammer brochure or the MQ Soil Compaction Handbook at multiquip.com

DID YOU KNOW?

Narrow trench shoes are available as options.



FORWARD PLATE COMPACTORS



Trade Names

Plate - Forward Plate - Tamper - Compactor - MQ Mikasa

How do Rammers Work?

Forward plate compactors use a v-belt drive to turn a rotating eccentric shaft mounted on the baseplate to compact and generate forward momentum. The result is LOW amplitude, HIGH frequency VIBRATION that consolidates the material, removes air pockets and increases load bearing ability.

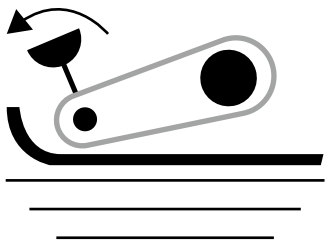

Who Uses Plate Compactors?

Asphalt, underground, concrete and general contractors; municipalities, landscapers, utilities

What Soil Type Is Ideal For Plates?

Granular material and asphalt

Where Are Plates Needed?

Site preparation, asphalt patching, confined areas, utility construction, paving stone, residential, plumbing and landscaping

What Else May The Customer Need?

Users may require transit levels, shovels, cutoff saws, paving stone mats, safety equipment, skid steers, mini-excavators and water trailers



MVC64VHW

Let's Talk Forward Plates.

- 1. Selection** - Multiquip offers 10 different models including paver plates
- 2. MQ Zero** - Emission-free option Honda battery powered plate at 14" wide
- 3. Ergonomics** - Vibration dampened handle minimizes vibration to the operator and reduces fatigue
- 4. Reliability** - Honda engines assure easy starting
- 5. Water Tanks** - Self-contained, easily removed without tools, features a tethered fill cap and no external water lines
- 6. Easy Clean Up** - Open base plate design should permit easy clean up and not trap rocks or debris

Learn more! Download MQ Plate Compactor brochure at multiquip.com

DID YOU KNOW?

Paving stone mats and wheel kits are available for MVC88-Series plates.



REVERSIBLE PLATE COMPACTORS



Trade Names

Plate - Reversible Plate - Tamper - MQ Mikasa

How do Reversible Plates Work?

Reversible plate compactors use a hydraulic drive to adjust twin rotating eccentric shaft mounted on the baseplate. The positioning of the weights allows forward, reverse or spot compaction.

The result is low amplitude, high frequency vibration that consolidates the material, removes air pockets and increases load bearing ability.

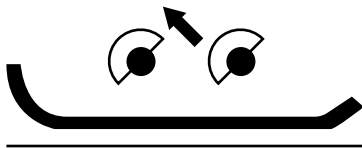

Who Uses Reversible Plate Compactors?

Asphalt, underground, concrete and general contractors; municipalities, landscapers, utilities

What Soil Types Are Best For Plates?

Ideal for compacting granular material and in some cases asphalt

Where Are Plates Needed?

Site preparation, decorative asphalt, confined areas, utility construction, residential, plumbing and landscaping

What Else May The Customer Need?

Users may require transit levels, shovels, safety equipment, skid steers, miniexcavators and water trailers



MVH128GH

Let's Talk Reversible Plates.

- 1. Selection** - Multiquip offers 8 different models
- 2. MQ Zero** - Emission-free option Honda battery powered plate at 14" wide
- 3. Ergonomics** - Vibration dampened handle minimizes vibration to the operator and reduces fatigue
- 4. Engine options** - Gasoline and diesel engine options are available
- 5. Force** - Reversible plates offer great compaction value and the best "bang for your buck"
- 6. Compass Technology** - Optional Compaction Analyzing System removes the guesswork with an easy to read LED panel guiding the operator as soil stiffness increases.

Learn more! Download MQ Reversible Plate brochure at multiquip.com

DID YOU KNOW?

Select MQ reversible plates include bolt on extensions that allow you to change the plates working width.

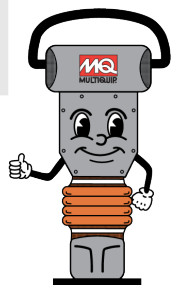

TRENCH ROLLERS



Trade Names

Articulating Roller - MQ Rammax

How do Trench Rollers Work?

The rollers feature drums adaptable to trench widths of 24" and 33". Steel pads provide traction for cohesive and mixed soil conditions common in many excavations. Diesel powered and hydraulically driven, it is controlled with a wireless remote keeping the operator safely out of the trench. Large eccentrics provide high centrifugal force for greater productivity.

Who Uses Trench Rollers?

Commercial and general contractors; underground utility, and pipeline contractors

Where Are Trench Rollers Needed?

Backfills, railway and dam construction, Site preparation, utility construction, confined areas, landfills, pipeline

What Else May The Customer Need?

Operators may require forward plates, rammers, concrete vibrators, rebar equipment, skid steers, safety equipment.



RX1575

Let's Talk Trench Rollers.

- 1. Flexible drums** feature easy to remove drum rings that adjust from 33" to 24" working widths.
- 2. Increased performance and stability** on uneven surfaces with a maintenance free oscillating articulation joint.
- 3. Increased control in all terrain conditions** with a wireless remote transmitter covering a wider operational area & two ideally positioned receiver eyes.
- 4. Charge the remote control battery** with a solar panel or cable connector.
- 5. Easy access to all maintenance points** with fold-up front and rear covers.

Learn more! Download MQ Trench Roller brochure at multiquip.com

DID YOU KNOW?

The RX1575 is the only trench roller to use a solar panel to charge the remote.



ASPHALT ROLLERS



Trade Names

Drum Roller - Road Roller - Smooth Roller

How do Ride-On Asphalt Rollers Work?

Hydraulically driven tandem drums use dynamic force, a combination of static pressure and force from a rotating eccentric, to compact the underlying surface. Low amplitude (.019"), medium frequency vibration (4,200 VPM) makes it ideal for both granular soil and asphalt applications.

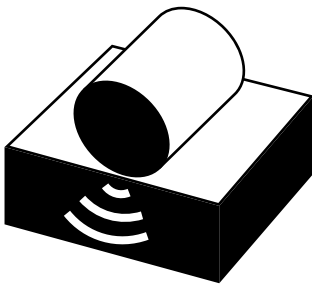

Who Uses Asphalt Rollers?

Residential, commercial and concrete contractors; municipalities, DOT's

Where Are Asphalt Rollers Needed?

Asphalt paving and patching, compaction of granular material and road base

What Else May The Customer Need?

Vibratory plates, Water trailers, Safety Equipment, hand tools

V305EK

Let's Talk Asphalt Rollers.

- 1. Reliable Honda GX630 engine** offers easy starting and exceptionally quiet operation.
- 2. Compact design** provides clear sight lines for better steering.
- 3. Recessed drive motors** and minimal frame overhang enables clearance of high curbs and obstructions
- 4. Maintenance free articulation joint and vibratory assembly** greatly reduces service time.
- 5. Heavy duty steel frame** and high strength fiberglass composite resist wear and are exceptionally durable.
- 6. Easy to use controls** provide intuitive access to vibration, water pump and water flow controls.

Learn more! Download the AR14 brochure at multiquip.com

DID YOU KNOW?

Double-drum rollers are popular, but municipalities often look for single drum rollers like the V305-series.



CONCRETE FINISHING EQUIPMENT

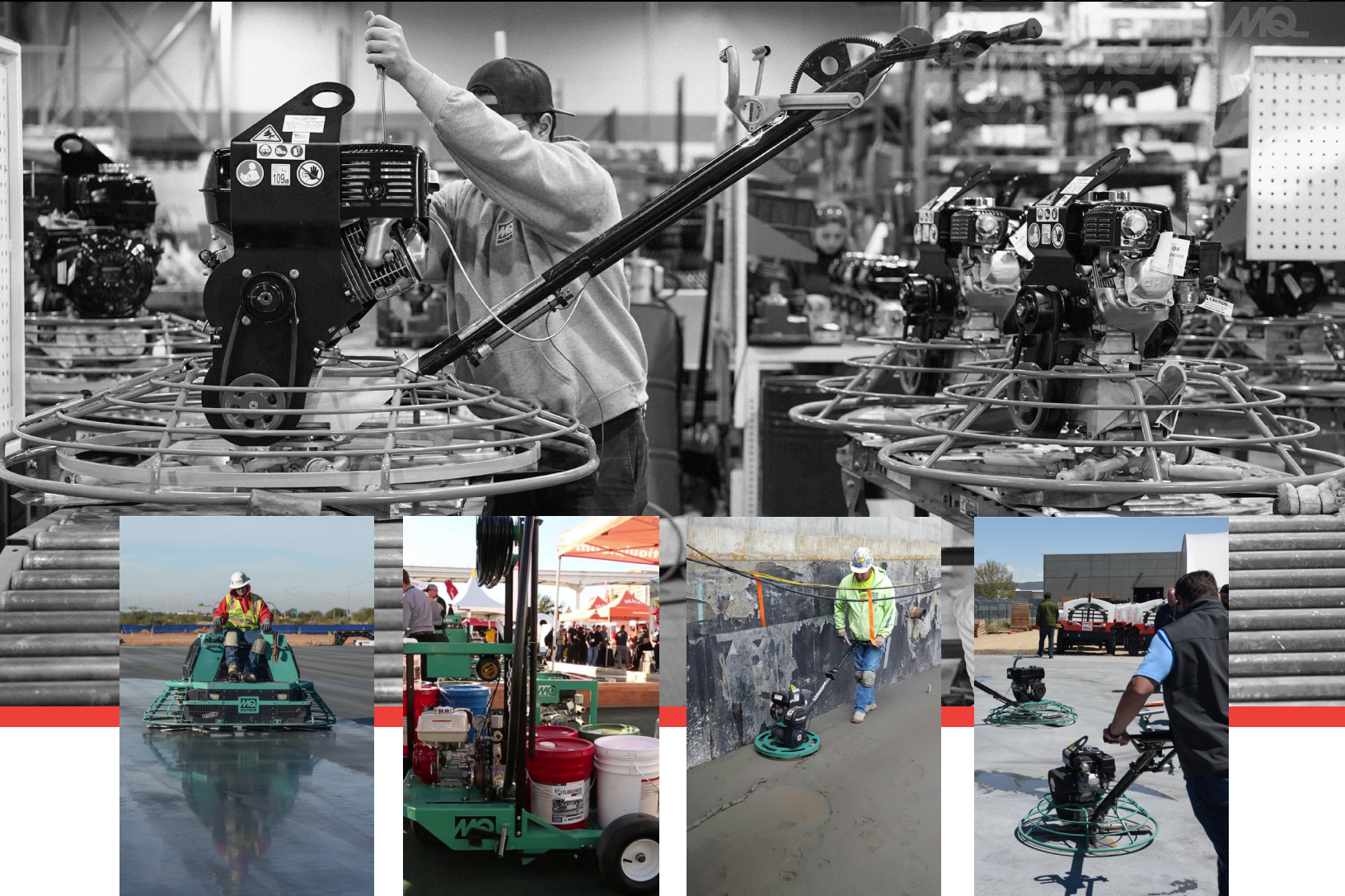

Walk-Behind Trowels
Ride-On Trowels
Screeds
Chemical Spraying Systems



WALK-BEHIND POWER TROWELS



Trade Names

MQ Whiteman - Trowel Machine - Trowel - Finisher

How do Walk-Behind Power Trowels Work?

The operator makes overlapping passes on the concrete surface using the rotating blades to first open (float) and later seal (finish) the floor. The number of passes depends on the desired finish.

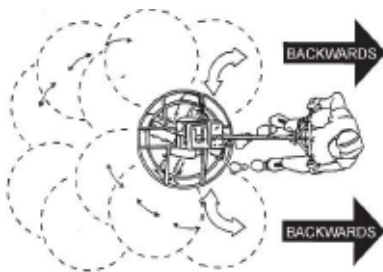

Who Uses Walk-Behind Power Trowels?

Concrete and general contractors, landscapers, and utility companies

What Types Of Jobs Require Walk-Behind Power Trowels?

Driveways, patios, parking garages and industrial or commercial flatwork; models are available for edging and working around plumbing and support structures

Where Are Walk-Behind Power Trowels Needed?

Trowels are commonly used on residential, commercial and industrial flatwork

What Else May The Customer Need?

Concrete buggy, bull float, hand trowels, shovels, come-along, hand held or vibratory screed, and safety equipment.



B46H90

Let's Talk Walk-Behind Power Trowels.

- 1. Selection** - Multiquip offers five different sizes of walk-behind power trowels that include seventeen different variations.
- 2. Ergonomics** - Height adjustable handles with superior vibration dampening reduce operator fatigue.
- 3. Reliability** - Reliable Honda and Briggs & Stratton engines assure easy starting.
- 4. Performance** - Proven gearboxes with top-quality components and durable spider assemblies ensure optimal performance.
- 5. Control** - Optimally balanced machines are easy to control and help operators achieve flatter floors.

Learn more! Download Walk-Behind Power Trowel brochure at multiquip.com

DID YOU KNOW?

Marvin Whiteman invented the original walk-behind power trowel in 1939.



RIDE-ON POWER TROWELS



Trade Names

MQ Whiteman - Trowel Machine - Trowel - Finisher

How do Ride-On Power Trowels Work?

Ride-on trowels are favored by flatwork specialists for their high productivity and ability to achieve flatter floors. They are used for high tolerance commercial and industrial floors as well as tilt-up and multistory applications.

Who Uses Ride-On Power Trowels?

Concrete flatwork and general contractors

What Types Of Jobs Are Best For Ride-On Power Trowels?

Jobs over 10,000 ft² requiring high F-Numbers, warehouses, big box retailers, high-rise construction

What Else May The Customer Need?

Users may require a concrete buggy, bull float, hand trowels, shovels, come-along, hand held or vibratory screed, and safety equipment.



HTX6H

Let's Talk Ride-On Power Trowels.

- 1. Selection** - Multiquip offers three different sizes of ride-on trowels that include three mechanical and five hydraulic driven models
- 2. Ergonomics** - Vibration dampened engine mount minimizes vibration to the operator and reduces fatigue
- 3. Performance Reliability** - MQ Whiteman riders come with these engine options: Honda, Hatz, Yanmar, Kohler, Kubota and Briggs & Stratton
- 4. Optimal Rotor Speeds** - Ranging from 0-180 RPM
- 5. Optimally balanced for smooth finishing and operator comfort**

Learn more! Download the Ride-On Power Trowel brochure at multiquip.com

DID YOU KNOW?

Multiquip offers a variety of blades and pans.



CHEMICAL SPRAYING SYSTEM



Trade Names

Spray Carts - Sprayers

How do Spray Systems Work?

Spray systems are used to apply many types of chemical additives to residential, decorative and general construction flatwork.

A single cylinder gear reduction gasoline engine drives a heavy duty chemical pump. Operator can easily apply product that consists of up to 20% solids.



Who Uses Spraying Systems?

Concrete and general contractors, residential-decreeive specialists

How Are Spraying Systems Used?

To apply specific concrete enhancing chemicals and curing additives.

What Else May The Customer Need?

Extra hoses, couplers, spray nozzles.



Let's Talk Chemical Spraying Systems.

1. **Powerful 5.5 HP Honda GX160** engine with gear reduction provides reliable operation
2. **Quick disconnect** hose connections for simple operation
3. **Engine-driven compressor** for recycling any leftover product remaining in the system back into the original container
4. **Convenient work tray** holds tools and other on-site needs.
5. **Hose rack** accommodates up to 250 feet of hose. Sprayers come complete with a wand and a 50 foot hose standard. Additional hoses available

Learn more! Download the MQ WSC55 spray cart brochure at multiquip.com

DID YOU KNOW?

The WSC55 also comes with smooth tires to reduce risk of floor damage and fork truck pockets.



SCREEDS

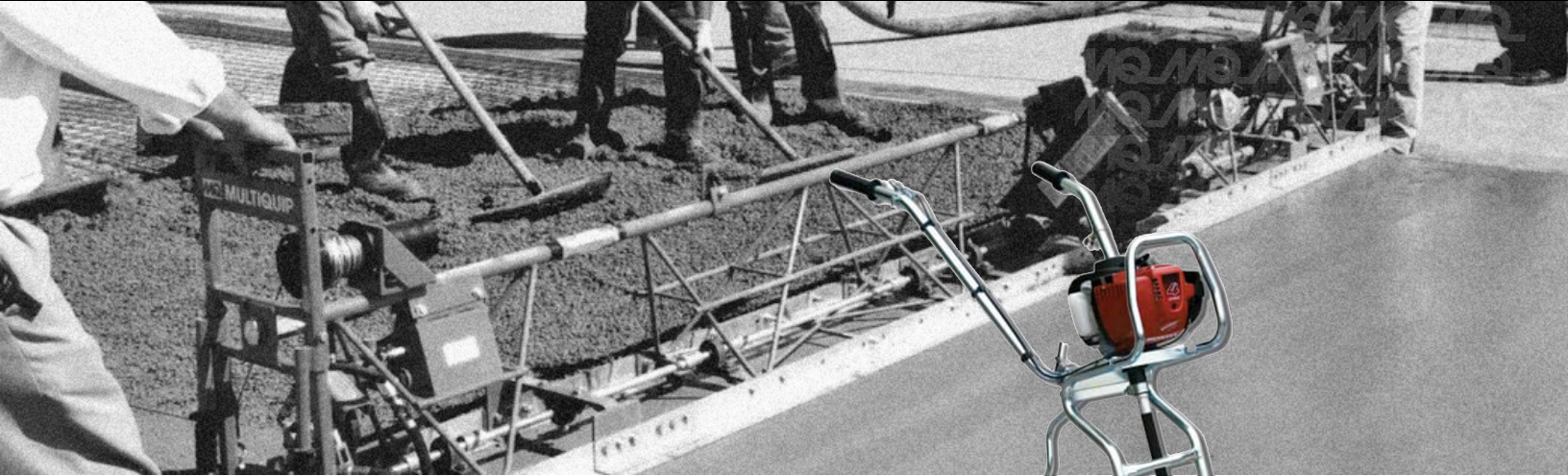

Trade Names

Truss - Strike Off - Wet Scream - DuoScreed

How do Screeds Work?

As concrete is placed, pockets of air and aggregate develop. A screed levels and may vibrate the concrete to settle the aggregate and bring the air up to the surface for proper finishing.

Walk-Behind Screeds – Ideal for smaller residential and commercial flatwork jobs, the DuoScreed is suitable for medium to high slump applications.

Truss Screeds – Ideal for commercial or industrial flatwork and paving jobs. All steel construction makes it the best choice for medium to high slump conditions.

Who Uses Concrete Screeds?

Homeowners, general contractors, concrete contractors and municipalities

What Else May The Customer Need?

Safety equipment, vibrators, trowels, hand tools and rebar equipment



DSGPLUW

Let's Talk Screeds.

1. Selection – Multiquip offers 2 types of screeds. DuoScreed, Truss Scream each designed to cover a variety of application and job requirements.

2. Plan Ahead – Do you need flexibility to adapt for tomorrow's jobs? Don't undersize!

3. What's my slump? Stiff, dry, mix designs require extra power to cut through the mud.

4. Quick Setup Required? The DuoScreed delivers and is ideal for municipal, residential and smaller industrial work.

Learn more! Download the Scream brochure at multiquip.com

DID YOU KNOW?

MQ Whiteman truss screeds can extend up to 65' in length.



CONCRETE & MASONRY EQUIPMENT



Mixers
Concrete Vibrators
Rebar Equipment
Power Buggies
Mud Tubs



MIXERS



Trade Names

Concrete Mixers - Mortar Mixers - Plaster Mixers

Plaster / Mortar Mixers use a stationary tub with rotating paddles to tumble a mixture of water, sand and cement. They cannot handle large aggregate.

Concrete Mixers use a rotating drum with fixed paddles to tumble a mixture of water, sand, cement and aggregate.

Who Uses Mixers?

General contractors, farmers, masonry and contractors, municipalities and public works

Where Are Mixers Needed?

Commercial, residential, rural and general construction, fireproofing, swimming pool construction

What Else May The Customer Need?

Masonry block saws, cut-off saws, concrete vibrators, hand tools, rebar equipment



MC44SH

Let's Talk Mixers.

- 1. Brand Recognition** - MQ Essick and MQ Whiteman are the leading names in towable mixers
- 2. Steel tub construction** is the preferred choice of professional masonry contractors for their long life.
- 3. Polyethylene construction** offers a very durable alternative to steel and greatly reduces cleanup time
- 4. Power options** include electric motors and Honda gasoline engines
- 5. Indoor work** is possible with compact, wheel barrow type concrete and mortar mixers

Learn more! Download the Mixer brochure at multiquip.com

DID YOU KNOW?

EasyClean™ polyethylene tubs withstand below freezing conditions in Alaska to the scorching heat of Arizona summers.



CONCRETE VIBRATORS



Trade Names

Vibrator - Flex-Shaft - High Cycle - Poker - Whips - Stingers

How do Concrete Vibrators Work?

A rotating eccentric weight creates high frequency vibration to remove air from the concrete after placement, consolidating the material and producing a product with higher strength.



Who Uses Concrete Vibrators?

General contractors, concrete contractors, utility construction, government agencies and municipalities

What Applications Use Concrete Vibrators?

Bridges, skyscrapers, home footings, masonry block fill, concrete flatwork, roadways, paving and pre-cast industry

How To Pick The Correct Concrete Vibrator?

Flex-shaft-vibrators - recommended for medium to high concrete slump conditions. High-cycle vibrators - best for low slump application

What Else May The Customer Need?

Users may require, mixers, concrete pumps, rebar equipment, masonry saws, mud tubs

Let's Talk Concrete Vibrators.

- 1. Selection** - MultiQuip offers Flex-shaft models and High-cycle models to meet any application requirement.
- 2. Head construction** - Industrial grade steel casings and roller bearings insure long operation with minimal maintenance.
- 3. Flex shaft options** - Choose rugged UL listed motors or Honda powered drive units. Couple with shafts ranging from 2' to 21' in length and steel heads up to 2-5/8" diameter.
- 4. High-Cycle options** - FX and FXA series vibrators feature a motor-in head design to optimize performance, pair with a 60/180 Hz generator or high-frequency inverter.

Learn more! Download the Concrete Vibrator brochure at multiquip.com

DID YOU KNOW?

High Frequency Inverter Concrete Vibrators allow the operator to change output frequency according to the slump conditions.



REBAR EQUIPMENT



Trade Names

Cutter - Bender

Rebar Cutters use an electric motor to drive a hydraulic pump that forces a piston equipped with a cutting blade forward to shears the rebar.

Rebar Benders use an electric motor to drive a set of gears that forces a roller (die) around a collar (die) to a preset stop making a specific radius bend.

Who Uses Rebar Benders?

General contractors, concrete contractors, utility construction, government agencies and municipalities

Is All Rebar The Same?

Rebar varies by diameter and hardness (grade). Check the specifications of the material to ensure it is matched to the performance capability of the machine.

What Else May The Customer Need?

Users may require hearing protection, eye protection, mixers, and vibrators, rebar tying and cutting equipment



MB25A

Let's Talk Rebar Equipment.

- 1. Cutting time** – Cut 60,000 psi rated rebar in less than 3 seconds and substantially reduce labor.
- 2. Cutting surface** – The HBC series uses heat-treated, high-strength, steel cutting blades.
- 3. Magnetic particle filter** – Built into the hydraulic reservoir, assists in keeping wear debris out of the hydraulic system.
- 4. Capacity** – Multiquip's MB25A can bend anything between 3/8" (#3 rebar) & 1" (#8 rebar).
- 5. Bending surface** – The MB25A is equipped with a 1/2" solid steel top plate. Wear and tear are virtually non-existent
- 6. Precise Control** – fine tune angle adjustment to increase or decrease the bend radius according to size and PSI rebar in use.

Learn more! Download Rebar Equipment brochure at multiquip.com

DID YOU KNOW?

Double-drum rollers are popular, but municipalities often look for single drum rollers like the V305-series.



MUD TUBS



Trade Names

Tub - Mortar Tub

What are MUD TUBS?

The Multiquip MUD TUB is the easy choice for supplying mortar to professional masons. It is engineered for durability & easy cleanup with two available models to meet your job requirements.

Who Uses MUD TUBS?

Mortar and professional masions.

What Else May The Customer Need?

Rubber mallet, gloves, etc.



MUDTUB

Let's Talk MUD TUBS.

- 1. Capacity** - 10 cubic foot polyethylene tub
- 2. Easy Clean** - Can be cleaned in minutes with tap of rubber mallet
- 3. Highly Durable** - Polyethylene construction resistant to cold weather and UV
- 4. Ease of Transportation** - MUD TUB W features heavy duty high impact resistance 8 inch caster wheels
- 5. Reduced Maintenance** - Resists dents, rust, and cracks

Learn more! Download the MUD TUB brochure at multiquip.com

DID YOU KNOW?

MUD TUBS can carry up to a 1,000 pound capacity.



POWER BUGGIES



TuffTruck
MQ Whiteman Buggies



TuffTruk



Trade Names

Georgia Buggy - Buggy - Track Buggy

How do TuffTruks Work?

Power buggies were originally developed as a way to quickly place concrete on job sites. Their versatility and drive options, make them a popular choice for other applications including landscaping and debris removal.

Who Uses TuffTruks?

Asphalt, underground, concrete and general contractors; landscapers, utilities, municipalities

What Can TuffTruks Carry?

Concrete, debris, landscaping material, soil, rocks, sub-base material

What Else May The Customer Need?

Concrete vibrators, screeds, trowels, rebar equipment, cut-off saws

TB12PE

Let's Talk Power Buggies.

- 1. Tub Construction** – choose between polyethylene or steel tub
- 2. Tub Capacity** – 6 ft³ capacity polyethylene tub carries material or debris and passes through 36-inch openings
- 3. Run Time** - high torque electric drive provides solid 8 hour run time under full load
- 4. Long Lasting Charge** lasts 2 to 3 days working under typical conditions
- 5. MQ Zero** – The TuffTruk offers the convenience of battery power and integral 120 volt charging

Learn more! Download the MQ TuffTruk brochure at multiquip.com



DID YOU KNOW?

TuffTruk has a patented 40° articulation angle and 56-inch turning radius.



MQ WHITEMAN BUGGIES



Trade Names

Georgia Buggy - Buggy - Track Buggy - TuffTruk

How do Power Buggies Work?

Power buggies were originally developed as a way to quickly place concrete on job sites. Their versatility and drive options, make them a popular choice for other applications including landscaping and debris removal.

Who Uses Power Buggies?

Asphalt, underground, concrete and general contractors; landscapers, utilities, municipalities

What Can Buggies Carry?

Concrete, debris, landscaping material, soil, rocks, sub-base material

What Else May The Customer Need?

Concrete vibrators, screeds, trowels, rebar equipment, cut-off saws



WTB-16

Let's Talk MQ Whiteman Buggies.

- 1. Tub Construction** – polyethylene tub facilitates quick clean-up
- 2. Tub Capacity** – choose from either 16 or 21 cubic foot models
- 3. Drive Options** - models are available with wheel or track drive to power through tough conditions
- 4. Tires** – Foam filled tires eliminate down time and provide "air-like" ride quality
- 5. Heavy Duty** frame with low center of gravity

Learn more! Download the MQ Whiteman Power Buggy brochure at multiquip.com

DID YOU KNOW?

You can remove the outer wheels of our 16 cubic foot model to pass through narrow doorways.



DEWATERING



Submersible Pumps
Centrifugal Pumps
Diaphragm Pumps
Water Trailers



SUBMERSIBLE PUMPS

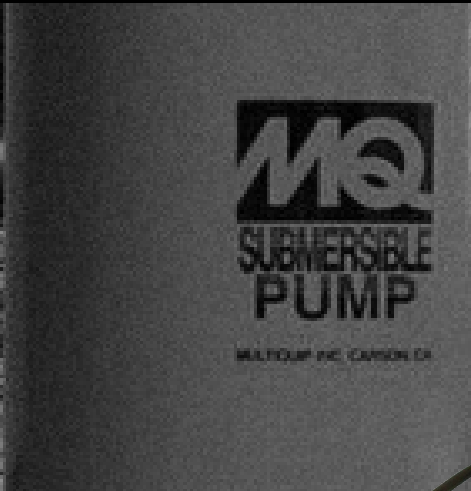

ST2038P

Trade Names

Sub Pumps - Electric Sump Pumps - Sump Pumps

How do Submersible Pumps Work?

Submersible pumps require no priming since they are in the water source. This eliminates cavitation and the need for suction hose. A hermetically sealed motor close-coupled to an impeller uses rotary (kinetic) energy to pressurize and discharge water from the pump to the surface via hose or pipe. Performance is measured as either flow (gallons per minute) or pressure (head).

Who Uses Submersible Pumps?

Underground and general contractors, emergency response, pool contractors, public works groups, municipalities, landscapers, plumbers, utility organizations, clean-up/restoration businesses, and DIY.

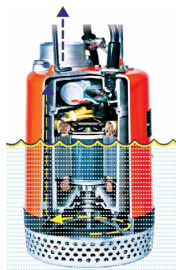

Where Are Submersible Pumps Needed?

Well casings, excavations, ponds, standing water, flooded rooftops and basements, swimming pools/spas, transformer vaults, and manholes.

What Else May The Customer Need?

Control boxes, float switches, NPT Thread or Cam & Groove quick disconnect hose, filter socks, couplers, PVC pipe, stability platforms, generators and tethering cable.

What Type Of Fluid Does A Sub Pump Handle?

Standard Centrifugal pumps handle water, small amounts of debris, and a small percentage of selected chemicals laced in the water source.

Trash pumps handle water that has higher amounts of debris and a small percentage of selected chemicals laced in the water source.

Let's Talk Submersible Pumps.

- 1. Selection** - Multiquip offers 12 centrifugal and 4 trash pump models ranging from 3/4" to 6" discharge.
- 2. Professional Grade Motor** - all electric motors are designed with 100% copper windings
- 3. Industrial Grade Components** - Oil filled, dual sealed stainless steel bearings to ensure operational longevity.
- 4. Internal Motor Protections** - dual insulated casing designs to cool the motor and automatic thermal overload protection for all single phase models.
- 5. High Performance** - exceptionally powerful flow and head rates; low operating amp requirements.
- 6. Electrical Ratings** - all single phase models provide UL/CUL certifications.

Learn more! Download MQ Sub Pump brochure or the MQ Pumping Handbook at multiquip.com

DID YOU KNOW?

MQ submersibles can pump water temperatures up to 160°.



CENTRIFUGAL PUMPS

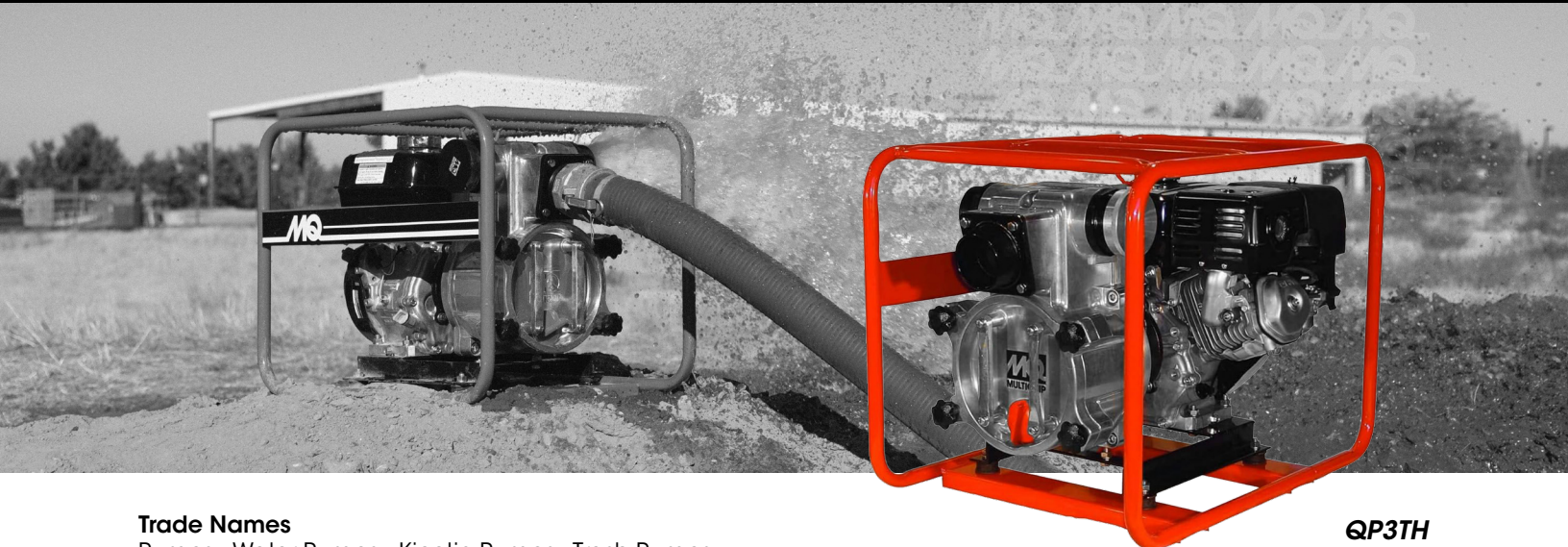

Trade Names

Pumps - Water Pumps - Kinetic Pumps - Trash Pumps

How do Centrifugal Pumps Work?

Centrifugal pumps use kinetic energy from a rotating impeller to move water. A rotating impeller churns a mixture of air and water inside a spiral casing (volute) that purges air from the pump. This action primes the pump by creating an area of low pressure within the housing. This in turn creates the "lift" necessary to move water through the suction line and into the housing where it is pressurized and discharged from the pump at considerable velocity.

Performance is measured as either flow (gallons per minute) or pressure (head). The head developed is approximately equal to the velocity energy at the periphery of the impeller.

Who Uses Centrifugal Pumps?

General contractors; farmers, residential and commercial operators, municipalities, government agencies, first response organizations, commercial boat operators, firefighting organizations, pool and spa service companies, public works departments.

Where Are Dewatering Pumps Needed?

Site preparation, utility operations, municipality and public works response, agricultural irrigation settings, protective firefighting options, residential standing water removal, emergency flooding response, sewer dewatering operations, water relocations, dust control and water jetting.

QP3TH

What Else May The Customer Need?

Operators may require either NPT Thread or Cam & Groove Q/D disconnect suction hose, couplers, PVC pipe, gate valves, NPT Thread or Cam & Groove Q/D disconnect discharge hose, couplers and wheel kits.

Let's Talk Centrifugal Pumps.

- 1. Selection** - Multiquip offers 15 models in 2", 3" and 4" .
- 2. Casing Design** - Die-cast aluminum housings provide fast priming, reduced weight and withstand 1.5 X their pressure ratings.
- 3. Service Parts** - Balanced (# 45) ductile iron impeller and volute assembly for abrasion resistance. Reliable silicon/carbon mechanical seal for long operating life.
- 4. Engines** - Honda gasoline engines for most models. Kubota diesels available for trash pumps.
- 5. High Performance** - Exceptionally powerful flow and head rates; with multiple discharge ports on most models for operator convenience.

Learn more! Download the MQ Pumping Handbook at multiquip.com

DID YOU KNOW?

Multiquip offers more portable high pressure pump models than any other manufacturer.



DIAPHRAGM PUMPS

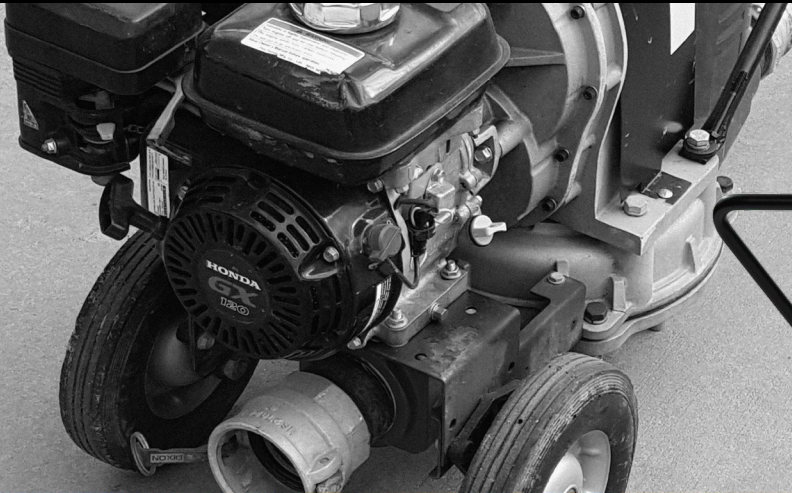

MQD3H

Trade Names

Mud Pumps - Mud Hogs - Membrane Pumps

How do Diaphragm Pumps Work?

Diaphragm pumps move water by contracting or expanding a flexible diaphragm. When expanded it draws in air and fluid into the chamber. The downward stroke pressurizes the chamber to discharge fluid and air. The air handling ability makes it ideal for slow seepage applications where centrifugal pumps would lose their prime.

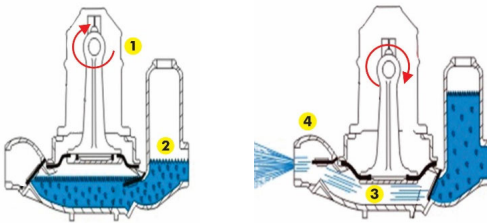

Who Uses Diaphragm Pumps?

General contractors; farmers, residential and commercial operators, municipalities, government agencies, first response organizations, commercial boat operators, pool and spa service companies, public works departments.

Where Are Diaphragm Pumps Needed?

Site preparation, cesspools, septic tanks, slurry removal, slow seepage, utility and public works, agricultural, standing water removal, emergency flooding response, sewer dewatering operations, and thick, heavy viscosity fluids must be moved.

What Else May The Customer Need?

NPT Thread or Cam & Groove Q/D disconnect suction and discharge hoses, couplers and PVC pipe.

Let's Talk Diaphragm Pumps.

- 1. Casing Design** - Die-cast aluminum reduces weight.
- 2. Diaphragm** - Abrasion resistant BUNA N (NBR) for long life and resistance to many alkaline and low pH fluids.
- 3. Quality Engine Choices** - HONDA gasoline engines with low oil shut-off.
- 4. Trusted Performance** - Can be relied upon to move heavy viscosity fluids without cavitation.
- 5. Contractor Features** - Integral wheel kit, easy access clean-out bowl

Learn more! Download the MQ Dewatering Pumps brochure or the Pumping Handbook at multiquip.com

DID YOU KNOW?

Multi-quip offers more portable high pressure pump models than any other manufacturer.



WATER TRAILERS



Trade Names

Water Wagons - Water Trailers

How do Diaphragm Pumps Work?

A standard centrifugal pump (1) draws water from the tank (3) and is tied into the distribution manifold (2). The pressurized water can be discharged through numerous ports on the water trailer (4). A rear spray bar assembly (not shown) operates in a similar manner to the discharge ports.

Who Uses Water Trailers?

General contractors, farmers, residential and commercial operators; municipalities, government agencies, first response organizations and public works

How Are Water Trailers Used?

Construction site dust control, emergency firefighting response, general construction, agricultural and irrigation support, and equipment wash down.

What Else May The Customer Need?

Hoses, couplers, spray nozzles, hose reels, pumps and compaction equipment

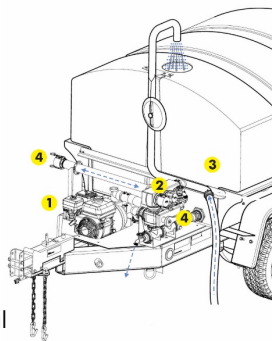

WT5HP

Let's Talk Water Trailers.

1. Trailer Design - A DOT certified, powder coated steel design provides long service life.

2. Tank Design - 6 molded baffles control water movement during acceleration and stopping for smooth towing

3. Simple Manifold Controls - Simple (2) two handle design controls all suction and discharge operations

4. Pump Choice - The Multiquip QP2H centrifugal pump sets the industry standard for 2" pump performance.

5. Easy Coupling - All discharge ports (excluding 3/4" hose bibs) are fitted with cam & groove quick disconnect couplers

Learn more! Download the MQ Water Trailer specifications at multiquip.com

DID YOU KNOW?

The rear spray bar can produce an 8' cone pattern using the gravity feed from the 500 gallon tank.



LIGHTING SOLUTIONS



Diffused Lighting
Light Towers
Cart Lighting



DIFFUSED LIGHTING



Trade Names

Balloon Light - Balloon Bag - GloBug

How Does Diffused Lighting Work?

Diffused lighting provides an alternative solution to conventional light towers and spotlights. Balloon envelopes create a clean, soft light that uniformly illuminates work areas while deducing glare and shadows that may be undesirable. Models range from stand-alone units that are supported by home, shore, or generator electrical power to ones that require mechanical & electric connection to standard, towable mobile light towers.

Balloon Lighting systems are offered with portable stands, mobile carts, or equipment mounting assemblies.

Who Uses Diffused Lighting?

General contractors, Law enforcement and security, residential and commercial operators, municipalities, government agencies, first response organizations, public works departments, rescue, and special events organizations.

Where Are Diffused Lights Needed?

Highway and industrial construction sites, emergency response, flaggers, general construction, agricultural, security, law enforcement check-points, film studios, and special events.

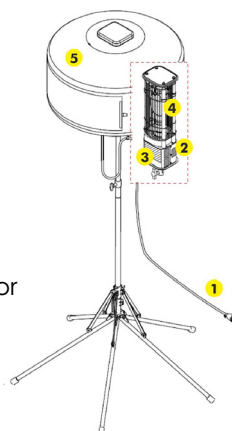

GB3LED

Let's Talk Diffused Lighting.

- 1. Lighting Options** – Conventional metal halide bulbs up to 1000W and energy efficient LED lamps up to 2400W are available.
- 2. Durability** – Balloon material and general components are built to withstand the toughest jobsite requirements.
- 3. Light Coverage** – 360 degrees of exceptional glare free luminance from 60 to over 300 feet.
- 4. Quick Deployment** – Units set-up and are ready to go in minutes.
- 5. MQ Zero** – Lithium-ion battery features fast charge times, higher energy density and long run times

Learn more! Download MQ Lighting Solutions specifications at multiquip.com

DID YOU KNOW?

The GBBAT8BM lighting auto dims when the battery level is low.



LIGHT TOWERS



Trade Names

Tower - Spotlight - GloBug

How do Light Towers Work?

Towable light towers provide stand alone lighting to the job site via a mechanical winch the mast assembly rise to heights of over 25'. Lamps are activated by a control panel. Power to provide electrical power and energy to the lamps is provided by an engine generator set. Electrical continuity for lamp operations is supported by specific power packs.

Who Uses Towable Light Towers?

General contractors, State DOT, farmers, residential and commercial operators, municipalities, government agencies, first response organizations, public works departments, and special events organizations.

Where Are Towable Light Towers Needed?

Highway construction sites, emergency response, general construction, agricultural, security, and special events.



Let's Talk Light Towers.

- 1. High Efficiency LED Lamps** produce powerful, bright white lumen projection.
- 2. Led Longevity And Safety** - Lamps provide 40,000 hours of operational life and allow for immediate strike/re-strike capability.
- 3. Trusted Kubota Diesel Engine** - Fuel efficient and easily maintained with EPA/CARB certifications.
- 4. Aerospace Mast Design** - Anodized aluminum 5-section telescopic mast provides strength and aggressive corrosion resistance.
- 5. MQ Zero** - Lithium-ion battery features fast charge times, higher energy density and long run times

Learn more! Download MQ Lighting Solutions specifications at multiquip.com

DID YOU KNOW?

The GBBAT3S4M fully charges in as little as 5.5 hours.



CART LIGHTING



Trade Names

Balloon Light - Balloon Bag - GloBug

How do Light Towers Work?

Cart lighting units provide tight footprint, flexible power connection, and quick response lighting solutions for numerous indoor and outdoor lighting applications.

Industrially constructed mobile carts support both metal halide, LED lighting lamp options and can easily navigate the work site.

Cart mounted units can be operated via simple 115V single-phase hard-point electrical connections, or can be operated off selected portable generators.

Who Uses Cart Lighting?

General contractors, Law enforcement and security, residential and commercial operators, municipalities, government agencies, first response organizations, public works departments, rescue, and special events organizations.

Where Are Light Carts Needed?

Highway and industrial construction sites, emergency response, flaggers, general construction, agricultural, security, law enforcement check-points, film studios, and special events.



GBX8B

Let's Talk Cart Lighting.

1. Lighting Options – Conventional metal halide bulbs up to 1000W and energy efficient LED lamps up to 1200W are available. Multiple projection and diffused balloon bag models.

2. Durability – Industrial mobile carts zinc-plated to resist corrosion. Additionally, the carts have easily deployable outriggers to handle wind and terrain challenges.

3. Quick Deployment – Units are transported and positioned quickly for both indoor and outdoor applications. The models set-up in seconds to provide immediate job site illumination.

Learn more! Download MQ Lighting Solutions specifications at multiquip.com

DID YOU KNOW?

GloBugs that offer diffused lighting characteristics accommodate most DOT requirements to mitigate Glare.



GENERATORS & WELDERS



**MQ Power Generators
Welders**



MQ POWER GENERATORS



Trade Names

DCA - WhisperWatt - MQ Power

MQ Power generators are available in wide range of sizes to meet virtually any application. Their performance and quiet operating characteristics these generators to deliver reliable power under the most demanding conditions.

Who Uses Generators?

General construction, special events, plant shutdowns, military, emergency response, agriculture, studio and entertainment, oil and gas exploration, back up and temporary power, concrete and asphalt batch plants

When Do You Recommend A Diesel Generator?

Long-term rentals for construction and industrial applications. Short-term such as festivals, concerts and sporting events.

What Is The Required Voltage And Phase?

Generator solutions are available for single or three-phase applications and a variety of voltage settings.

What Else May The Customer Need?

Air conditioning and heating, submersible pumps, cable & power distribution, lighting

DCA36SPXU4F

Let's Talk MQ Power Generators.

1. Selection - Single-phase units from 6kW to 36kW; Single/Three-phase models from 6kVA to 600kVA

2. Voltage regulation - Superior regulation $\pm 0.5\%$ on all models*

3. The original WhisperWatt - legendary sound attenuation ideal for work on industrial or residential jobs.

4. Digital control panel and analog instrumentation protect generator and engine and provides critical operating data.

5. Fluid Containment is available on selected models to prevent environmental spills.

**excludes DA7/DAC7-series models*

Learn more! Download MQ Power Solutions specifications at multiquip.com

DID YOU KNOW?

Generators equipped with our exclusive PowerBalance helps your customers by monitoring loads and prevent unwanted shutdowns and wet stacking.



WELDERS



Trade Names

Stinger - WhisperWeld - Welder-Generator

How do Welders Work?

Welders utilize electricity - AC & DC Current - to liquefy base metals so that they can be bonded together. In most all welding practices, some type of filler material is used to fill the gap which becomes stronger than the material being welded.

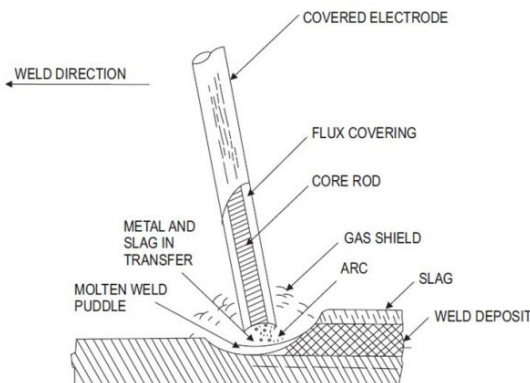

Who Uses Welders?

General Contractors, Steel outfitters, ship yards, oil & gas pipelines, mining, fence companies, ornamental design. When do you recommend a welder? General repair, structural work, MQ's Engine driven welders also serve the need for jobsite AC power.

What Else May The Customer Need?

Users may require welding leads, rod or wire, grinders, clamps, metal cutting equipment. Safety equipment including gloves, welding helmet, respiratory devices

Let's Talk Welders.

- 1. Selection** - Choose models with DC welding output from 135 amps to 500 amps; with up to 14kW AC output
- 2. Alternator** - 100% copper windings for optimum conductivity
- 3. Engine** - Choose from reliable Honda gasoline and Kubota Diesel engines.
- 4. Voltage Regulation** - Maintained as low as $\pm 1.5\%$ to produce the cleanest sinewave in the market.
- 5. Contractor Grade Features** - Dual weld capability, CC/CV output, Economy mode & wire remote options.
- 6. Cabinets** provide security, protection from the elements, sound attenuation and can be trailer mounted.

Learn more! Download information about the full range of MultiQuip Welders at multiquip.com

DID YOU KNOW?

Selected MQ welders feature fuel saving Smart Stick technology that shuts down the engine during periods of no load and allow restart with a tap of the welding rod.

