



Service Bulletin

AR14H Vibratory Ride-On Roller

Water Pump Protective Rubber Flap

Product Group: Roller	Date Issued: 08/09/16	Service Bulletin No. RR20160804
Bulletin Type <input type="checkbox"/> Mandatory <input type="checkbox"/> Information Only <input checked="" type="checkbox"/> Recommended Change	Models/Series Affected: AR14H S/N 160700 — AND BELOW	

Details
Problems: a. Water is entering the compartment where the water pump is located. This condition can cause the electrical motor inside the pump and associated wiring to short out. Solutions: a. Install a protective rubber flap to protect the water pump from water.

Parts Information										
<table><tr><th>Item No.</th><th>Part No.</th><th>Description</th><th>QTY.</th><th>Remarks</th></tr><tr><td>1</td><td>805812</td><td>Rubber Flap</td><td>1</td><td></td></tr></table>	Item No.	Part No.	Description	QTY.	Remarks	1	805812	Rubber Flap	1	
Item No.	Part No.	Description	QTY.	Remarks						
1	805812	Rubber Flap	1							

WORK SAFELY!

Only a **qualified service technician** with proper training should perform this installation. Follow all shop safety rules when performing this installation.

REQUIRED TOOLS

- Ratchet and Socket Set
- 3/16" Allen Wrench or 3/16" Socket

WATER PUMP RUBBER FLAP PROTECTOR INSTALLATION PROCEDURE

1. Release the latch (Figure 1A) that secures the floor panel to the frame.
2. Next, remove the battery (Figure 1B) from the roller and set aside in a safe place. Remove the **negative** battery cable first.
3. Using a 3/16" allen wrench remove the two 1/4" X 1" 20 allen head screws (Figure 1C) and associated hardware that secure the water pump to the frame.
4. Place the sloted sections (Figure 1D) on the protective rubber flap over the pump mounting holes.
5. Reinstall the pump mounting ears (Figure 1D) on top of the protective rubber flap and secure with hardware that was removed in step 3.
6. Fold the protective rubber flap over the pump to protect it from water (Figure 1E).
7. Reinstall the battery. Connect the **positive** battery cable first.
8. Reinstall floor panel and secure with locking latch.

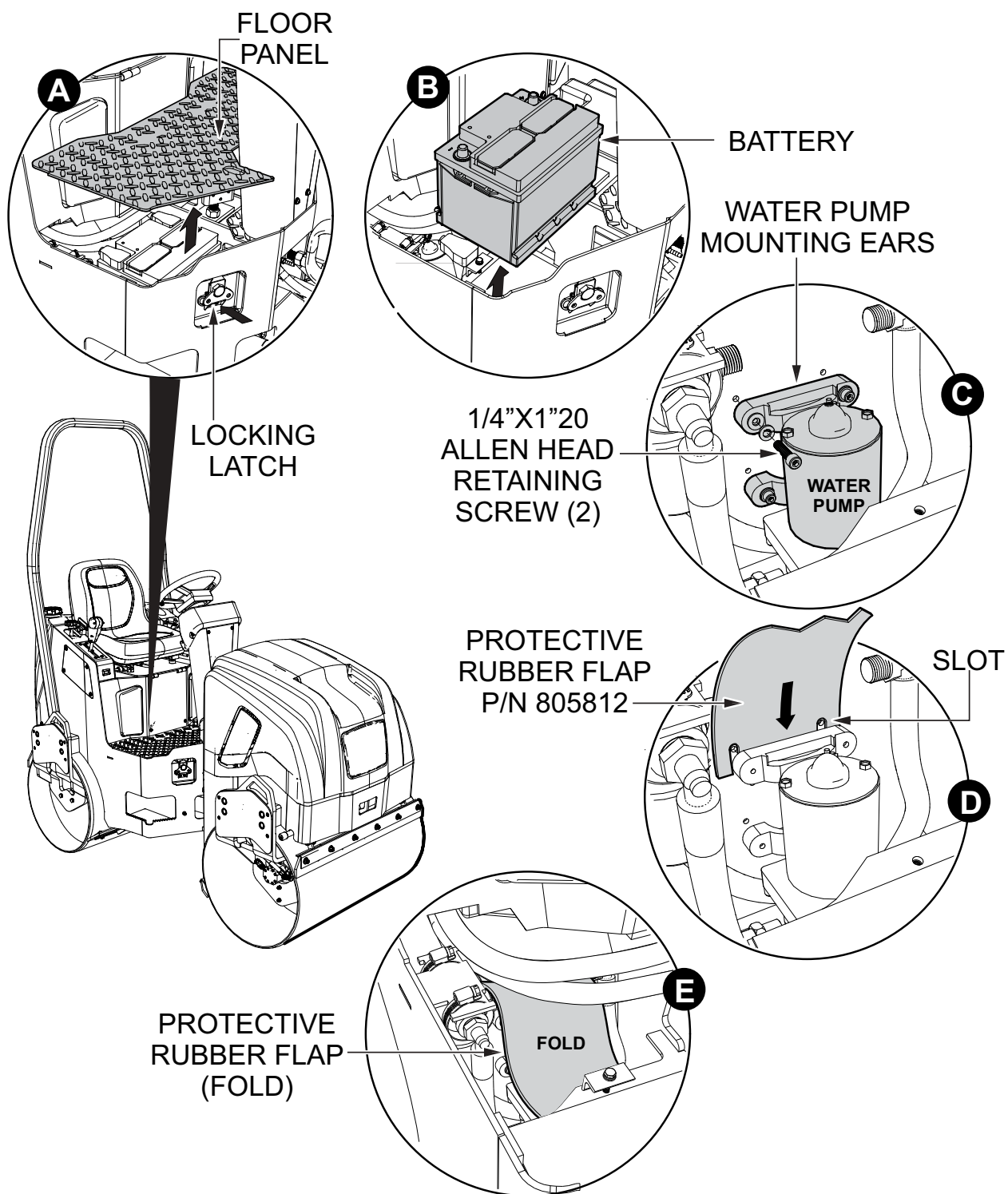

Figure 1. Water Pump Rubber Flap Protector Installation



Service Bulletin

AR14H Vibratory Ride-On Roller

Water Pump Protective Rubber Flap

HERE'S HOW TO GET HELP

PLEASE HAVE THE MODEL AND SERIAL
NUMBER ON-HAND WHEN CALLING

UNITED STATES

Multiquip Corporate Office

18910 Wilmington Ave. Tel. (800) 421-1244
Carson, CA 90746 Fax (310) 537-3927
Contact: mq@multiquip.com

Service Department

800-421-1244 Fax: 310-537-4259
310-537-3700

Technical Assistance

800-478-1244 Fax: 310-943-2238

MQ Parts Department

800-427-1244 Fax: 800-672-7877
310-537-3700 Fax: 310-637-3284

Warranty Department

800-421-1244 Fax: 310-943-2249
310-537-3700

CANADA

Multiquip

4110 Industriel Boul. Tel: (450) 625-2244
Laval, Quebec, Canada H7L 6V3 Tel: (877) 963-4411
Contact: infocanda@multiquip.com Fax: (450) 625-8664

UNITED KINGDOM

Multiquip (UK) Limited Head Office

Unit 2, Northpoint Industrial Estate, Tel: 0161 339 2223
Globe Lane, Fax: 0161 339 3226
Dukinfield, Cheshire SK16 4UJ
Contact: sales@multiquip.co.uk

© COPYRIGHT 2016, MULTIQUIP INC.

Multiquip Inc and the MQ logo are registered trademarks of Multiquip Inc. and may not be used, reproduced, or altered without written permission. All other trademarks are the property of their respective owners and used with permission.

The information and specifications included in this publication were in effect at the time of approval for printing. Illustrations, descriptions, references and technical data contained in this document are for guidance only and may not be considered as binding. Multiquip Inc. reserves the right to discontinue or change specifications, design or the information published in this publication at any time without notice and without incurring any obligations.

Your Local Dealer is:

