

## UNCONTROLLABLE DC AMPERAGE WHILE WELDING ON SIDE-A

Some DLW400ESA4 may have an uncalibrated IC control board (part # D5266200024B) that may experience uncontrollable DC amperage while operating only on side-A.

How to correct uncontrollable DC amperage (see image 1):

1. Turn the key switch to the "RUN" position. (Engine start not necessary).
2. Adjust the **WELDING REGULATION** (Side A) to "CONSTANT CURRENT".
3. Change dip switch # 4 to "ON" position for 6 seconds (see image 2).
4. Change dip switch # 4 back to "OFF" position.
5. Turn the key switch to the "STOP" position.

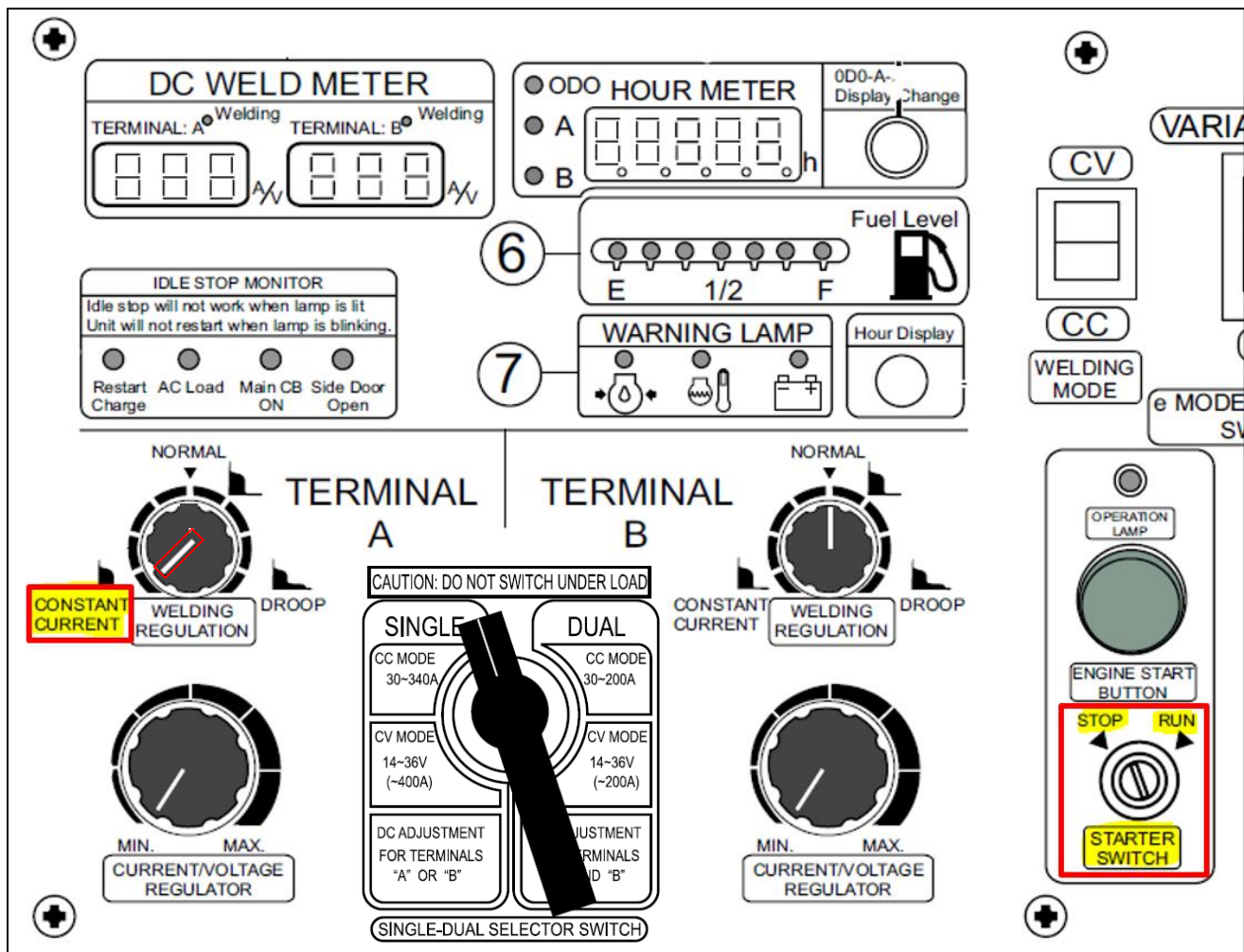

Control Panel  
 Image 1



Dip Switch # 4  
Image 2



IC Control Board  
Image 3