



JS36H55 Walk-Behind Trowel

Engine Mounting Instructions

The following instructions are intended to assist the user with the mounting of the Honda engine onto the trowel base.

REQUIRED TOOLS

- Ratchet/Socket Set
- Wire Cutters
- Pliers
- 1/8" Allen Wrench
- 1/2" Open End Wrench
- Phillips Head Screwdriver
- Blue Loctite™ #246

PARTS

Verify that all parts are accounted for. See Figure 1 and Table 1.

WORK SAFELY!

Only a **qualified service technician** with proper training should perform this installation. Follow all shop safety rules when performing this installation.

Table 1. Engine Mounting Parts				
Item	Part No.	Description	Qty.	Remarks
1	1386	Engine, Honda GX160UT2QX2	1	
2	1834	Deflector, Honda 5 HP Exhaust	1	
3	1273	Screw, HHST 8-32 X 3/8	2	
4	21915	Spacer, Lifting Bale	1	
5	21988	Lifting Bale Assembly	1	
6	12287	Screw, THP 1/4-20 x 3/4 SS	3	
7	21679	Spacer 1" x .78 x .69 L	1	
8	0255	Clutch Assembly, 3/4" Centrifugal	1	
9	1406	End Plug, Clutch	1	
10	21678	Screw, FHSC 5/16-24 x 1-3/4	1	
11	10229	Screw, HHC 5/16-24 X 1"	4	
12	933241	Washer, Flat SAE 5/16 GRD 9 YZ	1	
13	23866	Belt Guard, Friction Clutch	1	
14	0152 3	V-Belt A28	1	
15	0627	Key, 3/16 X 1-1/4	1	
16	21994	Pulley AK59 X 3/4	1	
17	21996	Spacer, 1.00 OD X .328 ID X .438 THK	3	
18	21966	Base Unit	1	
19	1488	Wire, Safety Switch	1	
20	1475	Connector, Splice Tap	1	
21	1662	Tie, Cable Tie Ty-Rap Black	1	
22	20845	Swivel, Assy. Throttle Cable	1	Includes Items With/\$
22A\$	20842	Screw, Pan Head 8-32 X 1/4	1	
22B\$	20844	Housing, Swivel Throttle Cable	1	
22C\$	15173	Washer, Flat, #8	1	
22D\$	20968	Screw, SHC 8-32 X 1/4	1	
23	22024	Screw, HHC 5/16-24 X 1 3/4 GRD. 5 Zinc	4	
24	933241	Washer, Flat SAE 5/16 GRD. 9 YZ	4	
25	0300 B	Washer, Flat SAE 5/16	1	

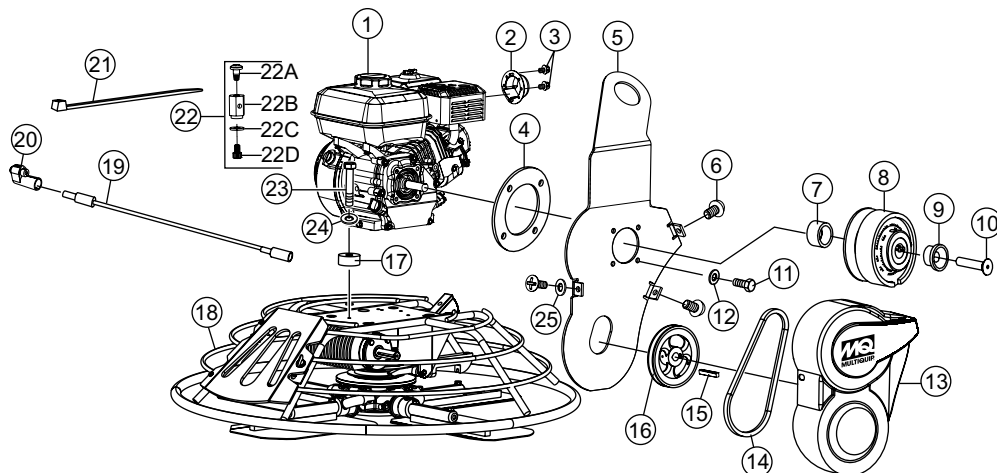

Figure 1. Parts

ENGINE INSTALLATION

Refer to Figure 2.

1. Place and align the four engine spacers P/N 21966 with the engine mounting holes located on the trowel base plate.

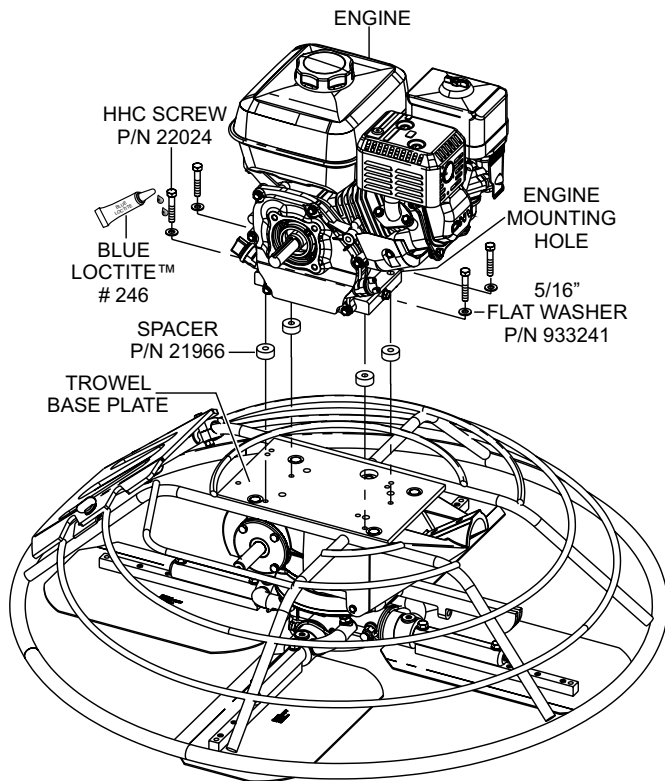

Figure 2. Engine Mounting

2. Next, lift the engine onto the trowel base plate and align the engine mounting holes with the spacers on the trowel base plate.
3. Locate the four 5/16-24 X 1-3/4" engine mounting HHC screws (P/N 22024) and apply Blue Loctite™ 246 (P/N 60097) to each screw.
4. Insert engine mounting screws (4) with a 5/16" washer (P/N 933241) through engine mounting holes and associated spacer.
5. Tighten each of the four engine mounting screws securely.

LIFTING BALE INSTALLATION

Refer to Figure 3.

1. Locate the four 5/16-24 X 1" lifting bale mounting HHC screws (P/N 10229) and apply Blue Loctite™ 246 (P/N 60097) to each screw.
2. Insert lifting bale mounting screw (4) with a 5/16" washer (P/N 933241) through any one of the lifting bale mounting holes.

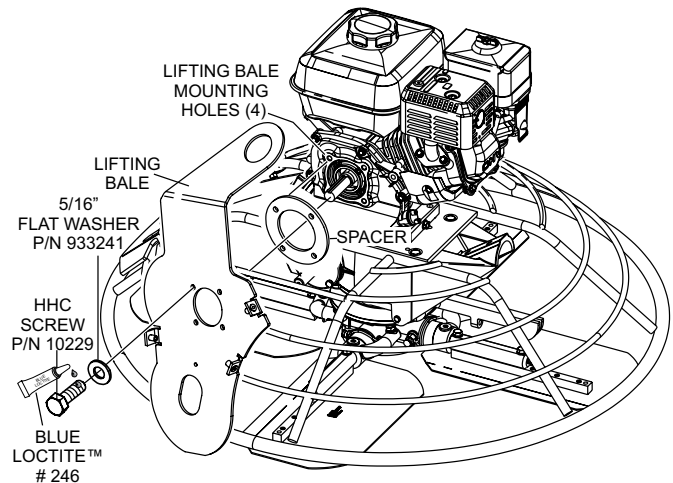

Figure 3. Lifting Bale Installation

3. Next, align any one of the holes on the lifting bale spacer (P/N 21915) with the HHC screw.
4. Repeat this procedure for the remaining 3 lifting bale mounting holes.
5. With all four screws in place carefully align lifting bale and spacer with lifting bale mounting holes on engine.
6. Hand tighten all four screws, then tighten all four screws securely.

CLUTCH INSTALLATION

Refer to Figure 4.

1. Place clutch spacer (P/N 21679) onto engine shaft and slide it all the way back until it touches engine body.

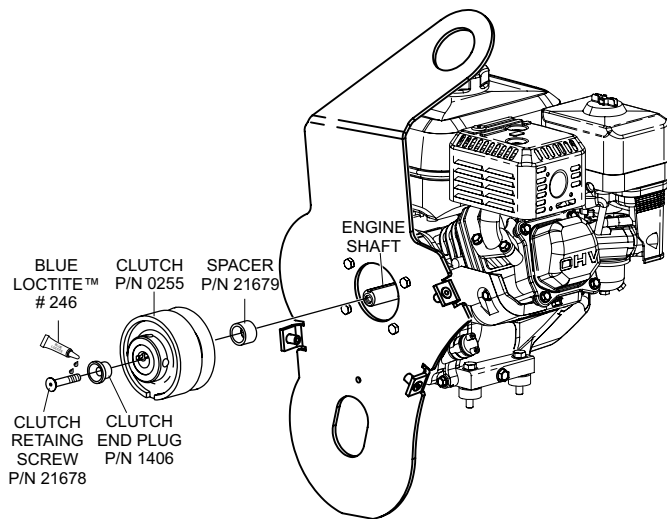

Figure 4. Clutch Installation

2. Next, place clutch (P/N 0255) onto engine shaft and slide it all the way back until it comes in contact with spacer.
3. After clutch has been properly seated onto engine shaft, insert end plug into clutch.
4. Apply Blue Loctite™ 246 (P/N 60097) to the FHSC 5/16-24 X 1-3/4", clutch retaining screw (P/N 21678), then insert screw into engine drive shaft.
5. Tighten clutch retaining screw securely.

GEARBOX PULLEY INSTALLATION

Refer to Figure 5.

1. Insert 3/16 x 1-1/4" key into key way on gearbox drive shaft.
2. Next slide pulley onto gearbox driveshaft.
3. Using a rubber mallet tap the pulley into the approximate position.

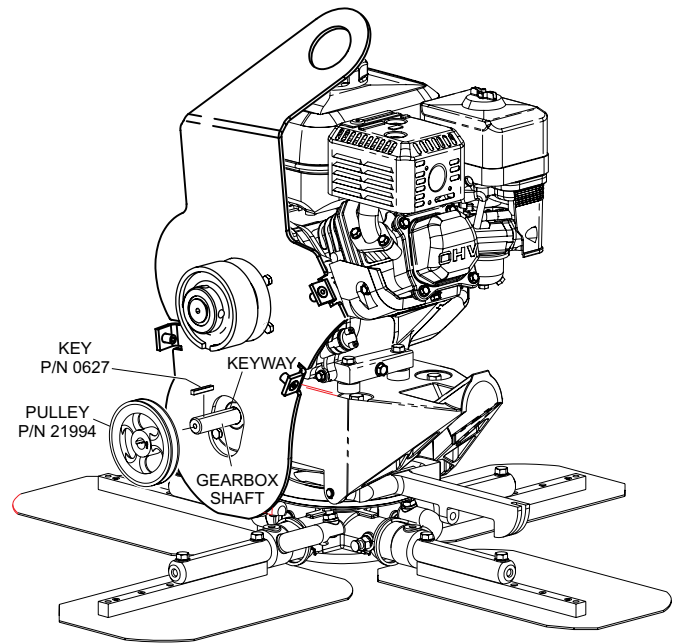

Figure 5. Gearbox Pulley Installation

Pulley Alignment

Refer to Figure 6.

1. Next, using a straight edge ruler align lower pulley with the clutch V-belt grooves. Ruler should be placed on the back side of the pulley.

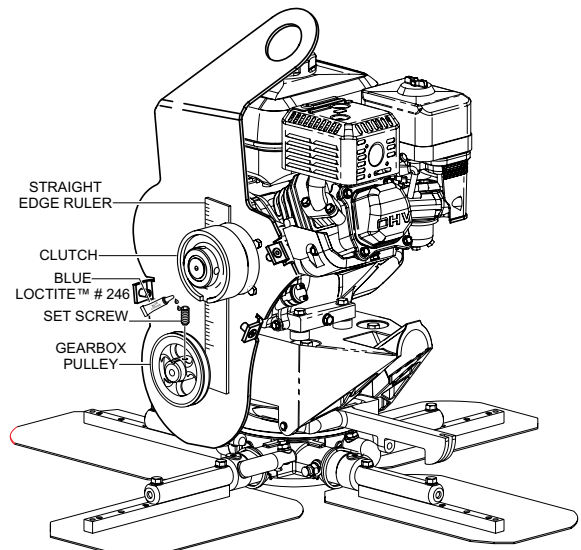

Figure 6. Pulley Alignment

2. Once the clutch and gearbox pulley have been properly aligned secure the gearbox pulley to gearbox shaft by applying Blue Loctite™ 246 to the two supplied set screws.
3. Insert both screws into the pulley hub and tighten each set screw securely.

V-Belt Installation

Refer to Figure 7.

1. Place the V-belt (P/N 0152 3) over the clutch and into the clutch pulley grooves.

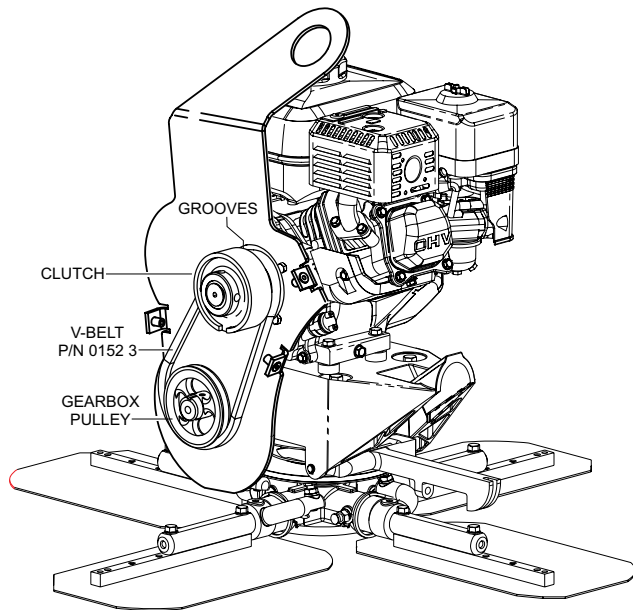

Figure 7. V-Belt Installation

2. Next, walk the V-belt over the gearbox pulley until the V-belt is fully seated.

V-Belt Guard Cover Installation

Refer to Figure 8.

1. Attach V-belt guard cover P/N 23866 to lifting bale P/N 21988 using three 1/4-20 X 3/4 screws P/N 12887. Use 5/16 " flat washer P/N 0300 B on left side of guard cover.

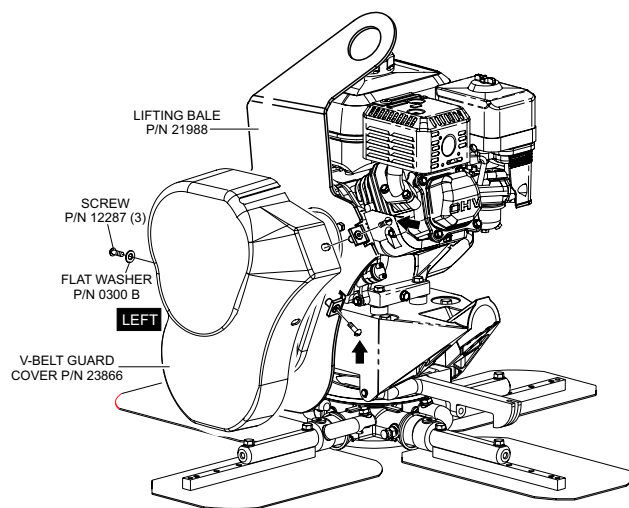

Figure 8. V-Belt Guard Cover Installation

2. Tighten all 3 screws securely.

Exhaust Deflector Installation

Refer to Figure 9.

1. Attach exhaust deflector P/N 1834 to muffler using two 8/32 X 3/8 screws P/N 1273.

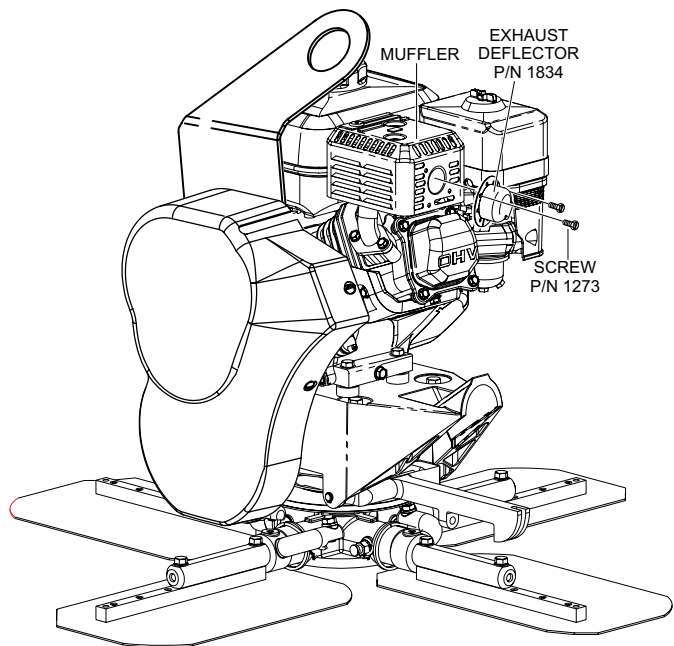

Figure 9. Exhaust Deflector Installation

2. Tighten both screws securely.

Splice Tap Connector Installation

Refer to Figure 10.

1. Locate oil alert unit on engine, it is adjacent to the engine ON/OFF switch.
2. Open the splice tap connector body P/N 1475.

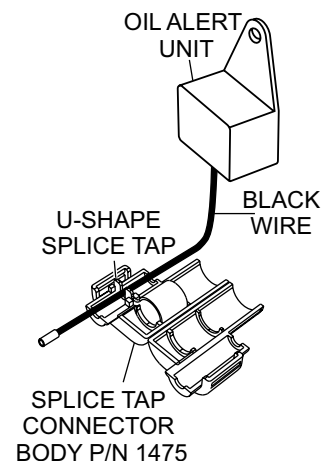

Figure 10. Splice Tap Connector Installation

3. Notice the U-shape splice tap inside the connector body.
4. Next, locate the **BLACK** wire coming from the oil alert unit.
5. With the splice tap connector body open, place the **BLACK** wire from the oil alert unit into the U-shape splice tap. For best results push the wire down until it is fully seated into the connector body.
6. Close the splice tap connector body. To ensure that a good connection has been made, squeeze the connector body with pliers (Figure 11). This will ensure that the **BLACK** wire inside the body has had its insulation removed and is now making contact with the adjacent terminal.

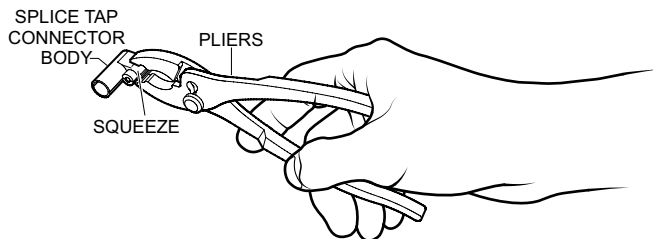

Figure 11. Squeezing Connector Body

Safety Switch Ground Wire Installation

Refer to Figure 12.

1. Locate **BLACK** ground wire (safety switch) P/N 1488 and insert the male end into the splice tap connector body.

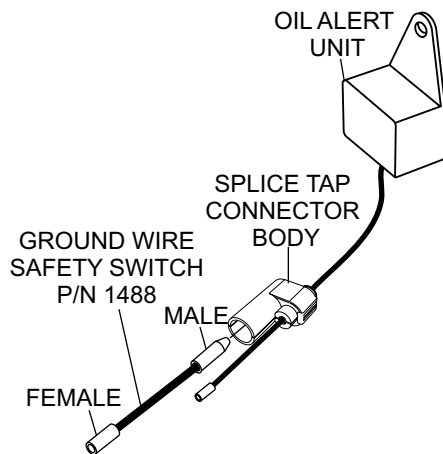

Figure 12. Safety Switch Ground Wire Installation

2. Using cable tie (Figure 13) P/N 1662 secure female end of **BLACK** ground wire (safety switch) P/N 1488 to guard ring.

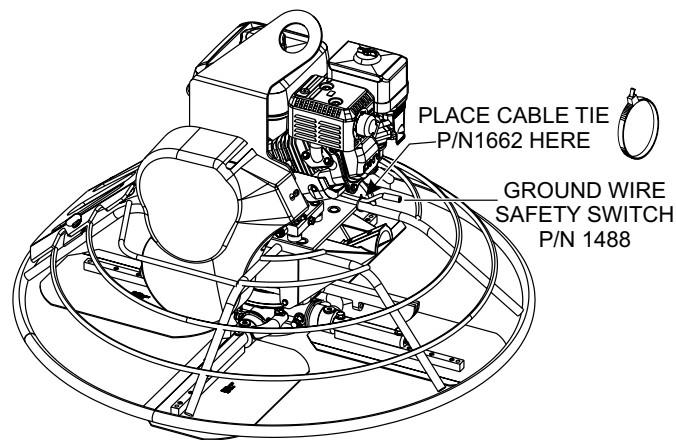

Figure 13. Cable Tie Connection Point

Throttle Swivel Installation

Refer to Figure 14.

1. Insert brass swivel housing P/N 20844 into throttle body hole opening.

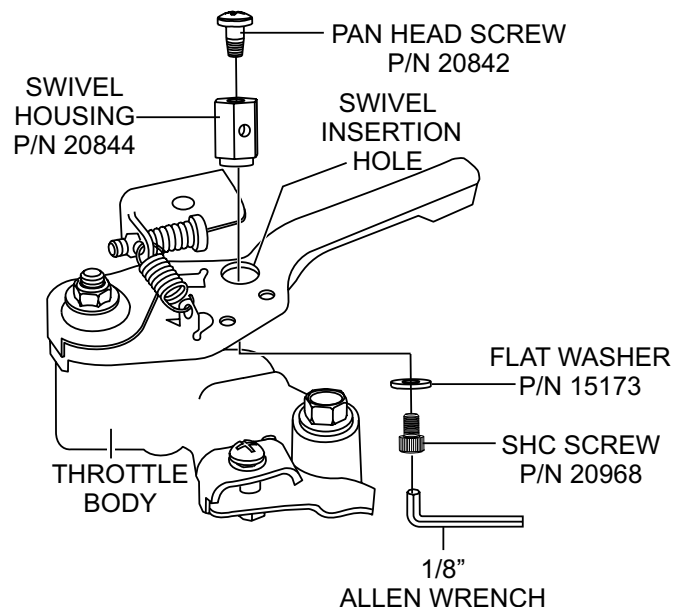

Figure 14. Swivel Housing Installation

2. Insert and hand tighten a 8/32 X 1/4" pan head screw P/N 20842 into the **top** of the brass swivel housing.
3. Next, insert a 8/32 X 1/4" SHC screw P/N 20968 and #8 flat washer P/N 15173 into the **bottom** of the brass swivel housing.
4. Using a 1/8" allen wrench tighten bottom screw securely.

JS36H55 ENGINE MOUNTING INSTRUCTIONS

HERE'S HOW TO GET HELP

PLEASE HAVE THE MODEL AND SERIAL
NUMBER ON-HAND WHEN CALLING

UNITED STATES

Multiquip Corporate Office

18910 Wilmington Ave. Tel. (800) 421-1244
Carson, CA 90746 Fax (310) 537-3927
Contact: mq@multiquip.com

Service Department

800-421-1244 Fax: 310-537-4259
310-537-3700

Technical Assistance

800-478-1244 Fax: 310-943-2238

MQ Parts Department

800-427-1244 Fax: 800-672-7877
310-537-3700 Fax: 310-637-3284

Warranty Department

800-421-1244 Fax: 310-943-2249
310-537-3700

MEXICO

MQ Cipsa

Carr. Fed. Mexico-Puebla KM 126.5 Tel: (52) 222-225-9900
Momoxpan, Cholula, Puebla 72760 Mexico Fax: (52) 222-285-0420
Contact: pmastretta@cipsa.com.mx

CANADA

Multiquip

4110 Industriel Boul. Tel: (450) 625-2244
Laval, Quebec, Canada H7L 6V3 Tel: (877) 963-4411
Contact: jmartin@multiquip.com Fax: (450) 625-8664

UNITED KINGDOM

Multiquip (UK) Limited Head Office

Unit 2, Northpoint Industrial Estate, Tel: 0161 339 2223
Globe Lane, Fax: 0161 339 3226
Dukinfield, Cheshire SK16 4UJ
Contact: sales@multiquip.co.uk

© COPYRIGHT 2013, MULTIQUIP INC.

Multiquip Inc and the MQ logo are registered trademarks of Multiquip Inc. and may not be used, reproduced, or altered without written permission. All other trademarks are the property of their respective owners and used with permission.

The information and specifications included in this publication were in effect at the time of approval for printing. Illustrations, descriptions, references and technical data contained in this document are for guidance only and may not be considered as binding. Multiquip Inc. reserves the right to discontinue or change specifications, design or the information published in this publication at any time without notice and without incurring any obligations.

Your Local Dealer is:

