

Steering Control Linkage

This documentation displays the changes made to the steering control linkage. This change will increase operator comfort by providing smoother steering control. The new rod ends and levers location will eliminate the possibility of the rod ends becoming damaged.

**** Effective date: 10/10/2008 ****

All H-series mechanical ride-on trowels with a starting serial number of YJ0206770 will have this new steering control linkage. This change is applicable to all H-Series mechanical trowels.

For reference this is the old assembly arrangement. Notice the location of the linkage.

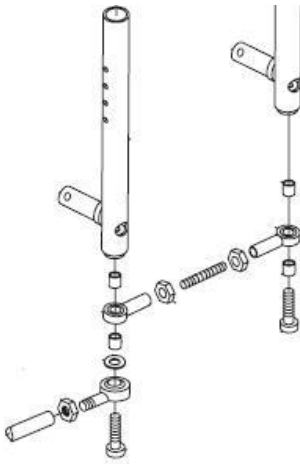

This is the assembly arrangement of current production with the new rod ends, spacer and coupling nut. Notice the location of the linkage

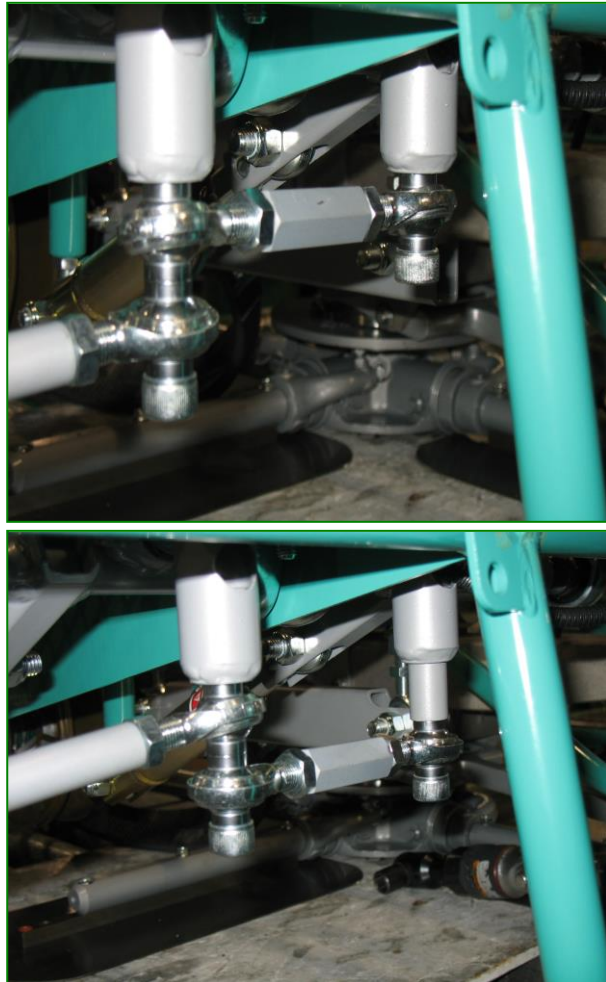

New Assembly

