



TANK VENT CHANGE

It has been noted in some cases the old check valve located on top of the fuel tank was not allowing proper venting and could lead to an over fueling condition of the carburetor and engine.

- MQ Part # 23508 – Old check valve

Replacing the check valve to a 90° elbow fitting is recommended to prevent unwanted tank pressure. In conjunction with the 90° elbow fitting, the grommet should also be replaced to maintain proper sealing.

- [MQ Part # 12007](#) – 90° Elbow fitting
- [MQ Part # 23507](#) – Rubber grommet

Production change beginning with serial numbers below will be equipped with the 90°elbow fitting.

- **Serial #RC0208767** for HHNG5.
- **Serial #RC0208806** for JWN24.

Old style check valve

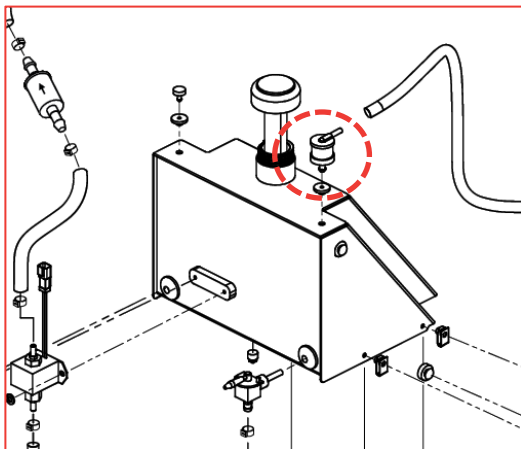

90° elbow fitting

