

GEARBOX MOUNTING HARDWARE PRODUCTION CHANGE

The gearbox mounting hardware has been replaced to improve durability.

This change is effective beginning with serial number: **TJ (OCTOBER 2013)**

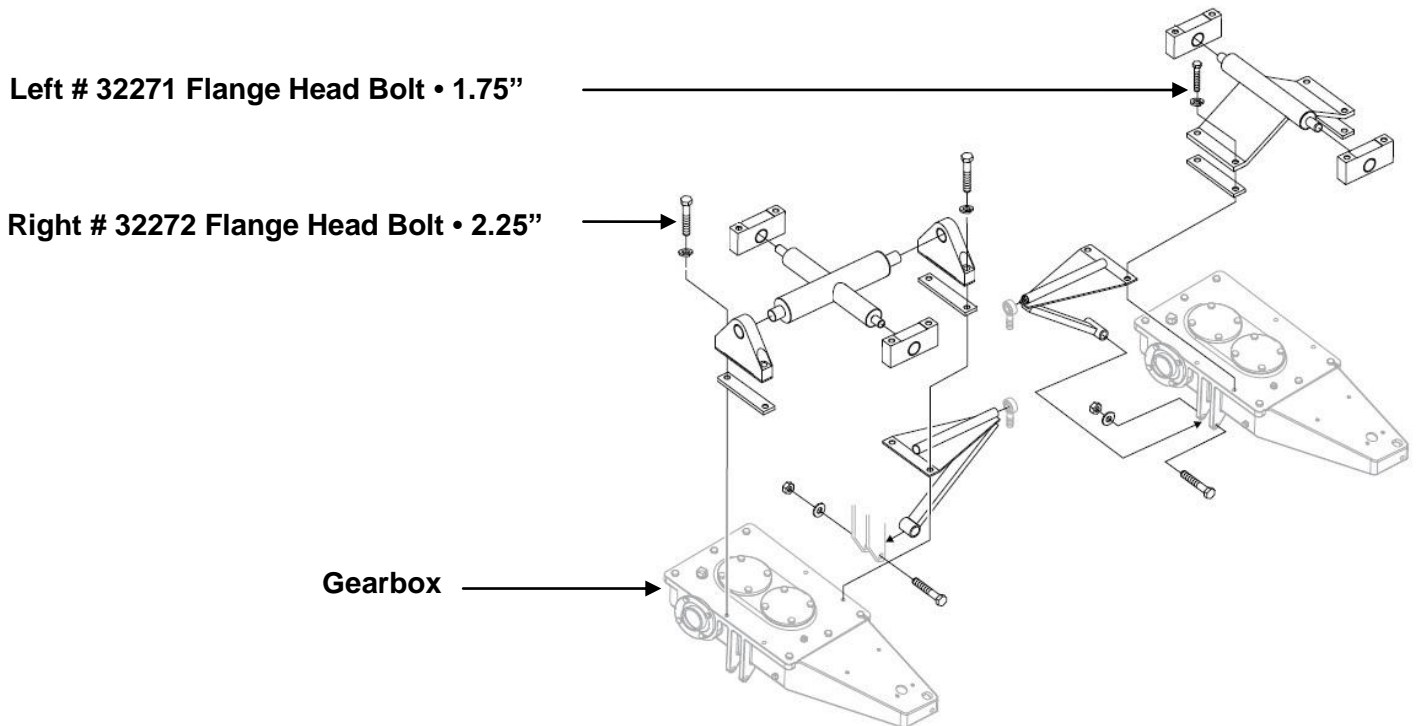

When replacing bolts:

- Dispose old washers and bolts do not reuse. Install Nordlock washers with all new bolts, part #'s below.
- Clean bolt and gearbox threads
- Use red Loctite # 272 on all bolts
- Torque Specification 32.5 ft. lbs.

New hardware MQ part numbers:

Qty	MQ Part #	Size
(4)	32272	Bolt 3/8 - 16 X 2.25" • grade 8
(4)	32271	Bolt 3/8 - 16 X 1.75" • grade 8
(8)	21707	Washer 3/8 Nordlock

