



J-B Walk-Behind Series Trowel

J-B Walk-Behind Trowel Stand Assembly Instructions

The following instructions are intended to assist the user in the assembly of the J-B Walk-Behind Trowel Stand. Please read all assembly instructions before assembling the kit.

REQUIRED TOOLS

- 7/16" Open-Ended Wrench
- 3/32", 5/32" Hex Wrench

PARTS

Verify that all parts are accounted for. See Figure 1 and Table 1.

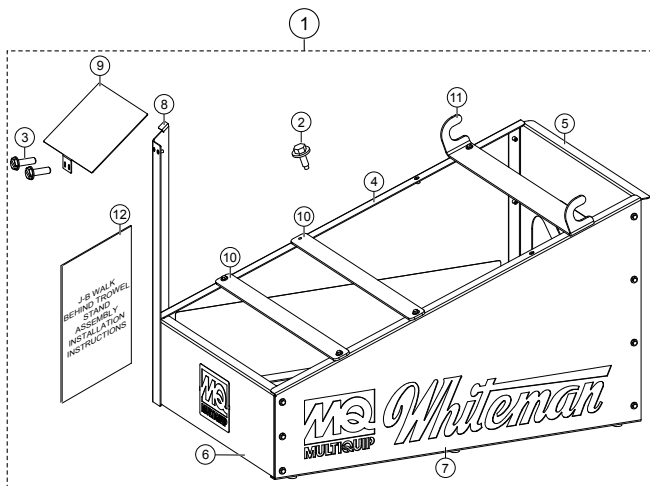

Figure 1. J-B Walk-Behind Trowel Stand Assembly Kit

Table 1. J-B Walk-Behind Trowel Stand Assembly Kit

Item No.	Part No.	Description	QTY.	Remarks
1	TROWELSTAND	Kit, J-B Walk-Behind Trowel Stand Assembly	1	Includes items 2-12
2	30119	Screw, 1/4-20 x 7/8" IND HEX	20	
3	11644	Screw, Hex Washer Slotted, 10-32 x 5/8"	2	
4	32752	Panel, Left, Show Stand	1	
5	32753	Panel, Rear, Show Stand	1	
6	32754	Show Stand, Panel, Front	1	
7	32750	Show Stand, Panel, Right	1	
8	32746	Display Assembly, Post Show Stand	1	
9	32748	Display, Plate	1	
10	32749	Show Stand, Strap	2	
11	32755	Show Stand, Hook	1	
12	32760	Instructions, J-B Walk-Behind Trowel Stand Assembly	1	

WORK SAFELY!

Follow all shop safety rules when performing this installation.

PREPARATION

1. Make sure the work area is clear of any potential hazards.

NOTICE

Hand tighten all screws upon initial installation. Fully tighten after all panels and display post have been assembled.

TROWEL STAND BASE ASSEMBLY

Secure all 1/4-20 x 7/8" screws using a 7/16" open-ended wrench.

1. Secure the left panel (P/N 32752) to the rear panel (P/N 32753) using 1/4-20 x 7/8" screws (4) as shown in Figure 2, (A).
2. Secure the left panel to the front panel (P/N 32754) using a 1/4-20 x 7/8" screw (1) through the center screw hole as shown in Figure 2, (B).
3. Secure the right panel (P/N 32750) to the front and rear panels using 1/4-20 x 7/8" screws (7) as shown in Figure 2, (C).

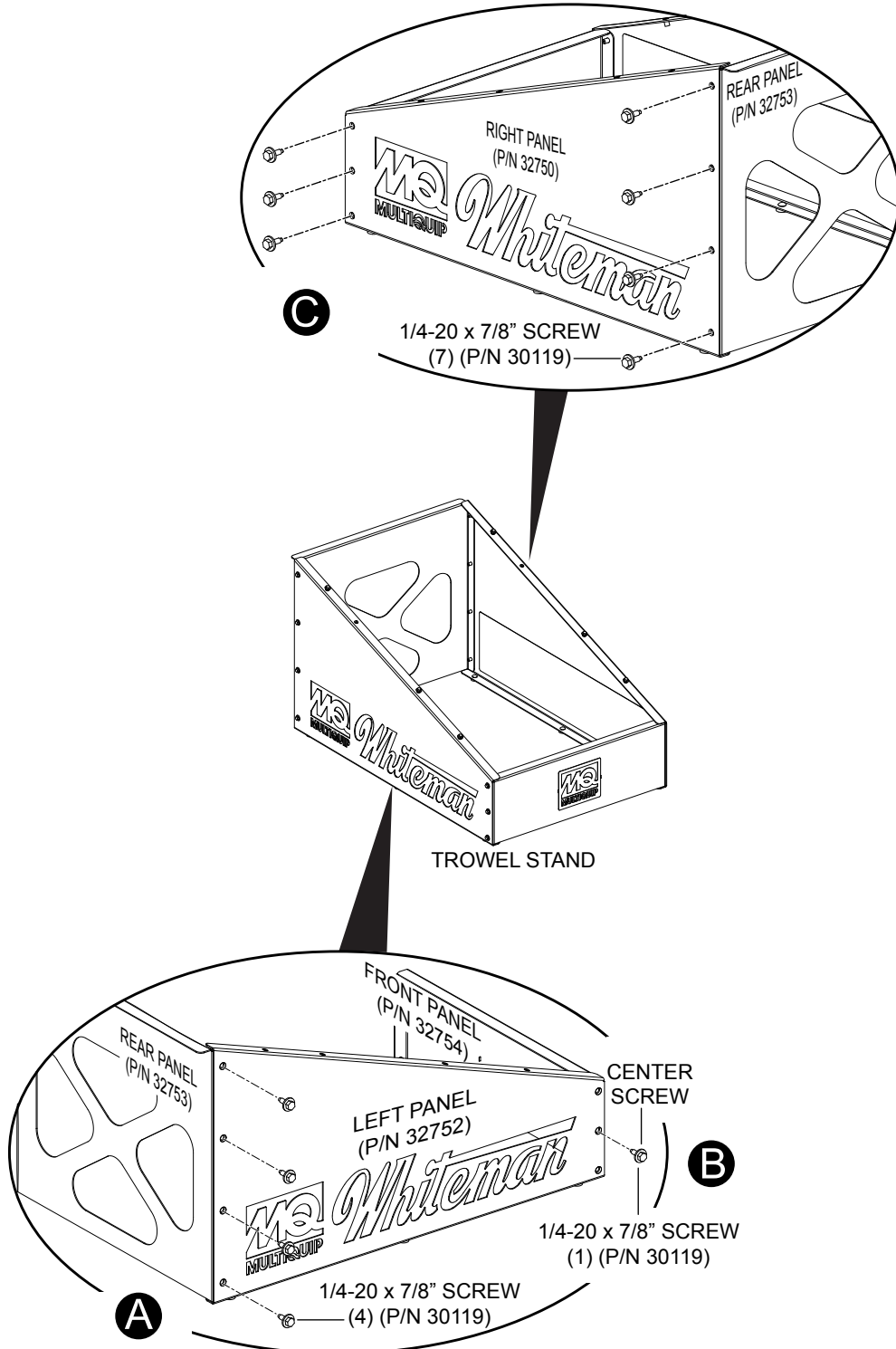

Figure 2. Trowel Stand Base Assembly

TROWEL STAND DISPLAY POST-PLATE ASSEMBLY

Secure all 10-32 x 5/8" screws using a 3/32" or 5/32" hex wrench.

1. Attach the display post (P/N 32746) to the trowel stand as shown in Figure 3 using 1/4-20 x 7/8" screws (2).
2. Attach the display plate (P/N 32748) to the display post as shown in Figure 3 using 10-32 x 5/8" screws (2).

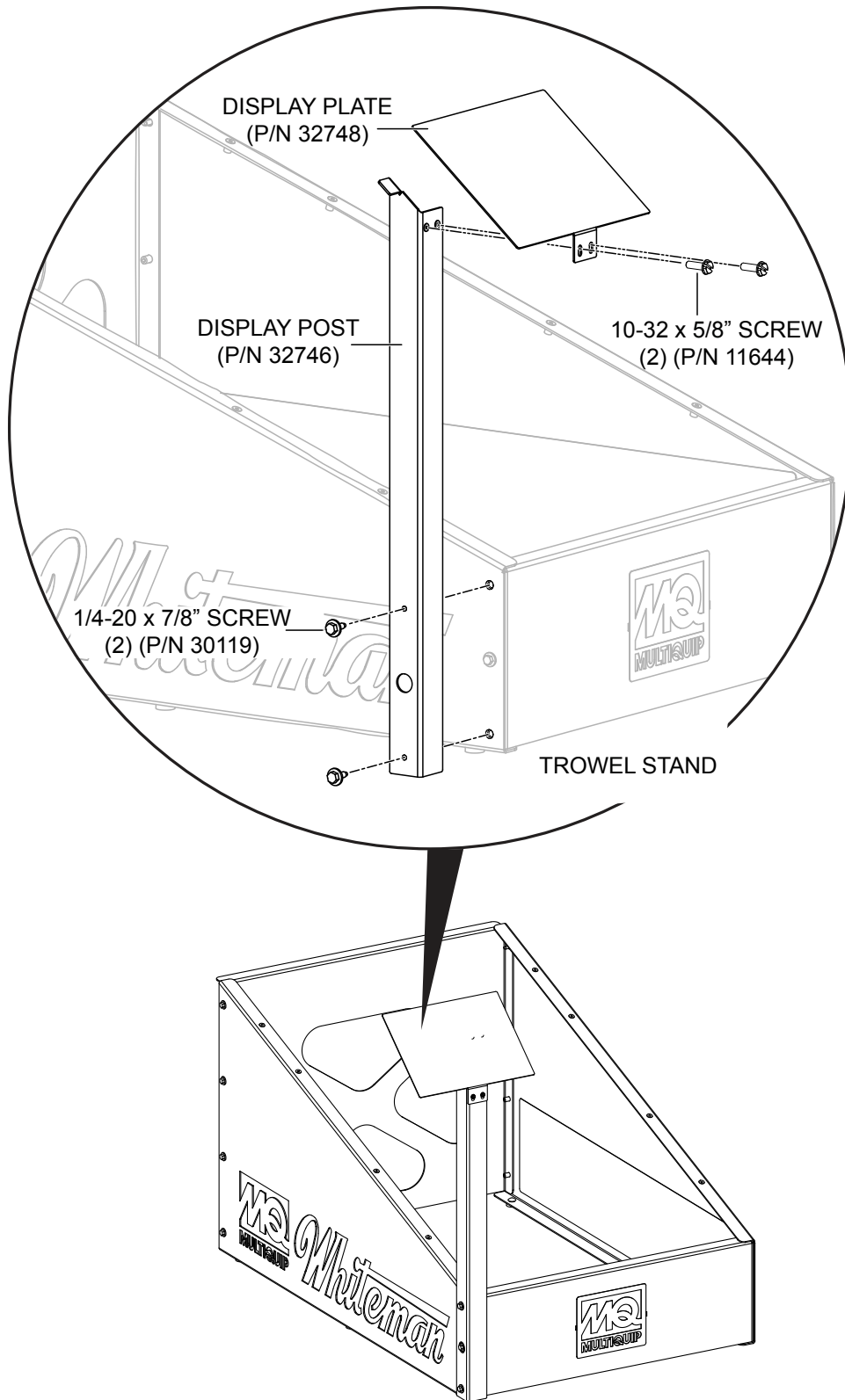

Figure 3. Display Post and Plate Assembly

TROWEL STAND STRAPS AND HOOK ASSEMBLY

1. Secure the two stand straps (P/N 32749) onto the trowel stand using 1/4-20 x 7/8" screws (4) as shown in Figure 4.
2. Secure the stand hook (P/N 32755) onto the trowel stand using 1/4-20 x 7/8" screws (2) as shown in Figure 4. See note below.
3. If desired, use a lifting device to mount the J or B Series Walk-Behind Trowel onto the trowel stand.

NOTE:

1 *B-Series Walk-Behind Trowel Mounting Location.*

2 *J-Series Walk-Behind Trowel Mounting Location.*

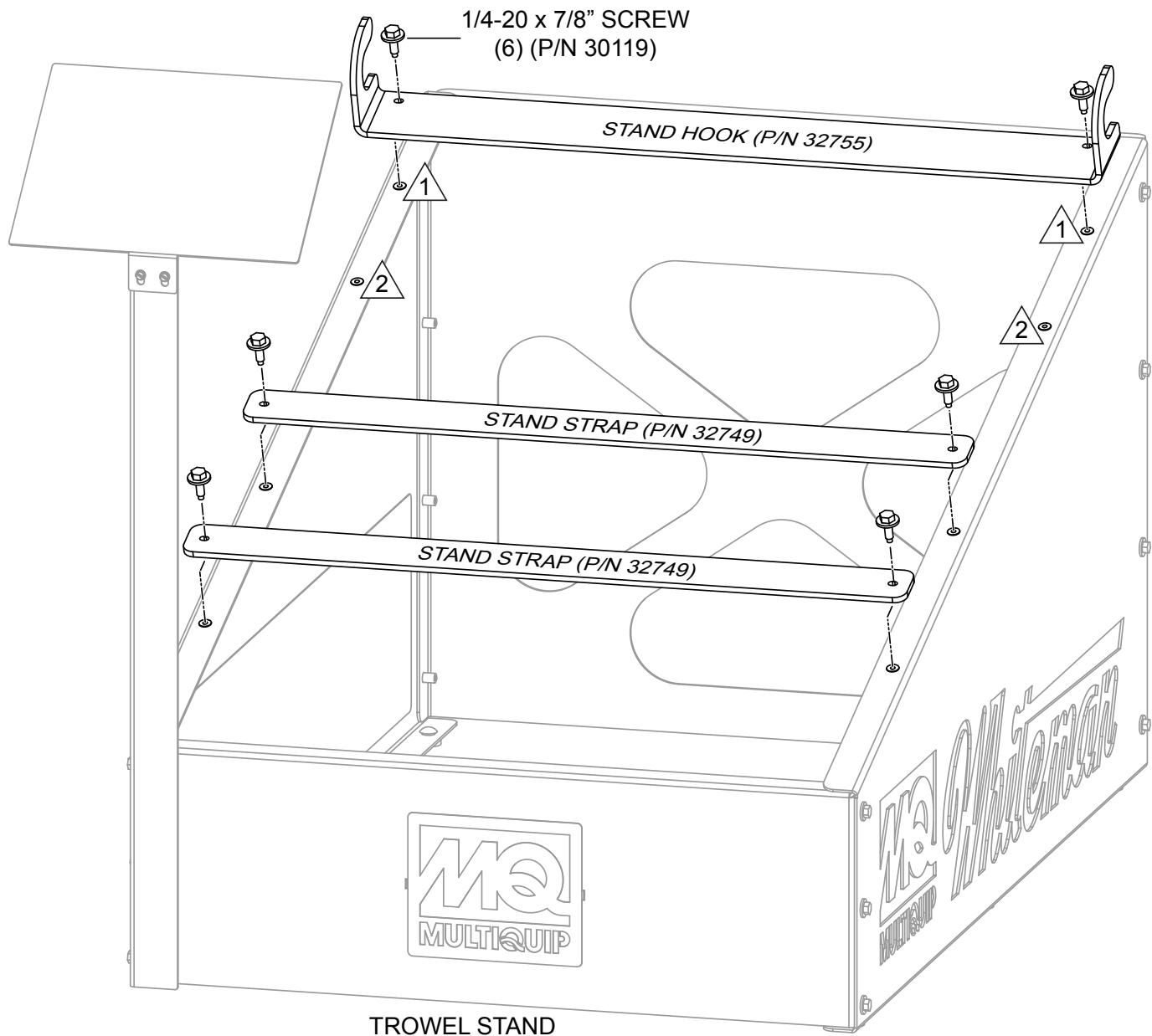

Figure 4. Trowel Stand Hook and Strap Installation



J-B Walk-Behind Series Trowel

J-B Walk-Behind Trowel Stand Assembly Instructions

HERE'S HOW TO GET HELP

PLEASE HAVE THE MODEL AND SERIAL
NUMBER ON-HAND WHEN CALLING

UNITED STATES

Multiquip Corporate Office

18910 Wilmington Ave. Tel. (800) 421-1244
Carson, CA 90746 Fax (310) 537-3927
Contact: mq@multiquip.com

Service Department

800-421-1244 Fax: 310-537-4259
310-537-3700

Technical Assistance

800-478-1244 Fax: 310-943-2238

MQ Parts Department

800-427-1244 Fax: 800-672-7877
310-537-3700 Fax: 310-637-3284

Warranty Department

800-421-1244 Fax: 310-943-2249
310-537-3700

CANADA

Multiquip

4110 Industriel Boul. Tel: (450) 625-2244
Laval, Quebec, Canada H7L 6V3 Tel: (877) 963-4411
Contact: infocanda@multiquip.com Fax: (450) 625-8664

UNITED KINGDOM

Multiquip (UK) Limited Head Office

Unit 2, Northpoint Industrial Estate, Tel: 0161 339 2223
Globe Lane, Fax: 0161 339 3226
Dukinfield, Cheshire SK16 4UJ
Contact: sales@multiquip.co.uk

© COPYRIGHT 2016, MULTIQUIP INC.

Multiquip Inc and the MQ logo are registered trademarks of Multiquip Inc. and may not be used, reproduced, or altered without written permission. All other trademarks are the property of their respective owners and used with permission.

The information and specifications included in this publication were in effect at the time of approval for printing. Illustrations, descriptions, references and technical data contained in this document are for guidance only and may not be considered as binding. Multiquip Inc. reserves the right to discontinue or change specifications, design or the information published in this publication at any time without notice and without incurring any obligations.

Your Local Dealer is:

