



Model LB2000 Lamp Fixture

Installation onto the LT12D, MLT and MLTDA Light Towers

The following instructions are intended to assist the user in the assembly of the LB2000 Lamp Fixture for use on LT12D, MLT and MLTDA Light Towers. Please read all assembly instructions before installing the LB2000.

WORK SAFELY!

Only a **qualified service technician** with proper training should perform this installation. Follow all shop safety rules when performing this installation.

REQUIRED TOOLS

- Ratchet/Socket Set
- Crescent Wrench

PARTS

Figure 1 shows the components of the LB2000 Lamp Fixture. Verify that all parts are accounted for. See Table 1.

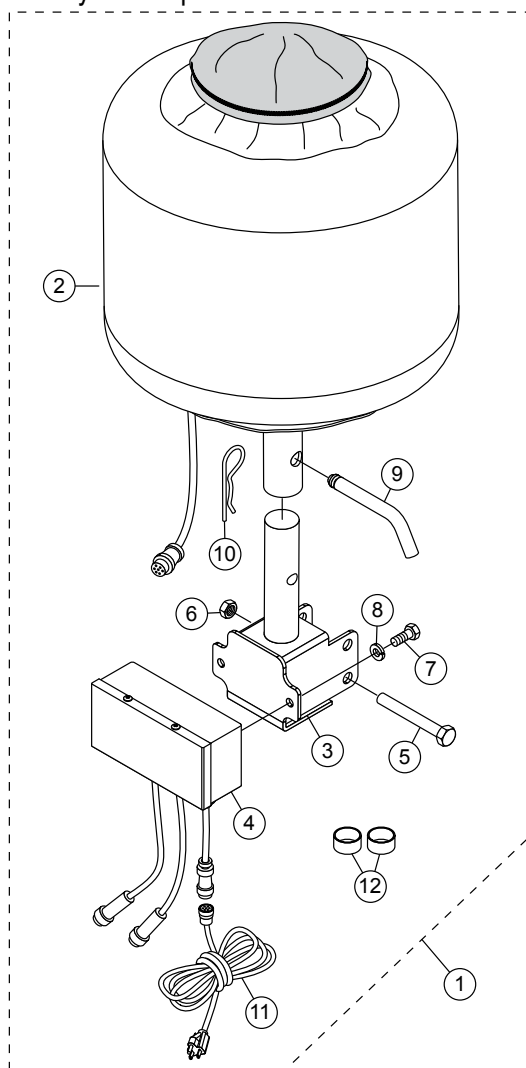

Figure 1. LB2000 Lamp Fixture Components

Table 1. LB2000 Lamp Fixture

Item	Part No.	Description	Qty.	Remarks
1	LB2000	Fixture, Globug, 2000W	1	Includes items 2-12
2		Balloon	1	
3		Bracket	1	
4		Junction Box	1	
5		Screw, HHC1/2-13x3-1/2, Bracket	2	
6		Nut, Nyloc, 1/2-13, Bracket	2	
7		Bolt, 3/8 x 16 x 3/4, Junction Box	2	
8		Lock Washer, 3/8", Junction Box	2	
9		Locking Pin	1	
10		Cotter Pin	1	
11		Quick-Disconnect Power Cable	1	
12		Connector Cap	2	

PREPARATION

1. Place the light tower in an area free of dirt and debris with enough clearance as not to interfere with any overhead obstructions. Make sure it is on secure level ground with chock blocks underneath each wheel to prevent the light tower from rolling.

DANGER

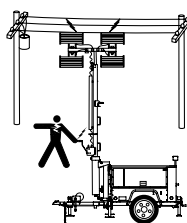

ALWAYS make sure the area above light tower is open and clear of overhead power lines and other obstructions. The tower extends in excess of 30 ft. (9 meters). Contact with overhead power lines or other obstructions could result in equipment damage, serious injury or death!

2. If the light tower is in the deployed position, place the tower mast into the cradle support (stowed position). See Figure 2. Make sure cradle lock/release pin has been inserted and the mast is locked.

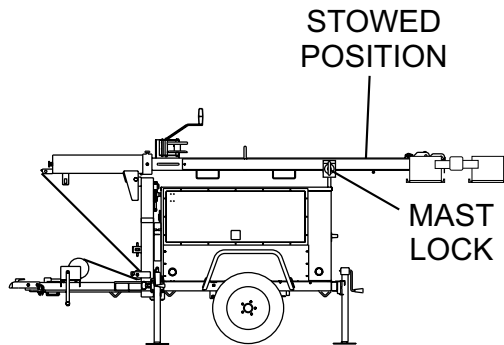

Figure 2. Light Tower in Stowed Position

DISASSEMBLY

1. For LT12D light towers, disconnect the negative cable (black) from battery. See Figure 3. For MLT series light towers, remove power cable from power source.

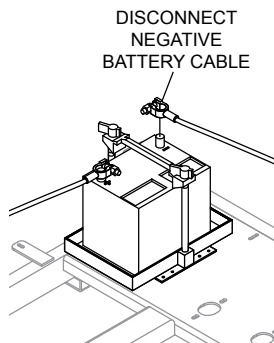

Figure 3. Disconnecting Battery

2. Disconnect the lamp power cables from receptacles J1 to J4 on the T-Bar assembly. See Figure 4.

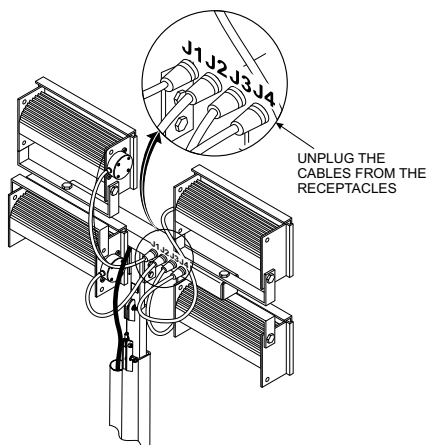

Figure 4. Remove Cables

3. Remove the four lamps from the T-bar by removing the bolts (with washers and nuts) holding each lamp in place. See Figure 5. Keep the removed lamps and the associated hardware together and store in a safe place, making sure that the lamps are properly protected to prevent breakage.
4. Cover receptacles J1 and J2 (innermost) with caps as they will not be used. See Figure 5.

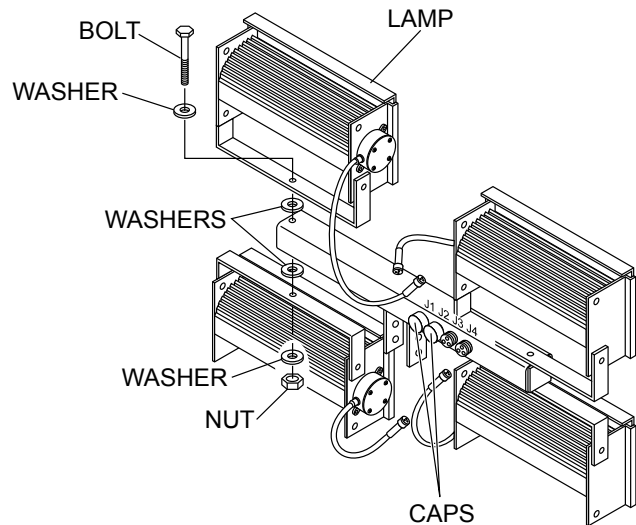

Figure 5. Lamp Removal

ASSEMBLY



CAUTION

Make sure that the T-bar is supported before removing the two screws and nuts to prevent T-bar from falling off.

1. Remove the screws and nuts at the T-Bar and mast assembly interface. Set them aside as they will not be used in the installation. See Figure 6.

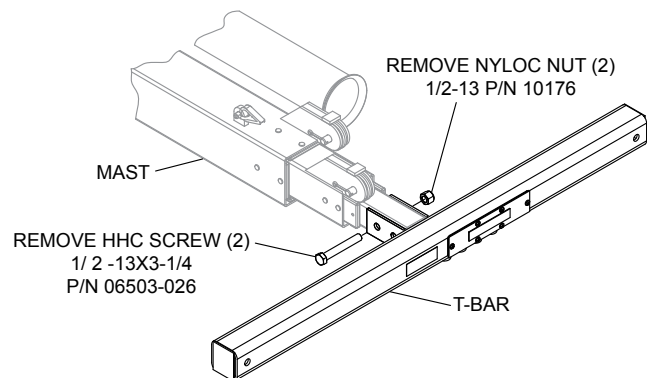

Figure 6. Removing Screws and Nuts

2. Install the bracket to the T-bar and mast interface with the new screws and nuts provided. See Figure 7.

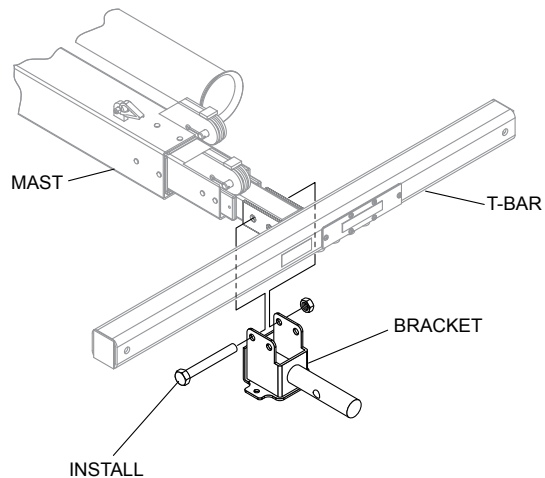

Figure 7. Installing Bracket

3. Attach junction box to the bracket with the bolts and washers provided. See Figure 8.

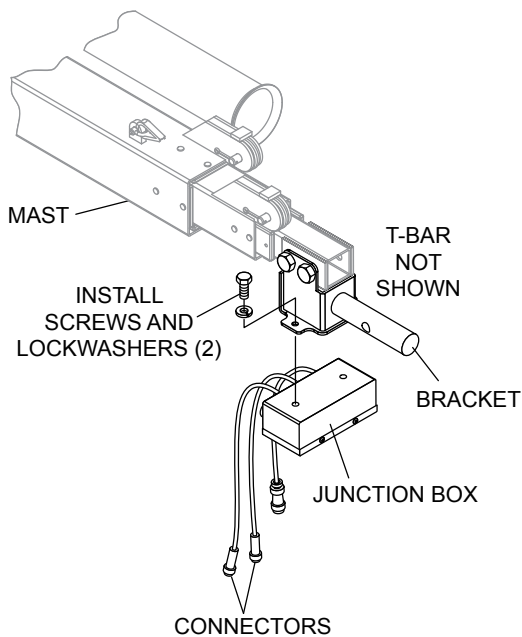

Figure 8. Junction Box Installation

4. Connect the LB2000 lamp fixture to the bracket. Lock the lamp fixture in place with the cotter pin. See Figure 9.

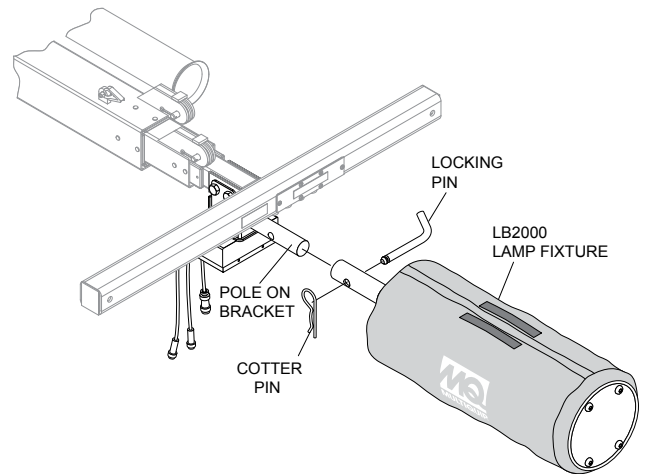

Figure 9. Installing LB2000 Lamp Fixture

5. Unscrew the cap from the lamp power connector on the junction box. Connect the power cord from the LB2000 lamp fixture to the junction box as shown in Figure 10.

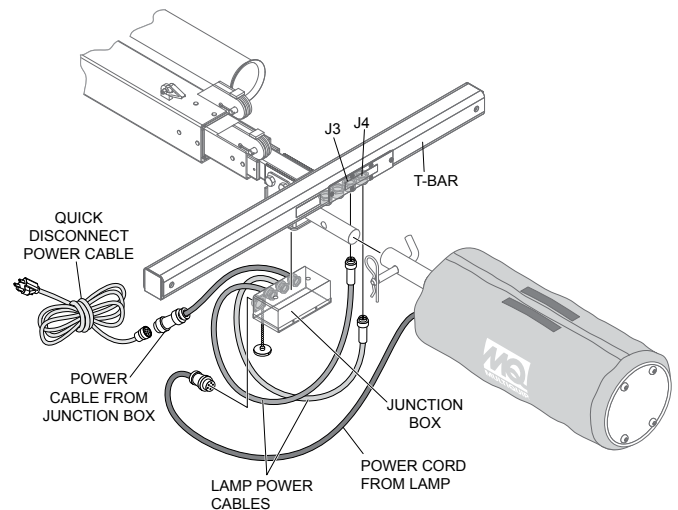

Figure 10. Junction Box Connections

6. Connect the lamp power cables from the junction box to the T-Bar connectors (J3 and J4) as shown in Figure 10.

REMOVING BALLOON PROTECTIVE COVER

CAUTION



DO NOT use excessive force when zipping or unzipping the balloon. The possibility exists of the zipper tearing, which would make the balloon unusable.

1. Expose the balloon by unsnapping the buttons and unzipping the protective cover as shown in Figure 11.

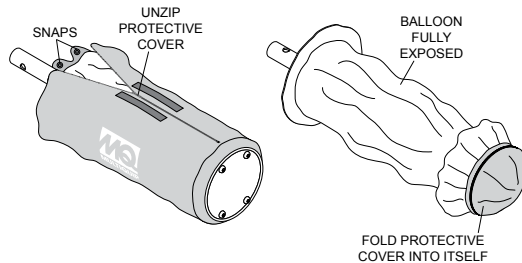

Figure 11. Removing Protective Cover

2. Next, fold the protective cover into itself and zip. See Figure 11.

INFLATING BALLOON AND TURNING ON LAMP

1. On LT12D light towers, reconnect negative battery cable (black). On MLT series light towers, reconnect power cord to power source.
2. Insert the quick-disconnect connector end of the power cable into the junction box. See Figure 10.
3. Slightly raise the light tower mast to allow clearance for the balloon to inflate.
4. Turn on the generator.
5. Plug the power cable into the GFCI receptacle on the generator as shown in Figure 12. Place the GFCI and main circuit breaker switches on the control panel in the ON position. See Figure 13. The balloon should begin to inflate.

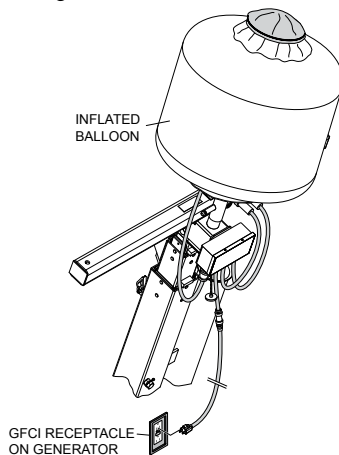

Figure 12. Applying Power to the Balloon

6. Turn on the two switches on the light tower that correspond to the lamp connectors on the T-bar (J3 and J4). See Figure 13. Confirm that the two lamps on the balloon turn on. Procedure will vary slightly for the MLT series light towers.

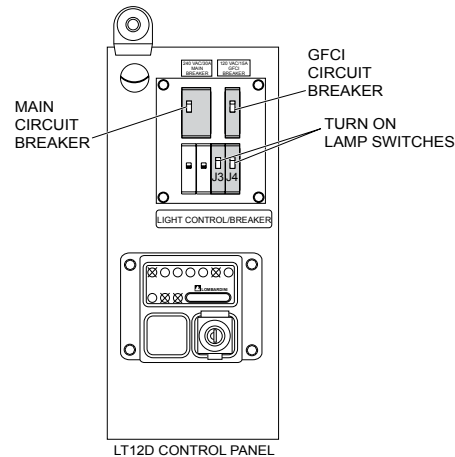

Figure 13. Lamp Switches (LT12D Only)

7. If the light tower is to be used, raise the mast to the upright position.

DEFLATING AND STORING BALLOON

1. Turn lamps OFF and allow to cool for at least five minutes. See Figure 13.
2. Once the lamps have cooled, place the GFCI and main breaker switches in the OFF position.

NOTICE

ALWAYS make sure lamps are turned off and allowed to cool before deflating balloon to avoid any damage to the balloon. **NEVER** transport LB2000 lamp fixture while attached to mast.

3. Unplug power cord from the GFCI receptacle on the generator.
4. When the balloon is completely deflated, unzip the protective cover and fold the balloon inside the cover.
5. Carefully zip up the cover and snap the buttons to fully close the protective cover.
6. Remove all cables from T-Bar, and remove balloon power cable from junction box.
7. Pull cotter pin from locking pin and remove lamp assembly from light tower mast.
8. Store lamp assembly in a safe place where it will not get damaged.



MULTIQUIP INC.

POST OFFICE BOX 6254 • CARSON, CA 90749
310-537-3700 • 800-421-1244 • FAX: 310-537-3927
E-MAIL: mq@multiquip.com • www.multiquip.com