



LD60 Ride-On Trowel

Foot Pedal Kit Installation

The following instructions are intended to assist the user with the installation of the Foot Pedal Kit on a Multiquip model LD60 Ride-On Trowel. It is not intended to take the place of the Operation manual shipped with the trowel. Refer to the Operation manual for safety, operation, and maintenance information. Please read all assembly instructions before installing the kit.

REQUIRED TOOLS

- 7/8" wrench
- 20 mm wrench
- 13 mm wrench or socket
- 10 mm wrench or socket

PARTS

Verify that all parts are accounted for. See Table 1 and Figure 1.

Table 1. LD60 Foot Pedal Kit Components				
Item No.	Part No.	Description	Qty.	Remarks
1	48231	Kit, Foot Pedal, LD6	1	Includes items 2-5
2	52248	Instructions, Foot Pedal Kit, LD6	1	
3	48232	Harness, Foot Pedal, LD6	1	
4	48233	Jumper, Foot Pedal, LD6	1	
5	43144	Pedal, Foot	1	

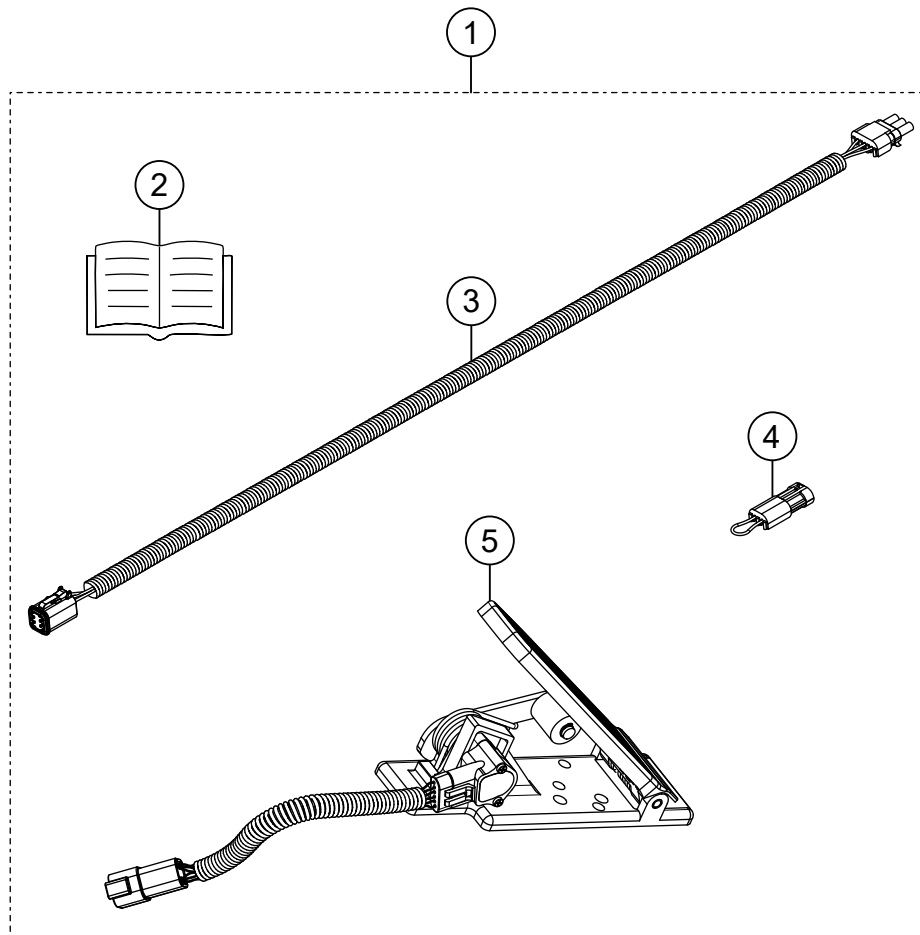

Figure 1. LD60 Foot Pedal Kit Components

WORK SAFELY!

Only a **qualified service technician** with proper training should perform this installation. Follow all shop safety rules when performing this installation.

PREPARATION

1. Place the trowel on secure, level ground in an area that is free of dirt and debris.
2. Make sure the trowel is turned **OFF** and the engine is cool.
3. Disconnect the negative (**BLACK**) battery cable from the negative (-) battery terminal.

FOOT SWITCH REMOVAL

1. Reach underneath the **front platform** (Figure 2) and disconnect **main harness connector P21** from the **foot switch**.

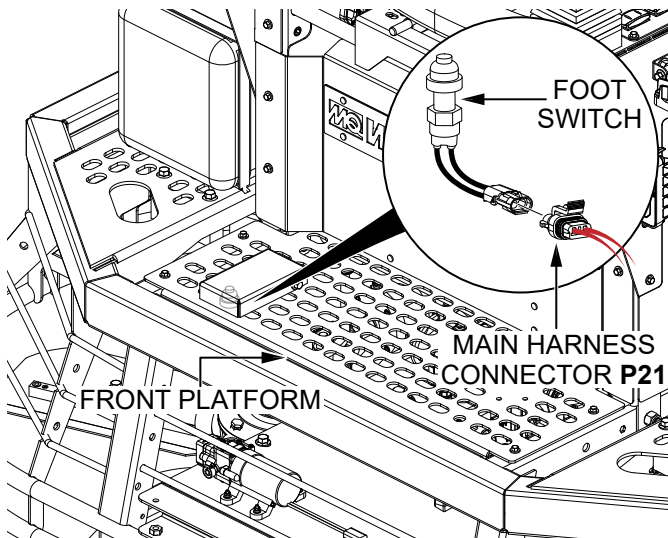

Figure 2. Disconnect Foot Switch

2. Connect the **foot pedal jumper (P/N 48233)** to **main harness connector P21**. See Figure 3.

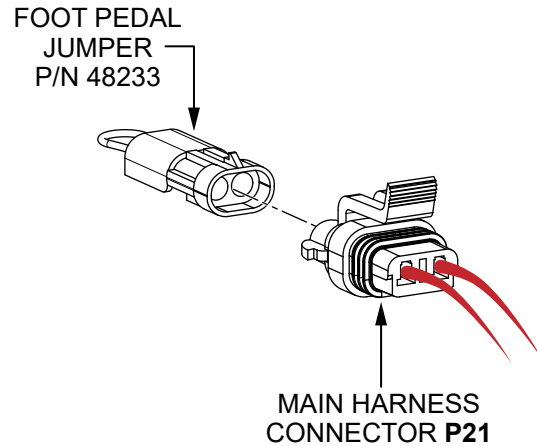

Figure 3. Connect Foot Pedal Jumper To Main Harness

3. Remove the **M8 hex flange screw** (Figure 4) and **M8 nyloc nut** securing the **foot switch protector** to the front platform, then remove the foot switch protector.

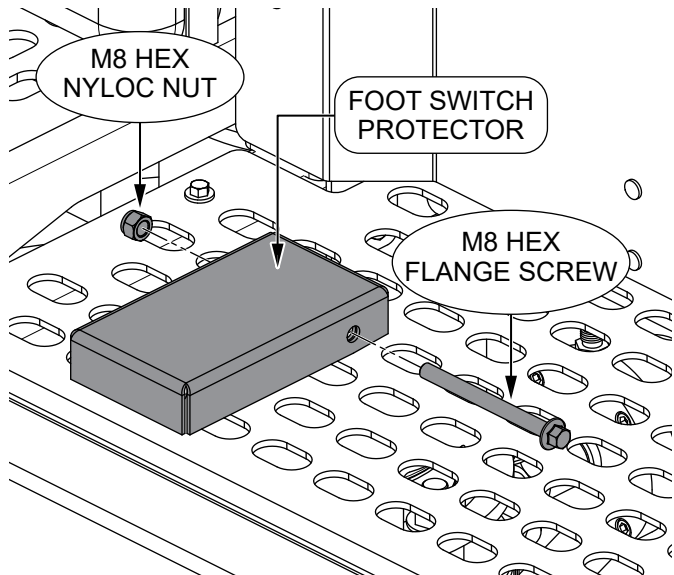

Figure 4. Remove Foot Switch Protector

4. Using a 20 mm wrench and a 7/8-inch wrench, disassemble and remove the **foot switch** (Figure 5) from the front platform.

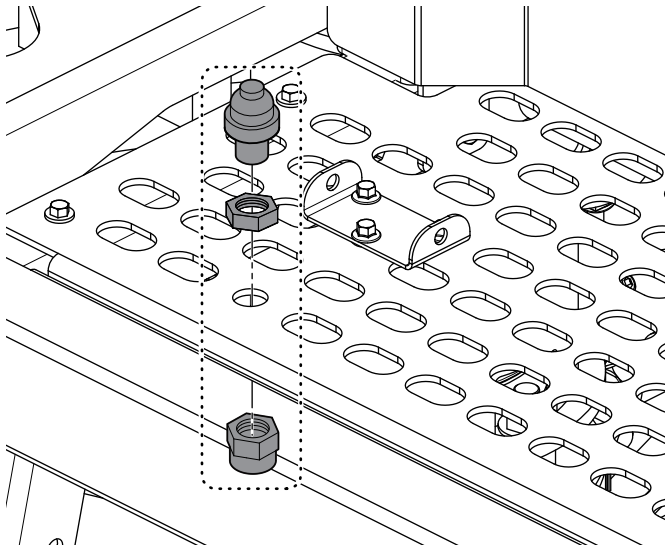

Figure 5. Remove Foot Switch

5. Remove the **three M6 hex flange screws** (Figure 6) and **three M6 hex flange nuts** securing the **switch protector mount** to the front platform, and remove the switch protector mount. Save the screws and nuts to reuse later in the procedure.

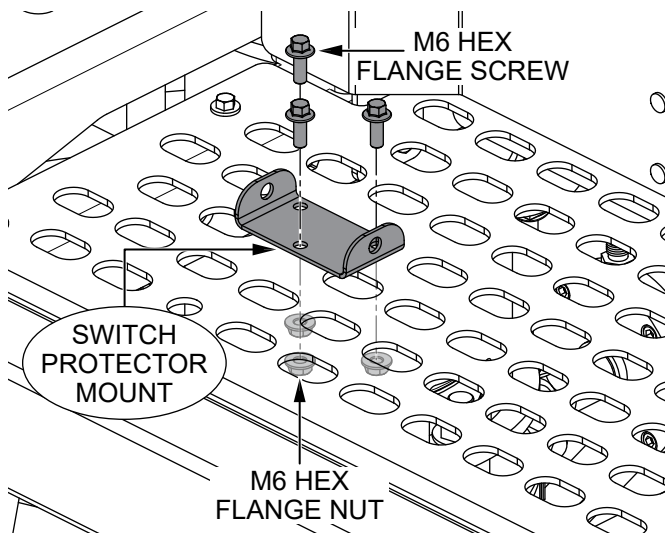

Figure 6. Remove Switch Protector Mount

FOOT PEDAL INSTALLATION

1. Reach underneath the **right-hand steering box** (Figure 7) and disconnect **main harness connector P18** from the **rotor speed control lever**.

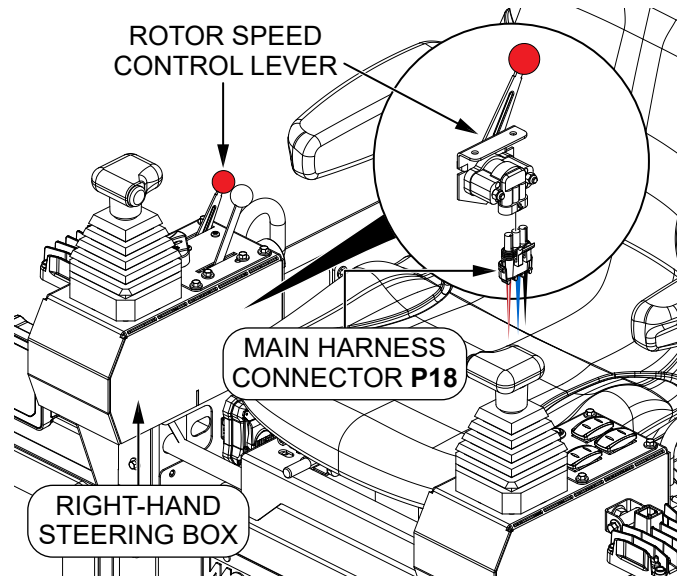

Figure 7. Disconnect Speed Lever

2. Connect **main harness connector P18** to **connector J1** on the **foot pedal harness (P/N 48232)**.

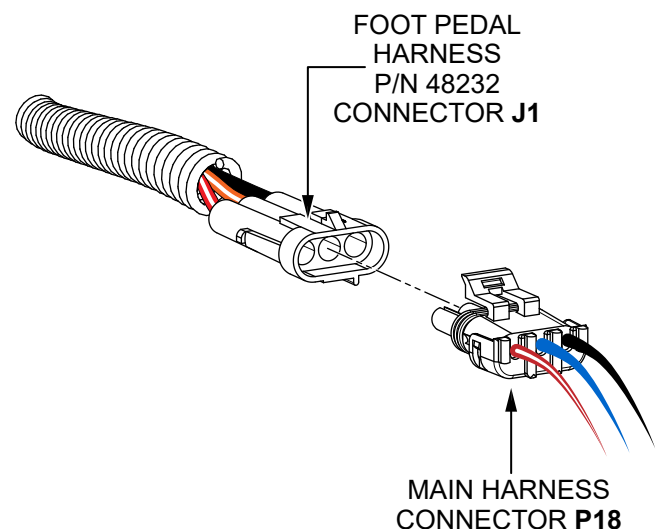

Figure 8. Connect Foot Pedal Harness To Main Harness

3. Use two **M6 hex flange screws** and two **M6 hex flange nuts** that were removed earlier to secure the **foot pedal (P/N 43144)** to the front platform. See Figure 9.

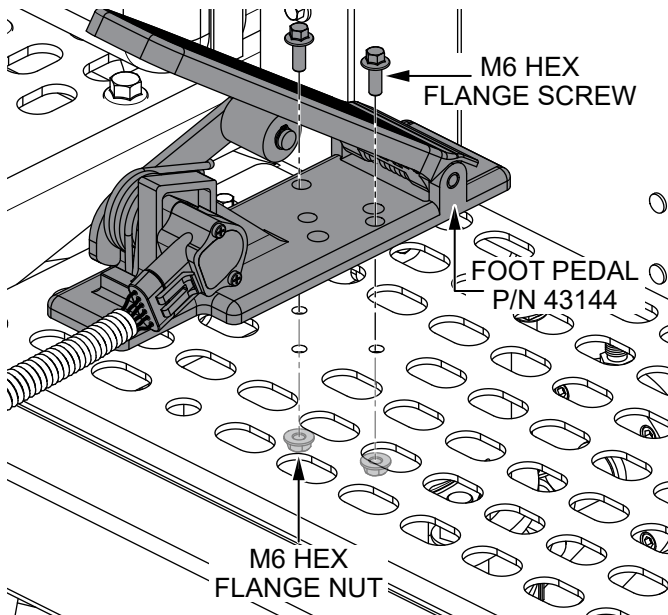

Figure 9. Install Foot Pedal

4. Connect the foot pedal wiring connector to **connector P1** on the **foot pedal harness (P/N 48232)**. See Figure 10.

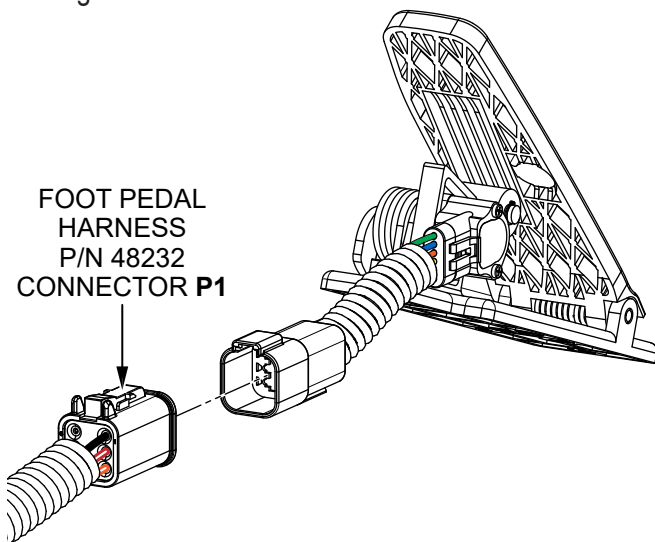

Figure 10. Connect Foot Pedal Harness To Foot Pedal

FOOT PEDAL OPERATION

The rotor speed control lever is no longer functional. Rotor speed is now controlled by the foot pedal. The position of the foot pedal determines the rotational speed of the rotors. Slow rotor speed is obtained by slightly depressing the foot pedal. Maximum rotor speed is obtained by fully depressing the foot pedal.

HERE'S HOW TO GET HELP

UNITED STATES

Multiquip Inc.
(310) 537- 3700
E-mail: mq@multiquip.com

CANADA

Multiquip
(450) 625-2244
E-mail: infocanada@multiquip.com

UNITED KINGDOM

Multiquip (UK) Limited Head Office
0161 339 2223
E-mail: sales@multiquip.co.uk

