



# Service Bulletin

## LT6KV Light Tower

<b>Product Group:</b> Light Tower	<b>Date Issued:</b> 11/29/16	<b>Service Bulletin No.</b> LT20161103
<b>Bulletin Type</b>  <input checked="" type="checkbox"/> Mandatory <input type="checkbox"/> Information Only <input type="checkbox"/> Recommended Change		<b>Models/Series Affected:</b>  LT6KV S/N 40934 — 41918

### Details

#### Problem:

- Multiquip has determined the Class II ball coupler on the LT6KV may, in some applications, be subjected to side loads that exceed its rated capacity. In some rare instances, the light tower may be subject to **tip over** during slow speed turns.

#### Solution:\*

- Replace the Class II ball coupler with a Class IV rated ball coupler.
- Increasing the wall thickness of the tow bar assembly to 1/4" for structural rigidity.

### Parts Information

Table 1. LT6KV Tow Bar Kit Parts				
Item No.	Part No.	Description	QTY.	Remarks
1	44210-SK	Kit, Tongue Assy., LT6KV	1	Includes Items 2-6
2	915319	Screw, HHC 5/8"-11 X 4	1	
3	9503	Nut, Nyloc 5/8"-11	1	
4		Tow Bar with Coupler	1	
5	1662	Black Tie Wrap, 11 in.	3	
6	44414	Tow Bar Kit Instructions, LT6KV	1	

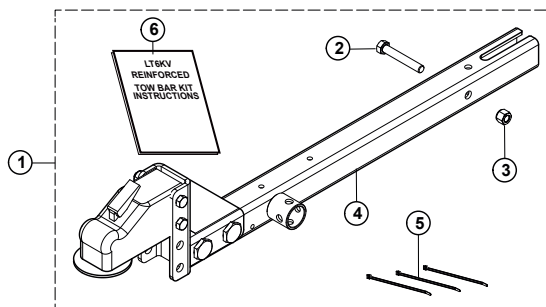

Figure 1. Kit, Tongue Assy., LT6KV

## WORK SAFELY!

Only a **qualified service technician** with proper training should perform this installation. Follow all shop safety rules when performing this installation.

## PREPARATION

1. Place the LT6KV Light Tower in an area free of dirt and debris. Make sure it is on secure level ground with chock blocks underneath each wheel to prevent the light tower from rolling.

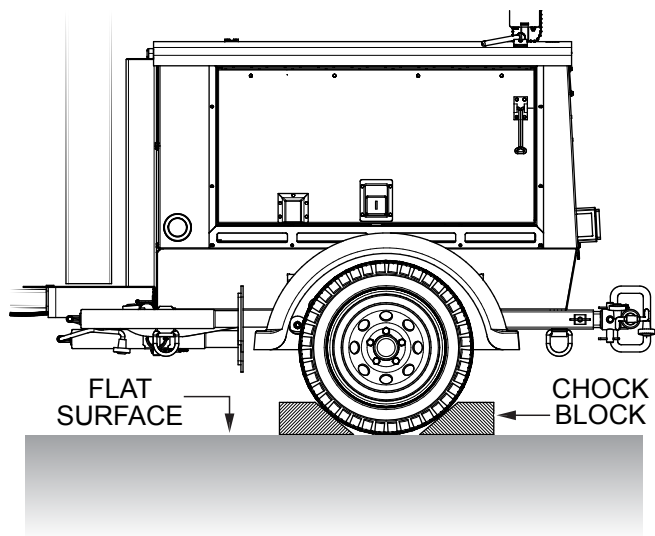

**Figure 2. Chock Tires**

2. Make sure the unit is turned **OFF**.
3. Check that **all** parts are accounted for before attempting this installation procedure. Reference Table 1 and Figure 1.

## REQUIRED TOOLS

- Ratchet Set
- Open-End Wrench Set

## PROCEDURE

The following instructions will guide you through the **removal** of the existing tow bar assembly and the installation of the **replacement** tow bar assembly.

## DEPLOYING OUTRIGGERS

1. Deploy the left and right side outrigger jack stands to support the front-end (tow side) of the light tower. See Figure 3.

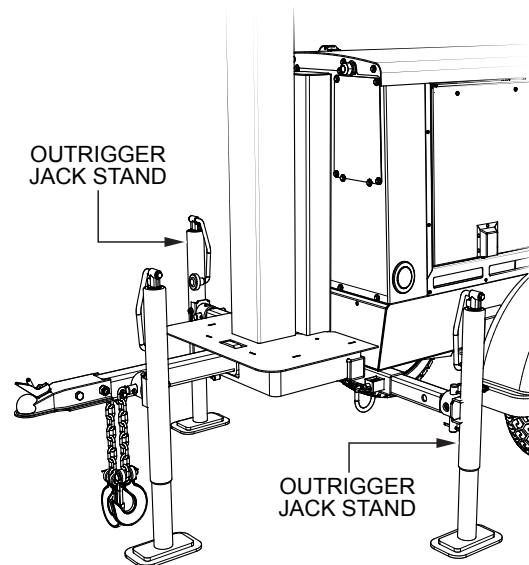

**Figure 3. Outrigger Deployment**

2. Once the tow end of the light tower has been supported by the left and right outrigger jack stands, remove the **cotter pin** from the locking pin hole as shown in Figure 4.

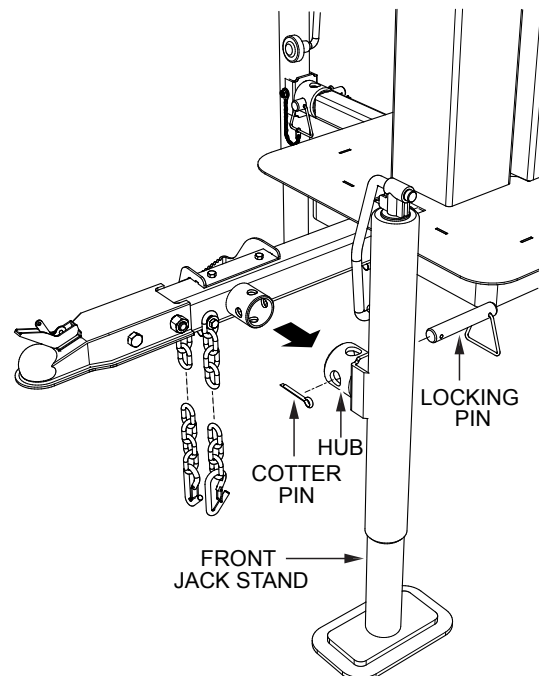
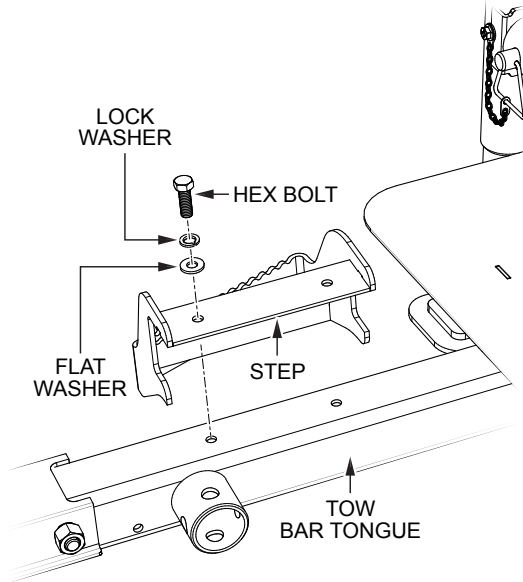

**Figure 4. Front Jack Stand Removal**

3. Next, remove the locking pin (Figure 4) from the jack stand support hub, Set locking and cotter pins aside.
4. Remove jack stand and set aside.

## TOW BAR REMOVAL

1. Remove the bolts and washers that secure the **tow bar step** to the tow bar tongue (Figure 5).
2. Remove **tow bar step** and set aside, it will be mounted onto the replacement tow bar. Save mounting hardware, it will be used later.



**Figure 5. Remove Tow Bar Step**

3. On the underside of the tow bar, remove the two 1/2" clamps and tie wraps that secure the tail light harness to the tow bar (Figure 6).
4. Set the tail light harness and associated hardware aside, as these components will be installed onto the new replacement tow bar.

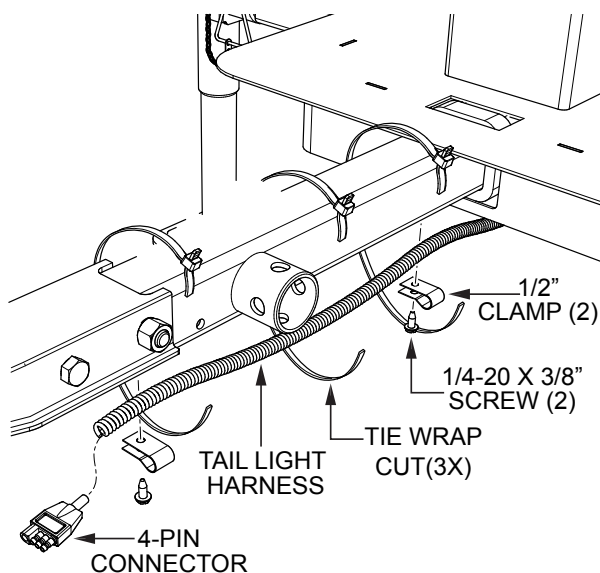

**Figure 6. Tail Light Harness**

5. Remove the bolt and washers that secure the safety chain to the tow bar (Figure 7).

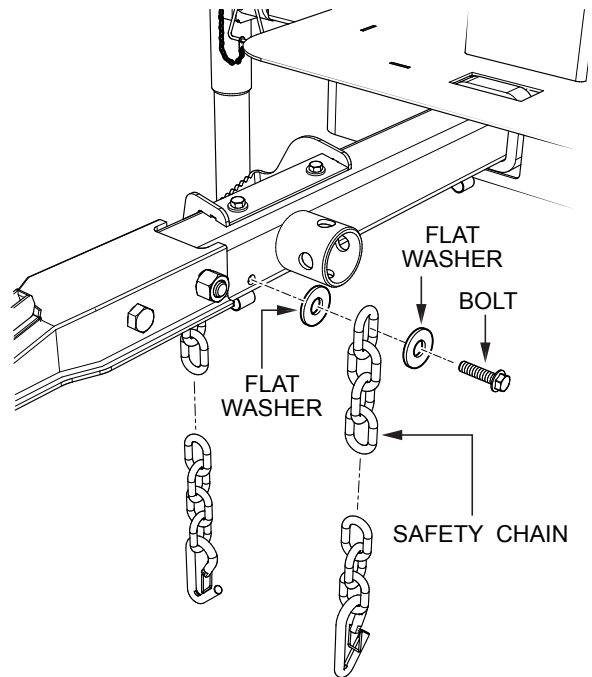

**Figure 7. Safety Chain Removal**

6. Remove safety chain and set aside, it will be mounted onto the replacement tow bar.
7. Remove the 5/8"-11 X 4 HHC screw and 5/8" nyloc nut (Figure 8) that secures the tow bar to the frame.
8. Remove tow bar from the frame channel. Discard tow bar (old), 5/8"-11 X 4 HHC screw and 5/8" nyloc nut.

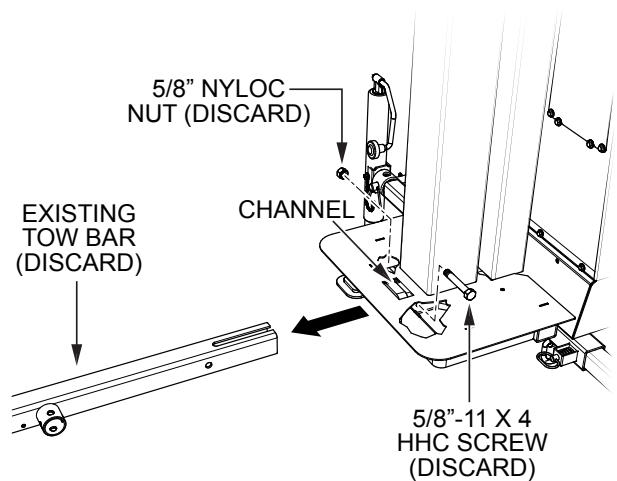

**Figure 8. Existing Tow Bar Removal**

## NEW TOW BAR INSTALLATION

1. Slide **new tow bar with coupler** into the frame channel as shown in Figure 9.
2. Secure tow bar with new 5/8"-11 X 4 HHC screw (P/N 915319) and 5/8" nyloc nut (P/N 9503). Tighten nut securely.

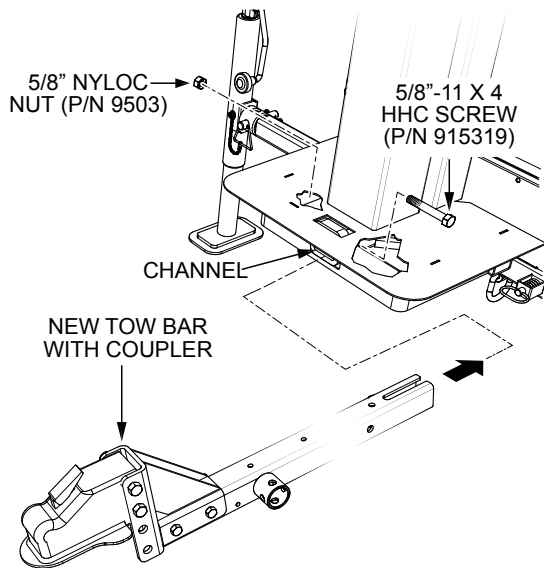

Figure 9. Attach and Secure New Tow Bar

## REASSEMBLY

### Front Jack Stand

1. Place **front jack stand** onto tow bar jack stand support hub as shown in Figure 10.

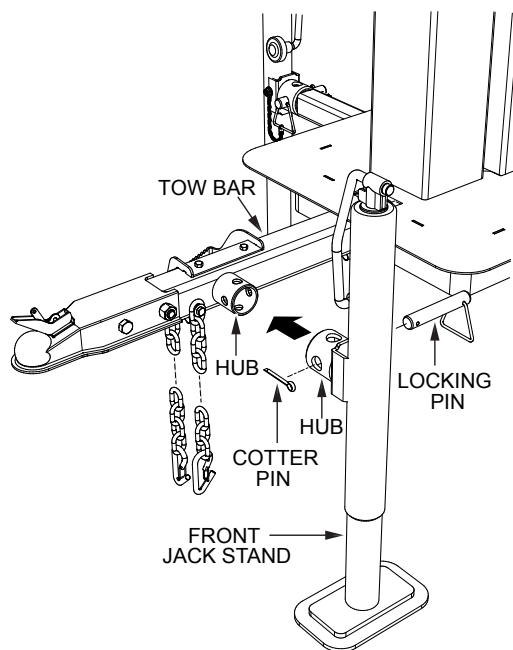

Figure 10. Front Jack Stand Install

2. Next, insert the jack stand **locking pin** through both the jackstand and tow bar support hubs.
3. Secure front jack stand to tow bar by inserting **cotter pin** into locking pin hole.

### Tow Bar Step

1. Align the **tow bar step** with the two mounting holes (Figure 11) on the tow bar.
2. Secure the tow bar step with the bolts and washers that were removed earlier. Reference "Tow Bar Removal" section, step 2.

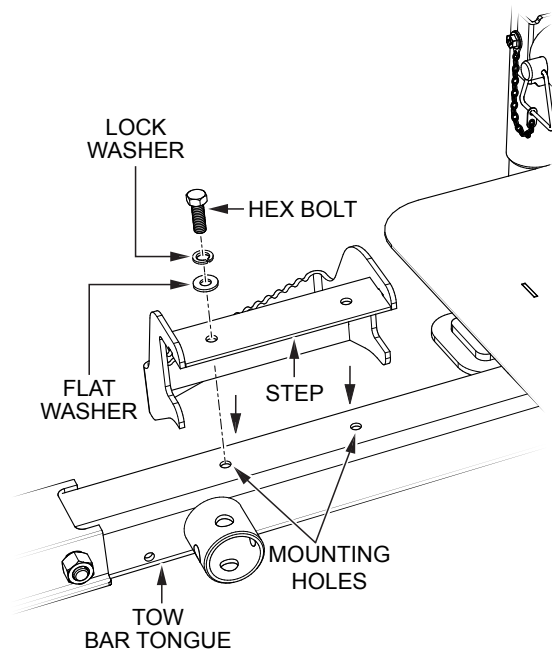
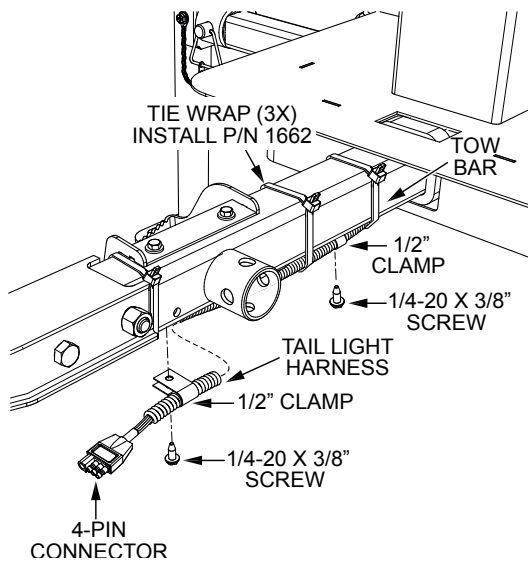

Figure 11. Install Tow Bar Step

## Tail Light Harness

1. Route the tail light harness through both of the 1/2" clamps as shown in Figure 12.

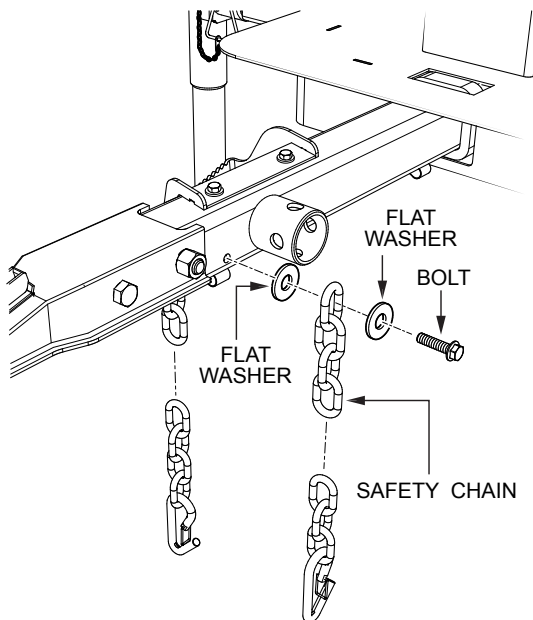

**Figure 12. Attaching Tail Light Harness**

2. Next, attach the tail light harness onto tow bar using 1/4-20 X 3/8" screw (2).
3. Apply three tie wraps (P/N 1662) around tow bar to further secure tail light harness.

## Safety Chain

1. Install the safety chain (Figure 13) onto the tow bar using the hardware that was removed in the "Tow Bar Removal" section, step 5. Tighten bolt securely.



**Figure 13. Safety Chain Installation**

## Final Assembly

1. Reference Figure 14 for final assembly.

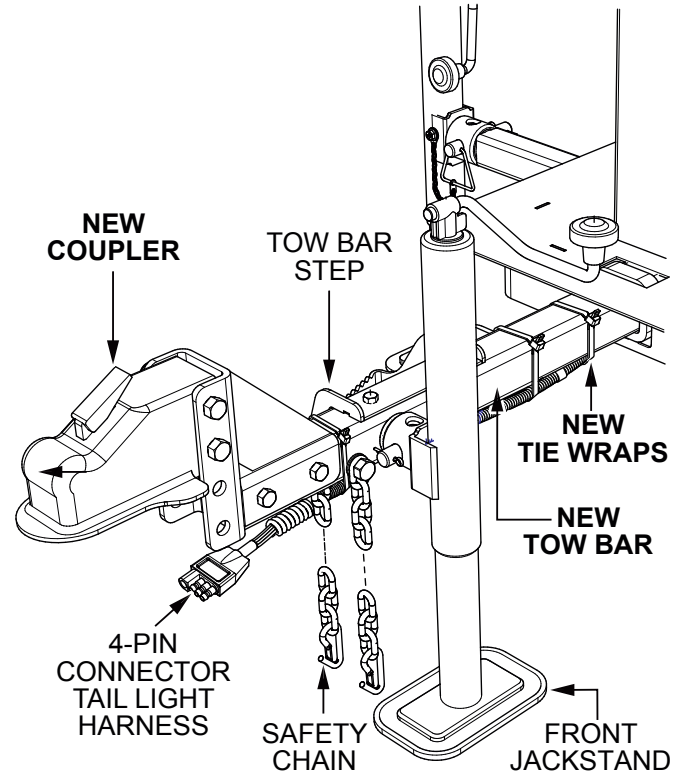

**Figure 14. Tow Bar Final Assembly**



# Service Bulletin

## LT6KV Light Tower

# HERE'S HOW TO GET HELP

PLEASE HAVE THE MODEL AND SERIAL  
NUMBER ON-HAND WHEN CALLING

### UNITED STATES

#### **Multiquip Corporate Office**

18910 Wilmington Ave.  
Carson, CA 90746  
Contact: mq@multiquip.com

Tel. (800) 421-1244  
Fax (310) 537-3927

#### **Service Department**

800-421-1244  
310-537-3700

#### **Technical Assistance**

800-478-1244

Fax: 310-943-2238

#### **MQ Parts Department**

800-427-1244  
310-537-3700

Fax: 800-672-7877

#### **Warranty Department**

800-421-1244  
310-537-3700

Fax: 310-943-2249

### CANADA

#### **Multiquip**

4110 Industriel Boul.  
Laval, Quebec, Canada H7L 6V3  
Contact: infocanda@multiquip.com

Tel: (450) 625-2244  
Tel: (877) 963-4411  
Fax: (450) 625-8664

### UNITED KINGDOM

#### **Multiquip (UK) Limited Head Office**

Unit 2, Northpoint Industrial Estate,  
Globe Lane,  
Dukinfield, Cheshire SK16 4UJ  
Contact: sales@multiquip.co.uk

Tel: 0161 339 2223  
Fax: 0161 339 3226

© COPYRIGHT 2016, MULTIQUIP INC.

Multiquip Inc and the MQ logo are registered trademarks of Multiquip Inc. and may not be used, reproduced, or altered without written permission. All other trademarks are the property of their respective owners and used with permission.

The information and specifications included in this publication were in effect at the time of approval for printing. Illustrations, descriptions, references and technical data contained in this document are for guidance only and may not be considered as binding. Multiquip Inc. reserves the right to discontinue or change specifications, design or the information published in this publication at any time without notice and without incurring any obligations.

Your Local Dealer is:

