



LT6KV Light Tower

Reinforced Tow Bar Installation Instructions

The following instructions are intended to assist the user with the installation of a reinforced tow bar used on the LT6KV Light Tower. Please read all assembly instructions before installing the kit.

REQUIRED TOOLS

- Ratchet Set
- Open-End Wrench Set

PARTS

Check that **all** parts are accounted for before attempting this installation procedure. Reference Table 1 and Figure 1.

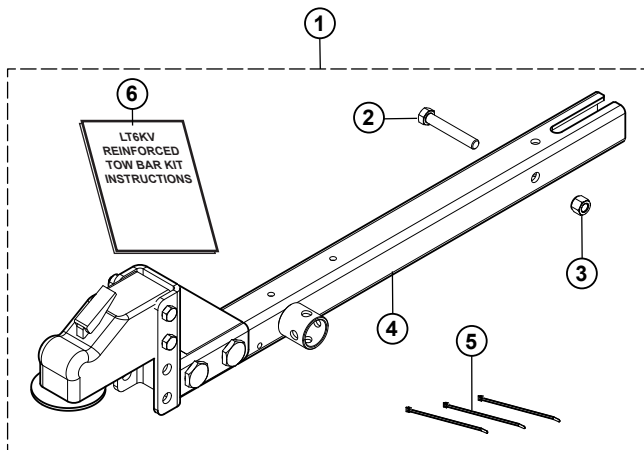

Figure 1. Kit, Tongue Assy., LT6KV

Table 1. LT6KV Tow Bar Kit Parts

Item No.	Part No.	Description	QTY.	Remarks
1	44210-SK	Kit, Tongue Assy., LT6KV	1	Includes items 2-6
2	915319	Screw, HHC 5/8"-11 X 4	1	
3	9503	Nut, Nyloc 5/8"-11	1	
4		Tow Bar with Coupler	1	
5	1662	Black Tie Wrap, 11 in	3	
6	44414	Tow Bar Kit Instructions, LT6KV	1	

WORK SAFELY!

Only a **qualified service technician** with proper training should perform this installation. Follow all shop safety rules when performing this installation.

PREPARATION

1. Place the LT6KV Light Tower in an area free of dirt and debris. Make sure it is on secure level ground with chock blocks (Figure 2) underneath each wheel to prevent the light tower from rolling.

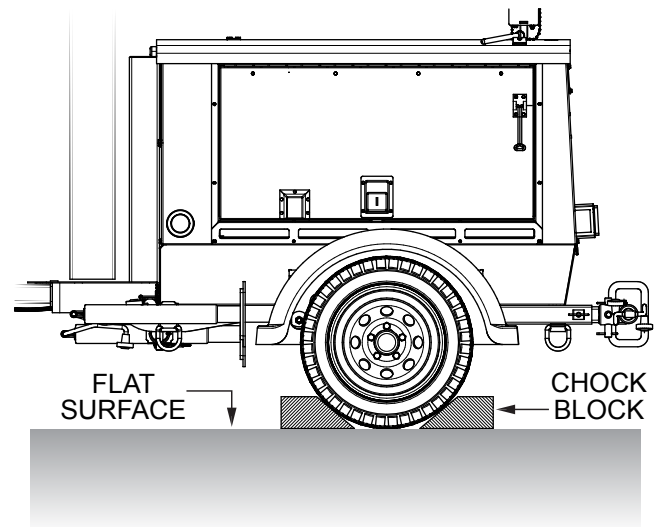

Figure 2. Chock Tires

2. Make sure the unit is turned **OFF**.

PROCEDURE

The following instructions will guide you through the **removal** of the existing tow bar assembly and the installation of the **replacement** tow bar assembly.

DEPLOYING OUTRIGGERS

1. Deploy the left and right side outrigger jack stands to support the front-end (tow side) of the light tower. See Figure 3

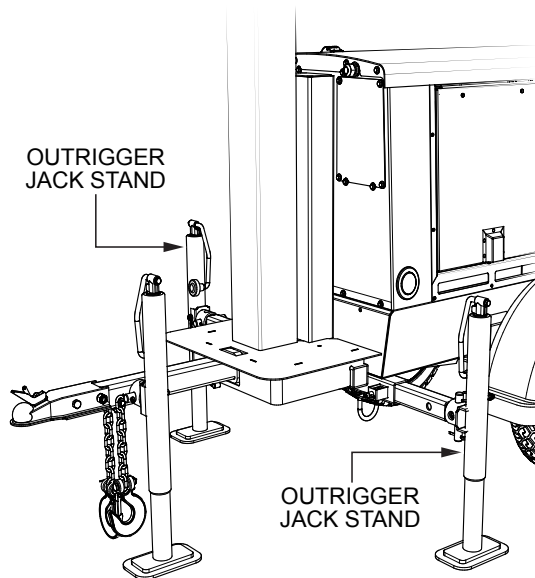

Figure 3. Outrigger Deployment

2. Once the tow end of the light tower has been supported by the left and right outrigger jack stands, remove the **cotter pin** as shown in Figure 4.

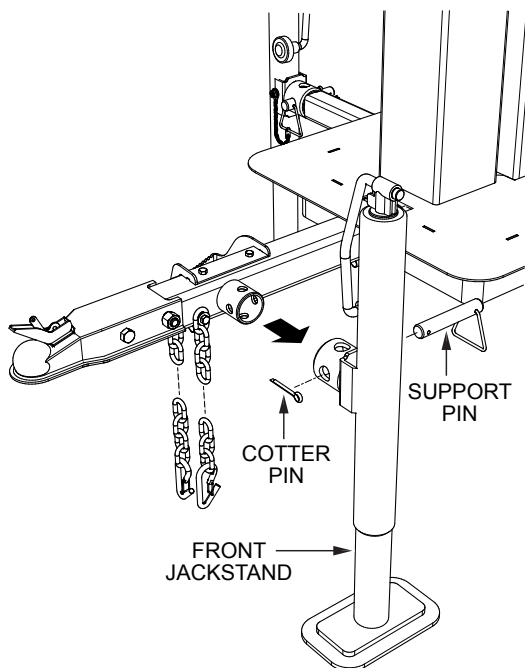

Figure 4. Front Jack Stand Removal

3. Remove the locking pin (Figure 4) from the jack stand support hub, Set locking and cotter pins aside.
4. Remove jack stand and set aside.

TOW BAR REMOVAL

1. Remove the bolts and washers that secure the **tow bar step** to the tow bar tongue (Figure 5).
2. Remove **tow bar step** and set aside, it will be mounted onto the replacement tow bar. Save mounting hardware, it will be used later.

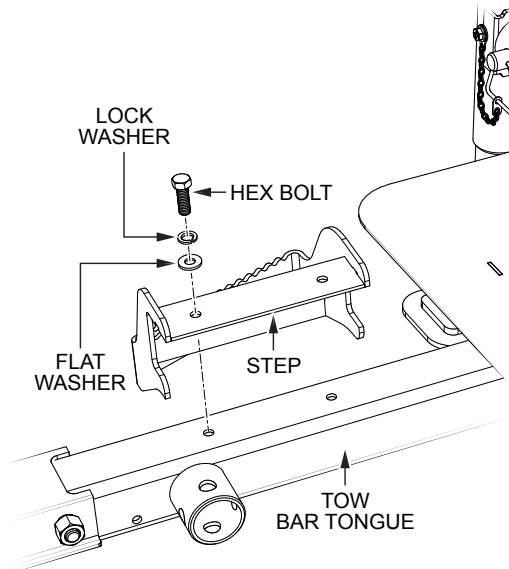

Figure 5. Remove Tow Bar Step

3. On the underside of the tow bar, remove the two 1/2" clamps that secure the tail light harness to the tow bar (Figure 6).
4. Set the tail light harness and associated hardware aside, as these components will be installed onto the new replacement tow bar.

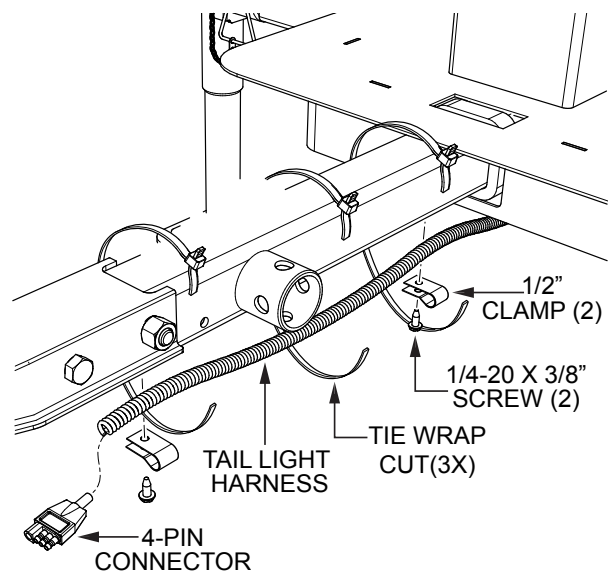

Figure 6. Tail Light Harness

- Remove the bolt and washers that secure the safety chain to the tow bar (Figure 7).

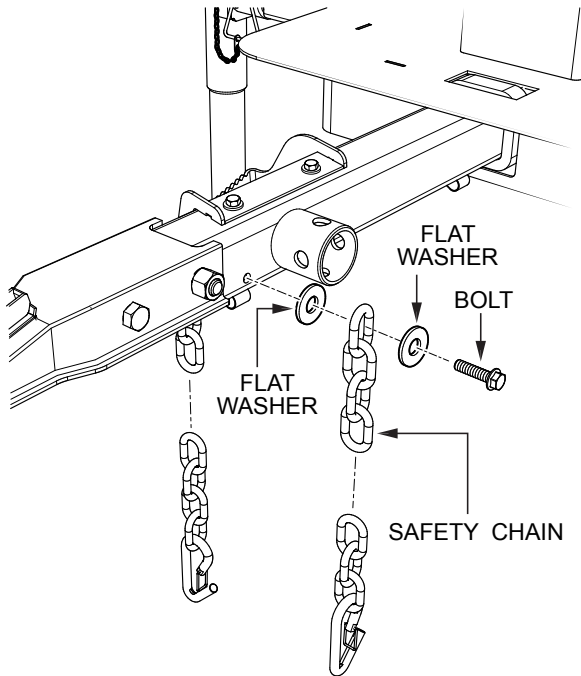

Figure 7. Safety Chain Removal

- Remove safety chain and set aside, it will be mounted onto the replacement tow bar.
- Remove the 5/8"-11 X 4 HHC screw and 5/8" nyloc nut (Figure 8) that secures the tow bar (Figure 8) to the frame.
- Remove tow bar from the frame channel. Discard tow bar (old), 5/8"-11 X 4 HHC screw and 5/8" nyloc nut

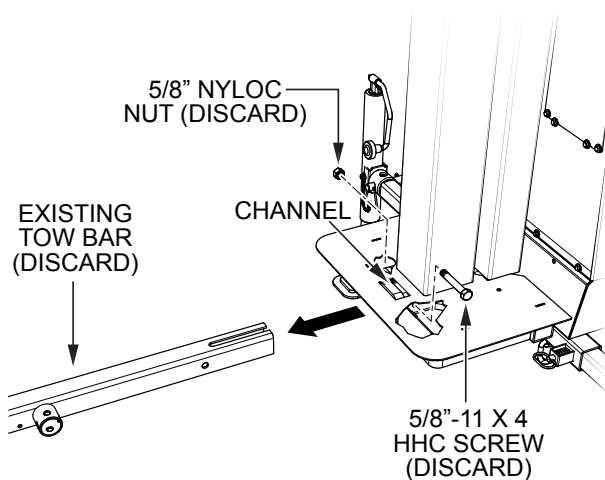

Figure 8. Existing Tow Bar Removal

NEW TOW BAR INSTALLATION

- Slide **new tow bar with coupler** into the frame channel as shown in Figure 9.
- Secure tow bar with new 5/8"-11 X 4 HHC screw (P/N 915319) and 5/8" nyloc nut (P/N 9503). Tighten nut securely.

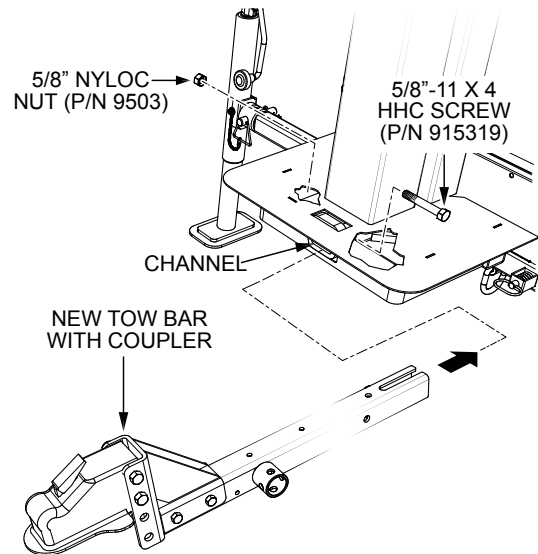

Figure 9. Attach and Secure New Tow Bar

REASSEMBLY

Front Jack Stand

- Place **front jack stand** onto tow bar jack stand support hub as shown in Figure 10.

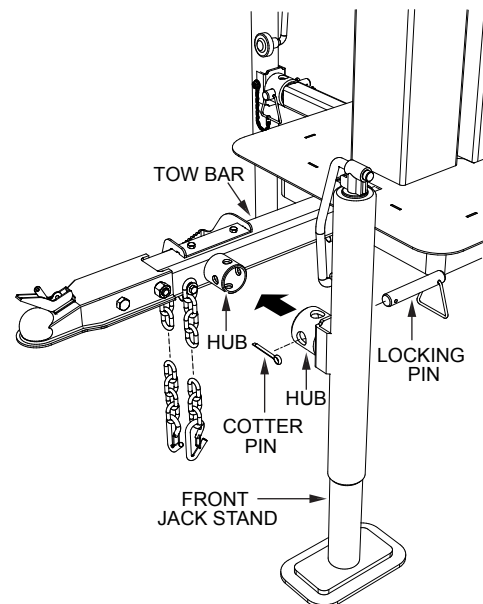

Figure 10. Front Jack Stand Install

2. Next, insert the jack stand **locking pin** through both the jackstand and tow bar support hubs.
3. Secure front jack stand to tow bar by inserting **cotter pin** into locking pin hole.

Tow Bar Step

1. Align the **tow bar step** with the two mounting holes (Figure 11) on the tow bar.
2. Secure the tow bar step with the bolts and washers that were removed earlier. Reference "Tow Bar Removal" section, step 2.

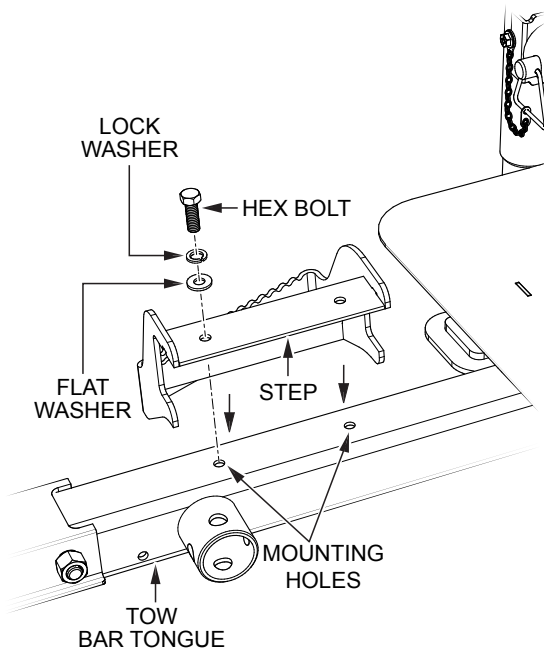

Figure 11. Install Tow Bar Step

Tail Light Harness

1. Route the tail light harness through both of the 1/2" clamps as shown in Figure 12.

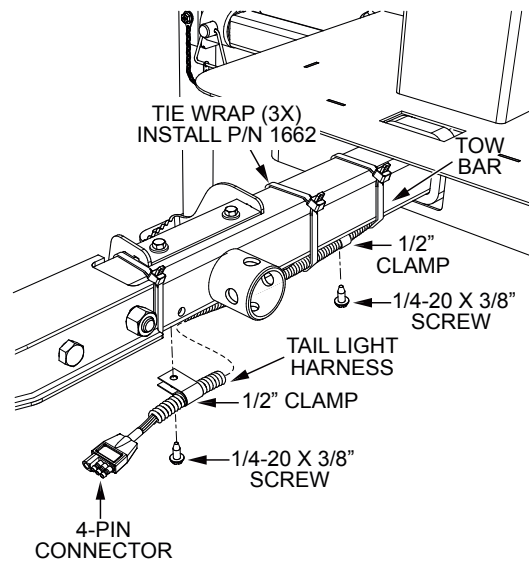

Figure 12. Attaching Tail Light Harness

2. Next, attach the tail light harness onto tow bar using 1/4-20 X 3/8" screw (2).
3. Apply three tie wraps (P/N 1662) around tow bar to further secure tail light harness.

Safety Chain

1. Install the safety chain (Figure 13) onto the tow bar using the hardware that was removed in the "Tow Bar Removal" section, step 5. Tighten bolt securely.

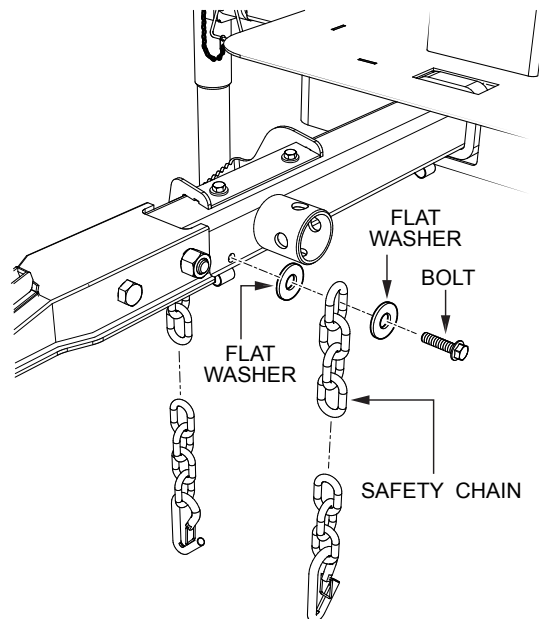

Figure 13. Safety Chain Installation

Final Assembly

1. Reference Figure 14 for final assembly.

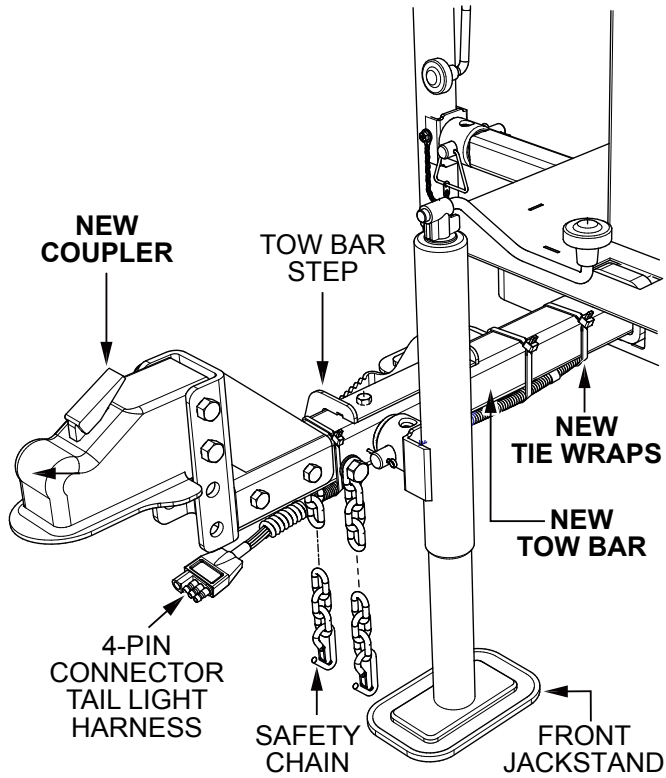

Figure 14. Tow Bar Final Assembly



LT6KV Light Tower

Reinforced Tow Bar Installation Instructions

HERE'S HOW TO GET HELP

PLEASE HAVE THE MODEL AND SERIAL
NUMBER ON-HAND WHEN CALLING

UNITED STATES

Multiquip Corporate Office

18910 Wilmington Ave.
Carson, CA 90746
Contact: mq@multiquip.com

Tel. (800) 421-1244
Fax (310) 537-3927

Service Department

800-421-1244
310-537-3700

Technical Assistance

800-478-1244 Fax: 310-943-2238

MQ Parts Department

800-427-1244 Fax: 800-672-7877
310-537-3700

Warranty Department

800-421-1244 Fax: 310-943-2249
310-537-3700

CANADA

Multiquip

4110 Industriel Boul.
Laval, Quebec, Canada H7L 6V3
Contact: infocanda@multiquip.com

Tel: (450) 625-2244
Tel: (877) 963-4411
Fax: (450) 625-8664

UNITED KINGDOM

Multiquip (UK) Limited Head Office

Unit 2, Northpoint Industrial Estate, Tel: 0161 339 2223
Globe Lane, Fax: 0161 339 3226
Dukinfield, Cheshire SK16 4UJ
Contact: sales@multiquip.co.uk

© COPYRIGHT 2016, MULTIQUIP INC.

Multiquip Inc and the MQ logo are registered trademarks of Multiquip Inc. and may not be used, reproduced, or altered without written permission. All other trademarks are the property of their respective owners and used with permission.

The information and specifications included in this publication were in effect at the time of approval for printing. Illustrations, descriptions, references and technical data contained in this document are for guidance only and may not be considered as binding. Multiquip Inc. reserves the right to discontinue or change specifications, design or the information published in this publication at any time without notice and without incurring any obligations.

Your Local Dealer is:

