



J-Series Walk-Behind Trowel

Lifting Bale Mounting

The following instructions are intended to assist the user in the installation of the lifting bale for the following J-series walk-behind trowels: 3HP and 5HP Briggs & Stratton, 5HP Honda, and 4.5 Robin engines. Please read all assembly instructions before installing the kit.

REQUIRED TOOLS

- 1/2", 7/16", 9/16" socket or open-ended wrench
- Clutch Puller Tool
- Blue Loctite #242
- Philips Head Screwdriver
- 4mm, 5mm, 8mm Allen Head Key
- Ratchet w/ Extension

PARTS

Verify that all parts are accounted for. See Figure 1 and Table 1.

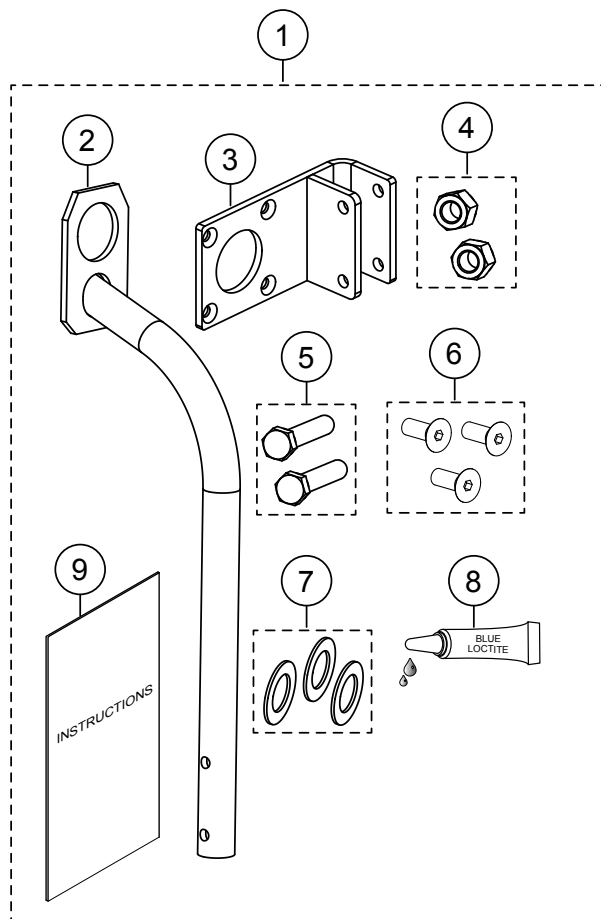

Figure 1. Lifting Bale Mounting Kit

Table 1. Lifting Bale Mounting Kit

Item No.	Part No.	Description	QTY.	Remarks
1	1846	Lifting Bale Mounting Kit	1	INCLUDES ITEMS 2-9
2	C8202	Lifting Bale	1	
3	10759	Plate, Lift Bale W/A	1	
4	1063	Nut, Nyloc, 3/8-24	2	
5	0478	Screw, HHC, 3/8-24 x 2-1/4	2	
6	1847	Screw, FHSC 5/16-24 X 3/4" Plated	4	
7	0939	Washer, Spacing	3	
8	1477	Loctite # 242 Blue .5CC Bottle	1	
9	2940	Instructions, Lifting Bale Mount, J	1	

WORK SAFELY!

Only a **qualified service technician** with proper training should perform this installation. Follow all shop safety rules when performing this installation.

Place trowel in a clean work area that is free of dirt and debris. Position the trowel in a manner so that it will not slip or slide while the installation is being performed.

BELT GUARD REMOVAL

1. Using a ratchet, ratchet extension, and 7/16" socket, remove the two 1/4-20 X 5/8" screws and 1/4" lock washers (Figure 1) from the belt guard.
2. If unit is equipped with T-bolts, turn counterclockwise with your hands to remove.

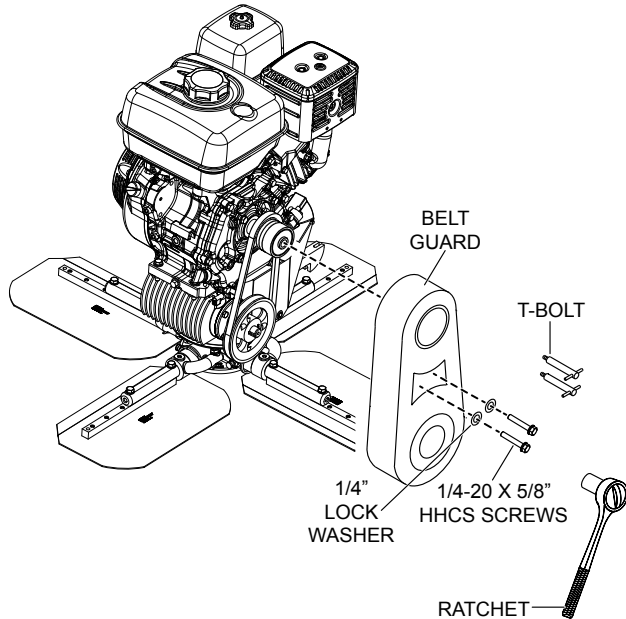

Figure 2. Belt Guard Removal

BELT REMOVAL

1. Remove or walk the belt off the clutch.
2. Let the belt hang loose on the lower pulley grooves.

CLUTCH REMOVAL

1. Using a 4mm-5mm allen head key, loosen the two clutch set screws (Figure 3).
2. Using a 8mm allen head key, remove and retain the clutch retaining screw (Figure 3).
3. Using a clutch puller tool (Figure 3), remove clutch from the engine shaft. The engine shaft key slides out when the clutch is removed.
4. Set the engine shaft key aside in a safe place. It will be reinstalled later.

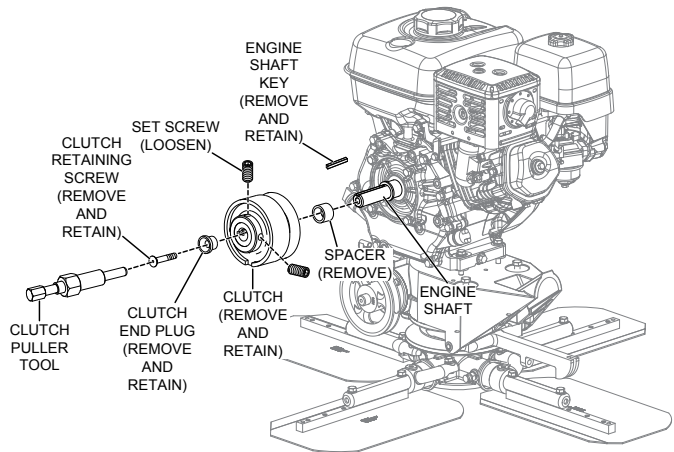

Figure 3. Clutch Removal

"CLUTCH PANEL " BOLT REMOVAL

1. Using a ratchet, ratchet extension, and socket, remove the four screws and washers, or flange bolts (Figure 4), that bolt to the engine.
2. Discard the four engine screws and washers, or flange bolts, as they will not be used anymore.

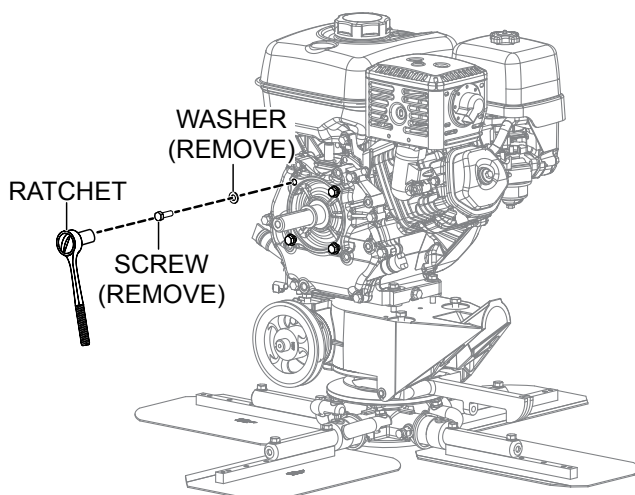

Figure 4. Clutch Panel Bolt Removal

LIFTING BALE ASSEMBLY

1. Locate the lifting bale (P/N C8202) and lifting bale bracket plate (P/N 10759) in the kit.
2. Using a 9/16" open-ended wrench, secure the lifting bale and lifting bale bracket plate together (Figure 5) using two 3/8-24 x 2-1/4" HHCS screws (P/N 0478) and 3/8-24 lock nuts (P/N 1063).

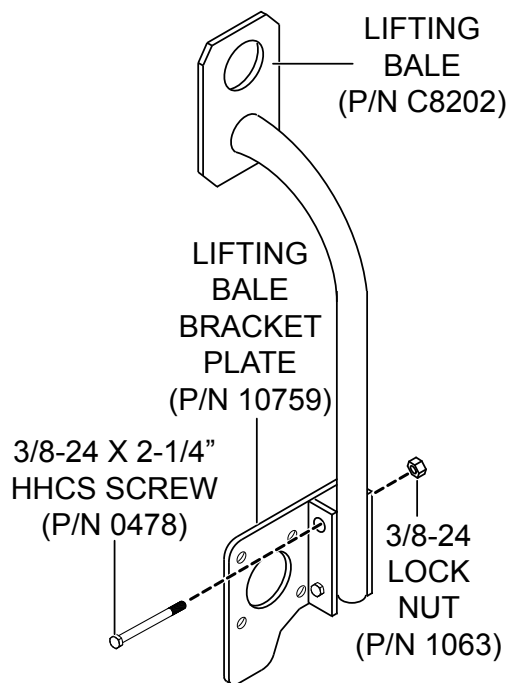

Figure 5. Lifting Bale Assembly

LIFTING BALE INSTALLATION

1. Apply Blue Loctite™ #242 (P/N 1477) to the four lifting bale mounting 5/16-24 X 3/4" FHSC screws (P/N 1847) as shown in Figure 6.
2. Place the lifting bale onto the engine shaft (Figure 6) and slide backwards until flush with the engine.
3. Using a 8mm allen head key (Figure 6), tighten screws (4) to secure lifting bale to the engine.

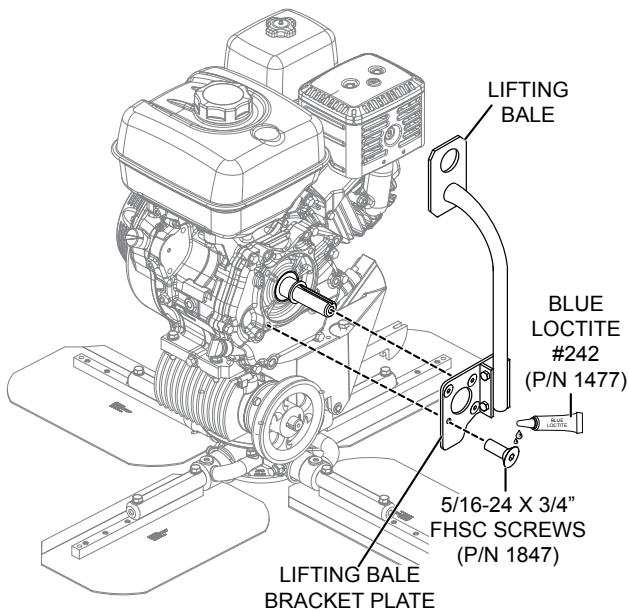

Figure 6. Lifting Bale Installation

SPACER INSTALLATION

1. Locate the three spacers (P/N 0939) in the kit.
2. Set the spacers (3) on the engine shaft (Figure 7) and slide back until flush with the lifting bale.

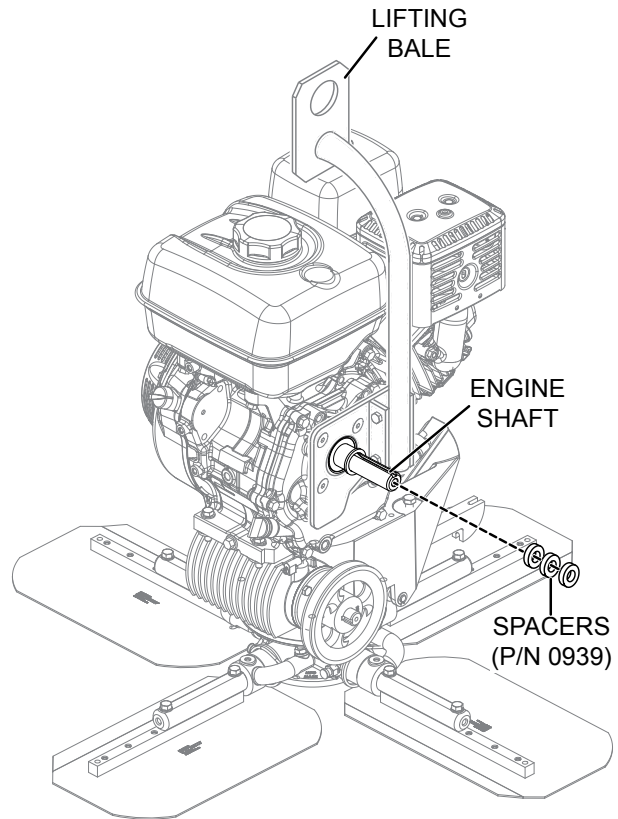

Figure 7. Spacer Installation

CLUTCH INSTALLATION

1. Place the clutch (P/N 0255) onto engine shaft (Figure 8) and slide back until flush with the spacers.
2. Apply Blue Loctite™ #242 (Figure 8) to the clutch retaining screw and insert into the clutch.
3. Using a 8mm allen head key, tighten the clutch retaining screw.
4. Using a 4mm-5mm allen head key, tighten the two clutch set screws (Figure 9).
5. Using a rubber mallet, gently tap the engine shaft key into the engine shaft key slot.

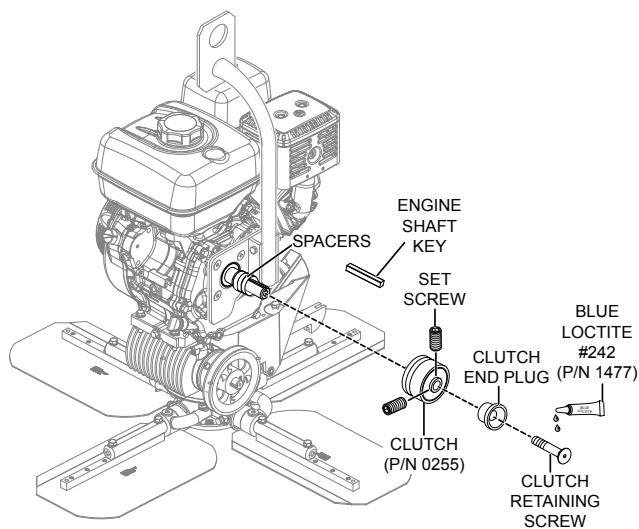

Figure 8. Clutch Installation

LOWER PULLEY ADJUSTMENT

1. Using an allen head key, loosen the lower pulley set screw as shown in Figure 9.
2. Using a clutch puller tool (Figure 9), move the lower pulley 3/16" away from the gearbox.
3. Retighten the set screw to secure the lower pulley.

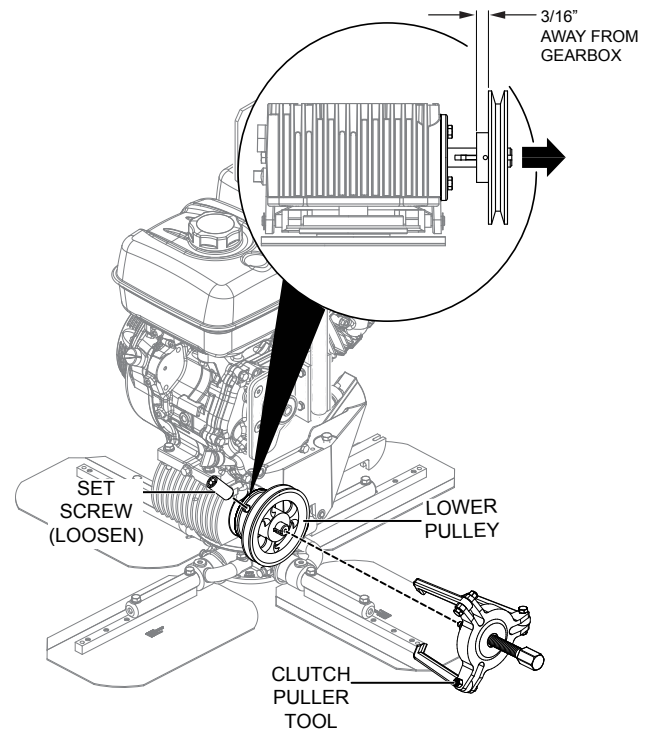

Figure 9. Lower Pulley Adjustment

LOWER PULLEY ALIGNMENT

1. Using a straight edge ruler, align the lower pulley with the clutch grooves. Place ruler on the lower pulley's back side.
2. Apply Blue Loctite™ #242 to the lower pulley set screw once the clutch and lower pulley are aligned.
3. Retighten the set screw to secure the lower pulley.

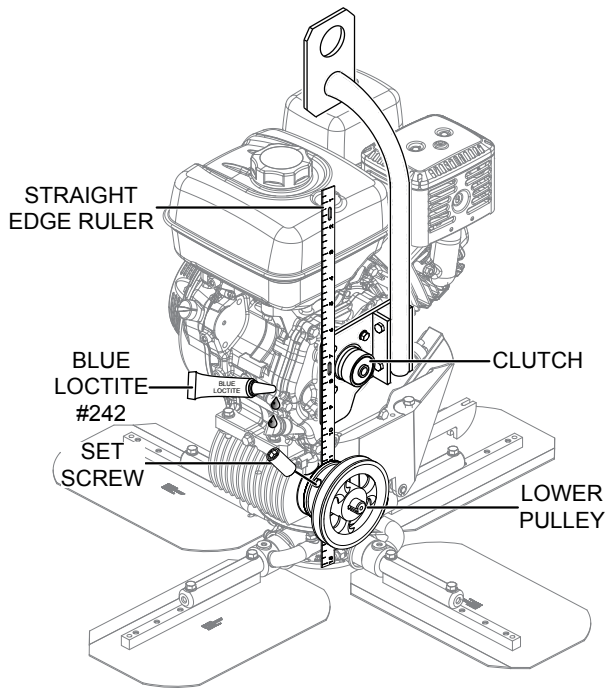

Figure 10. Lower Pulley Alignment

BELT INSTALLATION

1. Lift or walk the belt onto the clutch grooves.

BELT GUARD INSTALLATION

1. Using a ratchet, ratchet extension, and 7/16" socket, tighten the two 1/4-20 X 5/8" screws and 1/4" lock washers (Figure 11) to secure the belt guard.
2. If unit is equipped with T-bolts, turn clockwise with your hands to tighten.

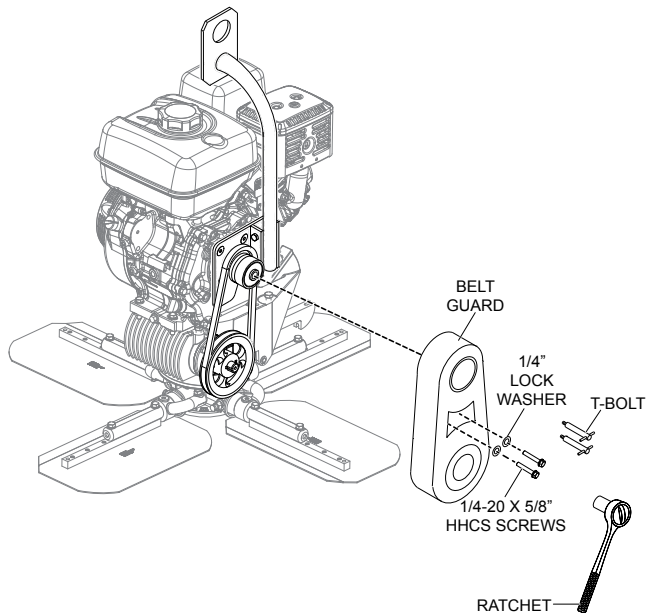

Figure 11. Belt Guard Installation

STARTING THE TROWEL/TESTING

1. Start the trowel as referenced in the Operator's Manual. Be sure to check the engine oil level prior to starting the engine.



CAUTION

The engine's exhaust contains harmful emissions. **ALWAYS have adequate ventilation when operating.** Direct exhaust away from nearby personnel.

2. Run machine, bringing throttle up so the clutch engages. Cycle the engine from idle to full throttle twice, and shut off engine.



J-Series Walk-Behind Trowel

Lifting Bale Mounting

HERE'S HOW TO GET HELP

PLEASE HAVE THE MODEL AND SERIAL
NUMBER ON-HAND WHEN CALLING

UNITED STATES

Multiquip Corporate Office

18910 Wilmington Ave. Tel. (800) 421-1244
Carson, CA 90746 Fax (310) 537-3927
Contact: mq@multiquip.com

Service Department

800-421-1244 Fax: 310-537-4259
310-537-3700

Technical Assistance

800-478-1244 Fax: 310-943-2238

MQ Parts Department

800-427-1244 Fax: 800-672-7877
310-537-3700 Fax: 310-637-3284

Warranty Department

800-421-1244 Fax: 310-943-2249
310-537-3700

CANADA

Multiquip

4110 Industriel Boul. Tel: (450) 625-2244
Laval, Quebec, Canada H7L 6V3 Tel: (877) 963-4411
Contact: jmartin@multiquip.com Fax: (450) 625-8664

UNITED KINGDOM

Multiquip (UK) Limited Head Office

Unit 2, Northpoint Industrial Estate, Tel: 0161 339 2223
Globe Lane, Fax: 0161 339 3226
Dukinfield, Cheshire SK16 4UJ
Contact: sales@multiquip.co.uk

© COPYRIGHT 2015, MULTIQUIP INC.

Multiquip Inc and the MQ logo are registered trademarks of Multiquip Inc. and may not be used, reproduced, or altered without written permission. All other trademarks are the property of their respective owners and used with permission.

The information and specifications included in this publication were in effect at the time of approval for printing. Illustrations, descriptions, references and technical data contained in this document are for guidance only and may not be considered as binding. Multiquip Inc. reserves the right to discontinue or change specifications, design or the information published in this publication at any time without notice and without incurring any obligations.

Your Local Dealer is:

