



This bulletin is provided for technical reference and service related updates. If you have any questions, comments or do not wish to receive these e-mails, please reply to this e-mail or call the Service Technical Support Group 800 478-1244.

CONTROL BOX CHANGE

The DEUTZ modified control box has been discontinued and replaced with the new LOFA control box.

This change is effective on December 2009 production machines beginning with SERIAL# 621009862

DEUTZ Modified Control Box DISCONTINUED

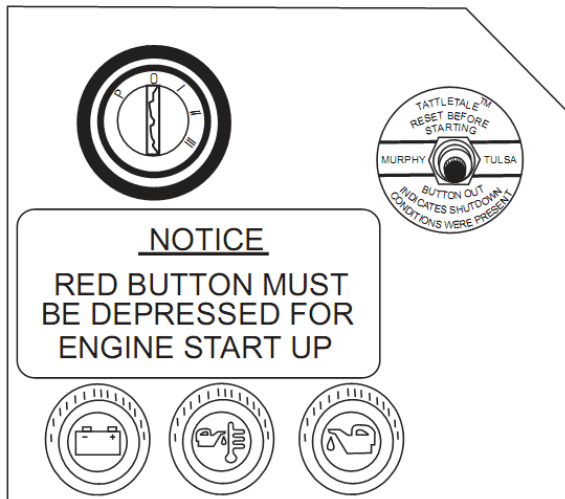

MQ PART# 34462

New LOFA Control Box

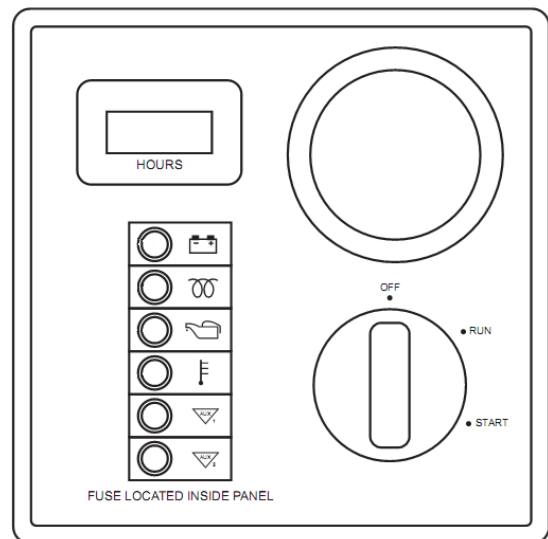

MQ PART# 34708

Features and Benefits

- Solid state construction with reverse polarity protection.
- Ultra bright - first fault diagnostics LED display.
- Hour meter.
- Heavy duty anodized aluminum enclosure designed to withstand most jobsite conditions.
- Heavy duty water resistant key switch with mechanical locking to prevent unwanted engagement of starter motor after engine is running.
- Wire harness features weather proof plug with all terminals machined crimped.

LOFA CONTROL BOX



MQ PART NUMBERS

Solid state control box.....	34708
Control box bracket.....	34709
Engine bracket.....	34707
Wiring harness assembly.....	34710

