



# Service Bulletin

## MRH601DS Travel Lever Replacement

<b>Product Group:</b> Rollers	<b>Date Issued:</b> 11/17/14	<b>Service Bulletin No.</b> VR20140813
----------------------------------	---------------------------------	---

<b>Bulletin Type</b>  <input checked="" type="checkbox"/> Mandatory <input type="checkbox"/> Information Only <input type="checkbox"/> Recommended Change	<b>Models/Series Affected:</b>  MRH601DS S/N Y1001 – Y1013 S/N Z1014 – Z1022
---	--

**Details**

**Problem:**

- The bolt of the traveling lever may become loose and cause rusting around screw thread of the lever shaft.
- The electrical cables are may be exposed to water from the sprinklers.

**Solution:**

- Replace travel lever with new design (no bolt) to eliminate problem of bolt getting loose during operation.
- Cover the electrical cables with flex tube.

### Parts Information

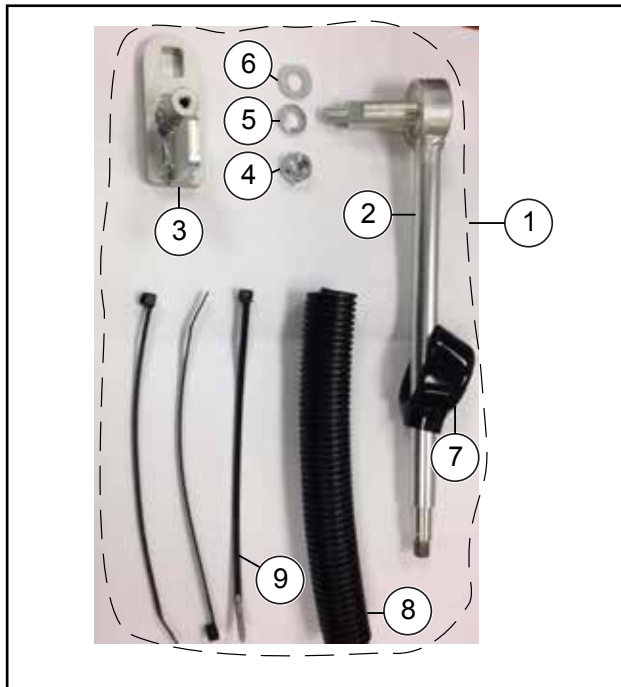

Figure 1. MRH601DS Parts

Item No.	Part No.	Description	QTY.	Remarks
1	MRH601LEVERKIT	Kit, Travel Lever and Electrical Tube	1	Includes items 2-9
2	518352810	Travel Lever	1	
3	518352800	Lever Shaft	1	
4	020310080	Nut, M10	1	
5	030210250	Lock Washer, M10	1	
6	031110160	Flat Washer, M10	1	
7	518467530	Lever Cover	1	
8	959021924	Flex Tube, Electrical 25D-200L	1	
9	507010110	Tie Wraps TC-200	3	

## REPLACING TRAVEL LEVER

1. Remove knob from the travel lever by turning it counterclockwise. Set knob aside (Figure 2).

SLIDE LEVER COVER REMOVE KNOB



**Figure 2. Removing Travel Lever Knob**

2. Slide the lever cover up to access the bolt on the travel lever (Figure 2).
3. Remove the four bolts, and associated hardware, securing the handle cover, with a 10 mm socket (Figure 3).

REMOVE HANDLE COVER REMOVE 4 BOLTS



**Figure 3. Handle Cover Removal**

4. Remove handle cover.
5. Loosen and remove the bolt and washers at the rod end with a 10 mm socket and detach rod end from lever shaft (Figure 4).

REMOVE ROD END BOLT



**Figure 4. Removing Bolt At Rod End**

6. Loosen the travel lever bolt with a 13 mm wrench and remove bolt and associated hardware (Figure 5).

REMOVE TRAVEL LEVER BOLT

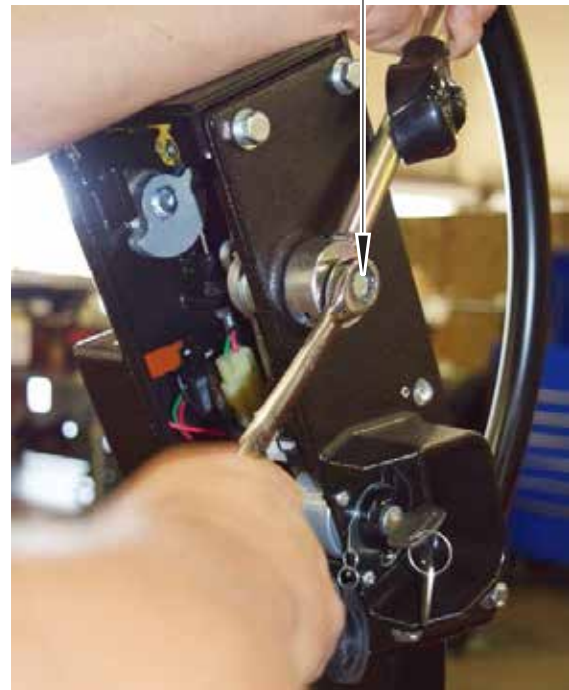

**Figure 5. Travel Lever Bolt Removal**

- Remove travel lever and lever shaft and discard. Remove and keep the collar next to the lever shaft (Figure 6).

**REMOVE AND KEEP COLLAR**

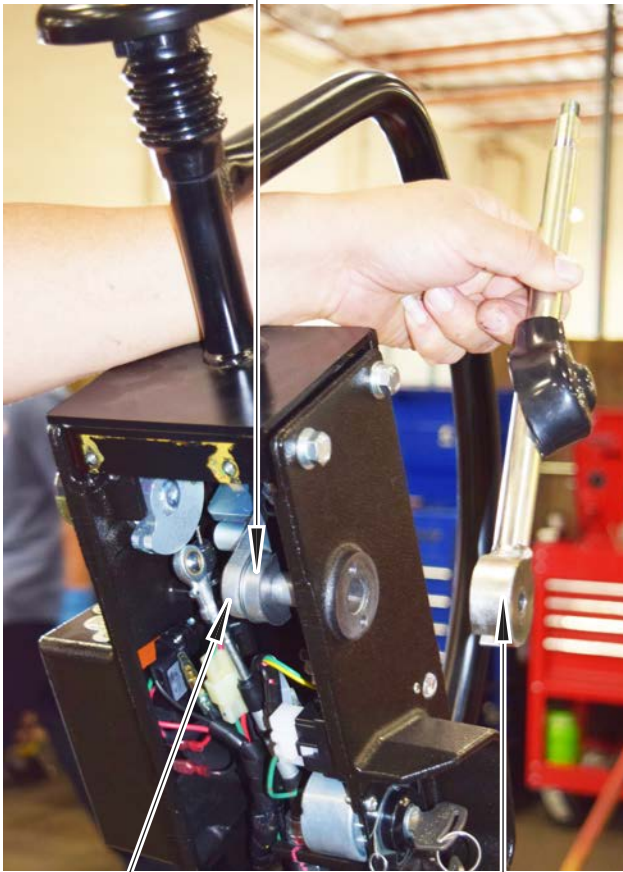

REMOVE AND DISCARD LEVER SHAFT

REMOVE AND DISCARD TRAVEL LEVER

**Figure 6. Travel Lever and Lever Shaft Removal**

- Install the new travel lever, making sure it is in the **STOP** position (Figure 7).
- Install the new lever shaft, with the collar in its original position (Figure 7).
- Push in new lever shaft and first tighten nut in place with a wrench until snug, then secure with flat and lock washers and nut. Apply Loctite 243 and torque nut to 48.05 Nm (490 kgf-cm). See Figure 8.

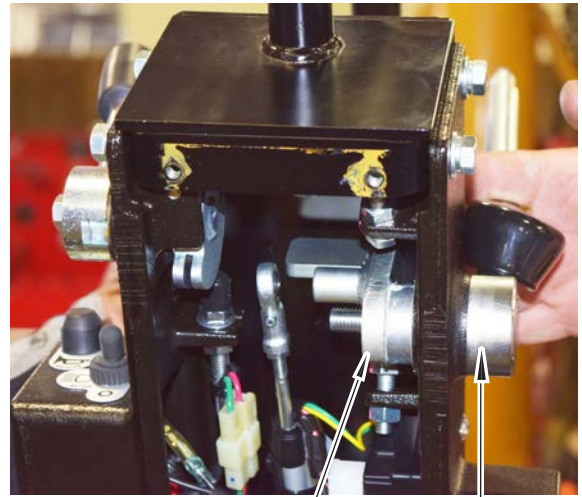

NEW LEVER SHAFT

NEW TRAVEL LEVER

**Figure 7. New Travel Lever and Lever Shaft**

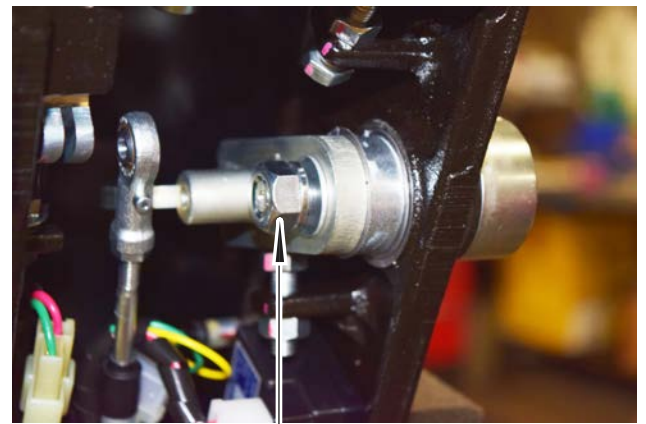

TIGHTEN NUT WITH FLAT AND LOCK WASHERS

**Figure 8. Securing Lever Shaft**

11. Attach the rod end to the lever shaft. Reinstall and tighten the bolt and washers with a 10 mm wrench and torque to 16.7 Nm (170 kgf-cm). See Figure 9.

#### ATTACH ROD END WITH BOLT AND WASHERS

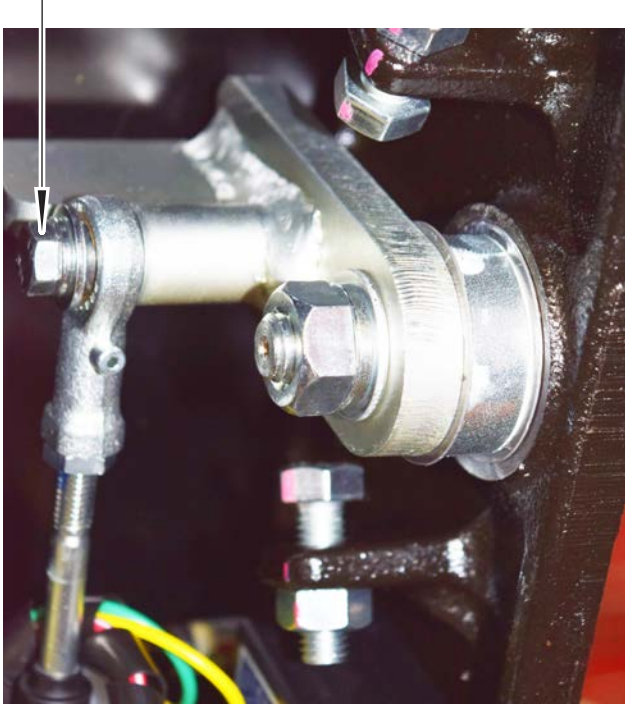

**Figure 9. Reinstalling Rod End**

12. Slide down new lever cover until it covers the rounded portion of the travel lever snugly.
13. Reinstall knob on travel lever and turn clockwise to tighten.

#### INSTALLING FLEX TUBE

1. Remove the 2 bolts with a 10 mm wrench from the T-connector between the 2 water hoses (Figure 10).

#### REMOVE 2 BOLTS



**Figure 10. Removal of T-Connector Bolts**

2. Detach the T-connector from the engine guard.
3. Remove 3 bolts from the engine guard with a 17 mm socket and remove engine guard (Figure 11).



#### REMOVE 3 BOLTS FROM ENGINE GUARD

**Figure 11. Engine Guard Removal**

4. Install flex tube over cables, making sure they are completely covered (Figure 12).



INSTALL FLEX TUBE

**Figure 12. Flex Tube Installation**

5. Position the open end of the flex tube down towards ground to prevent any accumulation of water in the tube.
6. Attach three clamps to secure the flex tube.
7. Reattach the engine guard. Apply Loctite 243 to the 3 bolts and tighten with a torque of 49.03 Nm (500 kgf cm).
8. Reattach the T-connector to the engine guard. Apply Loctite 243 to the 2 bolts and tighten with a torque of 11.78 Nm (120 kgf cm).



# Service Bulletin

## MRH601DS Travel Lever Replacement

### HERE'S HOW TO GET HELP

PLEASE HAVE THE MODEL AND SERIAL  
NUMBER ON-HAND WHEN CALLING

#### UNITED STATES

##### ***Multiquip Corporate Office***

18910 Wilmington Ave.      Tel. (800) 421-1244  
Carson, CA 90746      Fax (310) 537-3927  
Contact: mq@multiquip.com

##### ***Service Department***

800-421-1244      Fax: 310-537-4259  
310-537-3700

##### ***Technical Assistance***

800-478-1244      Fax: 310-943-2238

##### ***MQ Parts Department***

800-427-1244      Fax: 800-672-7877  
310-537-3700      Fax: 310-637-3284

##### ***Warranty Department***

800-421-1244      Fax: 310-943-2249  
310-537-3700

#### CANADA

##### ***Multiquip***

4110 Industriel Boul.      Tel: (450) 625-2244  
Laval, Quebec, Canada H7L 6V3      Tel: (877) 963-4411  
Contact: jmartin@multiquip.com      Fax: (450) 625-8664

#### UNITED KINGDOM

##### ***Multiquip (UK) Limited Head Office***

Unit 2, Northpoint Industrial Estate,      Tel: 0161 339 2223  
Globe Lane,      Fax: 0161 339 3226  
Dukinfield, Cheshire SK16 4UJ  
Contact: sales@multiquip.co.uk

© COPYRIGHT 2014, MULTIQUIP INC.

Multiquip Inc and the MQ logo are registered trademarks of Multiquip Inc. and may not be used, reproduced, or altered without written permission. All other trademarks are the property of their respective owners and used with permission.

The information and specifications included in this publication were in effect at the time of approval for printing. Illustrations, descriptions, references and technical data contained in this document are for guidance only and may not be considered as binding. Multiquip Inc. reserves the right to discontinue or change specifications, design or the information published in this publication at any time without notice and without incurring any obligations.

Your Local Dealer is:

