



MTX THROTTLE CABLE R & R

This documentation can be used as a guide when replacing the throttle cable

Tools Needed

- 13 mm wrench
- 10 mm wrench
- 4 mm hex wrench
- Screwdriver
- Pick
- Needle nose pliers

Cable Removal

Remove the rubber end caps on both the cable side and high speed adjustment side.

Move the throttle lever to the high speed position.

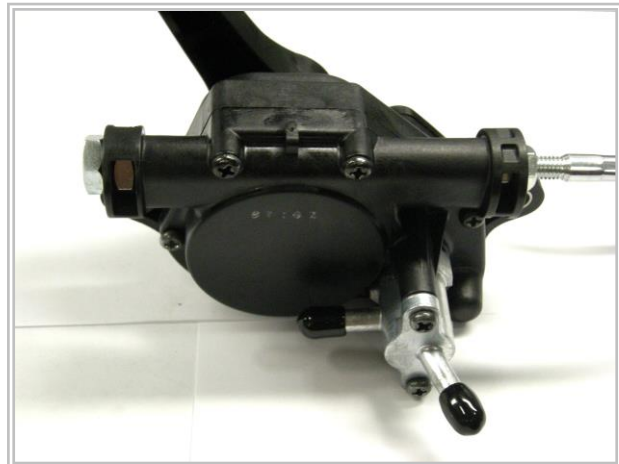

Loosen and remove the outer throttle adjuster jam nut.



Remove the throttle adjuster and jam nut



Behind the throttle adjuster is a slider. Pushing the inner cable from the opposite side of lever will push out the slider. Use a pick or small screwdriver to work the slider and throttle cable out of the housing.

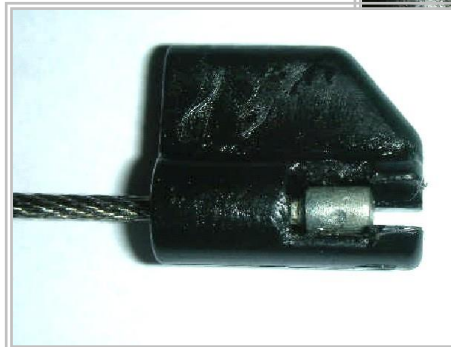
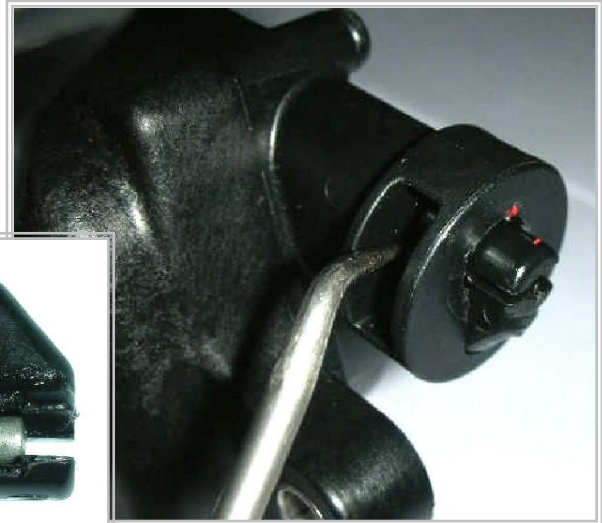

After pulling the inner cable out, this will allow you to remove the slider from the cable if needed.

To remove the throttle cable sleeve from the housing assembly, loosen the outer jam nut and unscrew the cable sleeve from the housing.



Cable Installation

Start by positioning the lever in the high rpm (full throttle) position.

Insert throttle cable into housing.
(Throttle adjuster side)

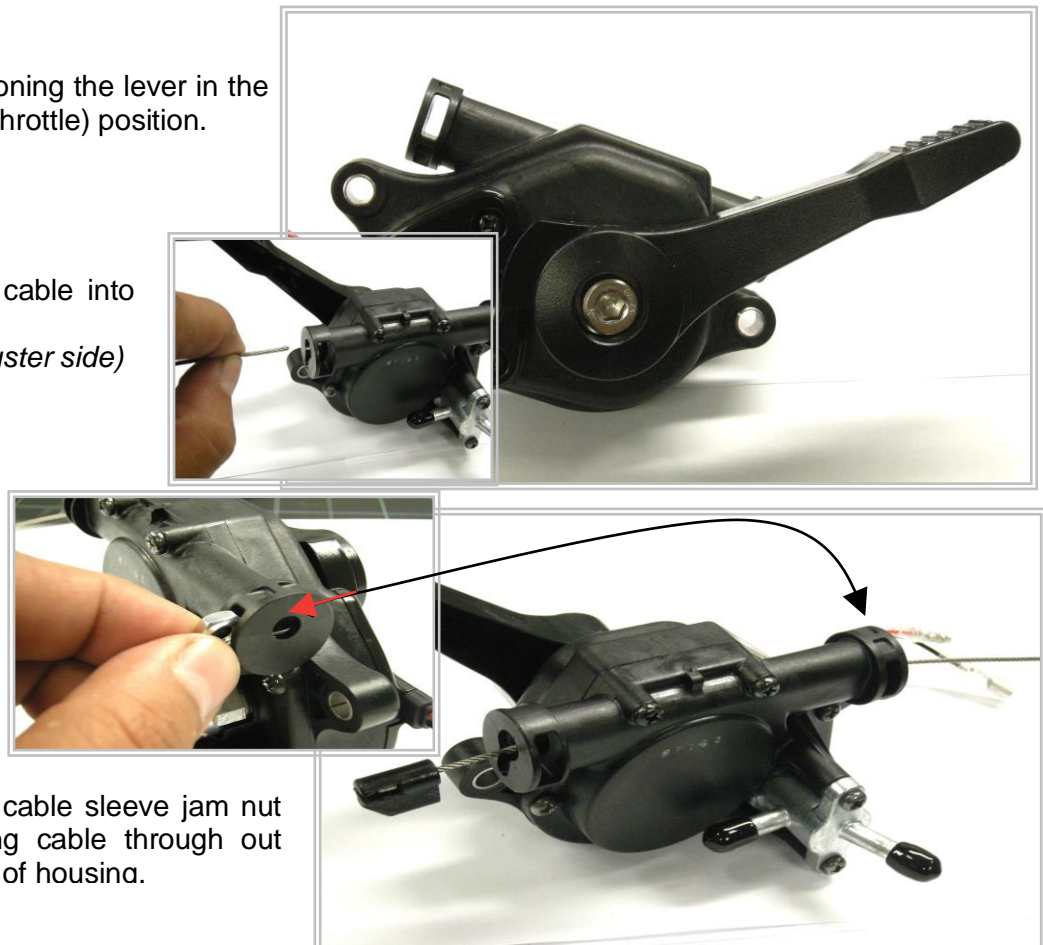

Insert throttle cable sleeve jam nut before pushing cable through out the other side of housing.

After pushing cable and slider in to the housing, install jam nut and throttle adjuster.



Throttle adjuster.

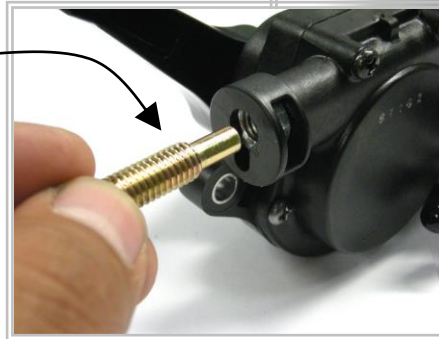

Install outer jam nut to lock in place. Adjusting can be made later when attached to machine.

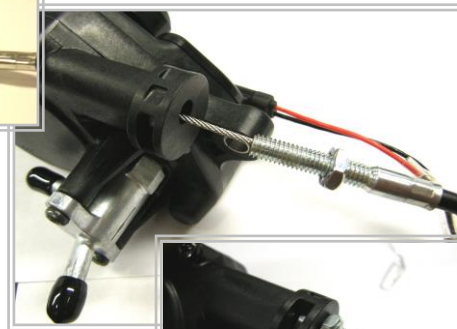
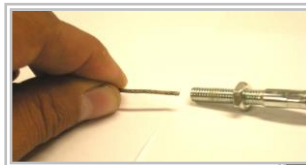
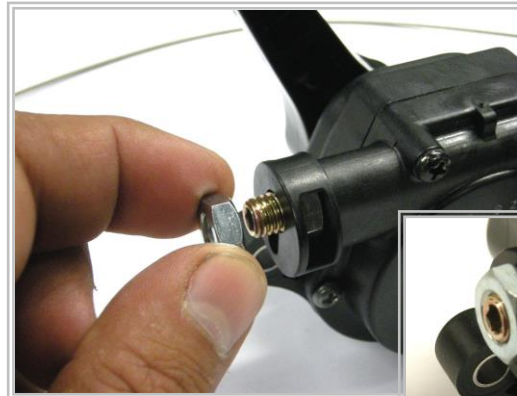

Insert throttle cable in the throttle cable sleeve. Pull sleeve up to housing and connect with earlier installed jam nut. Tighten outer jam nut to lock in place.





This bulletin is provided for technical reference and service related updates. If you have any questions, comments or do not wish to receive these e-mails, please reply to this e-mail or call the Service Technical Support Group 800 478-1244.

Rubber boot end caps. Notice the marking on the cap, this mark is positioned on top when installed.

