

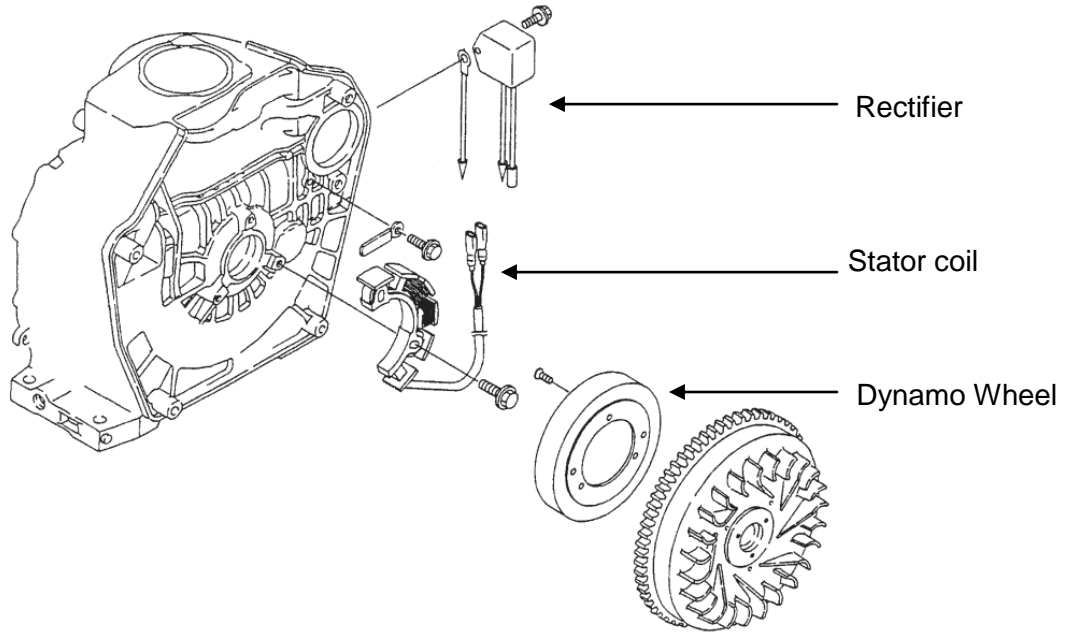

This bulletin is provided for technical reference and service related updates. If you have any questions, comments or do not wish to receive these e-mails, please reply to this e-mail or call the Service Technical Support Group 800 478-1244.

## CHARGING SYSTEM

This documentation can be used as guide when inspecting and diagnosing the electrical charging system.



### CHARGING SYSTEM PART#s

- |   |                             |
|---|-----------------------------|
| 1. Dynamo Assembly: (Stator & Dynamo wheel) | <b>MQ PART# 11435178251</b> |
| 2. Rectifier                                | <b>MQ PART# 16097077350</b> |
| 3. Stator (COIL)                            | <b>MQ PART# 11435178751</b> |
| 4. Dynamo wheel (ROTOR)                     | <b>MQ PART# 11435178761</b> |

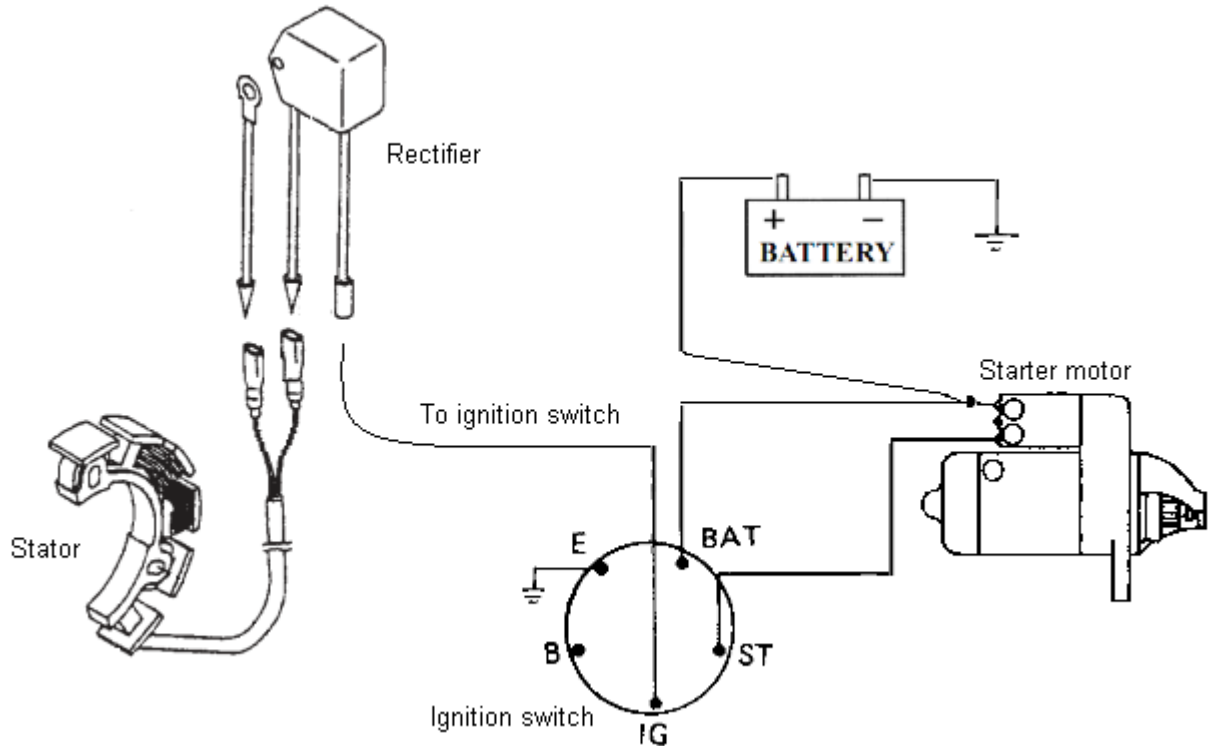

### ELECTRICAL DATA

Stator output.....30.3V AC  
 Rectifier output (battery charging voltage).....13V DC

### STATOR CONTINUITY TEST

If continuity is not detected ( $\infty \Omega$ ) between the stator wires, replace the stator.

### RECTIFIER CONTINUITY TEST

A good rectifier will test no continuity in one direction and continuity in the opposite direction.

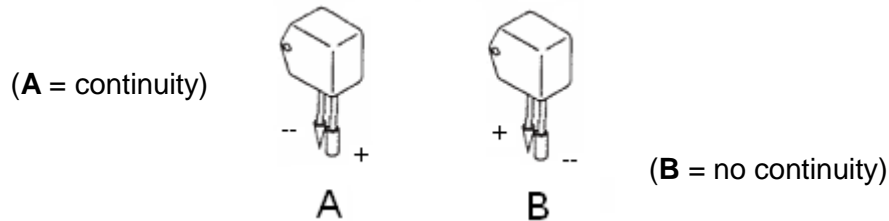

### ADDITIONAL PART#s

- |                    |                                    |
|--------------------|------------------------------------|
| 6. Battery         | <b>MQ PART# 955010020</b>          |
| 7. Wire harness    | call MQ PARTS DEPT. (800) 427-1244 |
| 8. Ignition switch | <b>MQ PART# 457333310</b>          |
| 9. Starter         | <b>MQ PART# 11436277011</b>        |