



# QPT405SLT

MULTIQUIP® 4" High Pressure Pump

## GALLONS PER MINUTE

**210 (795 L)**

## HEAD

**377 ft (115 M)**

## ENGINE

**Honda GX390**



## APPLICATIONS

Agricultural - Construction Sites - Emergency Response - Excavation - Farms - Floods - Irrigation - Jobsite - Drainage - Mining - Municipalities - Standing Water - Swimming Pools - Quarries - Water Departments - Water Supply from Lakes/Rivers

## STANDARD FEATURES

- Maximum pumping capacity of **210 gallons (795 liters) per minute.**
- Maximum lift of **25 feet (7.6 meters).**
- Aluminum body and cast-iron fittings.
- High-Efficiency impeller and volute for maximum fluid transfer.
- Closed sand-cast aluminum impeller and volute for **extreme high-pressure performance.**
- Silicon carbide mechanical seal provides **extreme abrasion resistance** and **high temperature operation.**
- **3-way discharge ports** can be used independently or simultaneously depending on the application.
- 1" (25.4 mm) diameter fill and drain ports.
- Engine oil-alert to protect the engine in the case of low engine oil.
- Trusted 11.7HP **Honda GX390** gasoline engine.
- Heavy-duty **1.07" (27.2 mm) tubular steel frame** for transportation and pump protection.

## WARRANTY\*

QPT405SLT: 24 months from date of purchase.

Honda GX390 Engine: 36 months from date of purchase.

Hoses: 3 months from date of purchase.

\*Refer to the MULTIQUIP NEW PRODUCT LIMITED WARRANTY FOR FULL TERMS AND CONDITIONS.

## FEATURES

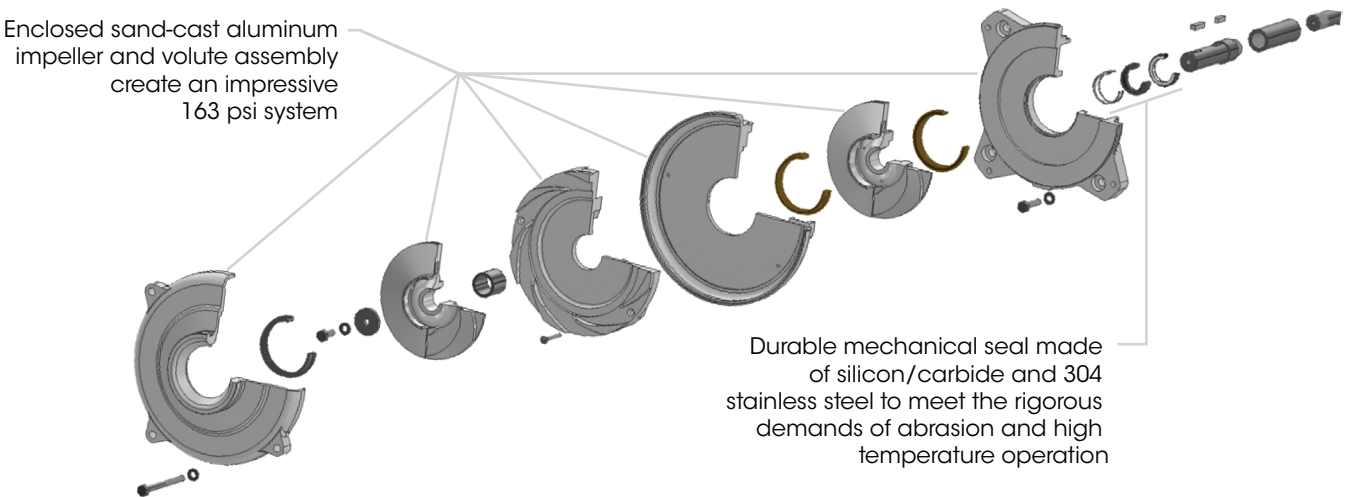
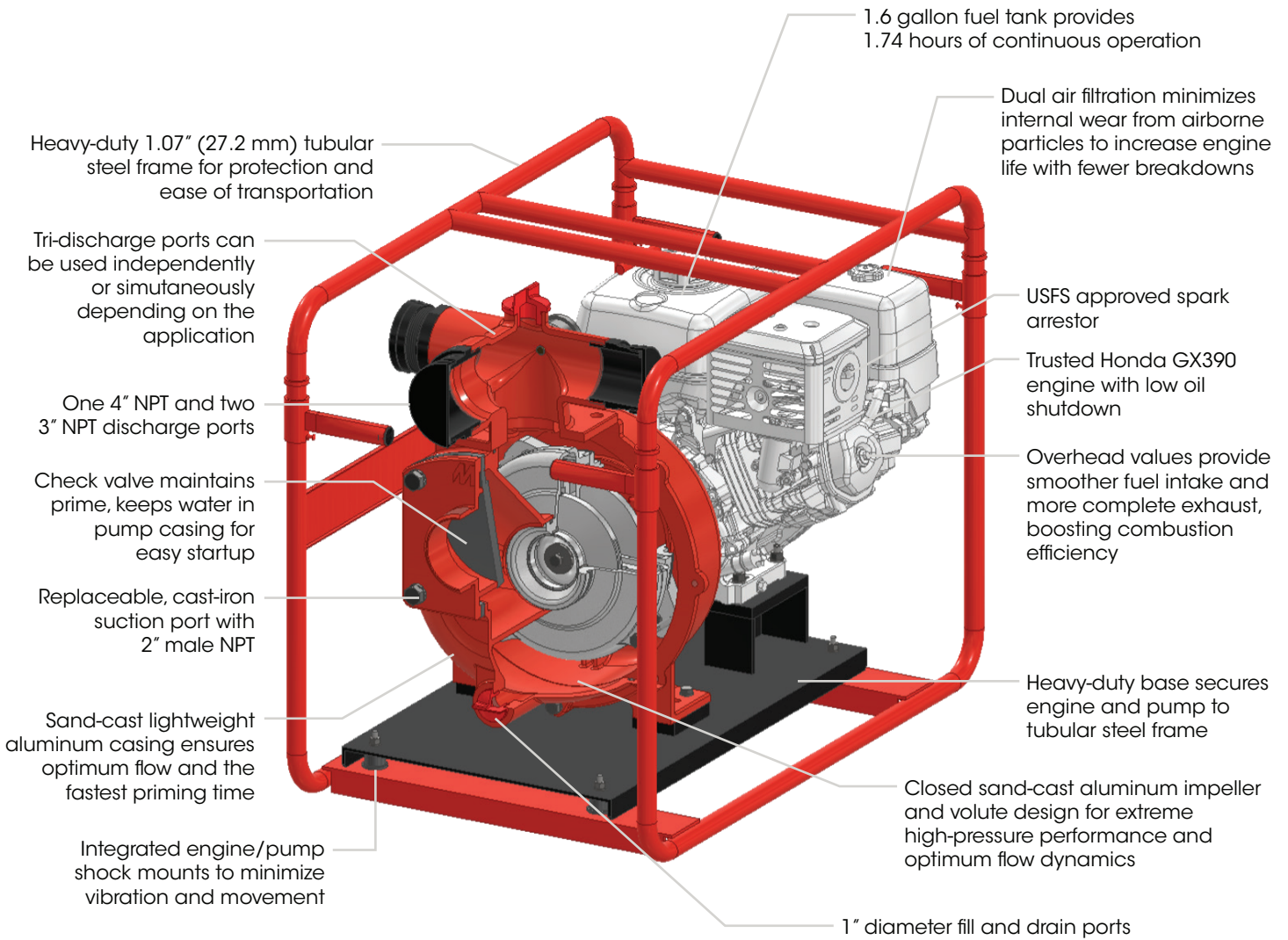

© COPYRIGHT 2026 MULTIQUIP INC. (REV 04012026)

## PUMP CURVE

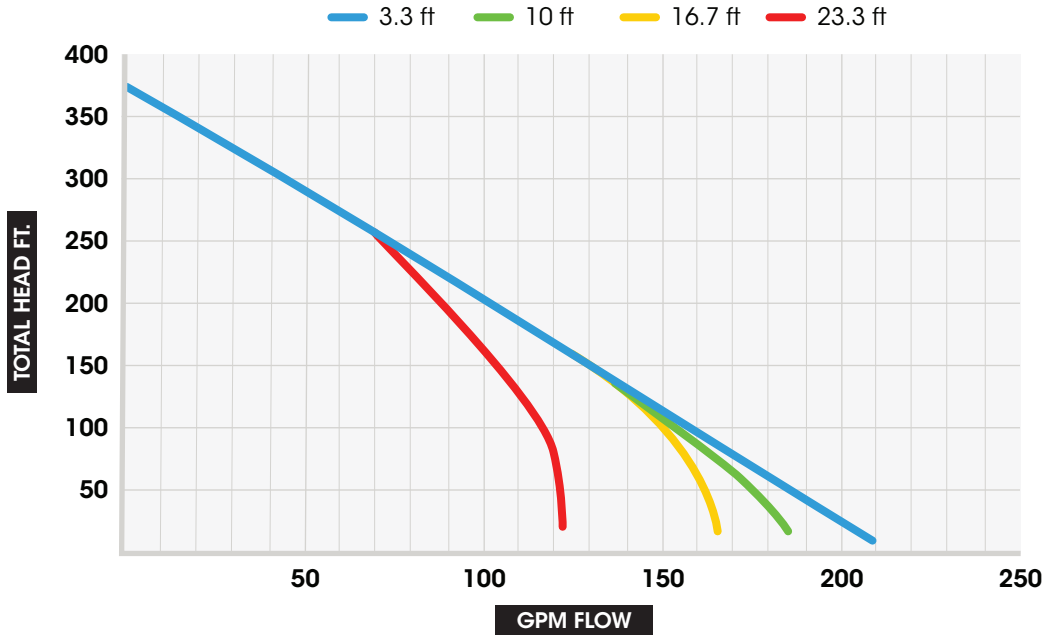

## PUMP DIMENSIONS

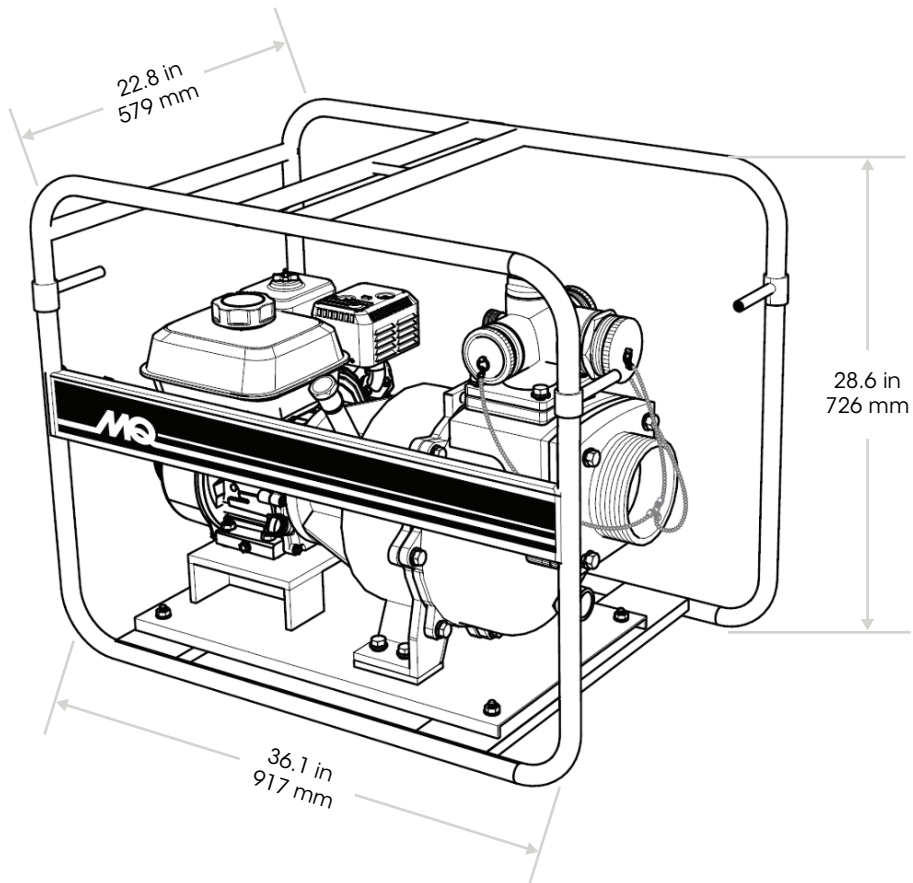

## SPECIFICATIONS

PUMP SPECIFICATIONS	
MODEL	QPT405SLT
TYPE	CENTRIFUGAL HIGH-PRESSURE PUMP
IMPELLER TYPE	DOUBLE CLOSED
MAX. PUMP CAPACITY	210 GALLONS/MINUTE (795 L/MIN)
MAX. SUCTION	25 ft (7.62 M)
MAX. HEAD	377.3 ft (115 M)
SUCTION PORT SIZE	4 in (100 mm)
DISCHARGE PORT SIZE	1 x 4 in (100 mm) 2 x 3 in (80 mm)
THREAD TYPE	NPT (MALE)
PSI	163
IMPELLER MATERIAL	SAND-CAST ALUMINUM
VOLUTE MATERIAL	SAND-CAST ALUMINUM
PUMP CASING MATERIAL	SAND-CAST ALUMINUM
CHECK VALVE MATERIAL	NITRILE BUTADIENE RUBBER
MECHANICAL SEAL MATERIAL	SILICON/CARBON 304 STAINLESS STEEL
DRAIN AND FILL CAP MATERIAL	ACRYLONITRILE BUTADIENE STYRENE
SALT OR CHEMICALS	NO
PUMP HARDWARE	STAINLESS STEEL
MAX. FLUID TEMPERATURE	104° F (40° C)
MAX. SOLID HANDLING	0.18 in (4.5 mm)
O-RINGS	NITRILE BUTADIENE RUBBER
STRAINER SIZE	4 in (100 mm) NPT
STRAINER INLET SIZE	0.16 in (4 mm)

ENGINE SPECIFICATIONS	
MAKE/MODEL	HONDA/GX390
EMISSIONS	EPA CERTIFIED AND CARB PREEMPT
STARTING METHOD	RECOIL START
DESIGN	AIR-COOLED, 4 STROKE, SINGLE CYLINDER, OHV, HORIZONTAL SHAFT
DISPLACEMENT	389 CC (23.7 CU-IN)
BORE X STROKE	3.46 x 2.52 in (88 x 64 mm)
HORSE POWER (kW)	11.7 (8.7)
ENGINE SPEED	3,600 RPM
GOVERNOR SPEED	MECHANICAL
SOUND LEVEL dB(A) AT 23 FT	77
AIR CLEANER	DUAL ELEMENT
LUBRICATION SYSTEM	SPLASH
SPARK ARRESTOR	STANDARD
OIL CAPACITY	1.16 QUARTS (1.10 LITERS)
OIL TYPE	SAE 10W-30
LOW OIL SHUT-DOWN	STANDARD

FUEL SPECIFICATIONS	
RECOMMENDED FUEL	UNLEADED GASOLINE
FUEL TANK CAPACITY	1.6 GALLONS (6.1 L)
FUEL CONSUMPTION	0.92 GPH (3.5 LPH)
RUN TIME	1.74 HOURS

WEIGHT AND DIMENSIONS	
DRY WEIGHT	273.4 lb (124 kg)
DIMENSIONS	36.1 x 22.8 x 28.6 in (917 x 579 x 726 mm)

**NOTICE** Features and Specifications are subject to change without notice.

## OPTIONS

### SUCTION HOSES

- **HS420C** - 4" x 20 ft., 65psi, rigid PVC helix reinforced, NPS thread
- **HSQ420C** - 4" x 20 ft., 65psi, rigid PVC helix reinforced, NPT thread, Male Camlock, includes one quick disconnect coupler
- **HS425C** - 4" x 25 ft., 65psi, rigid PVC helix reinforced, NPS thread
- **HSQ425C** - 4" x 25 ft., 65psi, rigid PVC helix reinforced, NPT thread, Male Camlock, includes one quick disconnect coupler
- **A400A** - 4" type A coupler, male quick disconnect x female NPT



HS420C and HS425C

HSQ420C and HSQ425C

### DISCHARGE HOSES

- **FIRENOZ15** - 1.5" nozzle, NPT thread
- **HDFNST** - 2.5" x 25 ft., 150psi, NPT thread, includes one quick disconnect coupler
- **A150A** - 1.5" type A coupler, male quick disconnect x female NPT



FIRENOZ15

HDFNST

A150A

### FILTER KIT

- **MKITPUMP-8** - (1) Air cleaner element, (1) spark plug, (2) flooding caps, (2) drain caps



### WHEEL KIT

- **UWK4** - Wheel kit with folding handles and flat free tires for easy transport