

TRAVEL ADJUSTMENT

This document is to assist with troubleshooting if the unit creeps while in the neutral position.

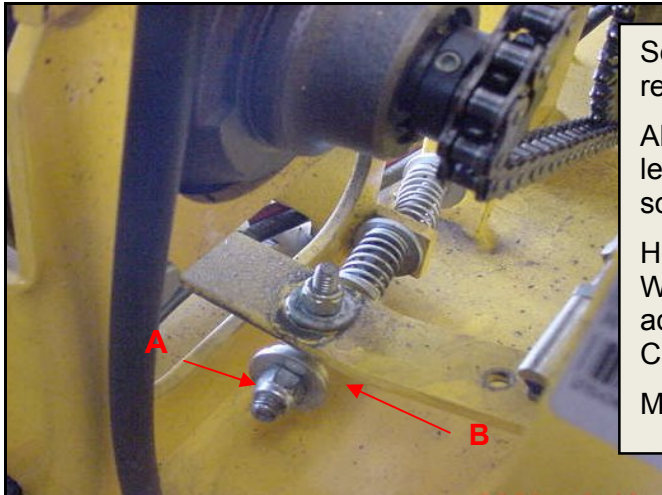

Set the travel lever in the neutral position and remove nylon nut "A".

Allow engine to run at idle slowly move the travel lever to the reverse position. Stop the lever as soon as the unit starts to barely move.

Hold travel lever firmly and turn engine off. Without disturbing setting of linkage and shift rod, add 2 more washers to the shift rod at point "B". Carefully replace nylon nut.

Move travel lever back to the neutral position.

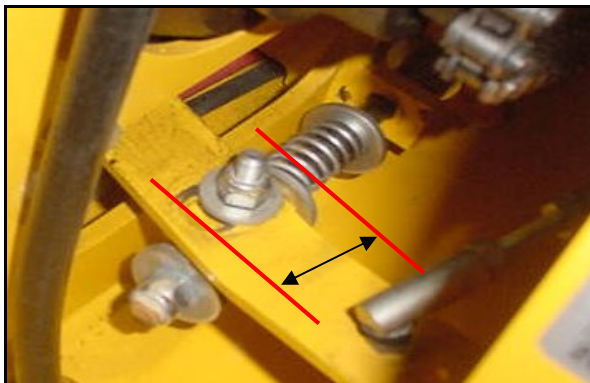

Check the position of the stud bolt inside the slot. If it is not in the center of the slot, remove the link arm from the bracket



The two bolts shown in this picture are not to be tightened completely. They are supposed to fit loose. The entire linkage assembly needs to be free flowing. If there is any binding on any of the shifting parts it will be very difficult to stop the creeping.

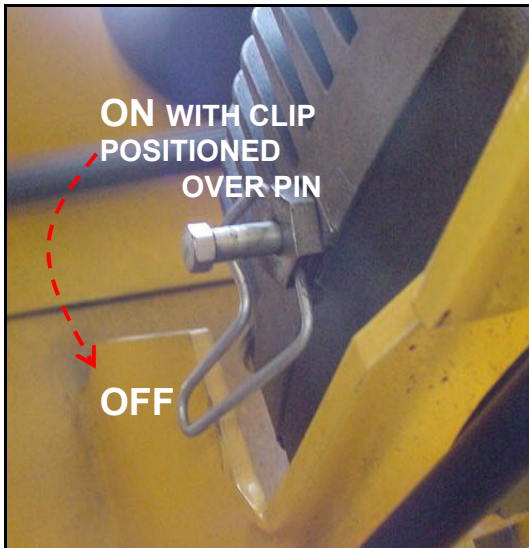

1. A unit with slow speed may be the result of the tow valve being locked in the tow position. Make sure the locking clip located on the side of the transmission is in the off position.

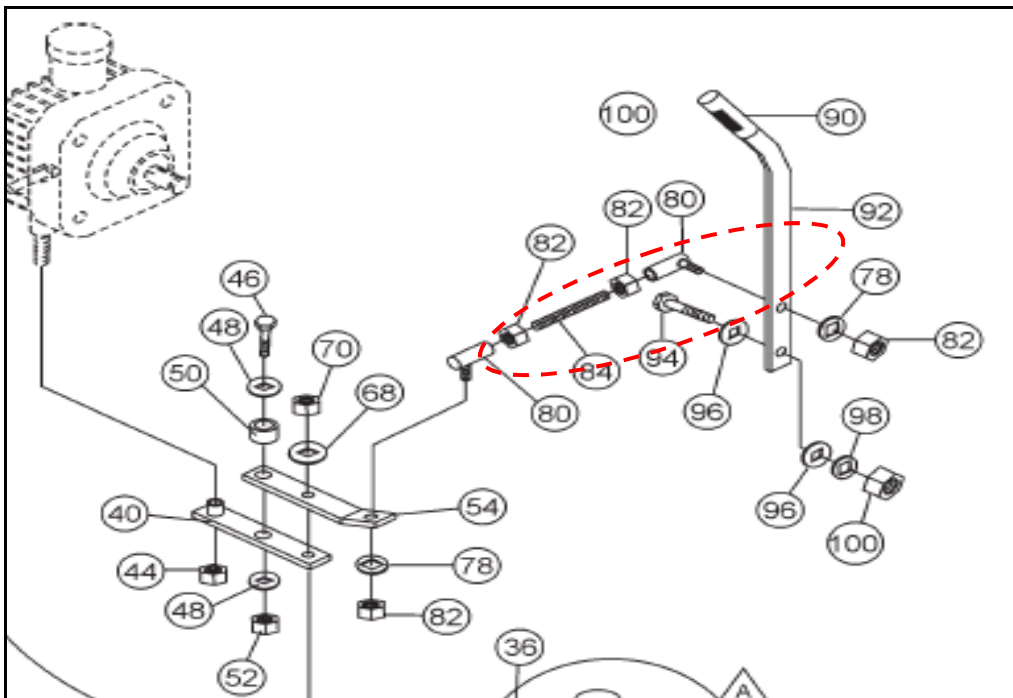

2. Make sure engine high rpms are set at 3600.

3. Travel speed is rated at 5.5 mph. and is the same in both directions. Make speed adjustment at the ball joint connecting rod item # 84. Loosen jam nuts and turn threaded rod to rated speed. Do not make speed adjustments at any other point.