

AIR FILTRATION KIT

The RX1575 series roller has released a production change on the air cleaner system. This system comes with double air filtration (figure A) as well as a rubber dust cleaner (figure B) to improve the air filtration capacity of the machine.

Beginning production **S/N 5570002** with T4F engines are equipped with this new air filtration system.

This enhancement can be retrofitted on existing RX1575 starting from **S/N 5570001** and below or if the roller has a 5 digit serial # that begins with **6 ******.



figure A



figure B

Retrofit Kit MQ Part # **4-10692058**

Item #	Description	Part #	Qty.
1	Air Filter	1300278	1
2	Air Filter Holder	1299659	1
3	M8 Nut	J902124	2
4	Locking washer	1-952116	4
5	Bolt 8X20	J901763	2
6	Holder	1307345	1
7	Pressed-in nut	J908446	2
8	Cable Tie	4-6150051016	2
9	Cable Tie	1278953	5
10	Bolt M10X35	1308433	2
11	Bolt M10X35	1308433	2
12	Nut M10	1283693	2

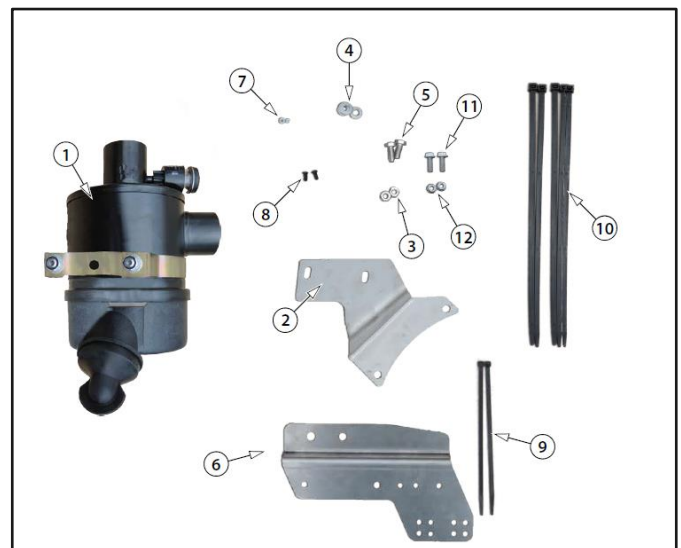

See next page for installation instructions of the retrofit kit.



SAFETY FIRST! Installation should be performed by qualified technicians. Do not operate or service the equipment before reading the operations manual. Safety precautions should be followed at all times!

- Lift the engine hood to gain access to the air filter assembly.
- Remove air suction hoses (E) and (F) from the air filter

E

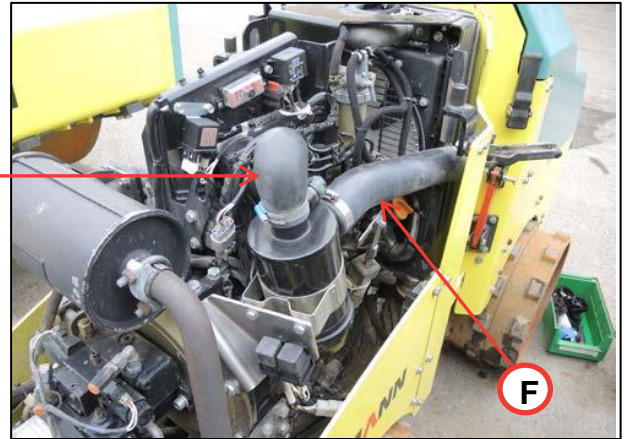

- Install a protective cover to prevent dust from entering the intake. Carefully wipe clean the intake port for any signs of dirt.



- Remove the relay (A) from the socket (B)

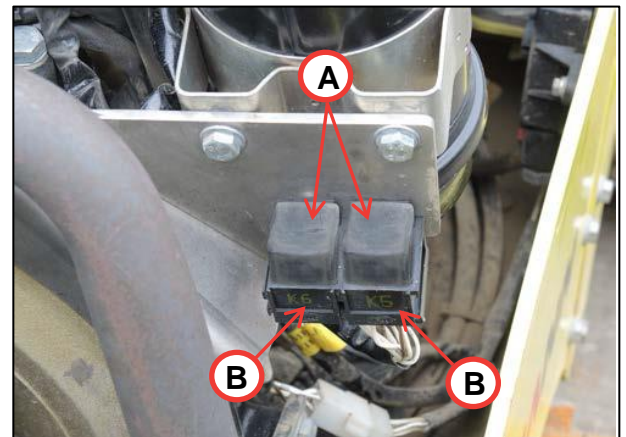

- Remove the sockets (B) from the air filter holder (C).

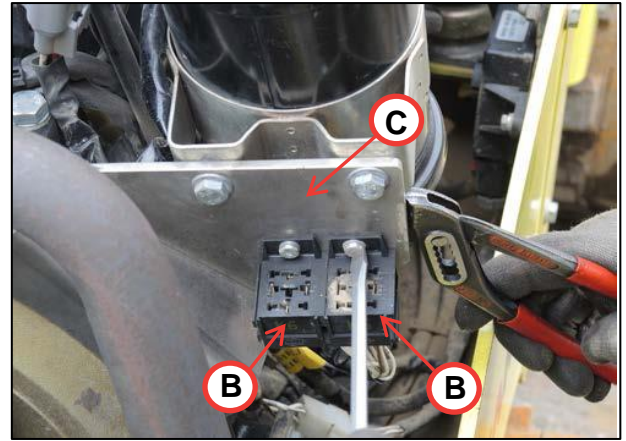

- Remove the holder (C) with air filter from the engine block.



- Press the nuts (7) onto the holder (6) using a hammer.

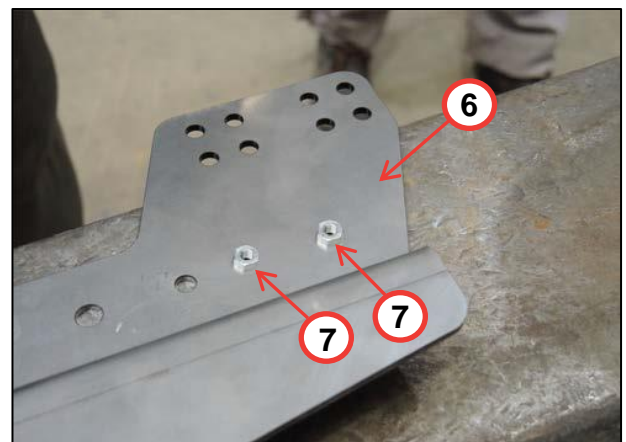

This bulletin is provided for technical reference and service related updates. If you have any questions, comments or do not wish to receive these e-mails, please reply to this e-mail or call the Service Technical Support Group 800 478-1244.

- Mount the holder (6) on the machine frame using screws (11) and nuts (12).



- Cut insulation of the cable harnesses for easier handling.



- Install the removed relay sockets (B) on the holder (6). Clean the bolts and bond them using Loctite 243.

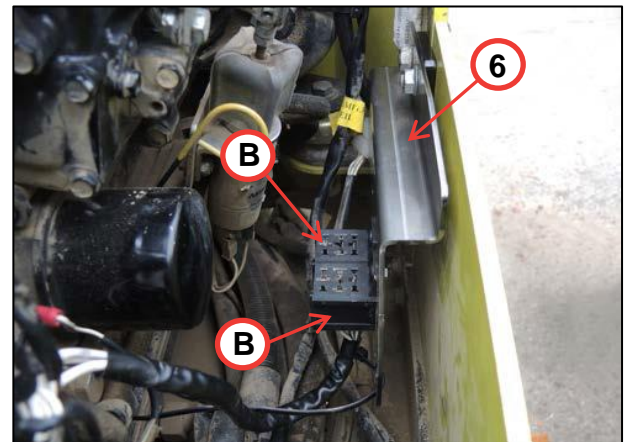

- Install the relays (A) back into the socket (B)

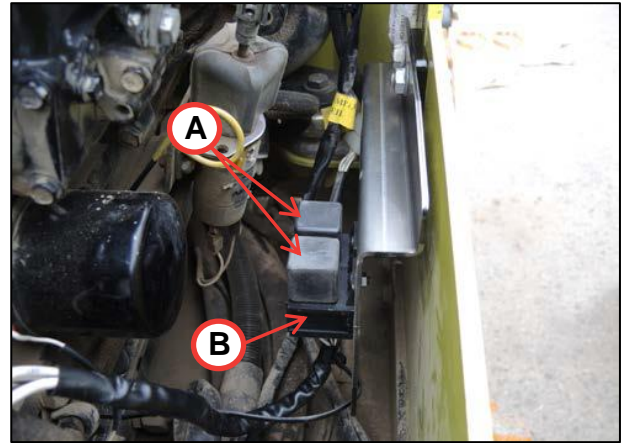

- Insulate the cable harnesses using an electrical tape and secure them using cable ties (10).

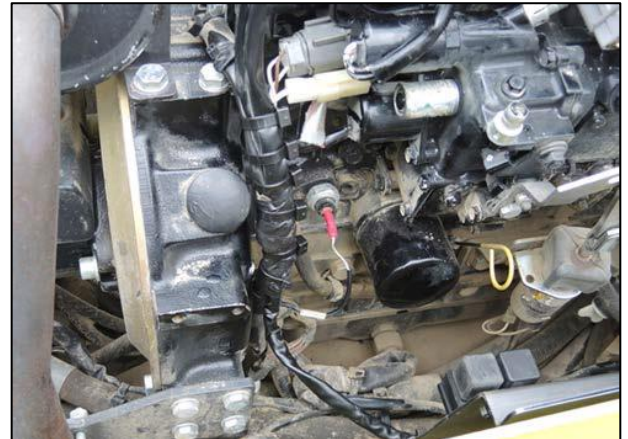

- Install air filter (1) on the holder (2) using a sleeve.

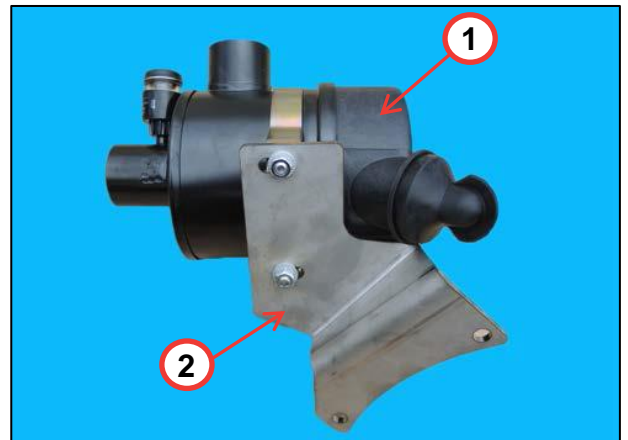

This bulletin is provided for technical reference and service related updates. If you have any questions, comments or do not wish to receive these e-mails, please reply to this e-mail or call the Service Technical Support Group 800 478-1244.

- Install the holder (2) with air filter (1) on the engine block. Clean the bolts and bond them using Loctite 243.

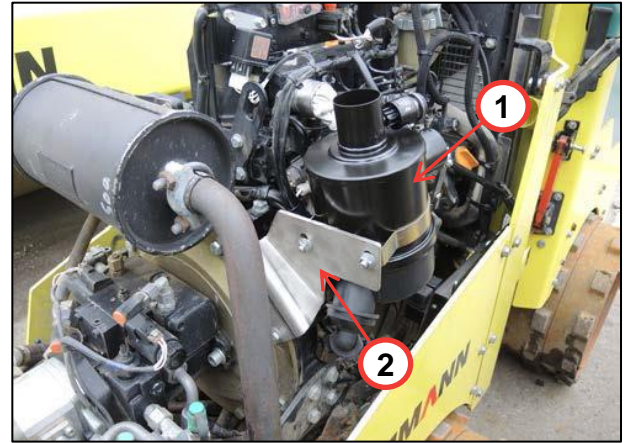

- Remove the protective cover from the intake ports.



- Reinstall the air suction hose (E).

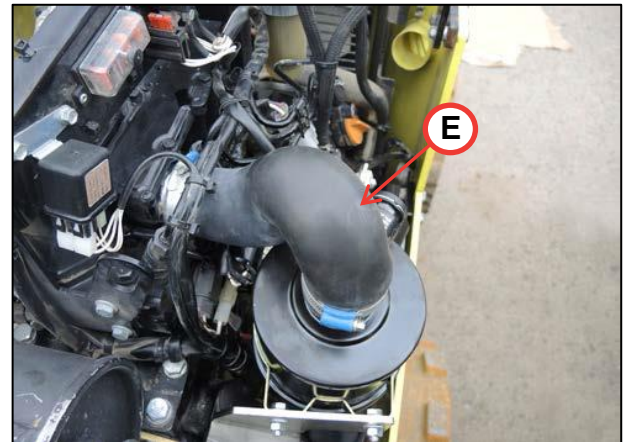

- Shorten the air suction hose (F) by 15mm.



- Install the air suction hose (F).
- Start the machine and check for leaks in the air suction circuit of the engine.

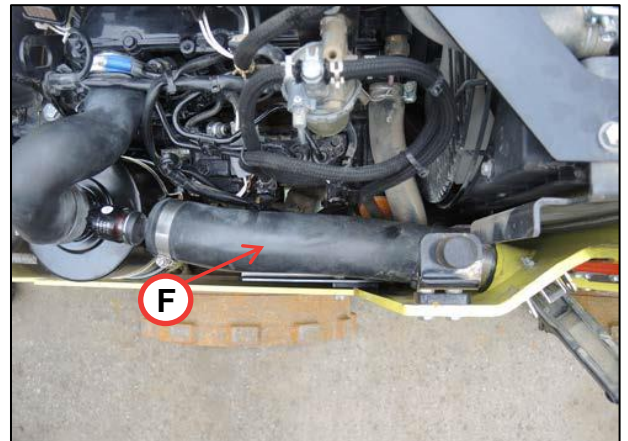

	Torque			
	For 8,8 (8G) bolts		For 10,9 (10K) bolts	
Thread	Nm	lb ft	Nm	lb ft
M6	10	7,4	14	10,3
M8	24	25,0	34	25,0
M8x1	19	14,0	27	19,9
M10	48	35,4	67	49,4
M10x1,25	38	28,0	54	39,8
M12	83	61,2	117	86,2
M12x1,25	66	48,7	94	69,3
M14	132	97,3	185	136,4
M14x1,5	106	78,2	148	109,1
M16	200	147,5	285	210,2
M16x1,5	160	118	228	168,1
M18	275	202,8	390	287,6

	Torque			
	For 8,8 (8G) bolts		For 10,9 (10K) bolts	
Thread	Nm	lb ft	Nm	lb ft
M18X1,5	220	162,2	312	230,1
M20	390	287,6	550	405,6
M20x1,5	312	230,1	440	324,5
M22	530	390,9	745	549,4
M22x1,5	425	313,4	590	435,1
M24	675	497,8	950	700,6
M24x2	540	398,2	760	560,5
M27	995	733,8	1400	1032,5
M27x2	795	586,3	1120	826,0
M30	1350	995,7	1900	1401,3
M30x2	1080	796,5	1520	1121,0