



Service Bulletin

STX6H Relief Valve Cartridge Replacement

Product Group: Ride-On Trowels	Date Issued: 9/5/17	Expiration Date: 9/5/18	Service Bulletin No. TR20170810
Bulletin Type <input checked="" type="checkbox"/> Mandatory <input type="checkbox"/> Information Only <input type="checkbox"/> Recommended Change		Models/Series Affected: STX6H S/N PK2003364 – NE2003524	

Details

Problem:

Existing relief valve cartridges have incorrect pressure settings.

Solution:

Install new relief valve cartridges that have correct pressure settings.

Parts Information

Item No.	Part No.	Description	QTY.	Remarks
1	42611-1	Cartridge, Relief Valve	2	

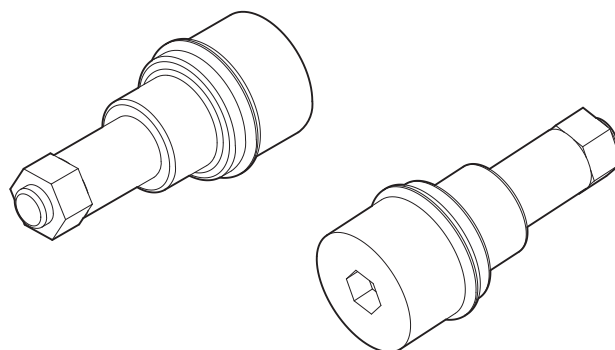

Figure 1. Relief Valve Cartridges

WORK SAFELY!

Only a qualified service technician with proper training should perform this procedure. Follow all shop safety rules while performing this procedure.

PREPARATION

1. Make sure the trowel is turned off and **the engine is cool**.
2. Place the trowel in an area free of dirt and debris, and make sure it is on secure level ground.

REQUIRED TOOLS

- 5/16" Socket
- 1-1/4" Wrench or Socket

TROWEL SAFETY

CAUTION

- **NEVER** lubricate components or attempt service on a running machine.

ENGINE SAFETY

WARNING

- **NEVER** place hands or fingers inside the engine compartment while the engine is running.

CAUTION

- **NEVER** touch the **hot** exhaust manifold, muffler, or cylinder. Allow these parts to cool before servicing the equipment.



BATTERY SAFETY

DANGER

- **DO NOT** expose the battery to open flames, sparks, cigarettes, etc. The battery contains combustible fluids. If these fluids come into contact with a flame or spark, an explosion can occur.

CAUTION

- **ALWAYS** disconnect the **NEGATIVE** battery terminal before servicing the equipment.

BATTERY DISCONNECTION

1. Remove and set aside the **LEFT** grill guard to gain access to the battery (Figure 2).

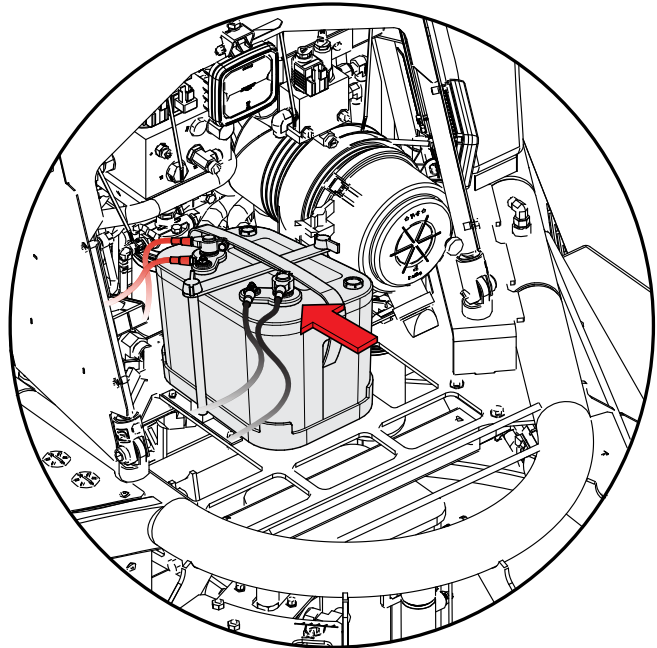

Figure 2. Battery Disconnection

2. Disconnect the two negative (**BLACK**) cables from the negative terminal on the battery. See Figure 2.

FOOT PLATFORM REMOVAL

1. Using a 5/16" socket, remove and set aside the 15 screws securing the foot platform to the frame (Figure 3).

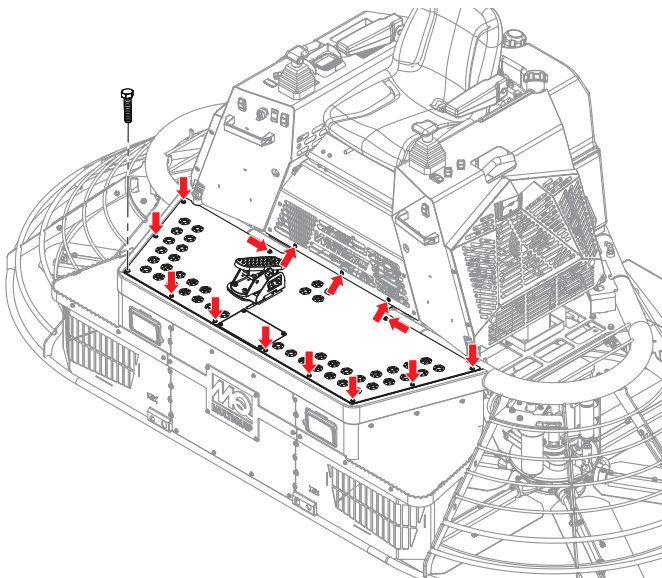

Figure 3. Foot Platform Hardware Removal

2. Remove the foot platform and set it **in front** of the trowel as shown in Figure 4. **DO NOT** disconnect or remove the foot pedal sensor cable.

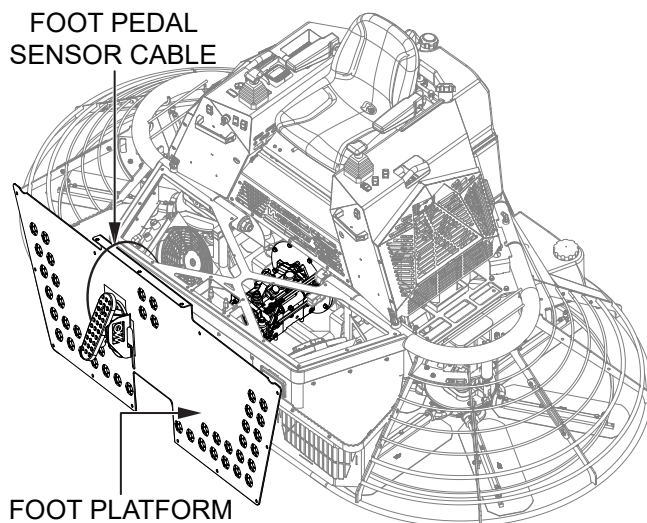

Figure 4. Foot Platform Removal

NOTICE

MAKE SURE the foot pedal sensor cable remains **connected**. Disconnection of this cable will cause an electrical fault.

RELIEF VALVE CARTRIDGE REPLACEMENT

1. Locate the two relief valve cartridges (Figure 5) on top of the pump assembly.

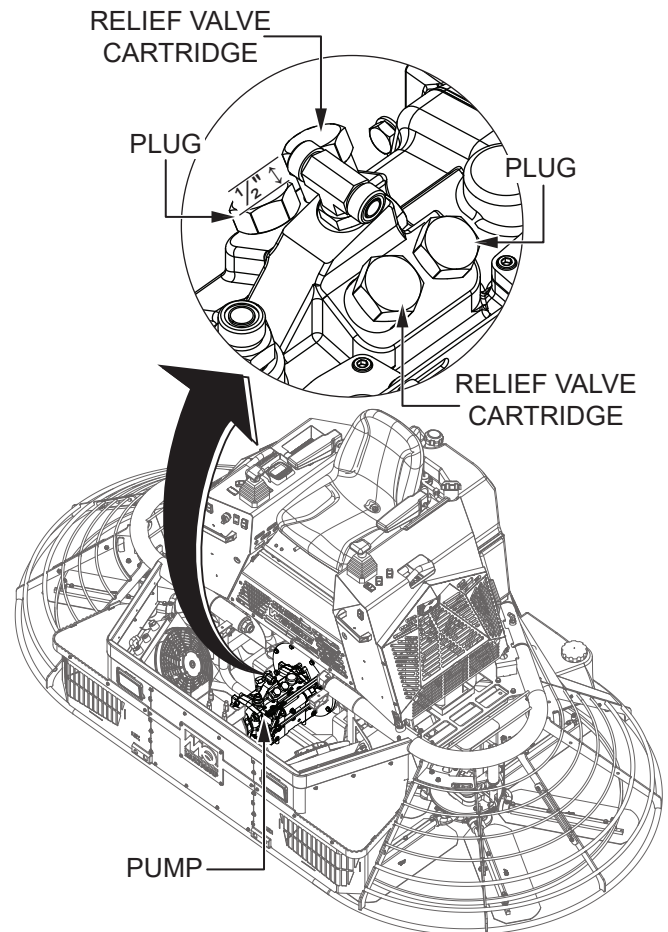

Figure 5. Relief Valve Cartridge Location

NOTICE

Each relief valve cartridge sits next to a plug that is nearly identical to it. **DO NOT remove these plugs!** The relief valve cartridges to be removed are approximately 1/2-inch longer than the plugs sitting next to them. See Figure 5.

2. Using a 1-1/4" wrench or socket, remove and discard both relief valve cartridges (Figure 6A).

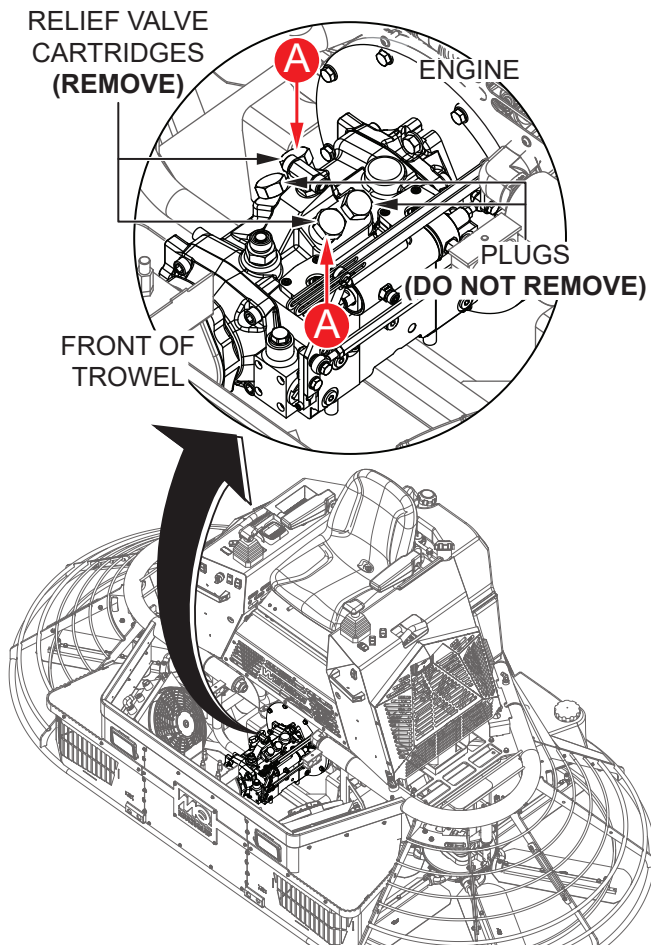

Figure 6. Relief Valve Cartridge Removal

3. Insert the two new relief valve cartridges (P/N 42611-1) into the pump and torque them each to 60 ft-lb (81.35 N·m). See Figure 7.

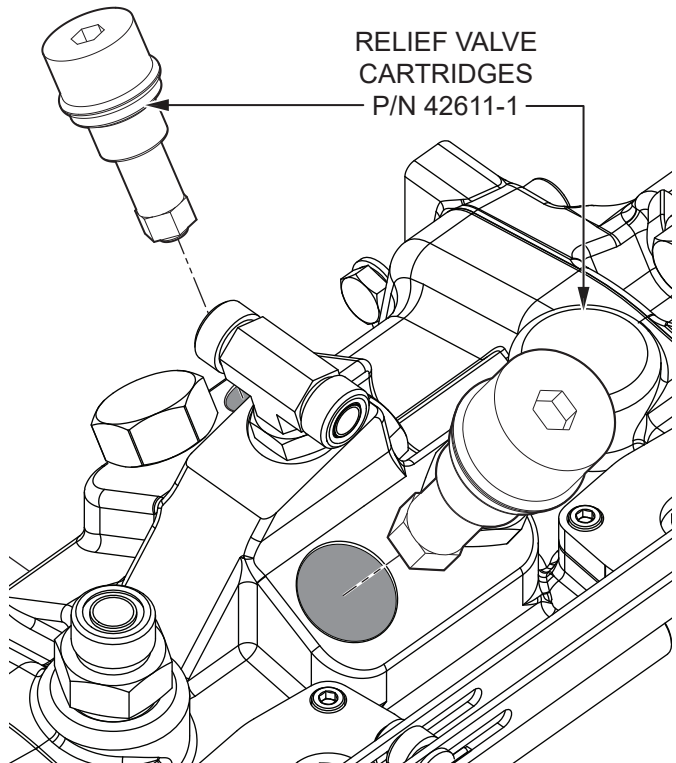

Figure 7. Relief Valve Cartridge Installation

TESTING AND REASSEMBLY

1. Reinstall the foot platform with the hardware that was removed earlier.
2. Reconnect the negative (**BLACK**) battery cables.
3. Start the engine according to the instructions found in the STX6H operation manual. Allow the engine to run for a few minutes, and make sure there are no leaks.

NOTES

[illegible]



Service Bulletin

STX6H Relief Valve Cartridge Replacement

HERE'S HOW TO GET HELP

PLEASE HAVE THE MODEL AND SERIAL
NUMBER ON-HAND WHEN CALLING

UNITED STATES

MultiQuip Corporate Office

18910 Wilmington Ave. Tel. (800) 421-1244
Carson, CA 90746 Fax (310) 537-3927
Contact: mq@multiquip.com

Service Department

800-421-1244
310-537-3700

Technical Assistance

800-478-1244 Fax: 310-943-2238

MQ Parts Department

800-427-1244 Fax: 800-672-7877
310-537-3700

Warranty Department

800-421-1244 Fax: 310-943-2249
310-537-3700

CANADA

MultiQuip

4110 Industriel Boul. Tel: (450) 625-2244
Laval, Quebec, Canada H7L 6V3 Tel: (877) 963-4411
Contact: infocanda@multiquip.com Fax: (450) 625-8664

UNITED KINGDOM

MultiQuip (UK) Limited Head Office

Unit 2, Northpoint Industrial Estate, Tel: 0161 339 2223
Globe Lane, Fax: 0161 339 3226
Dukinfield, Cheshire SK16 4UJ
Contact: sales@multiquip.co.uk

© COPYRIGHT 2017, MULTIQUIP INC.

MultiQuip Inc and the MQ logo are registered trademarks of MultiQuip Inc. and may not be used, reproduced, or altered without written permission. All other trademarks are the property of their respective owners and used with permission.

The information and specifications included in this publication were in effect at the time of approval for printing. Illustrations, descriptions, references and technical data contained in this document are for guidance only and may not be considered as binding. MultiQuip Inc. reserves the right to discontinue or change specifications, design or the information published in this publication at any time without notice and without incurring any obligations.

Your Local Dealer is:

