

FAN BELT INSPECTION & ADJUSTMENT

This documentation outlines the inspection procedure and adjustment for the MSG-425 Ford industrial engine fan belt. Drive belt system should be inspected every 200 hours.

INSPECTION

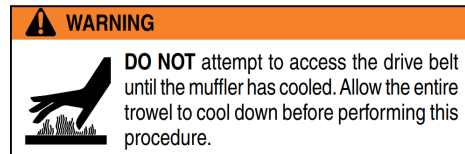
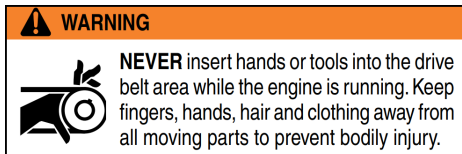

Drive belt squeal that is short and intermittent is expected and considered normal. Constant or reoccurring drive belt squeal can occur with a damaged pulley bearing, fluid contamination, or a loose belt. Running condition for engine coolant temperature may increase with loose belt.

Also check for belt misalignment which can cause a chirping noise. If misalignment is found, check the tensioner for damage, especially the mounting pad surface. Check for a damaged pulley that wobbles. Check mounting brackets for tightness and for any interference.

With belt off, check that all pulleys rotate freely without binding.

Note: The fan belt should have some deflection in it when pressure is applied from the side. Using a belt tensioner gauge a reading of 95 - 100 lbs. is recommended.

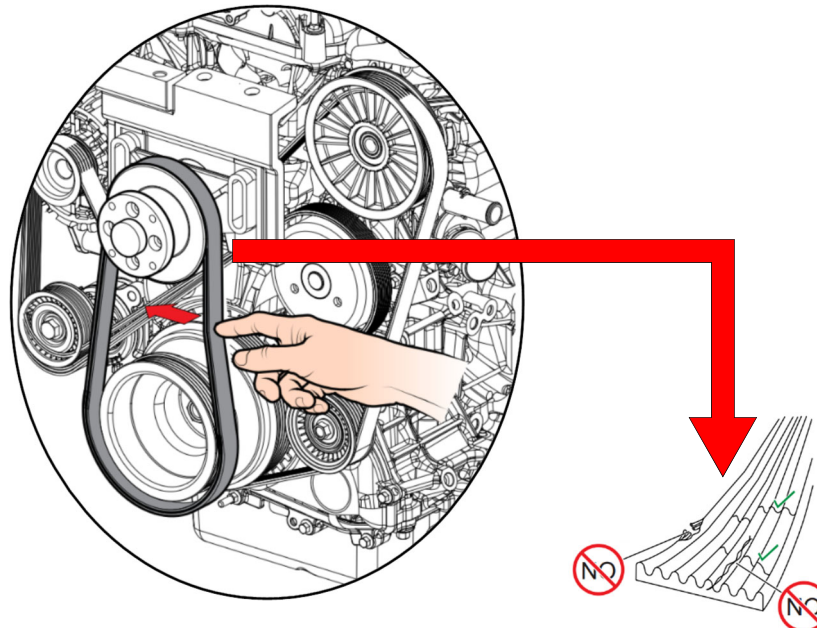

ADJUSTMENT

1. Remove negative battery cable.
2. Loosen M8x1.5 fan bearing bracket bolts so the bracket can slide down.
3. Place ratchet strap around fan pulley shaft and then secure it to a hoist or overhead beam.
4. Slowly ratchet allowing the bearing bracket to slide up evenly to tension the fan belt.
5. With the belt tensioned tighten the bearing bracket bolts 21 lb-ft (28Nm)
6. Install negative battery cable

Note: The fan belt should have some deflection in it when pressure is applied from the side. Using a belt tensioner gauge a reading of 95 -100 lbs. is recommended.

CAUTION: Incorrect fan belt installation will cause excessive drive belt wear and can cause the belt to come off the pulleys.

