

IMPORTANT UPDATE — IMMEDIATE ACTION REQUIRED!

Date: 02/06/23
To: MQ Power Trailer-Mounted Generator Owners
From: MQ Power Product Department
Subject: Fuel Level Sender Replacement



Dear Multiquip Customer,

Our records indicate that your company purchased one or more MQ Power DCA400SSI4F Series generators mounted on a TRLR400XF3DAE trailer. Some trailers were equipped with incorrect fuel level senders.

WARNING! Some fuel senders display inaccurate fuel levels that do not reflect the actual remaining/available fuel within the 350-gallon fuel system.

This can lead to premature low fuel warnings and/or low fuel shutdowns of your trailer-mounted DCA400SSI4F Series generator. The accompanying bulletin explains the corrective action required.

A list of affected generators is provided in the Service Bulletin. If these generators have been resold, please forward this bulletin to the new owner.

Your prompt attention to this matter is appreciated. If you have questions, please contact the Multiquip Technical Support Department at 800-478-1244 or techsupport@multiquip.com.

WARRANTY INFORMATION

Campaign: Reference No. TL20221221

File your claim online via E-Warranty at <http://service.multiquip.com/warranty-support.html> or contact our warranty department for assistance at 800-421-1244.

Labor Allowance: 0.5 hour total flat rate for fuel sender replacement.



Service Bulletin

TRLR400XF3DAE Fuel Sender Replacement

Product Group:	Date Issued:	Expiration Date:	Bulletin No.
Trailers	02/06/23	02/06/24	TL20221221

Models/Serial Numbers Affected:

Model	Serial Number Range									
DCA400SSI4F3	3961867	3961868	3962604	3962607	3962611	3963425 – 3963428	3963431	3964998		
DCA400SSI4F3B	3961155	3965021	3970312 – 3970315	3974478 – 3974481						
DCA400SSI4F3PB	3960361	3960362	3961884	3961886	3961887	3962628	3963442	3966751	3967692	3967695
	3967696	3967697	3968463 – 3968470	3969321	3969323	3969324	3970304 – 3970311	3971206		
	3971207 – 3971213	3971904	3971905	3971908	3972863 – 3972868	3973703 – 3973713	3974468			
	3974469 – 3974477	3976128	3976130	3976131						
DCA400SSI4F3PDSG	3961145	3961146	3961880	3961881	3962612	3962613	3962615 – 3962625	3963433 – 3963439		
	3964205	3964208 – 3964213	3965001 – 3965004	3965008 – 3965010	3965876	3965877	3965880			
	3965881 – 3965885	3966744 – 3966749	3967683 – 3967688	3968456 – 3968461	3969309 – 3969316					
	3970299	3970302	3970303	3971196 – 3971205	3971890 – 3971901	3971909 – 3971913	3972859			
	3972860 – 3972862	3974465 – 3974467								

Details

Problem:

Some TRLR400XF3DAE trailers were equipped with fuel senders that display inaccurate fuel levels. These trailers will not match the actual remaining/available fuel within the 350-gallon tank. This can lead to premature low fuel warnings and/or low fuel shutdowns of your DCA400SSI4F Series generator.

Solution:

Replace the fuel sender.

Parts Information

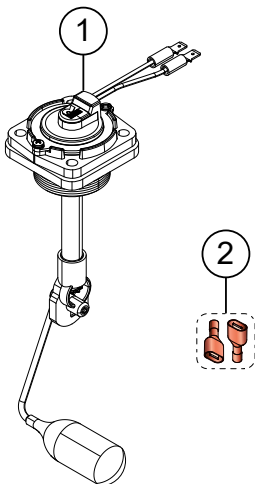

Item No.	Part No.	Description	Qty.	Remarks
1	EE62675	Sender, Fuel, Swing-Arm, Rochester, 350G	1	
2	N/A	Quick-Disconnect Connector, Insulated, Male	2	
3	N/A	Tie, Cable	4	Source locally

WORK SAFELY!

Only a qualified service technician with proper training should perform this procedure. Follow all shop safety rules when performing this procedure.

PREPARATION

1. Make sure the generator is turned **OFF** and the engine is cool. The generator **DOES NOT** have to be removed from the trailer for this procedure.
2. Place the trailer in an area free of dirt and debris. Make sure it is on secure, level ground with chock blocks underneath each wheel to prevent it from rolling.
3. Disconnect the negative (black) battery cable from the battery.

REQUIRED TOOLS

- Ratchet/socket set
- Phillips head screwdriver
- Wire cutters
- Wire strippers
- Wire crimpers

PROCEDURE

1. Remove the **four hex head bolts** (Figure 1) and **four washers** securing the **top cover** to the fuel tank assembly. Save the bolts and washers for later.

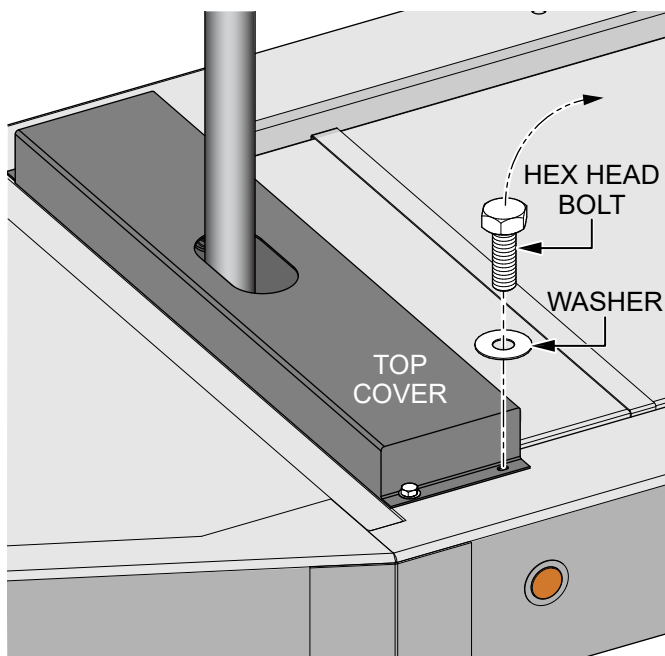

Figure 1. Remove Top Cover Hardware

2. Remove the **top cover** (Figure 2) and set it aside for later.

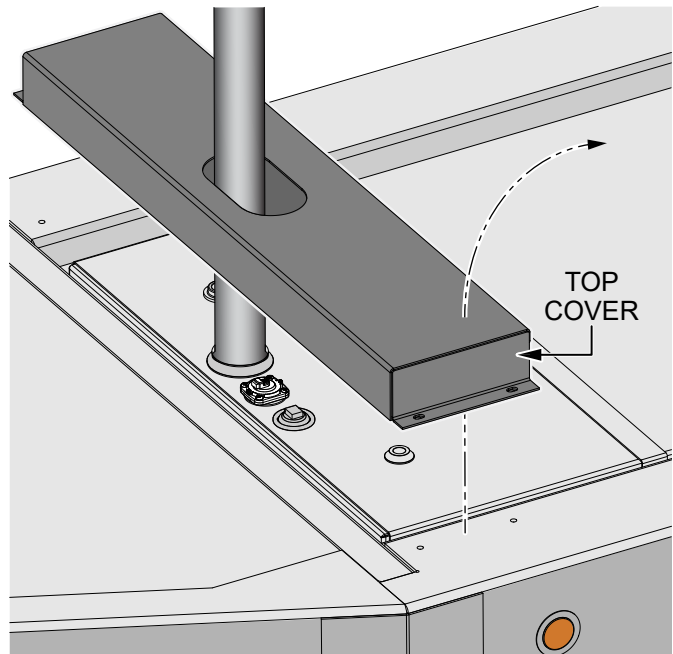

Figure 2. Remove Top Cover

3. Disconnect the **two fuel sender wires** (Figure 3) from the **wire harness**. Cut and remove **cab** ties as needed to access the wiring.

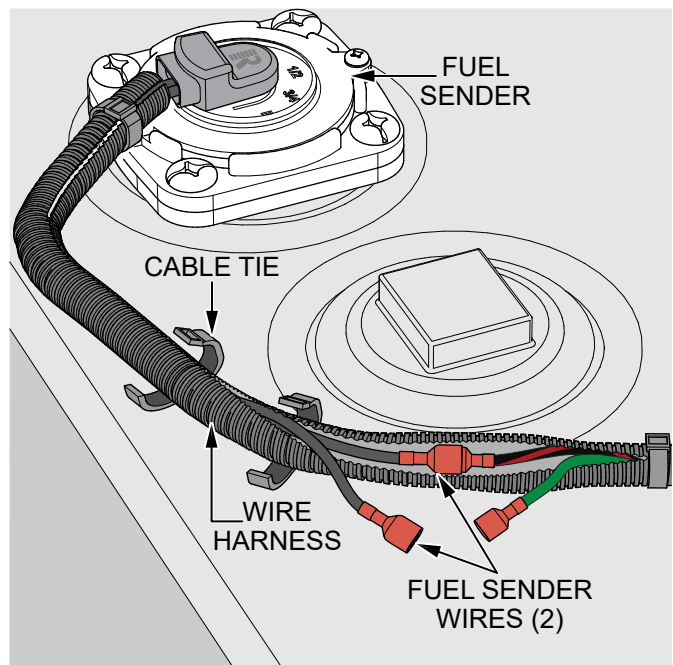

Figure 3. Disconnect Fuel Sender Wires

4. Remove the **four screws** (Figure 4) securing the **fuel sender** to the fuel tank. Save the screws for later.

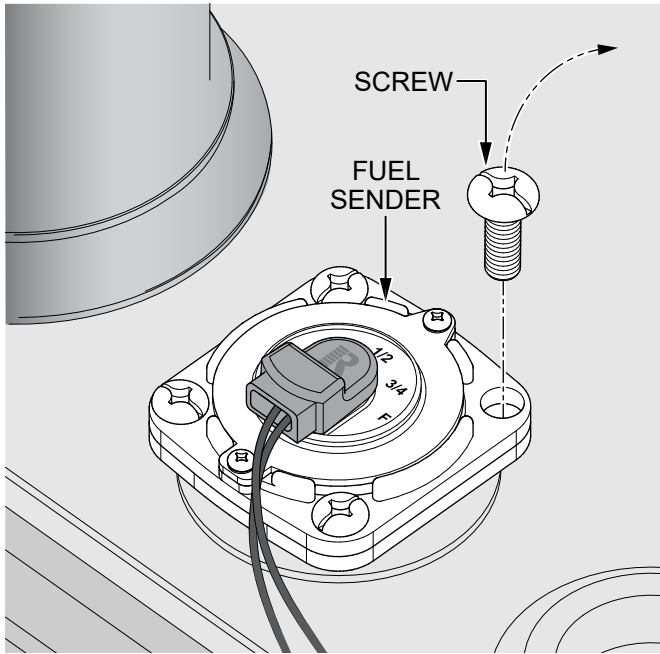

Figure 4. Remove Fuel Sender Hardware

5. Remove and discard the **fuel sender** (Figure 5).

NOTICE

During removal, note the orientation of the fuel sender to ensure correct installation of the new fuel sender. The orientation may differ from the illustration below.

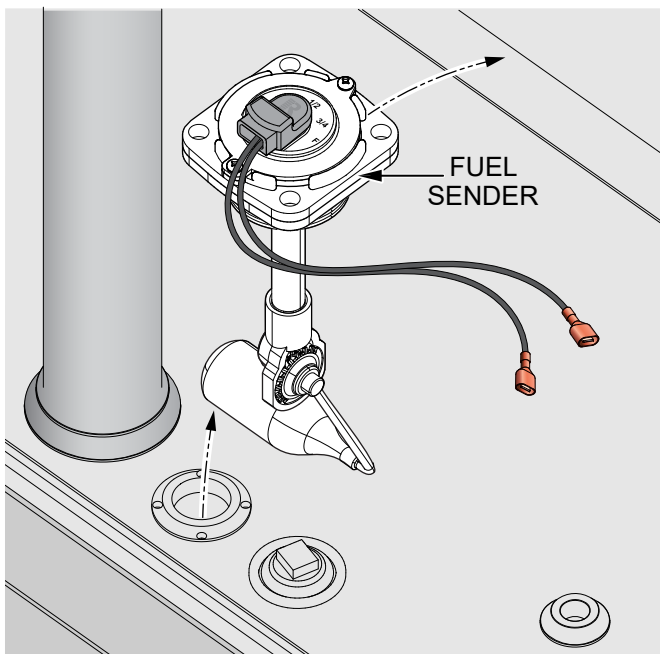

Figure 5. Remove Fuel Sender

6. Install the **new fuel sender (P/N EE62675)** into the fuel tank. Make sure to orient the fuel sender as noted during step #5. See Figure 6.

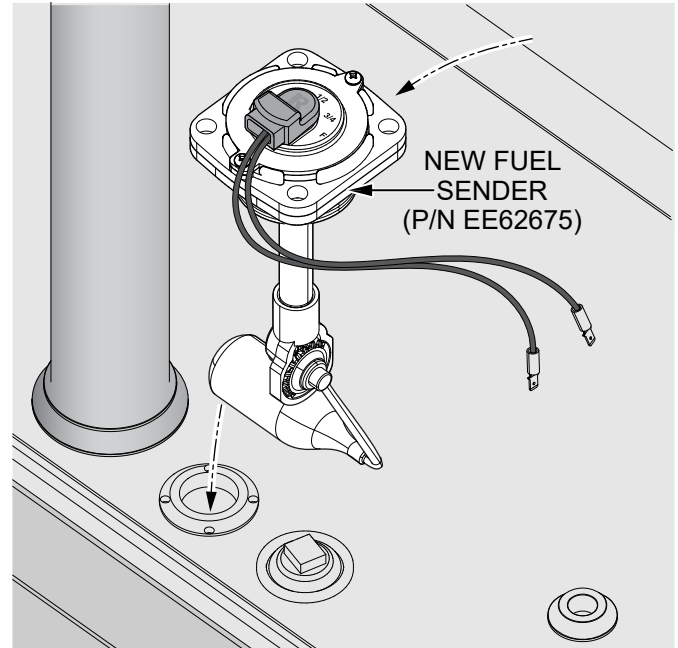

Figure 6. Install New Fuel Sender

7. Secure the **new fuel sender (P/N EE62675)** to the fuel tank using the **four screws** that were removed during step #4. See Figure 7.

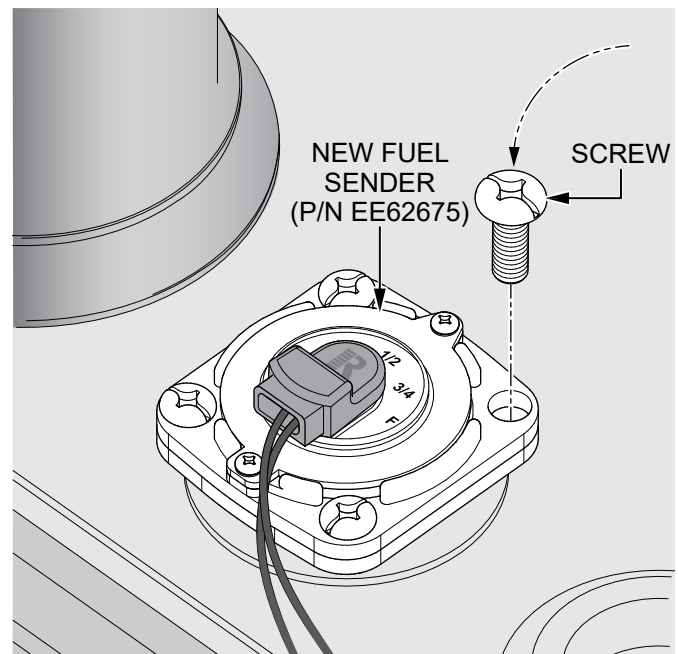

Figure 7. Install Fuel Sender Hardware

8. Cut off the **eyelet terminals** from the ends of the two wires extending from the top of the **new fuel sender (P/N EE62675)**. See Figure 8.

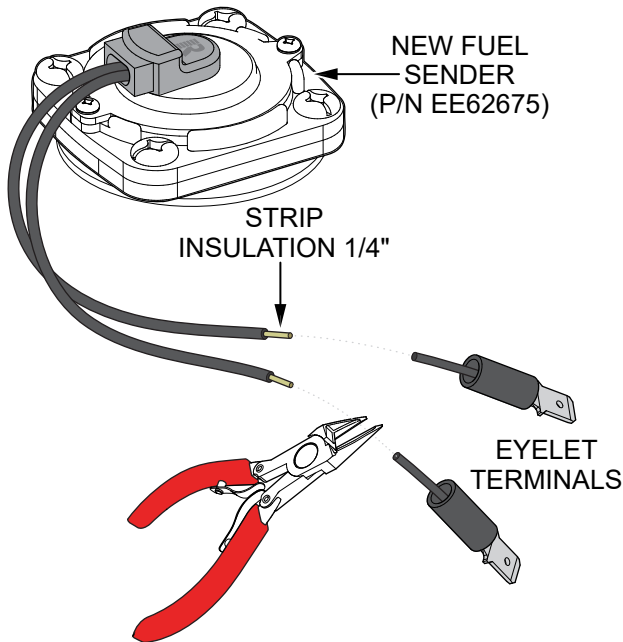

Figure 8. Cut And Strip Fuel Sender Wires

9. Strip the insulation back 1/4 inch (6 mm) from the ends of the fuel sender wires to expose the conductors. See Figure 8.
10. Insert the end of one of the stripped wires into an **insulated male quick-disconnect (QD) connector** (provided in kit) and crimp. See Figure 9.

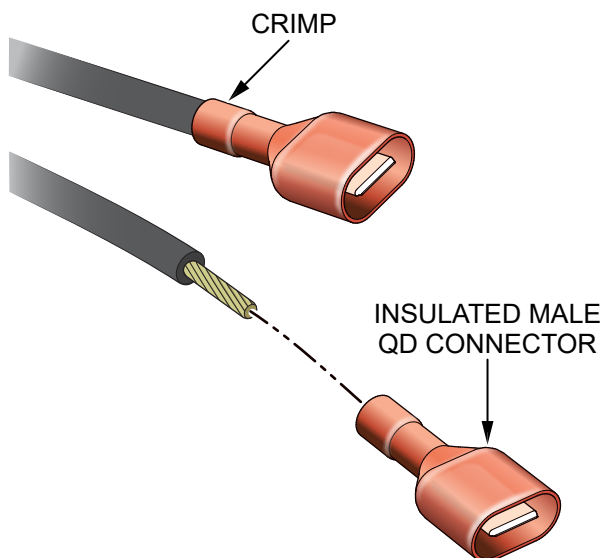

Figure 9. Crimp Connectors Onto Wires

11. Insert the end of the other stripped wire into an **insulated male QD connector** (provided in kit) and crimp. See Figure 9.

12. Connect the **two fuel sender wires** with **insulated male QD connectors** to the available **insulated female QD connectors** within the **wire harness** (Figure 10).

NOTICE

The wire connections are reversible. Each fuel sender wire can be connected to either of the available female QD connectors.

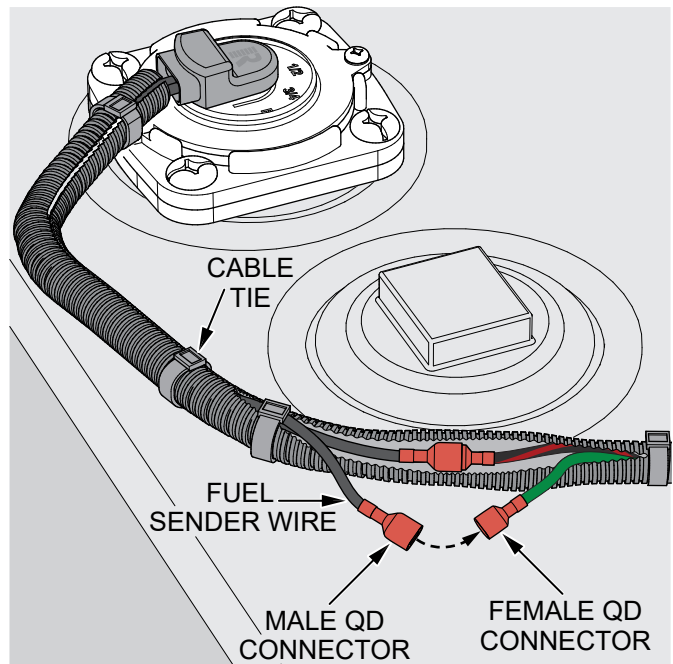

Figure 10. Connect New Fuel Sender Wires

13. Insert the wires into the wiring harness and secure it with locally sourced **cable ties** (Figure 10) as needed.

14. Reinstall the **top cover** (Figure 11) and secure it to the fuel tank assembly using the **four hex head bolts** and **four washers** that were removed during step #1.

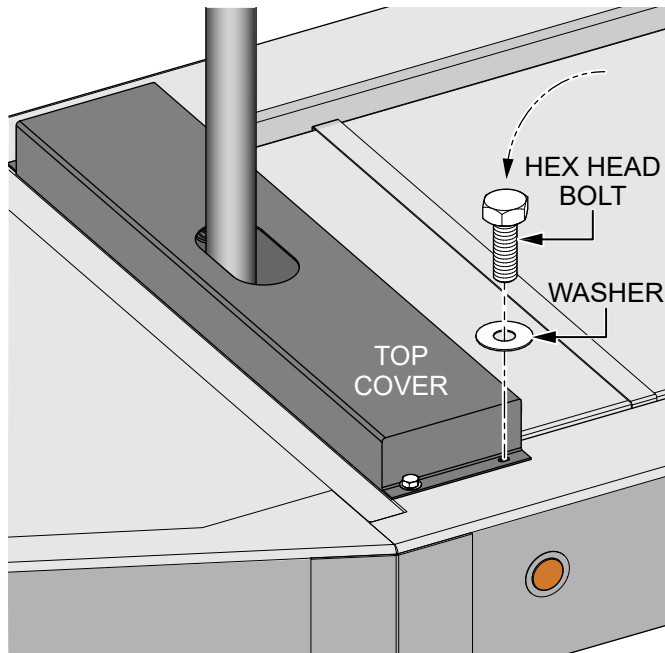

Figure 11. Reinstall Top Cover

15. Reconnect the negative (black) battery cable to the battery.

HERE'S HOW TO GET HELP

PLEASE HAVE THE MODEL AND SERIAL
NUMBER ON-HAND WHEN CALLING

UNITED STATES

Multiquip Inc.

(310) 537- 3700
6141 Katella Avenue Suite 200
Cypress, CA 90630
E-MAIL: mq@multiquip.com
WEBSITE: www.multiquip.com

CANADA

Multiquip

(450) 625-2244
4110 Industriel Boul.
Laval, Quebec, Canada H7L 6V3
E-MAIL: infocanada@multiquip.com

