

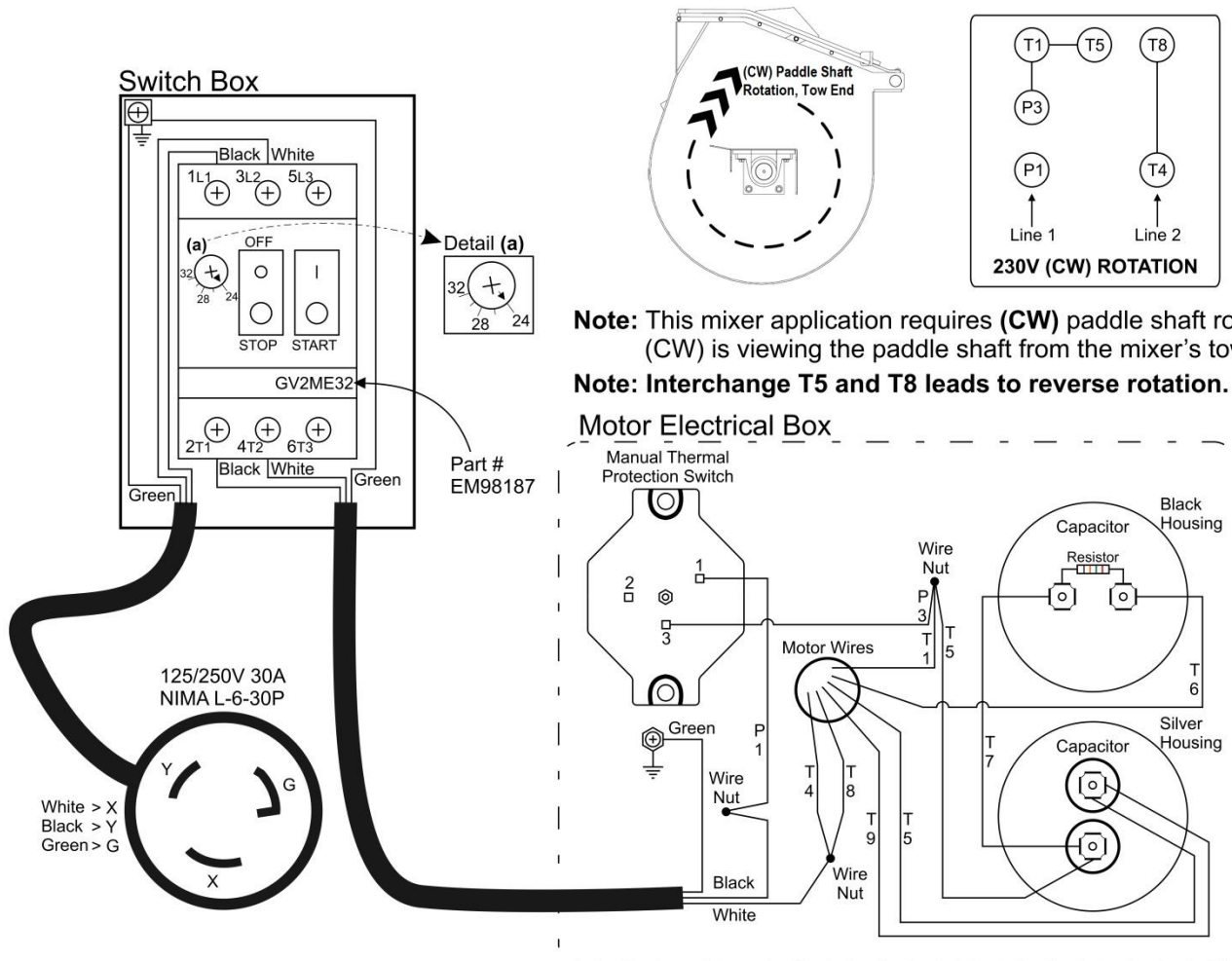

WIRING AND MOTOR INFORMATION 230V 1Ø

The purpose of this document is to illustrate the wiring configuration for these mixers and provide the general motor data plus the motor starter/protector switch amp setting “detail (a)”.



MARATHON ELECTRIC MOTOR MOD: #MZM184TBFW7034AAM

(Manual Thermal Protection)

VOLT: 230V, PH: 1, HZ: 60, HP: 5, FLA: 19.5, RPM: 1750, Continues Duty