

WRS-5200 — HYDRAULIC ASSY.

HYDRAULIC ASSEMBLY

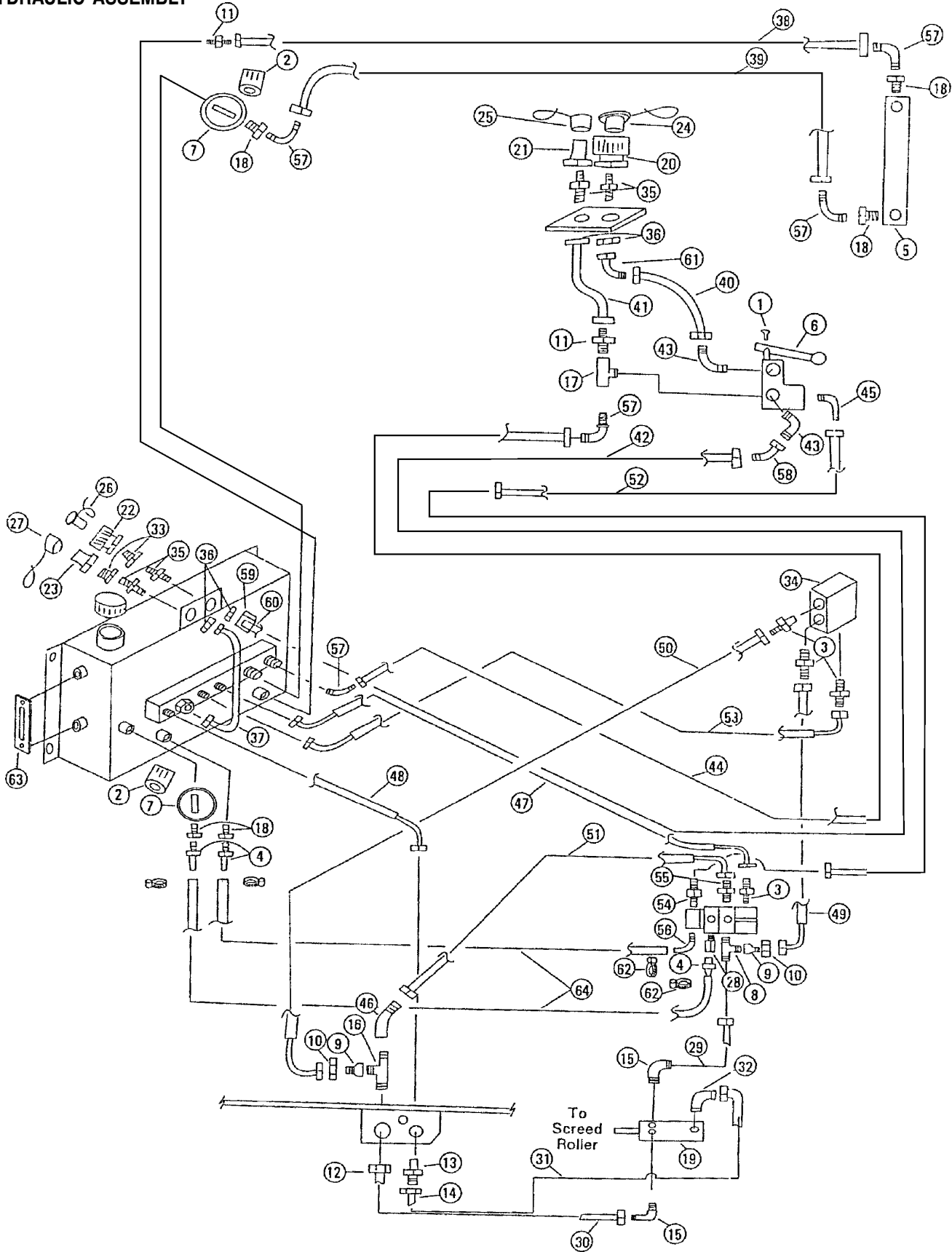

WRS 5200 RIDE-ON ROLLER SCREED
see legend on next page

WRS-5200 — HYDRAULIC ASSY.

HYDRAULIC ASSEMBLY

<u>NO</u>	<u>PART NO</u>	<u>PART NAME</u>	<u>QTY.</u>	<u>REMARKS</u>
1	0786	Screw, BHC 1/4-20 x 3/8 Nyloc	1	
2	11402	Filter, Hyd Oil	2	
3	11721	Fitting-06MO-R x -06MJIC	4	
4	13220	Fitting, Strt, 3/4 MPT x 3/4 Barb	3	
5	16213	Cooler, Hyd Oil	1	
6	16217	Valve, Selector, 3-way	1	
7	16218	Filter, Head	2	
8	16327	Fitting, 3/4 BOS Run J Tee	1	
9	16328	Fitting, 3/4 FJ x 3/8 MJ Reducer	2	
10	16329	Fitting, 3/4JFX x Tube Nut	2	
11	16331	Fitting, 3/4 MP x 5/8J	2	
12	16332	Fitting, Bulkhead Nut, 5/8	1	
13	16333	Fitting, 3/8J x 3/8J	1	
14	16334	Fitting, Bulkhead Nut, 3/8	1	
15	16336	Fitting, 10 BOS O-R x 10MJ 45EL	2	
16	16340	Tee, Bulkhead 3/4 Run	1	
17	16344	Fitting, Tee 3/4 MP x 3/4 FP	1	
18	16346	Bushing, 1-3/4	5	
19	16409	Motor, Strike Tube	1	
20	16564	Fitting, 1/2 Female QC	1	
21	16565	Fitting, 1/2 Male QC	1	
22	16566	Fitting, 3/4 Female QC	1	
23	16567	Fitting, 3/4 Male QC	1	
24	16568	1/2" Female Cover	1	
25	16569	1/2" Male Cover	1	
26	16570	3/4" Female Cover	1	
27	16571	3/4" Male Cover	1	
28	16572	Fitting, 8 BOSS O-Ring x 3/4 FPT (RIGID)	1	
29	16574	Hose, 80" OAL 5/8 Hose-10 FJ x 12 FJ	1	
30	16575	Hose, 75" OAL 5/8 Hose-10 FJ x 12 FJ	1	

WRS-5200 — HYDRAULIC ASSY. (CONT)

HYDRAULIC ASSEMBLY (CONT.)

<u>NO</u>	<u>PART NO</u>	<u>PART NAME</u>	<u>QTY.</u>	<u>REMARKS</u>
31	16576	Hose, 75" OAL 3/8 Hose-3/8 FJ x 3/8 FJ	1	
32	16581	Fitting, 4 BOSS O-R x 6 MJ 90 ELB	1	
33	16585	Fitting, Bushing 1/2 FP x 3/4 MP	2	
34	16594	Valve, Loop Flushing	1	
35	16597	Fitting, 1/2 MP x 5/8 MJ Bulkhead	4	
36	16598	Nut, 5/8 Bulkhead	4	
37	16660	Tube, HYD Steel (Manifold to HYD Tank)	1	
38	16601	Tube, HYD Steel (PAD. Return)	1	
39	16602	Tube, HYD Steel (PAD. Supply)	1	
40	16603	Tube, HYD Steel (Valve to Female QC)	1	
41	16604	Tube, HYD Steel (Valve to Male QC)	1	
42	16605	Tube, HYD Steel (Valve to Tank)	1	
43	16606	Fitting, 1/2 MP x 5/8 MJ 90 EL	2	
44	16607	Tube, HYD Steel (Valve to Manifold)	1	
45	16608	Fitting, 3/4 MP x 8 MJ 90 EL	1	
46	16609	Fitting, 12 FJ (SWIV) x 12 MJ 45 EL	1	
47	16610	Hose, 6C2AT-69FJX-64FJX	1	
48	16611	Hose, 6C2AT-6FJX-64FJX	1	
49	16612	Hose, 6C2AT-6FJX-69FJX	1	
50	16613	H6se, 6C2AT-6FJX-69FJX	1	
51	16614	Hose, 12C2AT-129FJX-12FJX	1	
52	16615	Hose, 8C2AT-89FJX-SFJX	1	
53	16616	Hose, 6C2AT-6FJX-69FJX	1	
54	16617	Fitting, 10 BOS O-Rx 8 MJ	1	
55	16618	Fitting, 12 BOS O-R x 12 MJ Strt	1	
56	3461	Fitting, 12 BOS O-RxV4Bar90EL	1	
57	3368	Fitting, 3/4 MP x 5/8 MJ 90 EL	5	
58	16698	Fitting, 5/8 FJ x 5/8 MJ 45 EL	1	
59	16717	Fitting, Ferrule 5/8 Tube HYD	7	
60	16718	Fitting, Nut 5/8 Tube HYD	7	
61	16846	Fitting, 5/8 FJ x5/8 MJ 90 Elbow	1	
62	3333	Clamp, 1-1/4 Hose	4	
63	3336	Gauge, Temp Sight	1	
64	3462	Hose, Suction	2	