



WT8C Series Water Trailer

Hose Reel Installation

The following instructions are intended to assist the user with the installation of the Hose Reel Kit on a Multiquip WT8C Series Water Trailer. It is not intended to take the place of the Operation manual shipped with the water trailer. Refer to the Operation manual for safety, operation, and maintenance information. Please read all assembly instructions before installing the kit.

REQUIRED TOOLS

- 1/2" wrench
- 9/16" wrench/socket
- 5/16" socket or slotted screw driver
- 1-1/16" wrench
- 5/8" wrench
- 1/2" socket (optional)

PARTS

Verify that all parts are accounted for. See Table 1 and Figure 1.

Table 1. Hose Reel Kit Components

Item No.	Part No.	Description	Qty.	Remarks
1	WTHR	Kit, Hose Reel, WT8C Series	1	Includes items 2-14
2	59778	Hose Reel Assy., Water Trailer, WT8/WT5	1	Includes items 3-13
3	59157	Hose, 50' - 1 in. Male NPT Contractors	1	
4	59158	Nozzle, Fog 1" NPT - Plastic	1	
5	59779	Hose, 2 Ft. Lg., With 1 In. Male NPT Conn.	1	
6	59617	Mount, Hose Reel, W/A, WT8	1	
7	22228	Screw, HHF 3/8-16 × 1.00 Grd 8	3	
8	36720	Screw, HHFS 5/16-18 × 3/4 Gr5	3	
9	5283	Nut, Nyloc 5/16-18	4	
10	12597	Clamp, Muffler, 2"	2	
11	59160	Fitting, Hose Barb To Male NPT 16-12	1	
12	21552	Clamp, Hose Worm #16	1	
13	59136	Drum Assy., Hose Reel	1	
14	52124	Instructions, Hose Reel Installation, WT8C Series	1	

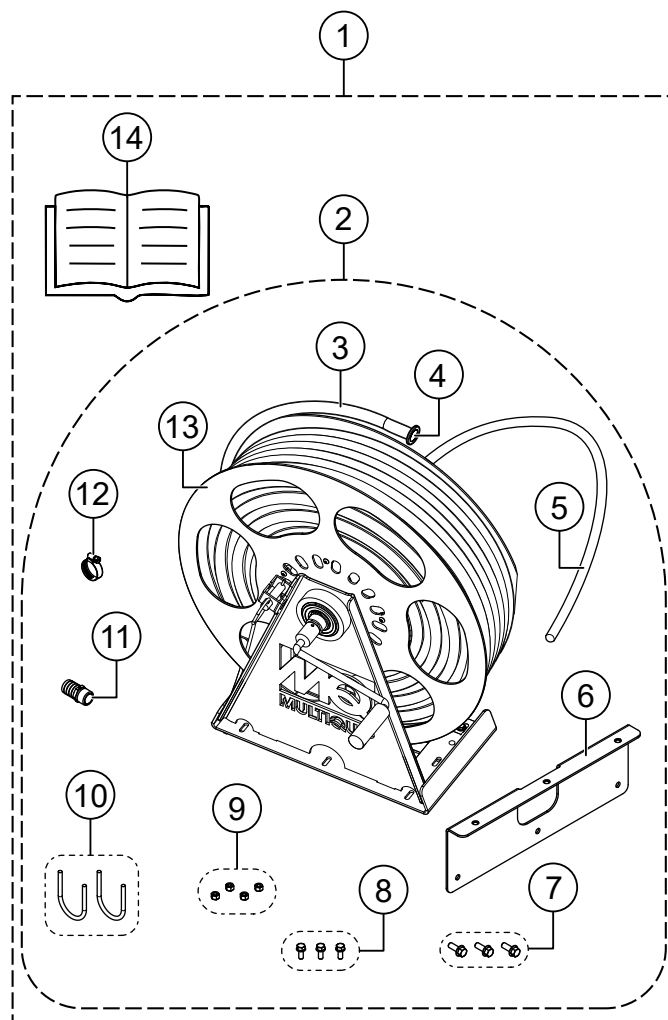

Figure 1. Hose Reel Kit Components

WORK SAFELY!

Only a **qualified service technician** with proper training should perform this installation. Follow all shop safety rules when performing this installation.

CAUTION

Improper installation of this kit may result in damage to the equipment or cause equipment to malfunction. Carefully follow the procedures outlined in these service instructions.

PREPARATION

1. Make sure the water trailer is turned **OFF** and the engine is cool.
2. Place the water trailer on secure, level ground in an area that is free of dirt and debris.
3. Discharge all water from the water tank. Make sure the tank is empty.

HOSE REEL INSTALLATION

1. Using a 5/8" wrench, remove the **3/4" plug** from the **cross tube** (Figure 2).

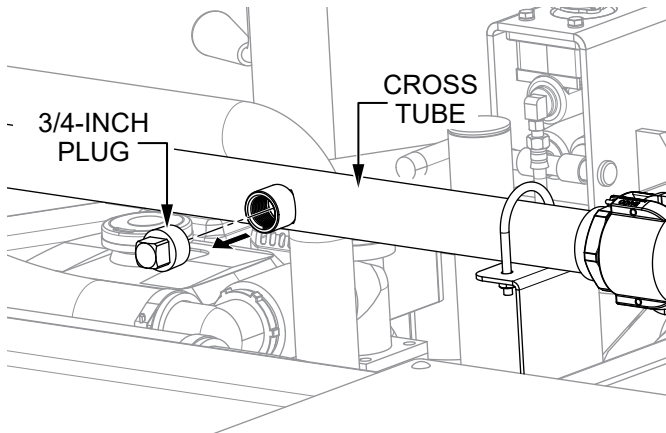

Figure 2. Remove 3/4-Inch Plug

2. Using a 1-1/16" wrench, install the **hose barb** (P/N 59160) in the same location (Figure 3).

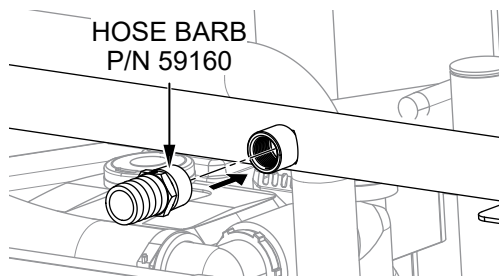

Figure 3. Install Hose Barb

3. Using the **three 3/8-16 x 1 hex head flange screws** (P/N 22228), secure the **hose reel mount** (P/N 59617) to the **front crossmember** as shown in Figure 4.

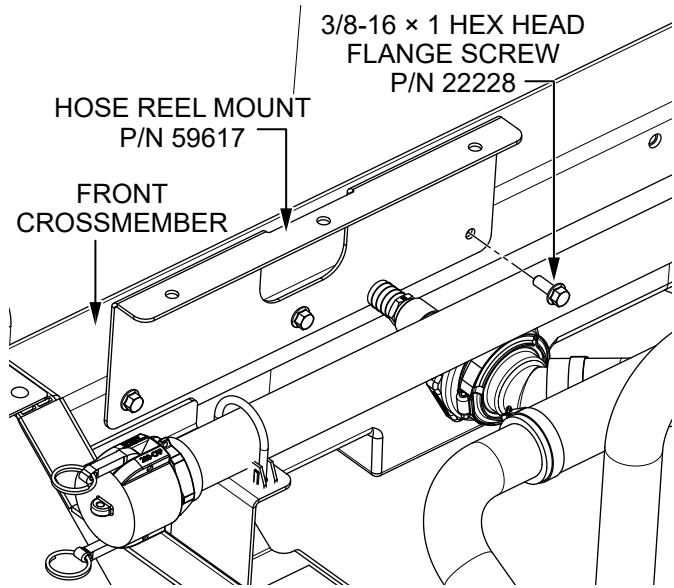

Figure 4. Install Hose Reel Mount

4. Place the **hose reel drum assembly** (P/N 59136) onto the **hose reel mount** (P/N 59617) and **cross tube** as shown in Figure 5.

NOTICE

The 50-foot main hose and 2-foot inlet hose both come pre-attached to the hose reel. The hoses and water tank are not shown for visual clarity.

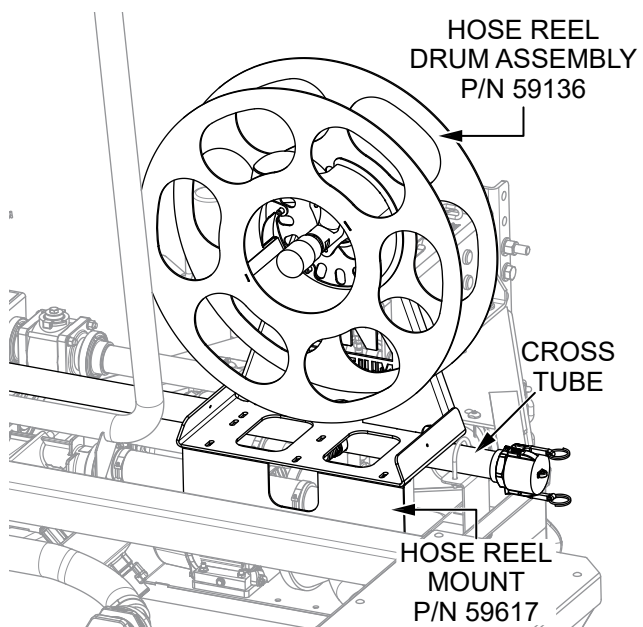

Figure 5. Hose Reel Drum Assembly Placement

5. Install the **three 5/16-18 × 3/4 hex head flange screws (P/N 36720)** as shown in Figure 6, but **DO NOT** fully tighten them yet. Leave the screws loose enough to allow the **hose reel drum assembly (P/N 59136)** to slide back and forth.

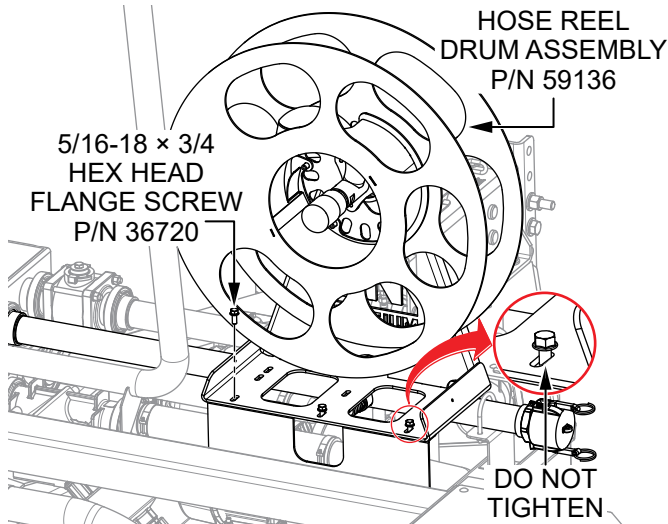

Figure 6. Install Three 5/16-18 × 3/4 Hex Head Flange Screws

6. Secure the **hose reel drum assembly (P/N 59136)** to the **cross tube** as shown in Figure 7 using the **two muffler clamps (P/N 12597)** and **four nyloc nuts (P/N 5283)**.
 - a. Tighten the front nyloc nut (Figure 7) on each muffler clamp until each clamp is touching the bottom of the cross tube.
 - b. Position the hose reel drum assembly (P/N 59136) as needed by sliding it back and forth.
 - c. Using a 1/2" wrench or socket, fully tighten the rear nyloc nut on each muffler clamp (Figure 8). This will further tighten the front nuts as well.

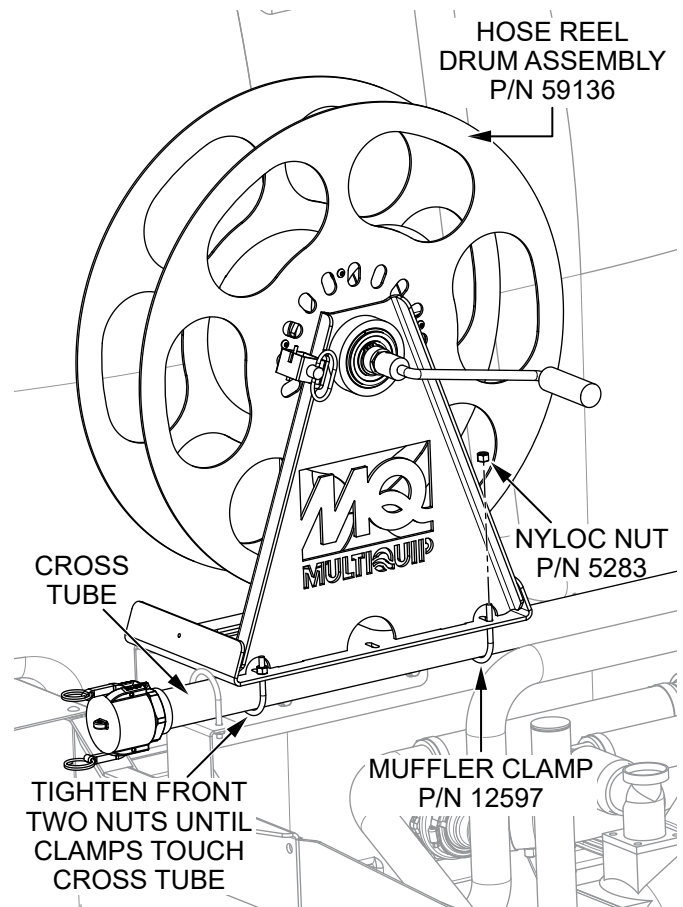

Figure 7. Secure Hose Reel Drum Assembly To Cross Tube

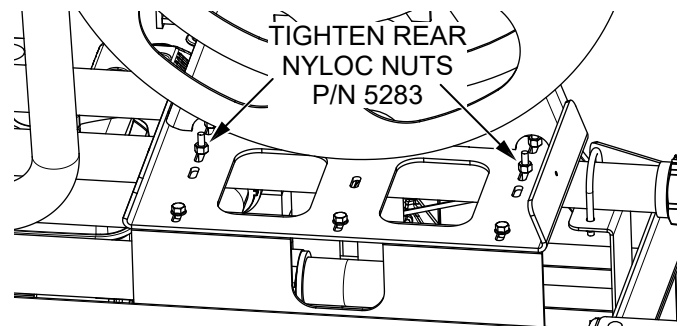

Figure 8. Tighten Rear Muffler Clamp Nuts

7. Using a 1/2" wrench or socket, fully tighten the **three 5/16-18 x 3/4 hex head flange screws (P/N 36720)** that were installed in step #5. See Figure 9.

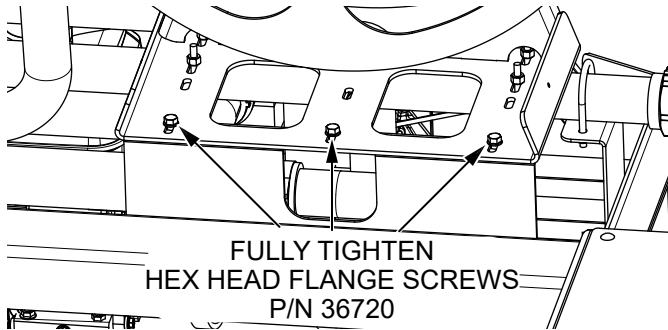

Figure 9. Fully Tighten Hex Head Flange Screws

8. Place the **hose clamp (P/N 21552)** onto the **hose reel inlet hose (P/N 59779)**. See Figure 10.

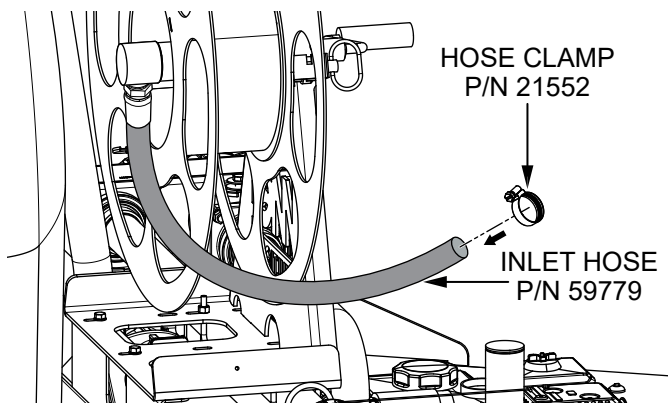

Figure 10. Place Hose Clamp Onto Inlet Hose

9. Place the end of the **hose reel inlet hose (P/N 59779)** onto the **hose barb (P/N 59160)**. See Figure 11.

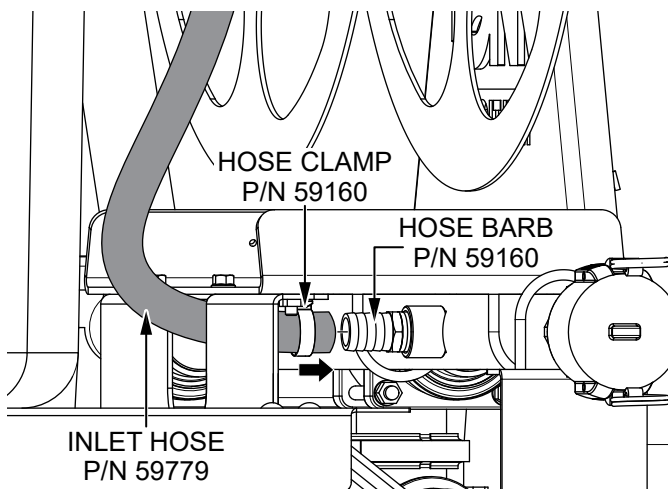

Figure 11. Place Inlet Hose On Hose Barb

10. Secure the **hose reel inlet hose (P/N 59779)** to the hose barb using the **hose clamp (P/N 21552)**. Tighten the hose clamp using a 5/16" socket or slotted screwdriver. See Figure 12.

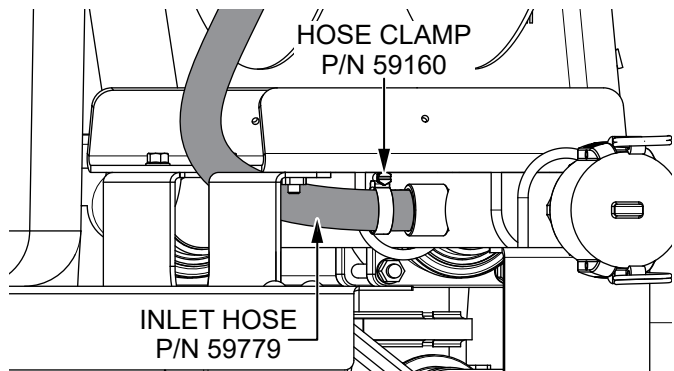

Figure 12. Secure Inlet Hose To Hose Barb

HERE'S HOW TO GET HELP

UNITED STATES

Multiquip Inc.

(310) 537- 3700

E-mail: mq@multiquip.com

CANADA

Multiquip

(450) 625-2244

E-mail: infocanada@multiquip.com

UNITED KINGDOM

Multiquip (UK) Limited Head Office

0161 339 2223

E-mail: sales@multiquip.co.uk

