



Walk-Behind Trowels

Operator Presence Switch Service Kit Installation

The following instructions are intended to assist the user with the installation of the Operator Presence Switch Service Kit on a Multiquip walk-behind trowel. It is not intended to take the place of the Operation manual shipped with the trowel. Refer to the Operation manual for safety, operation, and maintenance information. Please read all assembly instructions before installing the kit.

REQUIRED TOOLS

- A container or spray bottle of soapy water (dish or hand soap can be used)
- Phillips-head #2 screwdriver
- Adjustable open-end wrench
- Needle-nose pliers
- 3/16" Allen wrench
- 10 mm socket wrench
- Plastic cable ties (optional)

PARTS

Verify that all parts are accounted for. See Table 1 and Figure 1.

Table 1. Operator Presence Switch Service Kit				
Item No.	Part No.	Description	Qty.	Remarks
1	48736	Service Kit, MQ Presence Switch, 32.5 Inch	1	Includes items 2-8
2	48739	Harness, MQ Presence Switch, 72.5 Inch	1	
3	21172	Cable, Throttle, 70 Inch	1	
4	22732	Throttle Lever Assy.	1	
5	48655	Switch Assy., Operator Presence	1	
6	21173	Housing, Throttle Cables	1	
7	48763	Instructions, Presence Switch Service Kit	1	
8	21746	Spring, Primary Throttle Return	1	

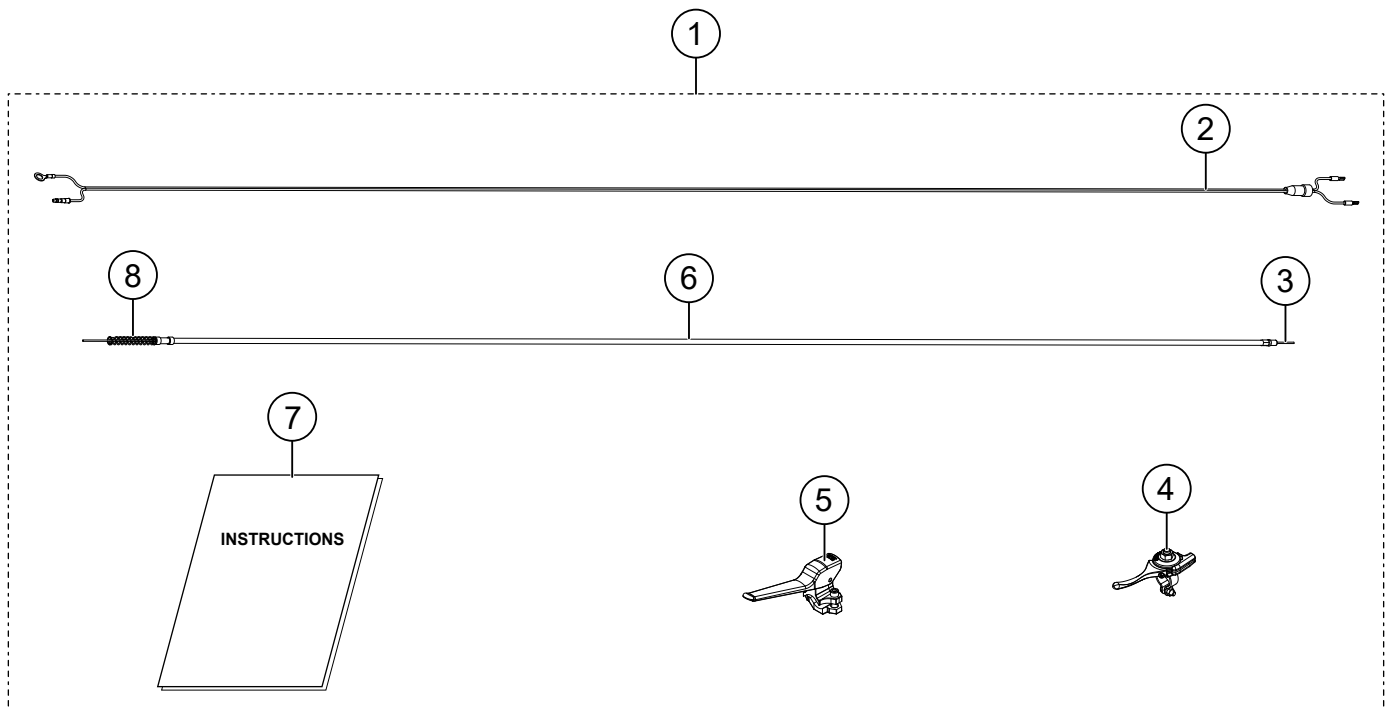

Figure 1. Operator Presence Switch Service Kit

WORK SAFELY!

Only a **qualified service technician** with proper training should perform this installation. Follow all shop safety rules when performing this installation.

CAUTION

Improper installation of this kit may result in damage to the equipment or cause equipment to malfunction. Carefully follow the procedures outlined in these service instructions.

PREPARATION

1. Make sure the trowel is turned **OFF** and the engine is cool.
2. Place the trowel on secure, level ground in an area that is free of dirt and debris.

EXISTING THROTTLE CABLE ASSEMBLY REMOVAL

If the existing throttle lever assembly is not installed, skip ahead to the **Kit Installation** section.

1. To remove the right-side hand grip, spray or pour a small amount of soapy water on the handlebar next to the hand grip, then work the soap under the hand grip by using a twisting motion and adding small amounts of soapy water as needed.
2. The hand grip will easily slide off the handlebar once the soap has been fully worked in between the hand grip and the handlebar. Use gentle motions to ensure the hand grip is not damaged and can be reused.
3. Loosen (but **DO NOT** remove) the **swivel stop screw**. See Figure 2.

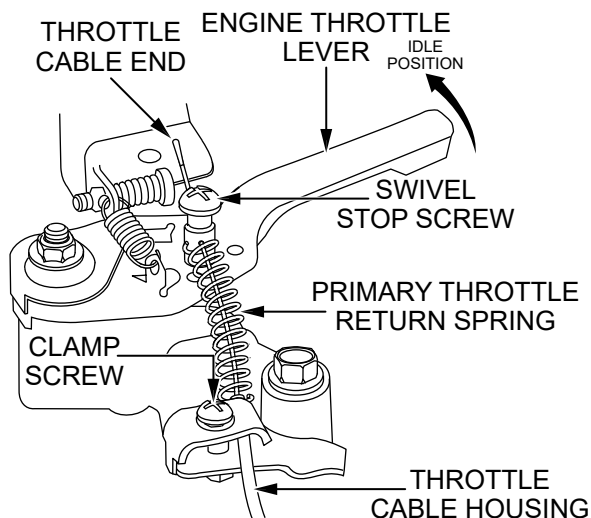

Figure 2. Remove Throttle Cable Assembly

4. Loosen (but **DO NOT** remove) the **clamp screw** (Figure 2).
5. While holding the **primary throttle return spring** (Figure 2), pull on the **throttle cable housing** to remove the **throttle cable** and cable housing. Discard all three of these components.

EXISTING WIRE HARNESS AND THROTTLE LEVER REMOVAL

1. Remove any plastic cable ties securing the electrical wire harness in place.
2. Disconnect the **bullet terminal** as shown in Figure 3.

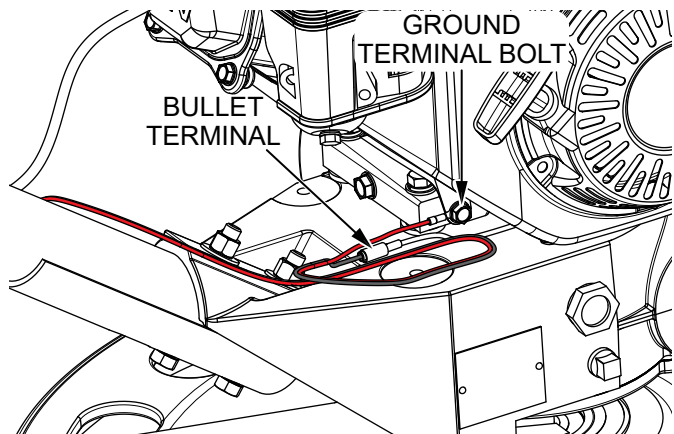

Figure 3. Disconnect Electrical Wire Harness

3. Remove the **bolt** (Figure 3) securing the **ground wire terminal** to the engine block, and set it aside.
4. Remove the **two M6-1.0 × 16 screws** (Figure 4) securing the existing throttle lever to the handlebar.

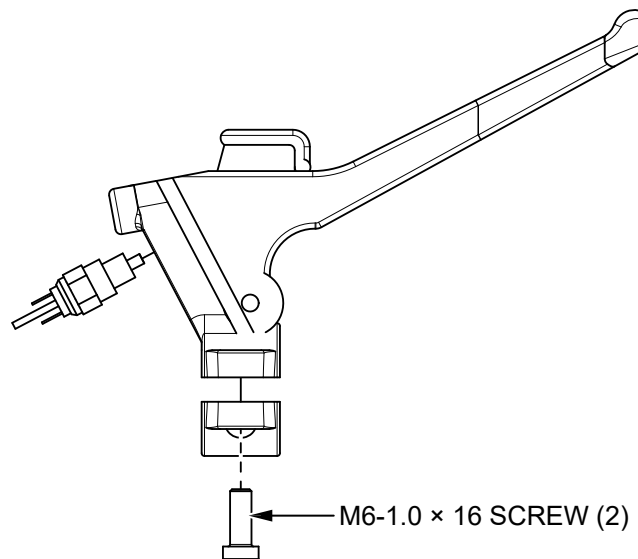

Figure 4. Remove Existing Throttle Lever

- The throttle cable and wire harness may remain attached to the throttle lever. Remove the throttle lever, throttle cable, and wire harness from the handle by guiding the cables and wires through and out of the handle assembly.

KIT INSTALLATION

- Clean all surfaces of the equipment prior to installation of the kit.

NOTICE

The operator presence switch will be installed on the right side of the handle and the throttle assembly will be installed on the left side.

- Carefully guide the terminals of the **wire harness** (P/N 48739) through the tubes of the handle and out of the **lower access hole** (Figure 5):

- Make sure the end of the wire harness with the **rubber boot** remains by the handle-grip area.
- The wire harness will route through the **left-side upper access hole** and left handle tube opposite from the presence switch location.
- Gently use needle-nose pliers to help guide the terminals out through the lower access hole.
- Take care to not damage the wires.

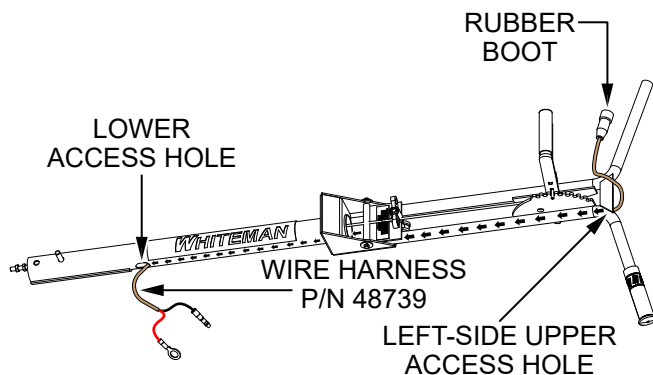

Figure 5. Route Wire Harness

- Route the **throttle cable housing** (P/N 21173) from the left-hand grip area to the **right-side upper access hole** and down through the right-side handlebar tube as shown in Figure 6. **DO NOT** install the throttle cable or primary throttle return spring at this time.
 - Gently use needle-nose pliers to help guide the housing out through the lower access hole.

NOTICE

The throttle cable (P/N 21172) and cable housing (P/N 21173) are resistant to bending. Care must be taken to not tear the outer coating of the throttle cable housing when guiding the housing through the handle bars.

CAUTION

DO NOT overbend the throttle cable housing. Overbending will cause permanent damage to the housing.

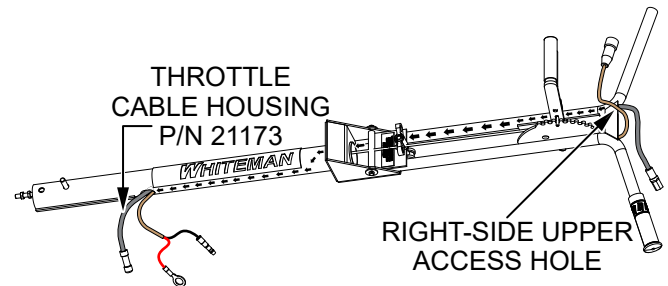

Figure 6. Route Cable Housing

- Install the **throttle cable** (P/N 21172) into the **throttle cable housing** (P/N 21173). Start by feeding the throttle cable through the handle-grip end of the housing. Once the cable is showing at both ends of the housing, thread the **primary throttle return spring** (P/N 21746) over the cable at the engine throttle control end as shown in Figure 7.

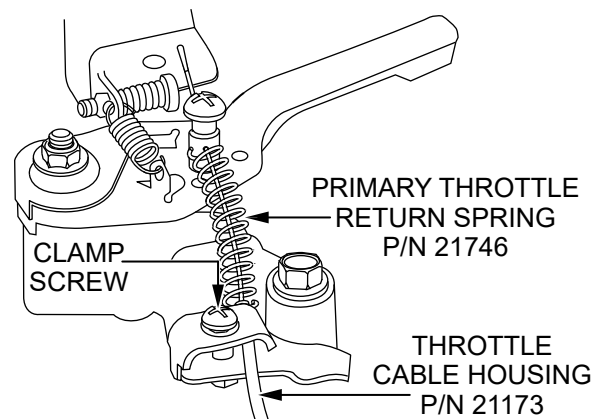

Figure 7. Install Throttle Cable To Engine

- Install the end of the **throttle cable housing** (with the throttle cable inside) into the engine throttle control assembly as shown in Figure 7. Tighten the **clamp screw** to hold the cable housing in place.

- Using the **two included 1/4-20 × 7/8 socket-head cap bolts**, install the **operator presence switch assembly** (P/N 48655) onto the right-side handle bar. Only finger tighten the bolts at this time. See Figure 8.

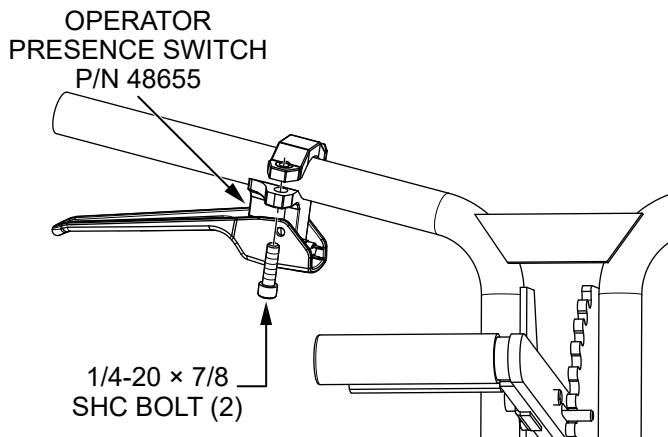

Figure 8. Install Operator Presence Switch

- Reinstall the **right-side hand grip** onto the right-hand grip area as shown in Figure 9. The presence switch body should be touching the rubber hand grip with the grip fully seated onto the handlebar tube.

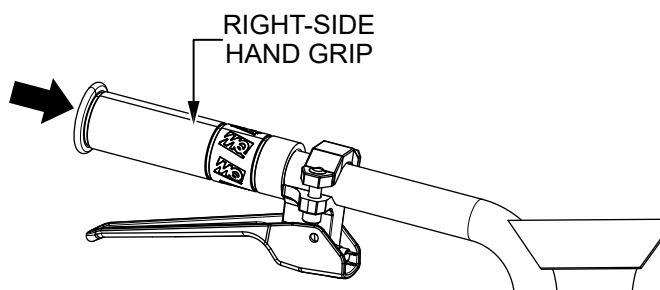

Figure 9. Reinstall Right-Side Hand Grip

- Using an Allen wrench, tighten the **two socket-head cap 1/4-20 × 7/8 bolts** (Figure 8) to secure the presence switch assembly to the handlebar. Tighten until the switch assembly does not move. **DO NOT** overtighten.
- Connect the **wire harness** (P/N 48739) to the **operator presence switch** (P/N 48655). Slide the **rubber boot** back to reveal the harness **wire terminals**, then connect the terminals to the switch as shown in Figure 10. It does not matter which color wire connects to which pin on the switch. When finished, slide the rubber boot back in place to cover the terminals and the back of the switch.

NOTICE

BE CAREFUL when connecting the harness wire terminals to the presence switch pins. The switch pins are delicate and may bend easily.

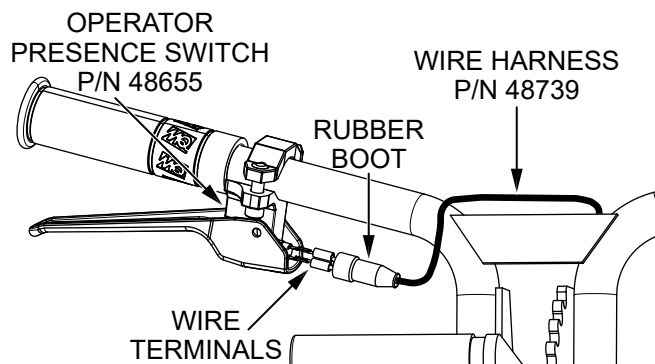

Figure 10. Connect Wire Harness

- Connect the **wire harness** (P/N 48739) to the engine electrical system:
 - Secure the **red (ground) wire with the ring terminal** to the engine block using the bolt that was removed during step #3 of the **Existing Wire Harness and Throttle Lever Removal** section (Figure 3).
 - Connect the **black wire with the bullet connector** to the engine as shown in Figure 3.
- Using the included **M5 × 0.8 pan-head Phillips screw**, install the **throttle lever assembly** (P/N 22732) onto the left-side handle bar, **1.75 inches (45 mm)** away from the **left-side hand grip**. Tighten the screw securely. See Figure 11.

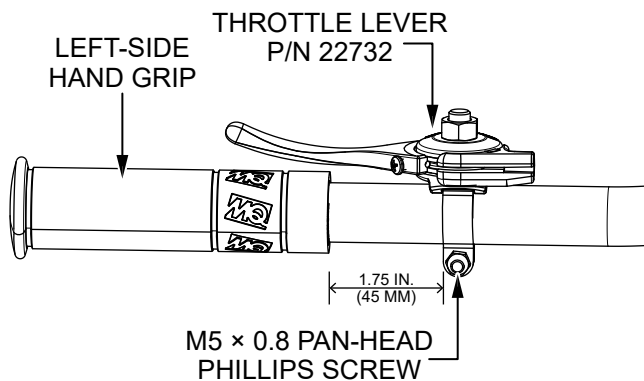

Figure 11. Install Throttle Lever

12. Feed the **throttle cable** (P/N 21172) through the **throttle lever** (P/N 22732) as shown in Figure 12 and seat the cable housing. Tighten the included **M4 × 0.7 pan-head Phillips retaining screw** to secure the throttle cable in place. Leave about **1/4 inch (6–7 mm)** of cable showing from the rear of the lever.

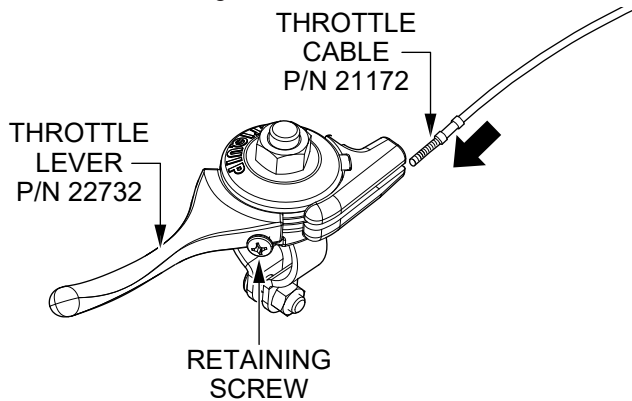

Figure 12. Connect Throttle Cable

13. Rotate the **throttle lever** (P/N 22732) counterclockwise to the aftmost position. See Figure 13.

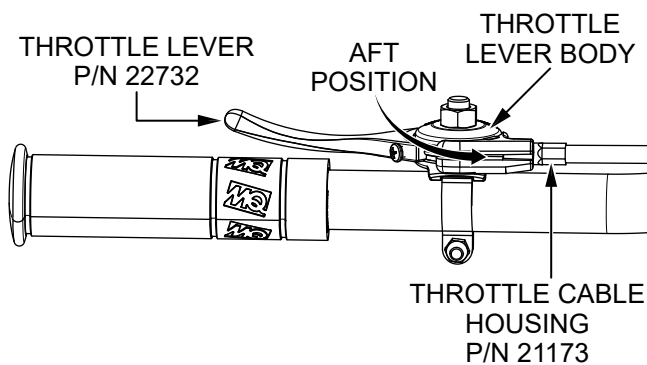

Figure 13. Throttle Lever (Aft Position)

14. With the **throttle lever** (P/N 22732) in the aftmost position, loosen the **swivel stop screw** (Figure 14) on the engine throttle control and use needle-nose pliers to pull the **throttle cable** (P/N 21172) tight.

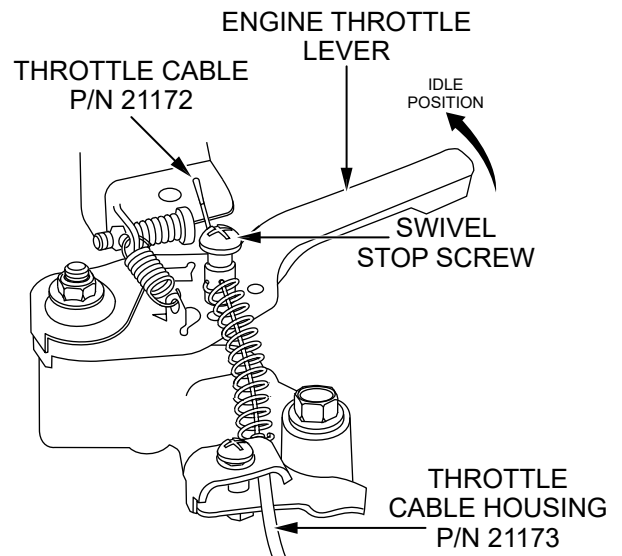

Figure 14. Adjust Throttle Cable

15. Make sure the **throttle cable housing** (P/N 21173) is properly seated against the **throttle lever body**. See Figure 13.
16. Make sure the **engine throttle lever** is fully in the **IDLE** position (Figure 14), then tighten the **swivel stop screw** to capture the throttle cable position. If excess throttle cable is protruding from the throttle lever, trim the cable to the approximate length shown in Figure 14.

CAUTION

Excess cable protruding from the engine throttle control may prevent the throttle from properly returning to the idle position.



Walk-Behind Trowels

Operator Presence Switch Service Kit Installation

HERE'S HOW TO GET HELP

PLEASE HAVE THE MODEL AND SERIAL
NUMBER ON-HAND WHEN CALLING

UNITED STATES

Multiquip Inc.

(310) 537- 3700
6141 Katella Avenue Suite 200
Cypress, CA 90630
E-MAIL: mq@multiquip.com
WEBSITE: www.multiquip.com

CANADA

Multiquip

(450) 625-2244
4110 Industriel Boul.
Laval, Quebec, Canada H7L 6V3
E-MAIL: infocanada@multiquip.com

UNITED KINGDOM

Multiquip (UK) Limited Head Office

0161 339 2223
Unit 2, Northpoint Industrial Estate,
Globe Lane,
Dukinfield, Cheshire SK16 4UJ
E-MAIL: sales@multiquip.co.uk

© COPYRIGHT 2024, MULTIQUIP INC.

Multiquip Inc. and the MQ logo are registered trademarks of Multiquip Inc. and may not be used, reproduced, or altered without written permission. All other trademarks are the property of their respective owners and used with permission.

The information and specifications included in this publication were in effect at the time of approval for printing. Illustrations, descriptions, references and technical data contained in this document are for guidance only and may not be considered as binding. Multiquip Inc. reserves the right to discontinue or change specifications, design or the information published in this publication at any time without notice and without incurring any obligations.

Your Local Dealer is:

