



# Walk-Behind Trowels

## InstaClutch Handle Installation

The following instructions are intended to assist the user in the installation of the Standard Handle (SXHC) and Quick Pitch™ Handle (QXHC) on Multiquip walk-behind trowels. It is not intended to take the place of the Operation and Parts manual shipped with the trowel. Refer to the Operation and Parts manual for safety, operation, and maintenance information. If you did not receive a manual with your trowel, contact Multiquip at (800) 421-1244 for a replacement.

### REQUIRED TOOLS

- 1/2" (2), 9/16" (2), 7/16" Open-End Wrenches
- Phillips Screwdriver

### PARTS

Verify that all parts are accounted for. See Figure 1 and Table 1.

Table 1. Standard/ Quick-Pitch™ Handle Assembly				
Item No.	Part No.	Description	Qty.	Remarks
1	SXHC or QXHC	Standard Handle or Quick-Pitch™ Handle	1	Includes Item 2
2	30220	InstaClutch Handle Installation Kit	1	Includes Items 3–7
3	1493	3/8-16 x 3 1/4 HHC Screw	1	
4	10133	3/8-16 Nyloc Nut	2	
5	10136	3/8 Flat Washer	2	
6	30219	Installation Instructions	1	
7	21746	Spring, Primary Throttle Return	1	

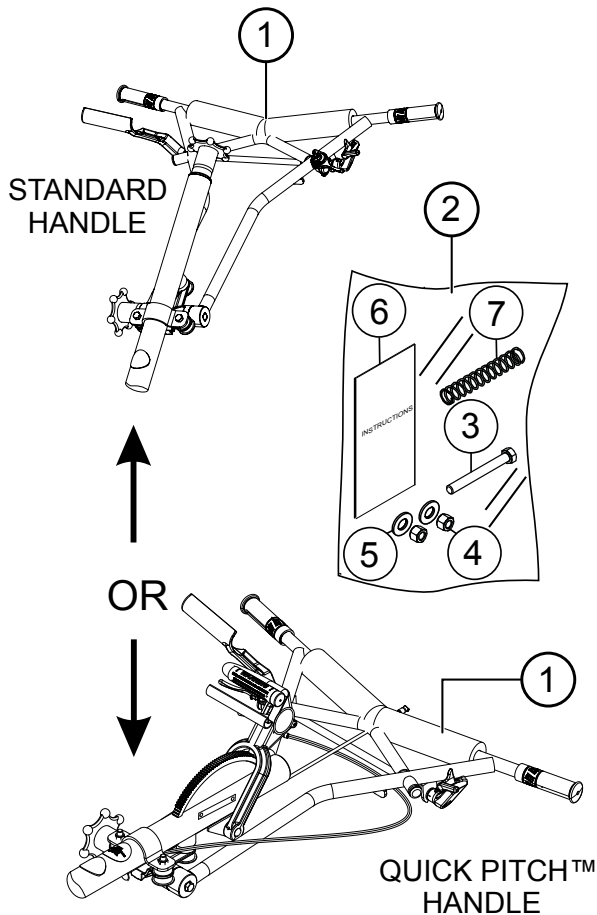

Figure 1. Standard/Quick Pitch™ Handle Assembly

### WORK SAFELY!

Only a **qualified service technician** with proper training should perform this installation. Follow all shop safety rules when performing this installation.

### PREPARATION

1. Make sure trowel is turned off and engine is cool.
2. Place the trowel in an area free of dirt and debris. Make sure it is on secure level ground.

## UNPACKING THE HANDLE

The handle (Figure 2) is shipped in the folded or stowed position.

1. To place the folding upper handle in the operational position, simply turn the star wheel counterclockwise to release it from its folded or stowed position.
2. Next, pull back on the upper handle and place the handle in the desired position. Turn the star wheel clockwise to lock firmly in place so that it will not move or slip.

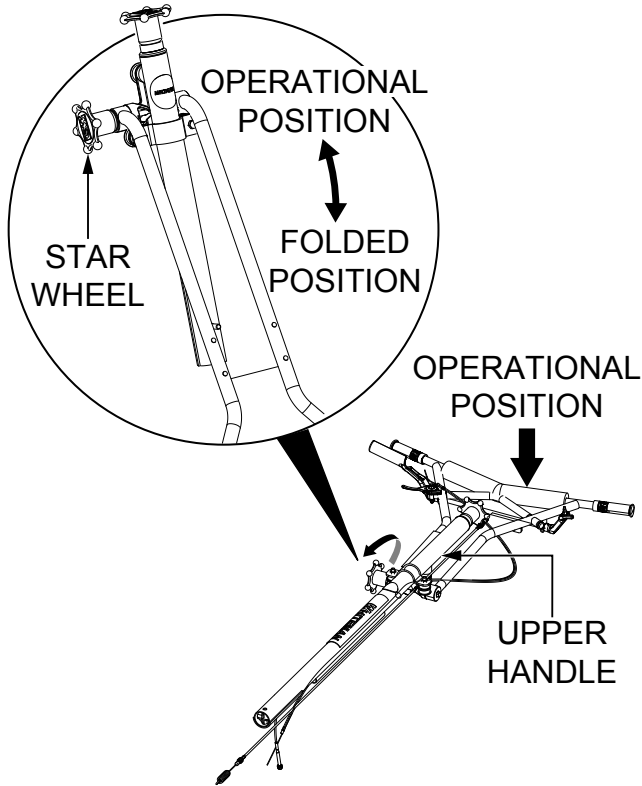

Figure 2. Unpacking The Trowel

## MAIN HANDLE TUBE INSTALLATION

Attach the main handle tube to the gearbox using the supplied hardware as shown in Figure 3.

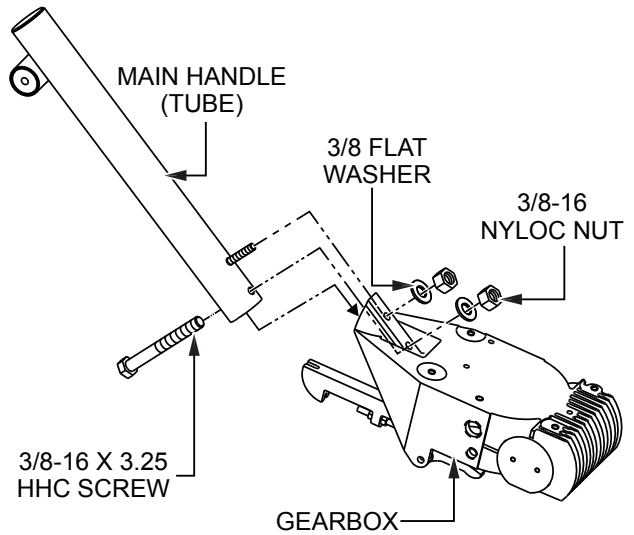
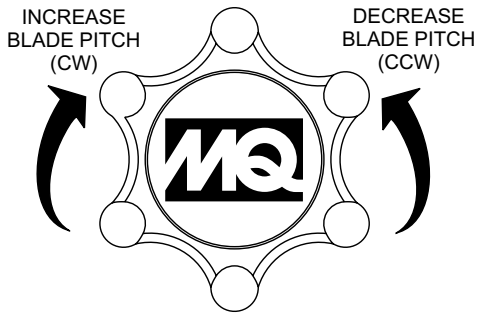

Figure 3. Handle Installation

## BLADE PITCH CABLE INSTALLATION

1. For trowels equipped with a **standard** handle (SXHC), simply turn the **star wheel** counterclockwise to release tension on the blade pitch cable. See Figure 4.



**Figure 4. Adjusting Cable Blade Pitch (Standard Handle)**

2. For trowels equipped with a **Quick Pitch™ T-handle** (QXHC), simply squeeze the trigger lock and push the **T-handle** towards the engine to release tension on the blade pitch cable. See Figure 5.

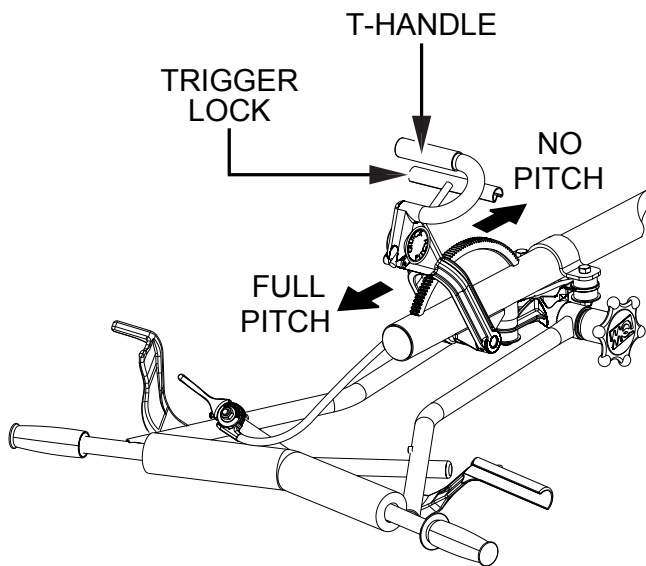
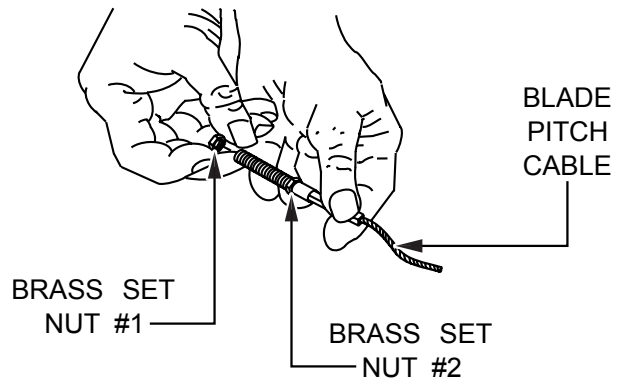

**Figure 5. Adjusting Cable Blade Pitch (Quick-Pitch™ Handle)**

### **WARNING**

The **Quick Pitch™ T-handle** is under spring tension and can snap in the direction of force (toward the user) if not firmly grasped, which may cause bodily injury.

3. Remove brass set nut #1 from the blade pitch cable end (Figure 6).



**Figure 6. Blade Pitch Cable**

4. Thread brass set nut #2 towards the cable as far as possible (Figure 6).
5. Insert the cable end through the yoke eyelet (Figure 7). Tighten brass set nut #1 by hand to remove all the slack from the cable.

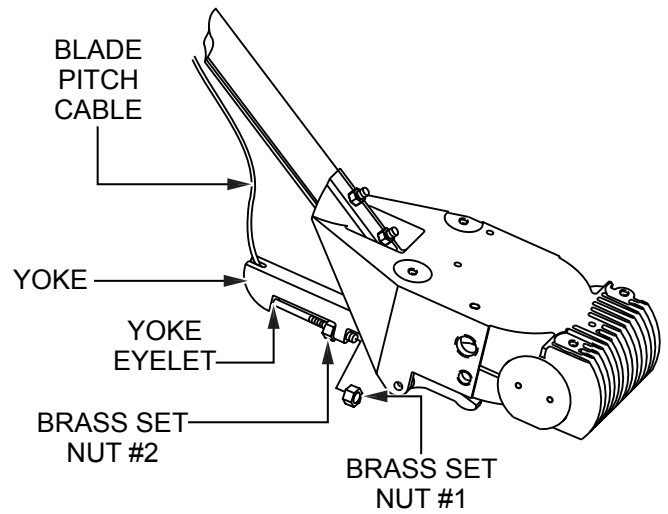
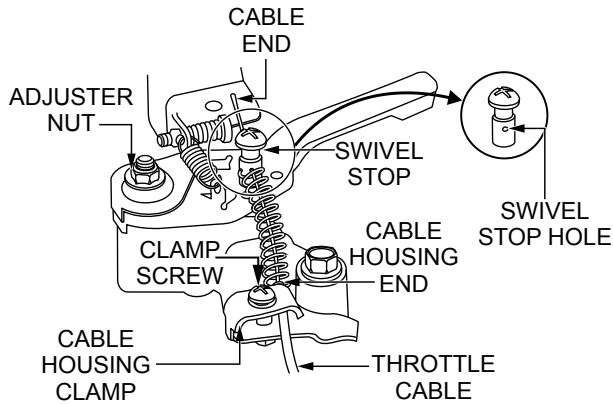

**Figure 7. Cable Yoke Attachment**

6. Using a wrench, tighten the brass set nut #2 up against the yoke boss. This will lock the cable in place.
7. Using a wrench, tighten the brass set nut #1 against the yoke boss.

## THROTTLE CABLE INSTALLATION

Refer to Figure 8.



**Figure 8. Throttle Cable Installation**

1. Uncoil the throttle cable and housing.
2. Check that the throttle cable is fed through the tube on the underside of the handle and secured to the upper handle and main tube with the zip ties.
3. Place the throttle in the run position (Figure 9).

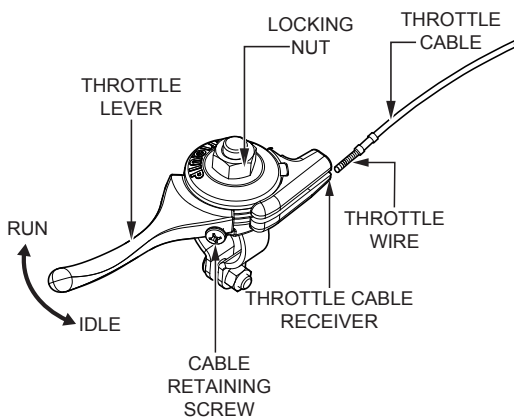

**Figure 9. Adjusting Cable Tension**

4. Back off both the cable housing clamp screw and the swivel stop screw.
5. Place the primary throttle return spring (P/N 21746) between the cable housing clamp and the swivel stop screw.
6. Feed the cable assembly through the cable housing clamp, primary throttle return spring, and swivel stop hole, until the cable housing extends under the housing clamp to its far edge.
7. On the throttle lever, slightly loosen the locking nut and cable retaining screw as shown in Figure 9.

8. Ensure that the cable housing is seated in the throttle cable receiver as shown in Figure 9.
9. Route the throttle wire past the cable retaining screw approximately 1/2" (Figure 9). Tighten the cable retaining screw to secure the throttle wire.
10. Adjust cable tension by loosening or tightening the locking nut and cable retaining screw on the throttle lever (Figure 9).

### NOTICE

If the throttle lever does not return to the **neutral** position with the throttle backed off, loosen the adjusting nut 1/2 turn at a time, tighten, and recheck. Readjust throttle tension as necessary.

## INSTACLUTCH CABLE INSTALLATION

1. Uncoil the free end of the clutch cable.
2. Check that the clutch cable (Figure 10) is attached to the torsion bar cable anchor and clutch cable support bracket.

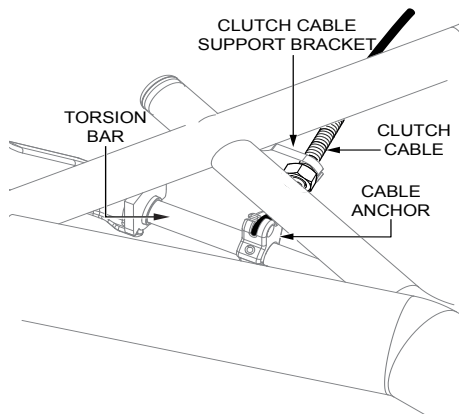

**Figure 10. Upper Handle Clutch Cable**

3. Check that the clutch cable is fed along the tube on the underside of the upper handle and secured to the main tube with the zip ties.
4. Using a 7/16" wrench, remove the three 1/4" retaining bolts that secure the clutch cover to the frame (Figure 11).

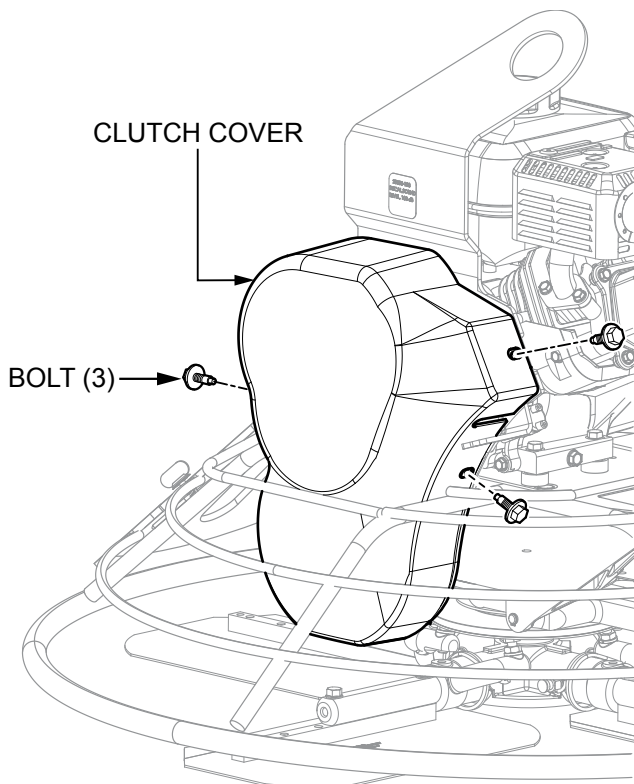

**Figure 11. Clutch Cover Removal**

5. Route the clutch cable (Figure 12) underneath the topmost rung of the guard ring.

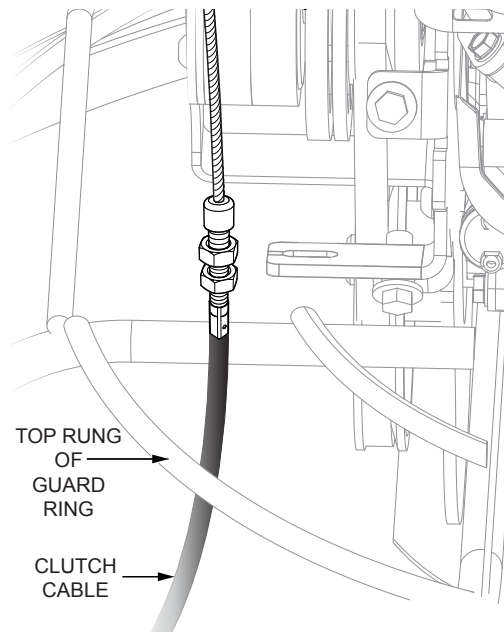

**Figure 12. Clutch Cable Routing**

### NOTICE

Clutch cable routing differs depending on the trowel model. If using trowel model JH55C, the clutch cable is routed **under** the topmost rung of the guard ring.

If using trowel models JH90C, BH90C, or BH111C, the clutch cable is routed **over** the topmost rung of the guard ring.

6. Remove the 5/16" outer nut (Figure 13) and rubber cap from the threaded end on the clutch cable.

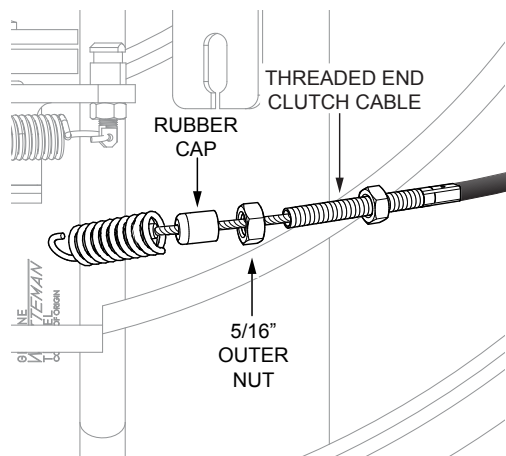

**Figure 13. Outer Nut And Rubber Cap Removal**

- Adjust the 5/16" inner nut (Figure 14) away from the threaded end on the clutch cable to the inner nut.

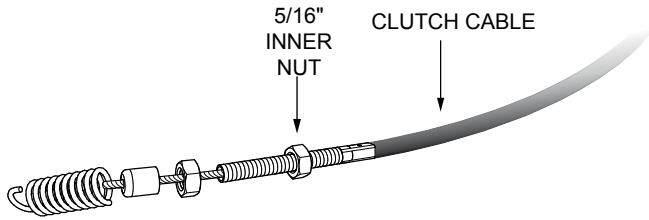

**Figure 14. Inner Nut Adjustment**

- Insert the exposed cable (Figure 15) into the cable slot on the cable support bracket.

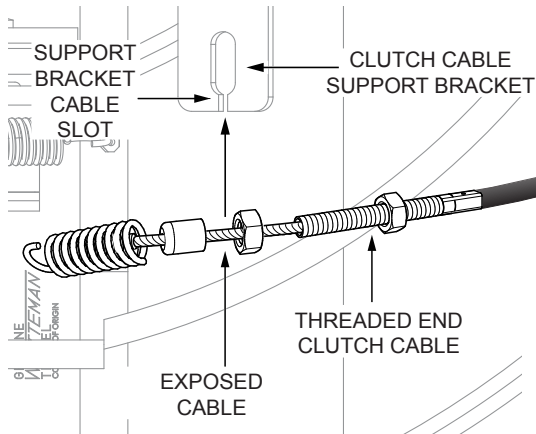

**Figure 15. Inserting Clutch Cable Into Cable Support Bracket**

- Connect the clutch cable to the clutch anchor by placing the spring loop over the clutch anchor flats as shown in Figure 16. Use needle nose pliers to slide the spring loop fully into the groove.

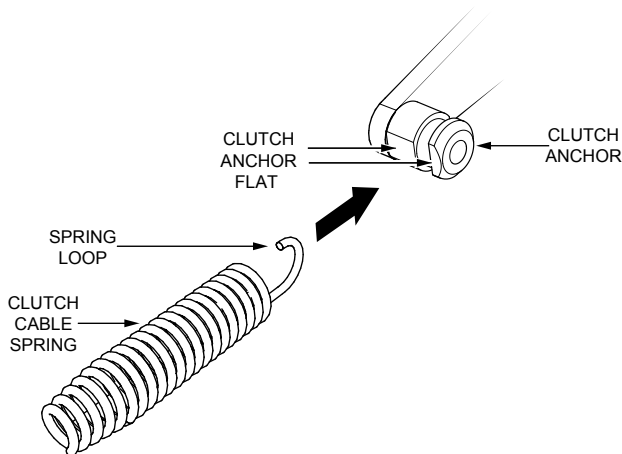

**Figure 16. Spring Loop Attachment**

- Tighten the inner nut (Figure 17) against the clutch cable support bracket until there is no longer any slack in the cable between the threaded cable end and the clutch cable spring.

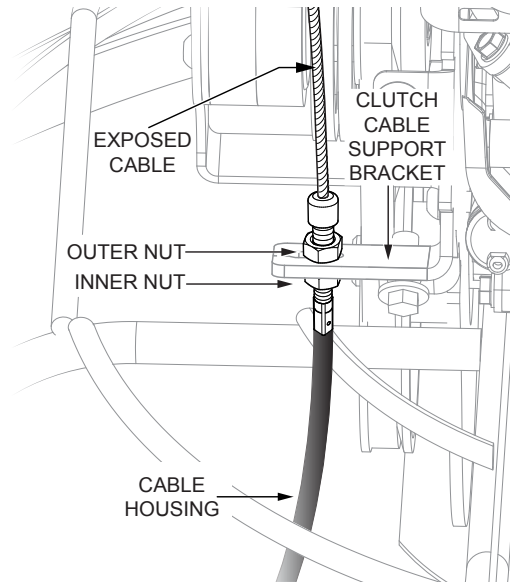

**Figure 17. Attaching Clutch Cable To Cable Support Bracket**

- Using two 1/2" wrenches, tighten the inner and outer nut against the clutch cable support bracket.

## INSTACLUTCH OPERATION

### NOTICE

Failure to follow these safe operation instructions can cause serious injury to the operator or bystanders and property damage. **NEVER** leave the trowel *unattended* with the engine running at high speed.

### Starting The Trowel

1. Place the trowel in an area free of dirt and debris. Make sure it is on secure, level ground.
2. Start the engine as described in the **Operation** manual supplied with the trowel.
3. Run the engine for a few minutes. Make sure there are no fuel leaks or loose components.
4. Stand in the operator's position (Figure 18) behind the trowel and grasp both hand grips securely.

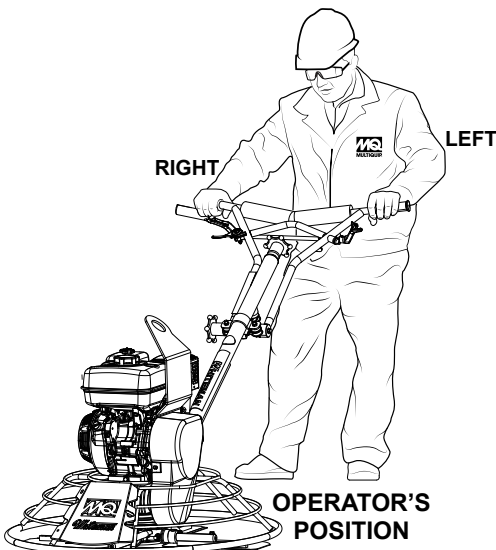

Figure 18. Operator's Position

### NOTICE

Operator must keep at least one hand on either grip at all times when operating the trowel.

5. With one hand on the **left-side** handgrip, move the throttle lever (Figure 19) from **IDLE** to the **RUN** position.

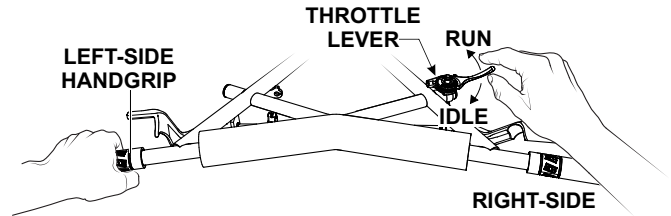

Figure 19. Throttle Lever (Run/Idle)

6. Firmly grasp the **left-side** handgrip, **squeeze and hold right-side** clutch lever (Figure 20) to engage the clutch.

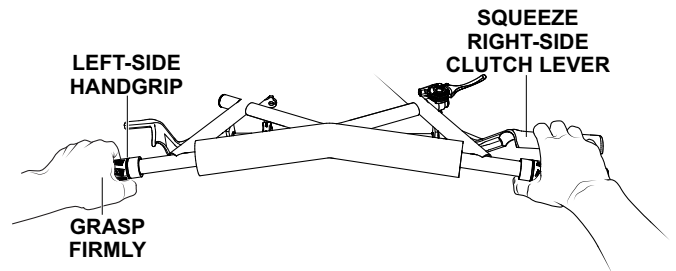

Figure 20. Engaging The Clutch

### WARNING

**BEFORE ENGAGING THE CLUTCH MECHANISM, ALWAYS MAINTAIN A FIRM GRASP ON THE LEFT-SIDE HAND GRIP WITH YOUR LEFT HAND. FAILURE TO DO SO CAN RESULT IN A RUNAWAY TROWEL, WHICH CAN CAUSE SERIOUS INJURY TO THE OPERATOR OR BYSTANDERS AND PROPERTY DAMAGE.**

7. Verify that the trowel blades are rotating.
8. Begin troweling.

### Stopping The Trowel

While maintaining control of the trowel with a firm grasp of the left-side hand-grip.

1. Release the clutch lever and verify the trowel blades have stopped rotating.
2. Return the throttle lever (Figure 19) to the **IDLE** position.
3. Release the handle and place engine ON/OFF switch in the **OFF** position.





# Walk-Behind Trowels

## InstaClutch Handle Installation

---

## HERE'S HOW TO GET HELP

PLEASE HAVE THE MODEL AND SERIAL  
NUMBER ON-HAND WHEN CALLING

### UNITED STATES

#### ***Multiquip Corporate Office***

18910 Wilmington Ave. Tel. (800) 421-1244  
Carson, CA 90746 Fax (310) 537-3927  
Contact: mq@multiquip.com

#### ***Service Department***

800-421-1244  
310-537-3700

#### ***Technical Assistance***

800-478-1244 Fax: 310-943-2238

#### ***MQ Parts Department***

800-427-1244 Fax: 800-672-7877  
310-537-3700

#### ***Warranty Department***

800-421-1244 Fax: 310-943-2249  
310-537-3700

---

### CANADA

#### ***Multiquip***

4110 Industriel Boul.  
Laval, Quebec, Canada H7L 6V3  
Contact: infocanda@multiquip.com

Tel: (450) 625-2244  
Tel: (877) 963-4411  
Fax: (450) 625-8664

---

### UNITED KINGDOM

#### ***Multiquip (UK) Limited Head Office***

Unit 2, Northpoint Industrial Estate, Tel: 0161 339 2223  
Globe Lane, Fax: 0161 339 3226  
Dukinfield, Cheshire SK16 4UJ  
Contact: sales@multiquip.co.uk

© COPYRIGHT 2017, MULTIQUIP INC.

Multiquip Inc and the MQ logo are registered trademarks of Multiquip Inc. and may not be used, reproduced, or altered without written permission. All other trademarks are the property of their respective owners and used with permission.

The information and specifications included in this publication were in effect at the time of approval for printing. Illustrations, descriptions, references and technical data contained in this document are for guidance only and may not be considered as binding. Multiquip Inc. reserves the right to discontinue or change specifications, design or the information published in this publication at any time without notice and without incurring any obligations.

Your Local Dealer is:

