



Walk-Behind Trowels

Operator Presence Switch-Ground Wire Installation

The following instructions are intended to assist the user in the installation and connection of the operator presence switch on the Multiquip walk-behind trowels. It is not intended to take place of the Operation and Parts Manual shipped with the trowel. Please read all assembly instructions before installing the kit.

REQUIRED TOOLS

- Ratchet w/ 10mm, 11mm sockets
- 10mm, 11mm Wrench
- Screwdriver

PARTS

Verify that all parts are accounted for. See Figure 1.

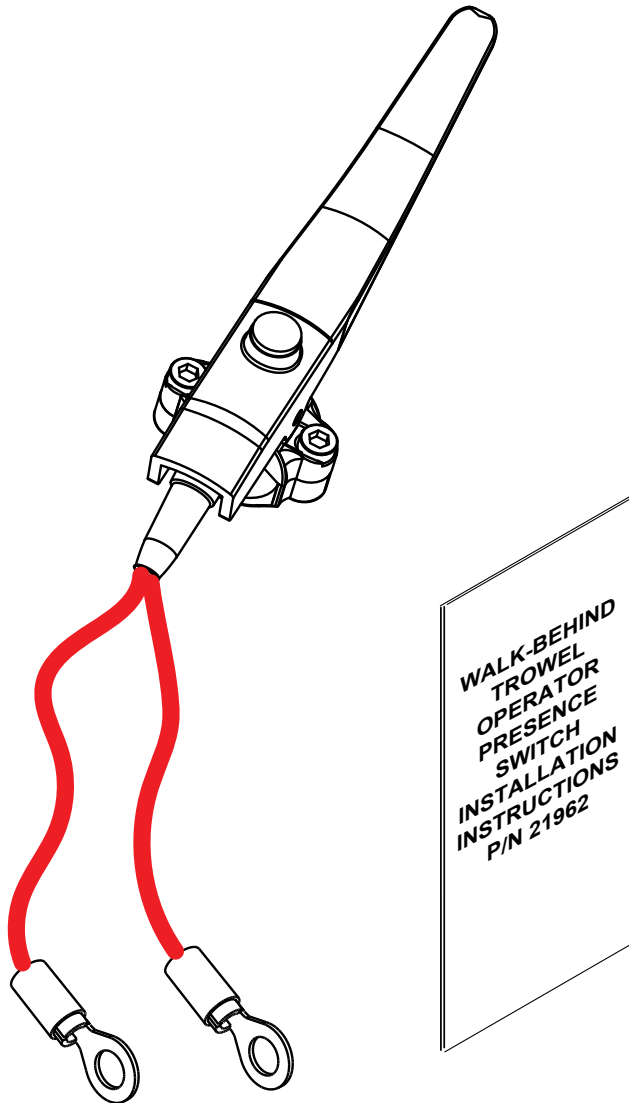

Figure 1. Operator Presence Switch Kit

WORK SAFELY!

Only a **qualified service technician** with proper training should perform this installation. Follow all shop safety rules when performing this installation.

PREPARATION

1. Make sure generator is turned off and engine is cool.
2. Place the trowel in an area free of dirt and debris. Make sure it is on secure level ground.

NOTICE

Before wiring the operator's presence switch and the centrifugal stop switch, install the handle tube onto the gearbox, handlebars onto the handle tube, and throttle cable according to the provided instruction sheet P/N 24011.

CENTRIFUGAL STOP SWITCH WIRING TO ENGINE

Reference Figure 2 for the centrifugal stop switch and operator presence stop switch wiring connection.

1. Connect the black tail wire from the engine to the **top black** safety stop wire from the centrifugal stop switch **(A)**.
2. Using a 10mm socket, remove the existing bottom mounting grounding screw on the recoil starter cover and connect it to the **bottom black/red** wire from the centrifugal stop switch **(A)**.
3. Reposition the operator's presence switch on the handlebars **(B)** with the lever facing the engine **(C)**.

4. Using an 11mm socket or wrench, remove one of the 7mm nuts on each of the centrifugal stop switch terminal lug connections **(D)**.

NOTICE

Leave the existing two wires connected **(D)** as they are the wires connected to the engine black tail wire **(A)** and the engine ground point **(A)**.

5. Route and connect the red wires (2) from the operator's presence switch to the centrifugal safety stop switch terminal lug connections **(E)**.
6. Using an 11mm socket or wrench, re-install and tighten the 7mm nuts to secure the centrifugal stop switch and operator presence switch connections **(E)**.

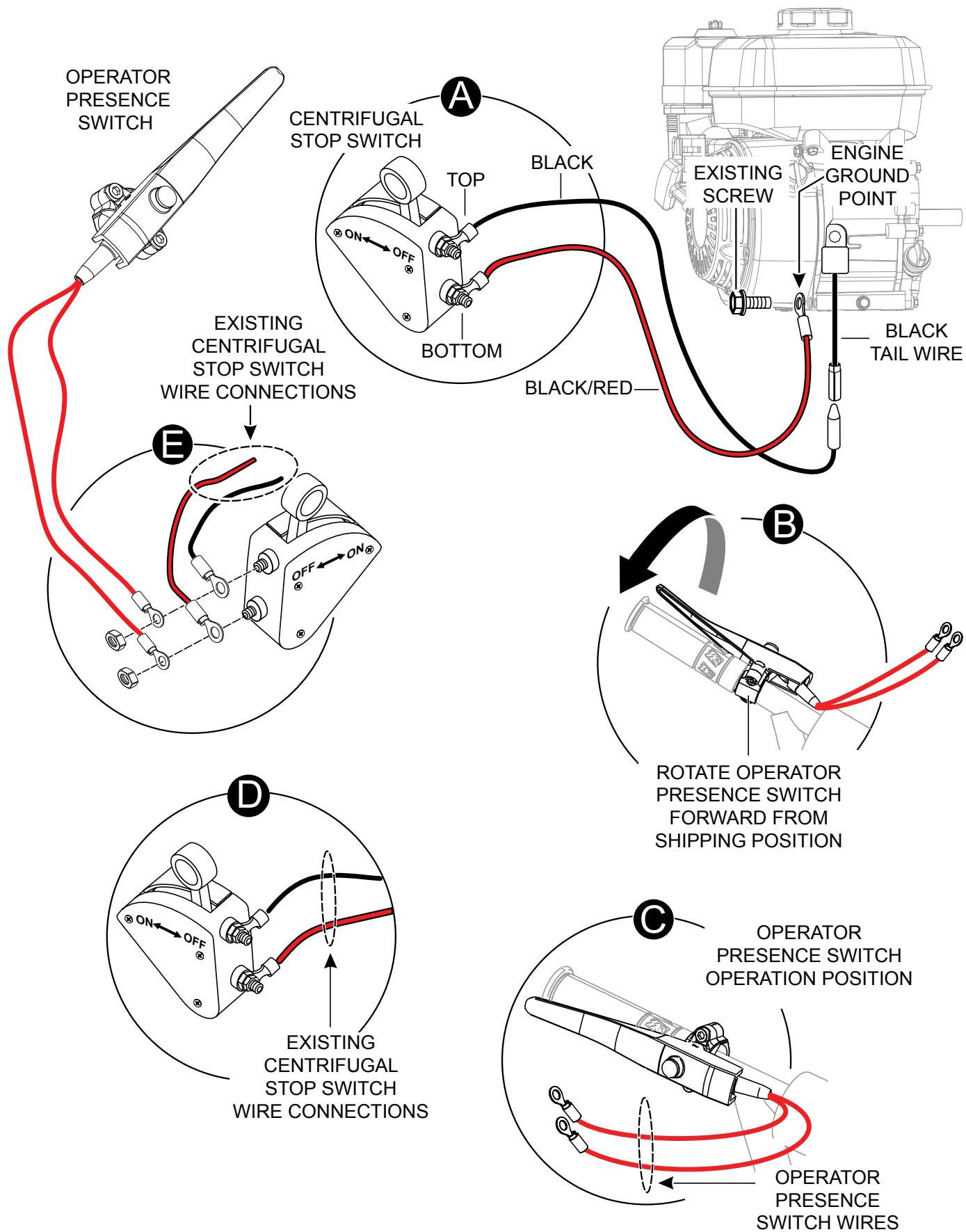

Figure 2. Centrifugal Stop Switch and Operator Presence Switch Wiring Connections



Walk-Behind Trowels

Operator Presence Switch-Ground Wire Installation

HERE'S HOW TO GET HELP

PLEASE HAVE THE MODEL AND SERIAL
NUMBER ON-HAND WHEN CALLING

UNITED STATES

Multiquip Corporate Office

18910 Wilmington Ave. Tel. (800) 421-1244
Carson, CA 90746 Fax (310) 537-3927
Contact: mq@multiquip.com

Service Department

800-421-1244 Fax: 310-537-4259
310-537-3700

Technical Assistance

800-478-1244 Fax: 310-943-2238

MQ Parts Department

800-427-1244 Fax: 800-672-7877
310-537-3700 Fax: 310-637-3284

Warranty Department

800-421-1244 Fax: 310-943-2249
310-537-3700

CANADA

Multiquip

4110 Industriel Boul. Tel: (450) 625-2244
Laval, Quebec, Canada H7L 6V3 Tel: (877) 963-4411
Contact: infocanda@multiquip.com Fax: (450) 625-8664

UNITED KINGDOM

Multiquip (UK) Limited Head Office

Unit 2, Northpoint Industrial Estate, Tel: 0161 339 2223
Globe Lane, Fax: 0161 339 3226
Dukinfield, Cheshire SK16 4UJ
Contact: sales@multiquip.co.uk

© COPYRIGHT 2016, MULTIQUIP INC.

Multiquip Inc and the MQ logo are registered trademarks of Multiquip Inc. and may not be used, reproduced, or altered without written permission. All other trademarks are the property of their respective owners and used with permission.

The information and specifications included in this publication were in effect at the time of approval for printing. Illustrations, descriptions, references and technical data contained in this document are for guidance only and may not be considered as binding. Multiquip Inc. reserves the right to discontinue or change specifications, design or the information published in this publication at any time without notice and without incurring any obligations.

Your Local Dealer is:

