

SAFETY KILL SWITCH

The Safety Kill Switch, This switch is placed on the trowel for protection in the event an operator loses control of the trowel, this switch will shut down the engine.

IDENTIFYING THE SAFETY KILL SWITCH

OLD STYLE



MQ PART# 1103

NEW STYLE



MQ PART# 20856

OPERATION OF THE SAFETY KILL SWITCH

- When unit is running and the handle is let go it will turn (*swing*) to the left.
- For safety the switch is designed to turn off the engine at approximately a quarter of a turn.
- The switch works on centrifugal force.
- This can be tested with the engine running at idle speed, and placed in an open area.





To test the safety kill switch, make sure the switch lever moves back and forth freely, also locate the terminals on the bottom of the switch to check for continuity between the terminals.

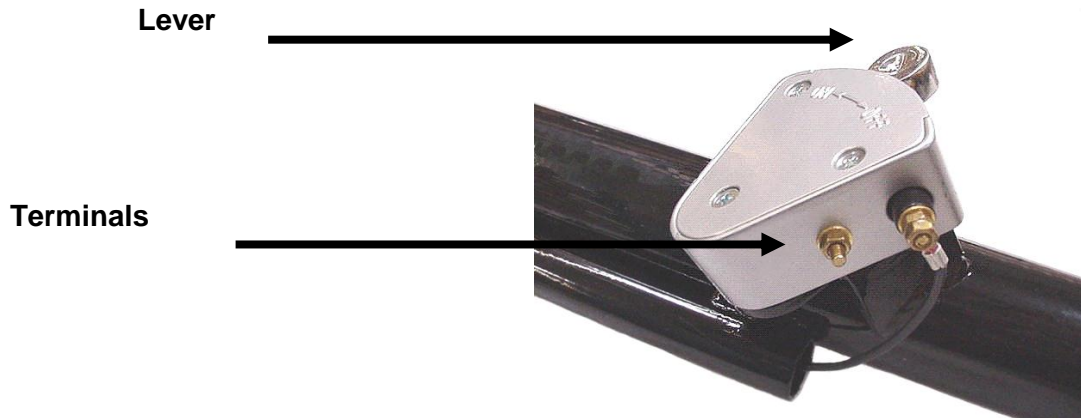

With a meter check for continuity between the terminals, there should be no continuity with the lever in the on position.

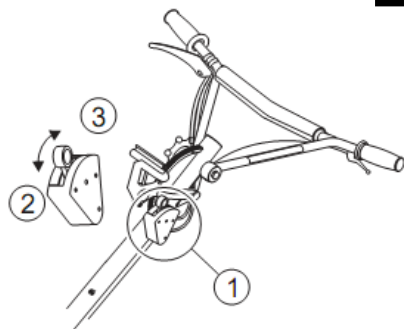

- 1 "Kill" Switch (Safety Stop)
- 2 "ON" Position
- 3 "OFF" Position

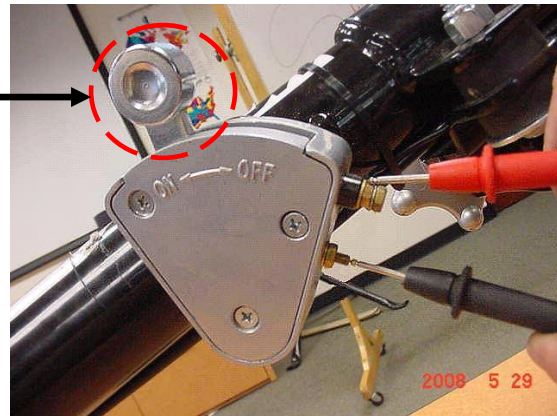

There should be continuity between the terminals when the lever is in the off position.

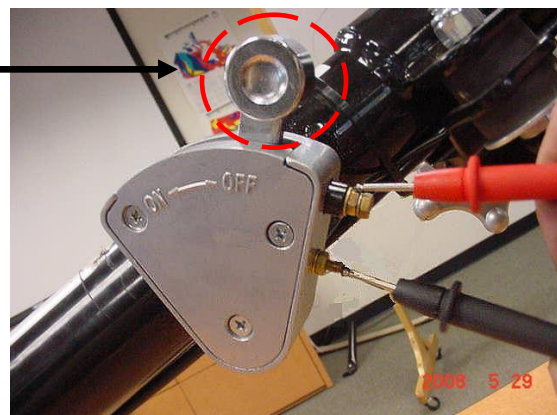

SAFETY KILL SWITCH TEARDOWN

If the switch fails the continuity test remove the safety switch cover and inspect the contacts inside.

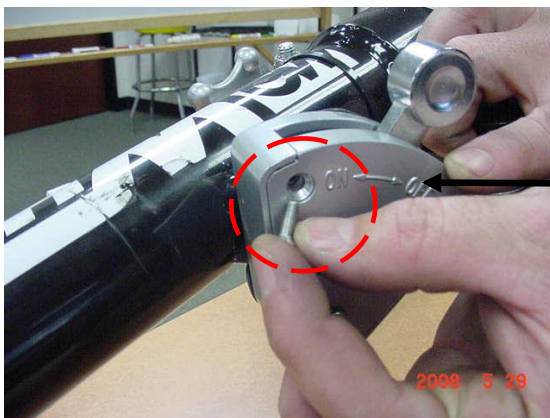

NOTE: when removing the cover remember the top left screw next to the on position is shorter than the others.

Make sure the contacts are not worn, stretched or broken.

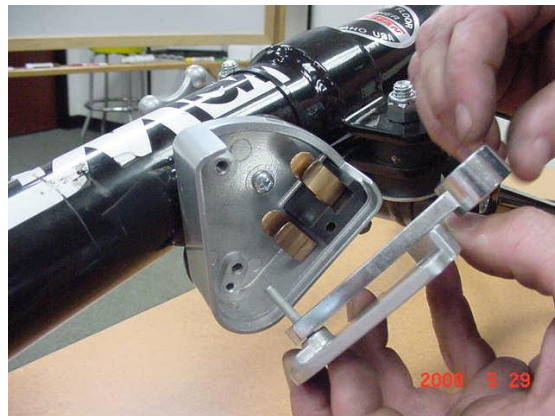

Make sure the lever is making a good connection between the contacts.

