



Trowel Series

Z-Clip Float Pan Installation Instructions

The following instructions are intended to assist the user in the installation of the Z-clip float pans to five and six blade ride-on trowels. Please read all assembly instructions before installing the kit.

REQUIRED TOOLS

- Lifting Safety Strap
- Forklift

PARTS

Verify that all parts are accounted for. See Figure 1 and Table 1.

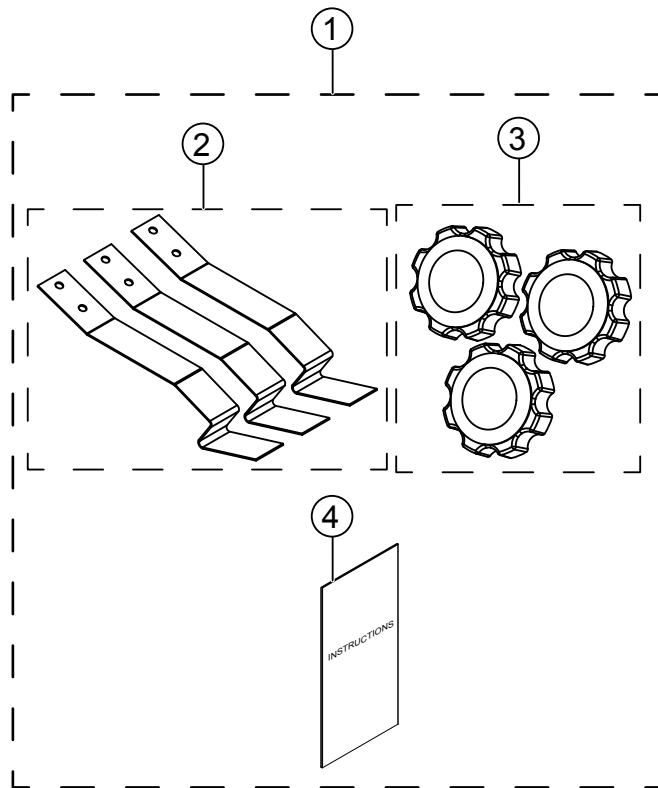

Figure 1. Z-clip Float Pan Installation Kit

Table 1. Z-clip Float Pan Installation Kit

Item No.	Part No.	Description	QTY.	Remarks
1	22204	Z-clip Float Pan Kit	1	Includes items 2-4
2	20847	Z-clip Blade Tie-Down	3	
3	20848	Z-clip Tie-Down Knob	3	
4	21108	Z-clip Float Pan Installation Instructions	1	

WORK SAFELY!

Only a **qualified service technician** with proper training should perform this installation. Follow all shop safety rules when performing this installation.

PREPARATION

1. Make sure trowel is turned off and engine is cool.
2. Place the trowel in an area free of dirt and debris.

INSTALLING Z-CLIP FLOAT PANS ONTO TROWEL BLADES

1. Using a forklift (Figure 2), attach lifting safety straps to the lifting points of the trowel. Lift trowel approximately **six inches** off the ground.

NOTICE

Lifting points are welded to the trowel frame. Make sure to use a forklift and lifting safety straps, or jack stands, with a minimum lifting capacity of 2,500 pounds (1,134 kg).

WARNING



DO NOT lift the trowel any higher than necessary to slide/position the float pans under the trowel blades.

ALWAYS install Z-clip float pans either on the work area or on an area that is next to and level with the work area.

2. Open the Z-clip Float Pan Kit. Confirm that it contains Z-clip blade tie-downs (2) and Z-clip tie-down knobs (2).

3. Slide/Position the Z-clip float pans (Figure 2) under the blade assembly.

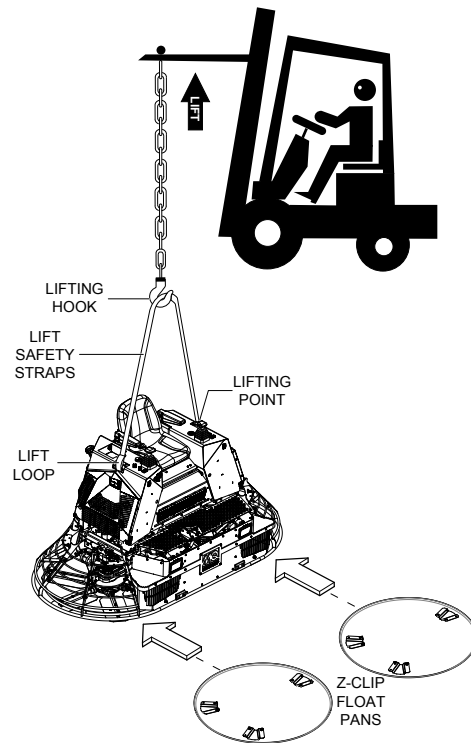

Figure 2. Positioning Z-clip Float Pans

4. Slowly lower trowel onto Z-clip float pans as shown in Figure 3.
5. Rotate the blades into position under the Z-clips as shown in Figure 3.

NOTICE

Be sure to position the blades in the direction of travel when the machine is in operation, or use the engine to rotate the blades into position under the Z-clips.

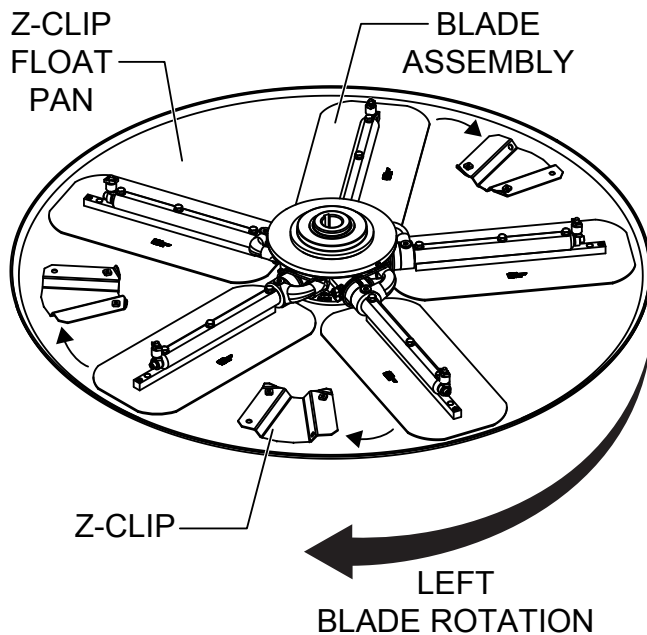

Figure 3. Securing Blades Under Z-clips

6. Attach the Z-clip blade tie-downs (3) to the far side of the Z-clips (3) and secure with Z-clip tie-down knobs as shown in Figure 4.
7. Check to make sure that the blade edges are secured under the Z-clips and the blade tie-downs are secured completely over the edges of the blade bar (Figure 4) before the machine is put back into operation.

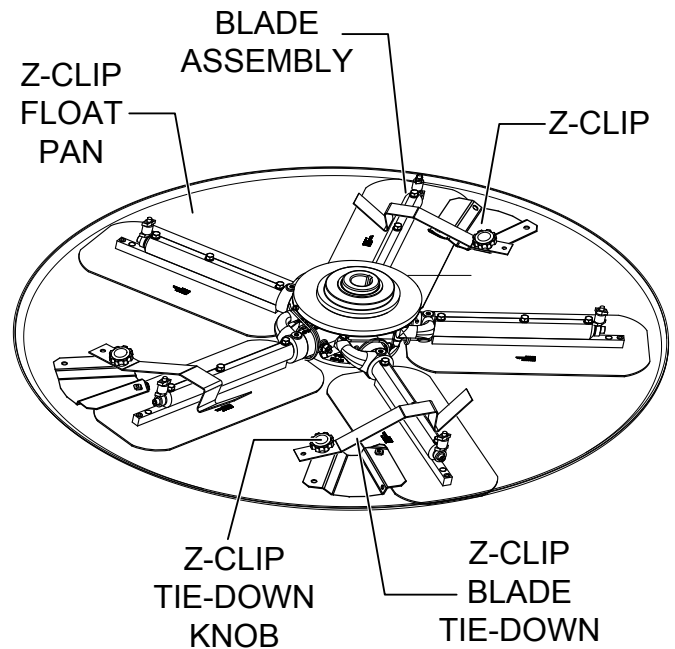

Figure 4. Z-clip Float Pan Installation

WARNING



DO NOT lift the trowel any higher than necessary when the Z-clip float pans are attached.

Lifting trowel to unnecessary heights may cause bodily harm and damage equipment.



Trowel Series

Z-Clip Float Pan Installation Instructions

HERE'S HOW TO GET HELP

PLEASE HAVE THE MODEL AND SERIAL
NUMBER ON-HAND WHEN CALLING

UNITED STATES

Multiquip Corporate Office

18910 Wilmington Ave. Tel. (800) 421-1244
Carson, CA 90746 Fax (310) 537-3927
Contact: mq@multiquip.com

Service Department

800-421-1244 Fax: 310-537-4259
310-537-3700

Technical Assistance

800-478-1244 Fax: 310-943-2238

MQ Parts Department

800-427-1244 Fax: 800-672-7877
310-537-3700 Fax: 310-637-3284

Warranty Department

800-421-1244 Fax: 310-943-2249
310-537-3700

CANADA

Multiquip

4110 Industriel Boul. Tel: (450) 625-2244
Laval, Quebec, Canada H7L 6V3 Tel: (877) 963-4411
Contact: jmartin@multiquip.com Fax: (450) 625-8664

UNITED KINGDOM

Multiquip (UK) Limited Head Office

Unit 2, Northpoint Industrial Estate, Tel: 0161 339 2223
Globe Lane, Fax: 0161 339 3226
Dukinfield, Cheshire SK16 4UJ
Contact: sales@multiquip.co.uk

© COPYRIGHT 2015, MULTIQUIP INC.

Multiquip Inc and the MQ logo are registered trademarks of Multiquip Inc. and may not be used, reproduced, or altered without written permission. All other trademarks are the property of their respective owners and used with permission.

The information and specifications included in this publication were in effect at the time of approval for printing. Illustrations, descriptions, references and technical data contained in this document are for guidance only and may not be considered as binding. Multiquip Inc. reserves the right to discontinue or change specifications, design or the information published in this publication at any time without notice and without incurring any obligations.

Your Local Dealer is:

